

RINSEKIT®

RACK SHOWER



FOR TIPS & TROUBLESHOOTING STEPS

www.RinseKit.com | 800-613-5764 | info@RinseKit.com

SYSTEM

The unit will NOT automatically turn off if the water tank is empty. To avoid damaging the unit, power off the RinseKit when the tank is empty.

MOUNTING

Inadequately secured loads and incorrectly mounted roof racks and accessory racks can come loose during travel and cause serious accidents! Therefore, installation, handling and use must be carried out in accordance with product and vehicle instructions. Check and tighten the mounting brackets periodically.

SOLAR HEATING

Your rack shower will heat the water inside on sunny days. Always check water temperature before using. The water tank may slightly bulge in hot conditions. The bulging will not damage your unit. You can open the fill cap to let the pressure out and the water tank will return to its original shape.

FREEZING CONDITIONS

For freezing conditions or longterm storage, drain all of the water out of the tank, then keep nozzle on until no water sprays out for 30 seconds.

WARRANTY

Your RinseKit comes with a warranty, for more information please visit www.RinseKit.com and click on the warranty tab. Note: receipt/proof of purchase will be required to file a warranty claim.

OTHER INFORMATION

Ok to use with hot and cold water. 33° - 120°F

BPA free materials.

Pump may vibrate when using mist spray setting.

Only use clean water or you may clog the system.

Keep upright to prevent leaking.

Remove hose before driving.



Pb



PB NONSPILLABLE
LEAD-ACID BATTERY
12.5V 5.0 Ah / 20HR

Scan QR code with phone camera
for instructional videos and more
information.



Check out some of our other products at
www.RinseKit.com



WATER HEATER



PARTS

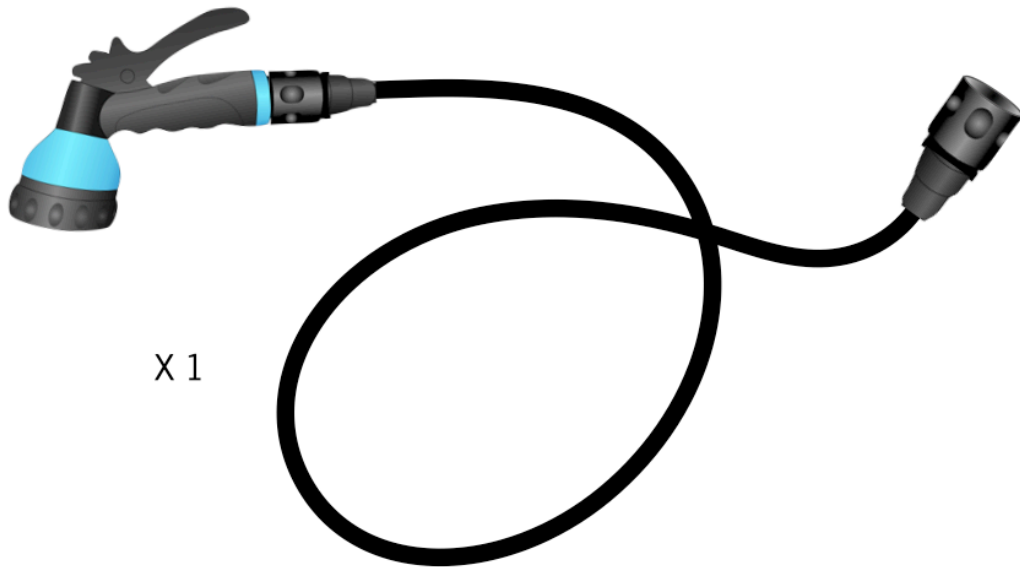
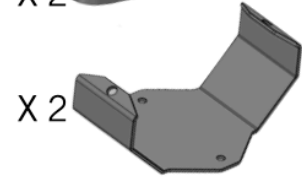
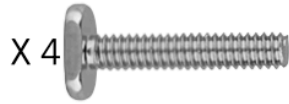
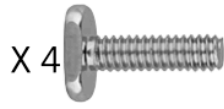

Installation booklet covers the following information

- Attaching mounting brackets
- Mounting on roof rack
- Mounting on other areas
- Controls
- How to fill and use
- Charging
- Connecting to vehicle power

HOW TO INSTALL

Mounting system can be installed on any side.

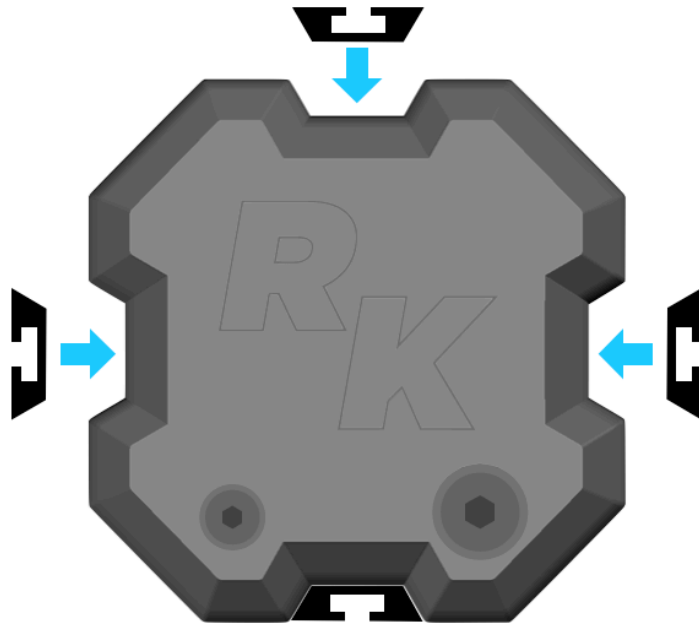

Your Rack Shower comes with the T-channel pre installed on the bottom. To move mounting orientation simply remove set screws and place T-channel on desired side. Then reinsert set screws.



Your Rack shower includes different size T-bolts. Use the length that works best for your application.



1

Insert T-bolts into mounting bracket.

Repeat on second bracket.

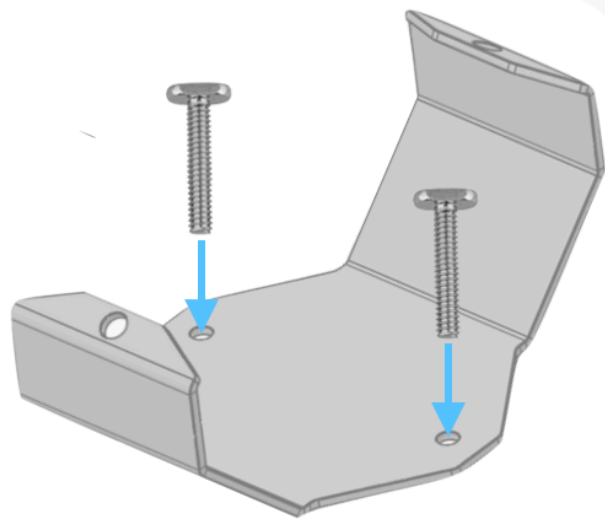

2

Slide mounting brackets with T-bolts onto the end of the rack shower.

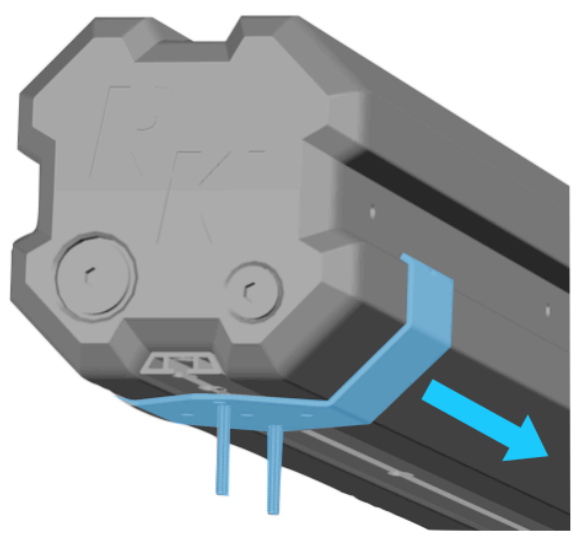
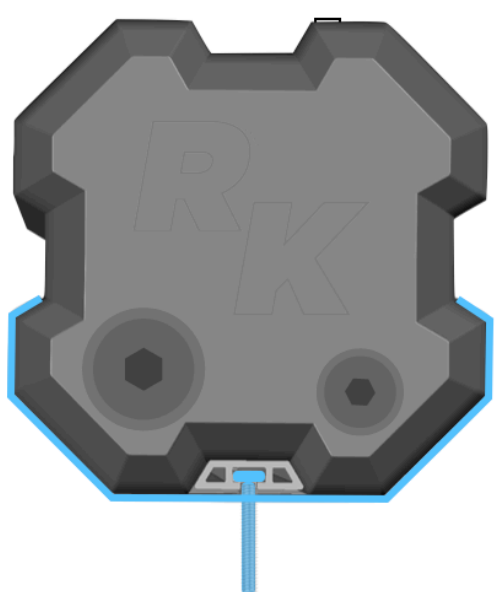

T-bolts should slide into T-channel.

3 Slide both mounting brackets into desired locations.

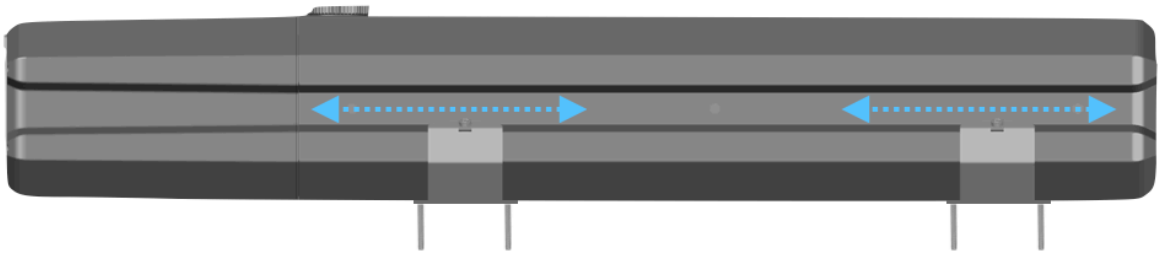

ROOF RACK MOUNTING

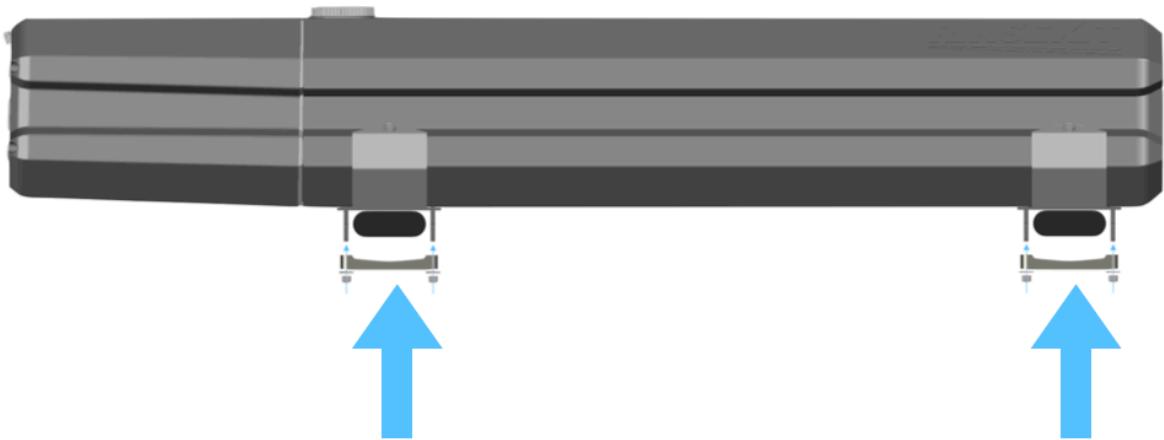

Attach mounting bracket clamp. Then attach and tighten down washer and locknut.

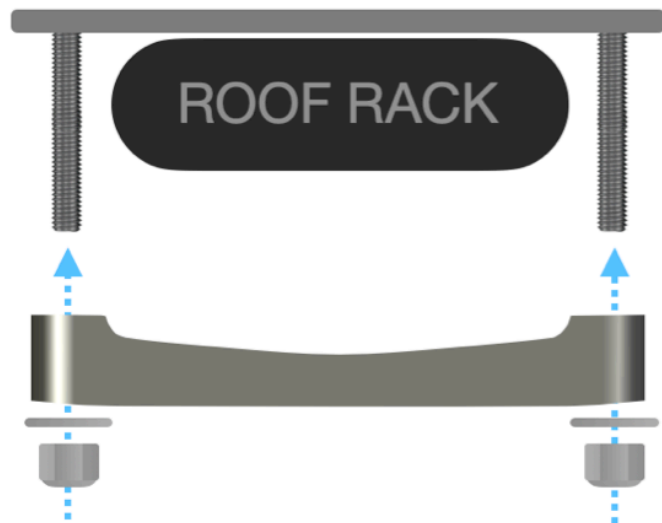

METAL SURFACE MOUNTING

If you are mounting your Rack Shower directly to a metal surface you do not need the clamps.

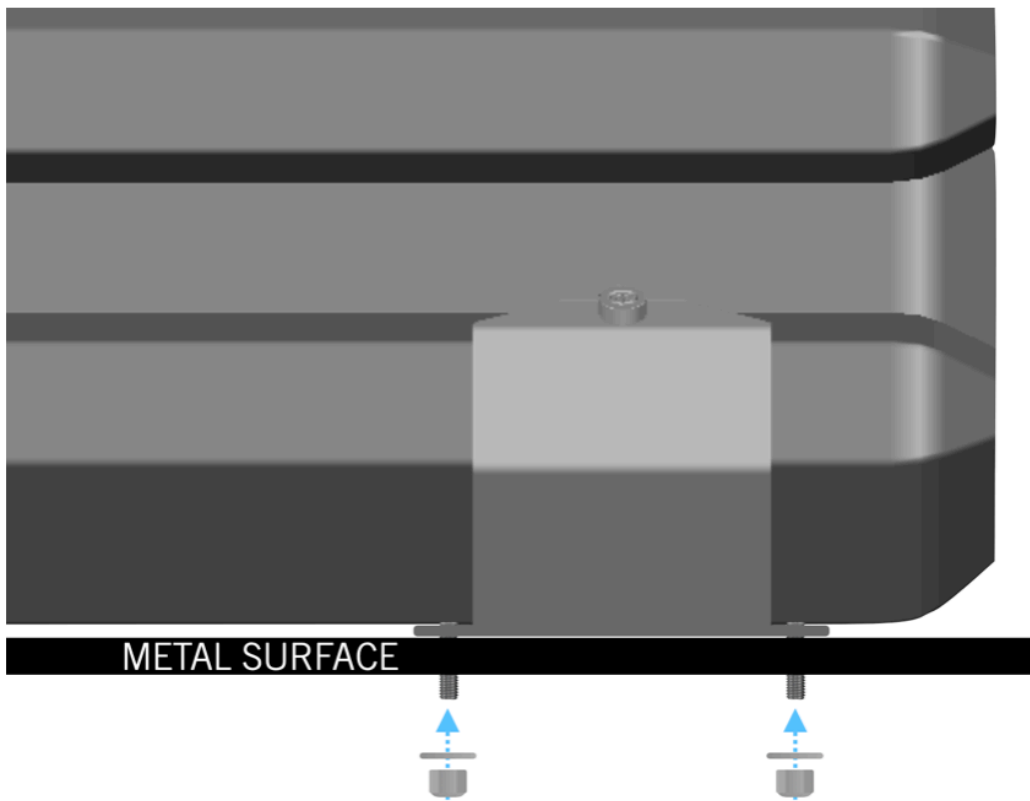
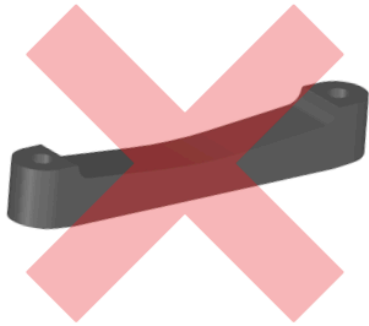

When mounting your Rack Shower to a metal surface, just attach the washers and locknuts.

4

Using the included set screw tool, insert the set screws into the sides of the mounting bracket.

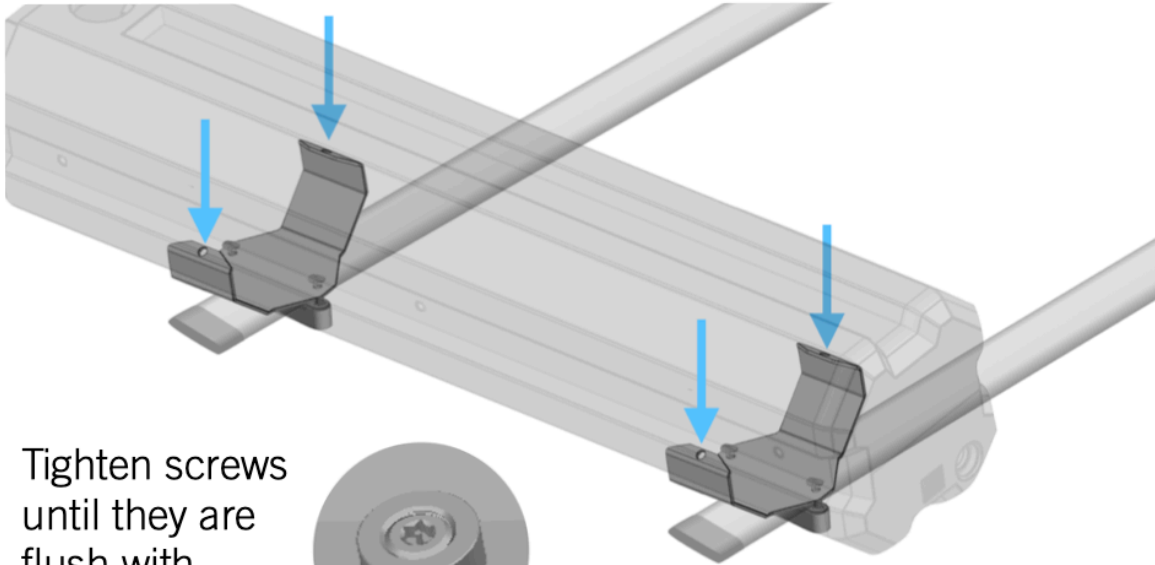
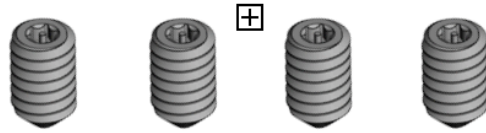

Tighten screws until they are flush with outer sleeve

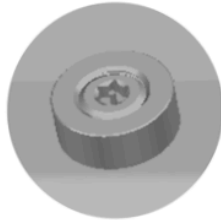

Keep covers in place when not in use to prevent water damage



12v Socket
Used for charging and powering other accessories.

Power Button
Turn power off when not in use or when water tank is empty.

USB Charging
Used for charging your USB devices.

Battery & Temperature
Blue numbers are the water temp. Green and red LEDs indicate battery charge levels. Charge when indicator reaches RED.

1

HOW TO USE

To attach the hose open control panel cover and press hose quick connect firmly on to adapter.

Remove hose and close control panel when not in use.

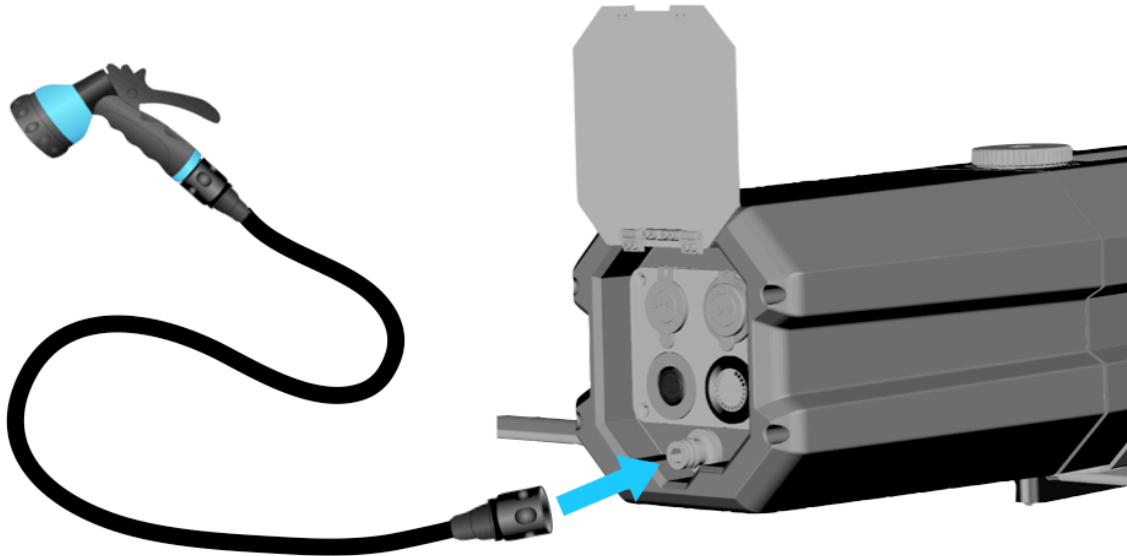

2

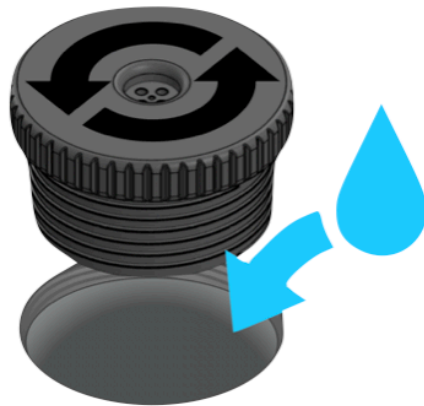

Remove water tank cap and add water



Press power button

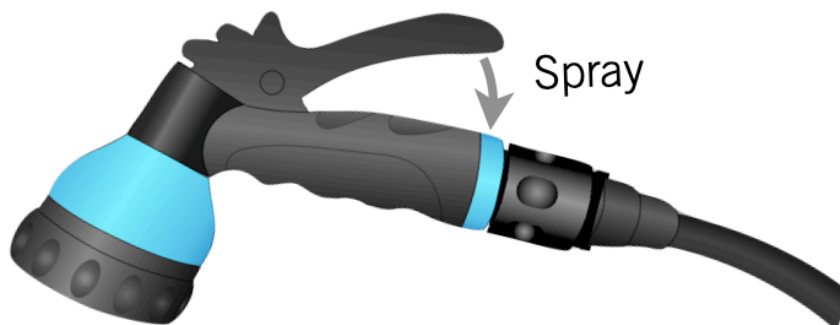

BATTERY COMES CHARGED

Wall Charger



Red LED = Charging
Green & Red Blinking or Green LED = Charged
Note: May take several hours to fully charge.

Car Charger



Red LED = Power
Ok to use system while plugged in.
Note: Will only charge to 12v

OPTIONAL POWER SUPPLY

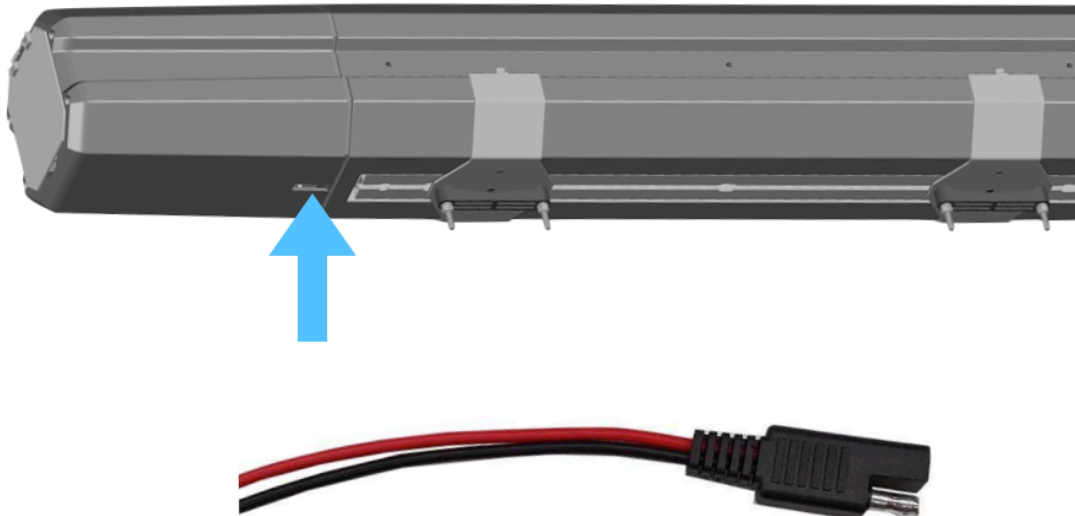

Your Rack Shower includes a 12v SAE plug for connecting directly to your vehicles 12v power supply. You can pull the SAE plug through the opening located on the bottom of the Rack Shower.

Don't forget to tag us on social media
for a chance to be featured on our
RinseKit In Action page!

Use #RinseKit when sharing your post!



@rinsekit



@rinsekitusa

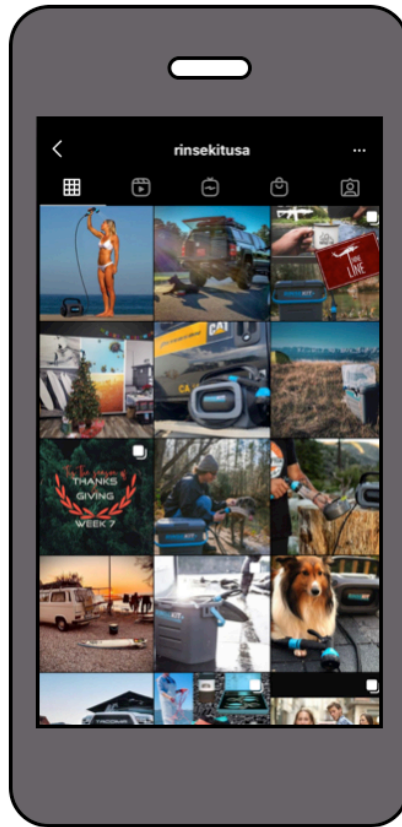

RINSEKIT®

www.RinseKit.com

