

bluedot

HOW TO INSTALL

WARNING: For use only with potable, microbiologically-safe water.

TIME NEEDED: 3 MIN.

(2 minutes to clean out all the stuff under your sink + 1 minute for installation)

1 Turn off your cold water valve.

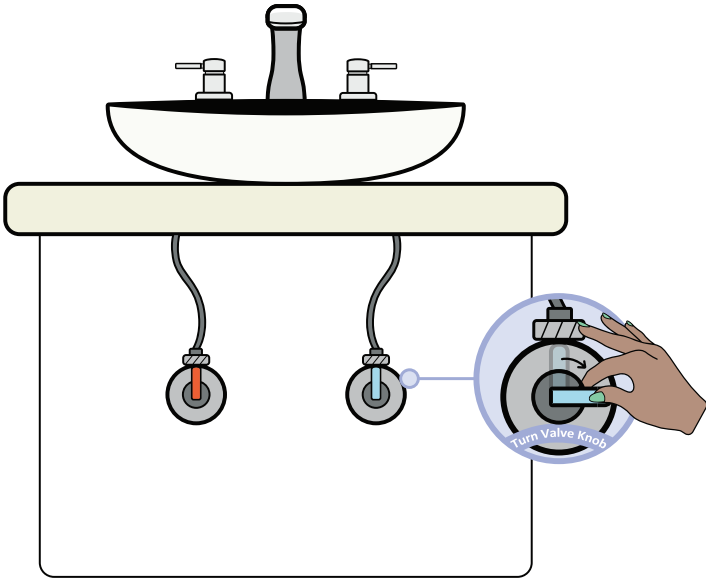

Pro Tip: not sure if you have the right valve? Turn off the valve and try turning on the cold water on your faucet. If nothing comes out or it's barely a trickle, you've got the right one.

2 Screw off the tube connected to the cold water valve and let it dangle for now (towel off any water that comes out). With bluedot's front facing you, screw on bluedot's left side tube.

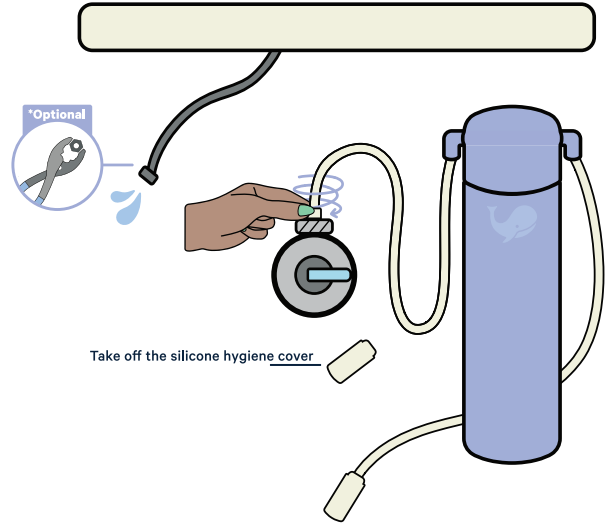

*The connector on the cold water line may be tightly fastened. If you are unable to unscrew it with your hands, use basic pliers or a wrench to loosen the existing cold water line.

3 Take the dangling tube that you screwed off from Step 2, and connect it to bluedot's right side tube.

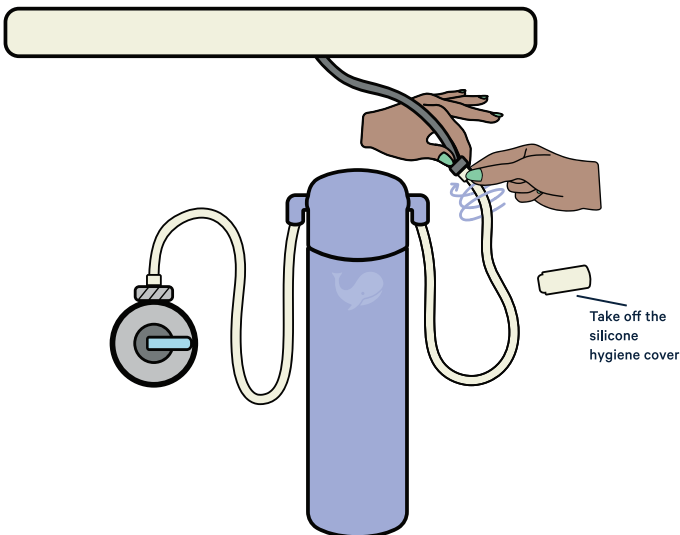

4 Turn on your cold water valve. Turn on your faucet's cold water. There should be zero leaks.* Let your water run for a few minutes so it saturates the filter and clears out any air.

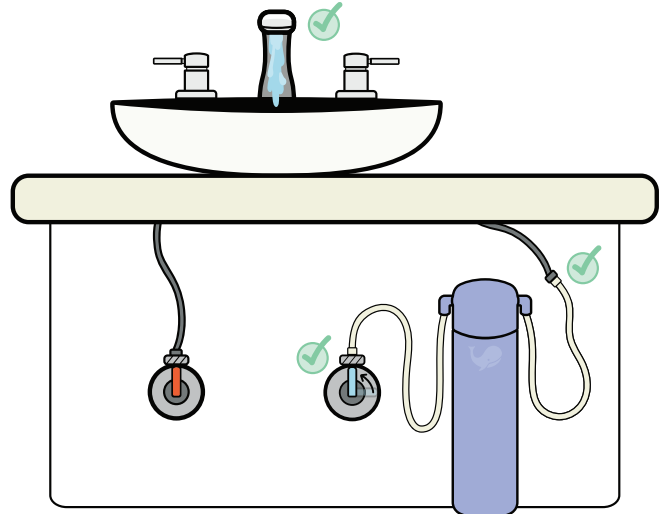

*If you have tightened up the two tube connections but you're still getting a leak, check our troubleshooting guide or call/live chat/email customer support for fast, friendly help.

PREFER TO WATCH AN INSTALL VIDEO?

Us too! Scan the code with your phone >>
or go to: mybluedot.com/pages/installation



OPTIONAL STUFF



Pliers



Towel