

9417 Textile Box Kraffform Kompakt Zyklus Mini 2, empty, 180 x 88 x 46 mm

Textile Pouches and Boxes for Zyklus Mini Ratchets, empty



EAN:	4013288194527	Size:	230x150x45 mm
Part number:	05136466001	Weight:	144 g
Article number:	9417	Country of origin:	CN
		Customs tariff number:	42029298

- Robust, rigid material
- Strong hook and loop fastener system prevents unintentional opening and loss of the tool
- Compact design for space-saving storage
- Low weight for easy transport
- Compatible with Wera 2go

Robust textile box for space-saving tool storage; ideal for mobile use, as the material used is light and firm; for Kraffform Kompakt Zyklus Mini 2; for socket wrench inserts with a maximum length of 13mm; empty.

Web link

https://products.wera.de/en/ratchets_and_accessories_zyklus_mini_textile_pouches_and_boxes_for_zyklus_mini_ratchets_empty_9417.html

Wera - 9417
05136466001 - 4013288194527

Wera Werkzeuge GmbH
Korzter Straße 21-25
D-42349 Wuppertal
Tel: +49 (0)2 02 / 40 45-0
E-Mail: info@wera.de

Textile Pouches and Boxes for Zyklus Mini Ratchets, empty

Robust, lightweight, rigid



The material used is distinguished by its high level of robustness. At the same time, the textile box is light and rigid. Even if the textile box falls down, the tools are well protected.

Secure hold and easy removal

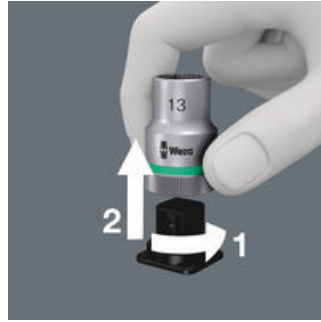

The all new smooth turning mechanism guarantees both secure and rattle-free storage, yet allows easy removal of the tool.

Flexible thanks to hook and loop fastener strips

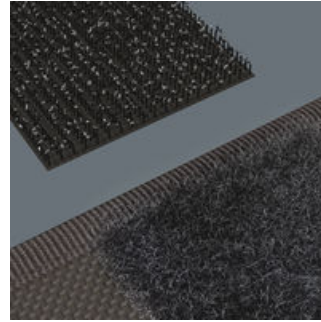

The textile box features a fleece zone at the back. Using the provided self-adhesive hook and loop fastener strips, the textile box can be attached to the Wera 2go components. Or to the wall, shelf or workshop trolley.

Further versions in this product family:

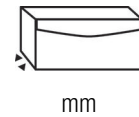
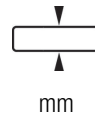
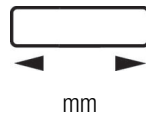

05136466001	180	88.0	46.0
-------------	-----	------	------

Web link

https://products.wera.de/en/ratchets_and_accessories_zyklus_mini_textile_pouches_and_boxes_for_zyklus_mini_ratchets_empty_9417.html

Wera - 9417
05136466001 - 4013288194527

Wera Werkzeuge GmbH
Korzter Straße 21-25
D-42349 Wuppertal
Tel: +49 (0)2 02 / 40 45-0
E-Mail: info@wera.de