

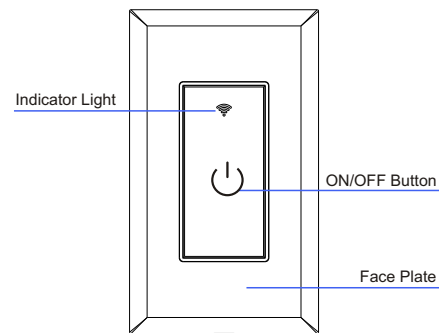

### SWAP-ME-SMART ULTRA USER MANUAL

MODEL NO: KS-602

#### PRODUCT DESCRIPTION



KS-602 Diagram

#### INSTALLATION

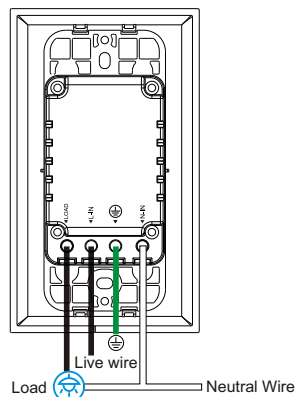

- Make sure the Power is OFF. Check the breaker or power source and make sure the power is always off before starting any electrical work.
- Only use this device if your home has RCD (Residual Current Device) or Leak Protection Detector.

#### PRECAUTION

This Product necessitates replacing the existing switch through a hard wiring process. This device has been tested by the Manufacturer according to all international electrical standards. However, every state has different standards and rules for installing electrical cabling and equipment in home. Please check with your local and state laws prior to using this device. Improper installation of product may cause electrical injury to persons. Installation of this product must be performed by someone who is adequately knowledgeable on electrical wiring, preferably an electrician. Never attempt to do your own electrical work without the supervision of someone who understands electrical wiring installation. Sonicgrace, Inc. assumes no liability for the improper installation of this product.

#### PRODUCT FEATURES

- Ultra Sensitive Touch Control Switch
- Wireless, just connect to your Home Wi-Fi
- No Ethernet Wire, No Hub Required
- Control a switch area of your home anywhere, anytime through your Smart Phone
- Voice Control compatible with Alexa and the GoogleAssistant
- Easy Hard Wiring installation
- Easy App Install
- Create Scenes to turn ON or OFF group of lights at one time
- With LED indicator, easy to find in the dark
- Will work on rooms with more than one switch
- Compatible with IFTTT
- Connects with other eco4life devices

#### Specifications

Type	120 Wi-Fi Smart Wall Light Switch
Model	KS-602
Power supply mode	Neutral-Live Wire
Rated Current	15A(Max)
Rated Voltage	AC110-125V~50/60Hz
Rated Power	1650W
Wireless Frequency	2.4GHZ
Wireless Standard	IEEE802.11 b/g/n

#### IMPORTANT

- This device is Single Band and will only work with 2.4 GHz Wi-Fi Router.
- Do not use special symbols in setting up your Wi-Fi Account Name and Passwords. It has to be numeric and letters only.
- Remember to Turn the Power Off from the Circuit Breaker prior to installation.
- Only use this device if your home has RCD (Residual Current Device) or Leak Protection Detector.

#### ABOUT SMART SWITCHES

- Smart Light Switches require neutral wires.
- Smart light switches are larger than traditional light switches. Make sure there is enough room in the wall or the junction box for the smart switch.
- Make sure your Light Switch is a single-pole switch and not a three-way switch. Smart Switch does not support 3-way switch

#### ADDING THE DEVICE

NOTE: After the Wall Switch has been properly installed

##### 1. Download the 'eco4life' App



Please scan the QR Code or download the 'eco4life' App from the iOS App Store or Google Play

#### ADDING THE DEVICE

##### 2. Registration and Logging In

Go to the Register/Log-In Interface. Enter your phone number. You will then receive a verification code to register. You may also choose to register through other authorized interface at the bottom of the page.

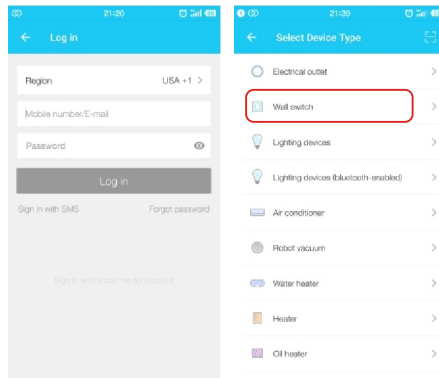

#### ADDING THE DEVICE

##### 3. HOW TO USE SWAP-ME-SMART ULTRA

###### Preparation:

- The Wall Switch has completely been wired and Circuit Breaker has been turned back on.
- Phone has been connected to the internet through Wi-Fi.
- eco4life app has been downloaded.

###### Pairing steps:

- Go to "Devices" from the eco4life App on your phone.
- Long Press the ON/OFF Button of the Wall Switch for 5 seconds until the Indicator Light quickly flashes.
- Tap the "+" icon on the top right corner of "Devices". Choose your device type (Wall Switch). Add Device.
- Make sure that the Indicator Light from the Wall Switch is blinking rapidly, then press "CONFIRM" button from the App on your phone.
- Choose the local Wi-Fi and enter the correct password, tap "Next".
- Wait until it successfully configures, then tap: "CONNECT".

NOTE: If the blue light is flashing slowly, then it is not connected to the Wi-Fi.

#### ADDING THE DEVICE

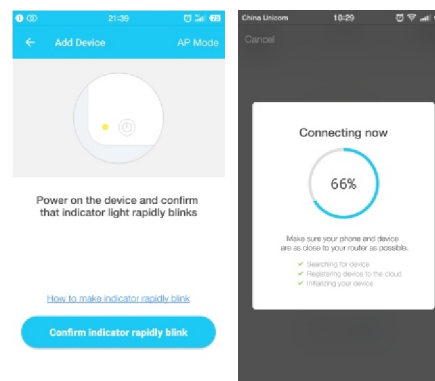

For more troubleshooting help, please visit [www.sonicgracehome.com](http://www.sonicgracehome.com) FAQ or send us an email at [CS@sonicgracehome.com](mailto:CS@sonicgracehome.com)

#### AMAZON ALEXA TUTORIAL



#### GOOGLE HOME TUTORIAL



#### FCC NOTE :

This device complies with Part 15 of the FCC Rules. Operation is subject to the following two conditions: (1) this device may not cause harmful interference, (2) this device must accept any interference received, including interference that may cause undesired operation.

The manufacturer is not responsible for any radio or tv interference caused by unauthorized modifications or change to this equipment. Such modifications or change could void the user's authority to operate the equipment.

This equipment has been tested and found to comply with the limits for a Class B digital device, pursuant to part 15 of the FCC Rules. These limits are designed to provide reasonable protection against harmful interference in a residential installation. This equipment generates, uses and can radiate radio frequency energy and, if not installed and used in accordance with the instructions, may cause harmful interference to radio communications. However, there is no guarantee that interference will not occur in a particular installation. If this equipment does cause harmful interference to radio or television reception, which can be determined by turning the equipment off and on, the user is encouraged to try to correct the interference by one or more of the following measures:

- Reorient or relocate the receiving antenna.
- Increase the separation between the equipment and receiver.
- Connect the equipment into an outlet on a circuit different from that to which the receiver is connected.
- Consult the dealer or an experienced radio/TV technician for help.

#### RF warning statement:

To maintain compliance with FCC's RF exposure guidelines, this equipment should be installed and operated with a minimum distance of 20cm between the radiator and your body.