

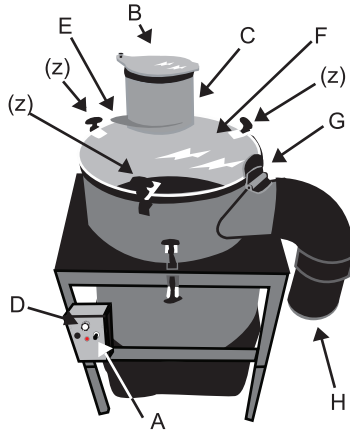



**FASTER & SAFER**

THE TRIMPRO AUTOMATIK IS DESIGNED TO BE USED WITH FRESHLY HARVESTED PLANTS.



**USER INSTRUCTIONS**

- 1- Read carefully the security instructions (see Warnings  in rear) before using the machine.
- 2- Plug the machine in an outlet.
- 3- Turn on the machine using the ON/OFF switch (A).
- 4- Open the lid (B) using the handle (C) on the top container.
- 5- Fill the upper container with freshly harvested and pre-cut plants.
- 6- Close the upper container's lid
- 7- Adjust the motor dimmer (D) at 100%
- 8- Slowly open the door at the base of the upper container (E) to empty it in the main container (F).
- 9- Once empty, close the door (E).
- 10- If necessary, slow down the dimmer speed (D) for the plants to stay more on top of the grate surface.
- 11- Let the plants bounce around into the machine for 1 to 3 minutes or until obtaining the desired cut.
- 12- Place the dimmer (D) to 100% to help the plants to go out.
- 13- Open the exit door (G) and keep it open until the main container is empty.
- 14- Open the final door (H) to get the cut plants and then, close the door.

**REPEAT** : Repeat steps 4 to 14 as needed, depending on the quantity of plants to be arranged.

- 15- Turn off the machine using the ON/OFF switch (A).
- 16- Unplug the machine from the outlet.

**MAINTENANCE**

In order to facilitate the trimming, spray vegetable oil and clean the grate and blades frequently with soap or isopropyl alcohol. This must be done when the machine is not running. Sharpen the blade when necessary. To sharpen them, never remove the blades from the hub even for sharpening.

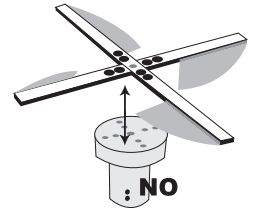

**1**  Read all warnings in rear.

**2 & 3**

**4**

**5**

**6**

**7** 100%

**8**

**9**

**10** REDUCE

**11** 1-3 min

**12** 100%

**13**

**14**

**15 & 16**

## ASSEMBLY

- 1- Remove the machine and its components from the transportation box.
- 2- Unfasten the three rubber fasteners (see part identified as "z" on the drawing on the other side of the sheet) attaching the transparent plastic and metal structure; turn it upside down and fix it with the same rubber fasteners.
- 3- Install the four legs and tighten them to the structure with the thumb screws supplied.
- 4- Assemble the two black plastic tubes together and install them on the machine.
- 5- Cut the plastic tie that is holding the electrical box and remove the box from inside the machine.
- 6- Install this box on the 3 screws prepared for it (front upper left of the machine). To do so, align the 3 holes on the back of the electrical box with the 3 screws, press the box against the machine to allow the 3 screws to enter inside the holes and then push it down to put in place (see drawing below).
- 7- (Optional) To make sure the electrical box is firmly tighten to the machine, remove the lid using the 2 screws, tighten the 3 screws that hold the box on the machine and put back the lid in position with the 2 screws.
- 8- Use the velcro strips at the top of the bag to fix it to the ring beneath the machine.
- 9- Place a bucket below the plastic tube.

Step 5

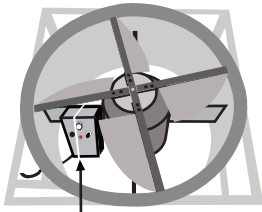

Plastic tie

Step 6

SIDE VIEW

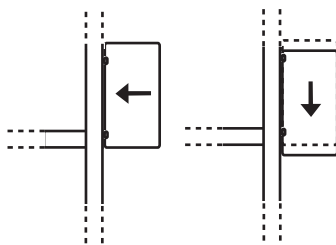

Step 7

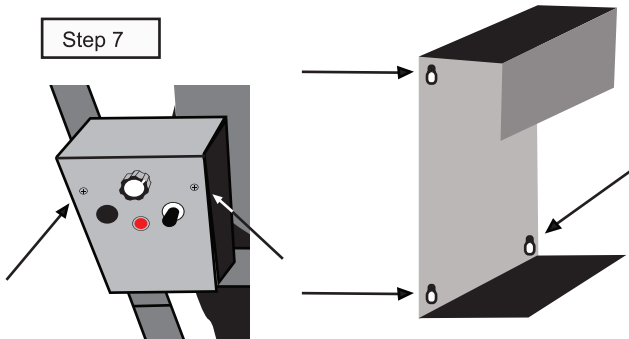

## WARNING!

### WHEN THE MACHINE IS RUNNING:

- Never place your fingers or the gloves or any other body part in contact with the grate or the blade.
- Safety glasses and gloves are required at all time. The gloves have to be tight enough so they don't get inside the grate slots. A loose glove is dangerous, beware!
- Never apply pressure on the grate.
- Do not use scissors, knives or any instrument above the grate.

## ADJUSTMENT OF THE BLADES HEIGHT

To adjust the height of the blades, follow these steps:

- 1- Remove both "A" screws (blocking screw), then both "B" screws (tightening screw) (See drawing "Adjustment screws").
- 2- Turn the "C" screw (height adjustment screw).  
To raise the blades, turn clockwise.  
To lower the blades, turn counterclockwise.
- 3- Apply pressure on the blades to ensure it is well located.
- 4- Put both "B" screws back.
- 5- Verify if the height of the blade is OK by closing the grate.  
If not, return to step 1.
- 6- To finish, put both "A" screws back.

**NOTE:** The "A" and "B" screws should always be aligned with the flat side of the motor shaft.

## SHARPENING

- 1- Remove both "A" screws (blocking screw), then both "B" screws (tightening screw). (See drawing "Adjustment screws").
- 2- Remove the blades and the hub in one piece from the motor shaft.
- 3- Clean the blade with isopropyl alcohol.
- 4- Use a grindstone.
- 5- Put a gentle pressure with the bottom of the blades on the grindstone with the sharpening angle desired.
- 6- Pass the blades on the grindstone with a movement from left to right and from right to left until each blade is properly sharpened.
- 7- Put back the blades and the aluminum hub on the motor shaft.
- 8- Put back in position the 4 set screws in the 2 holes on the side of the aluminum hub. Make sure these set screws are aligned with the flat part of the motor shaft.

In order to facilitate the trimming, spray vegetable oil and clean the grate and blades frequently with soap or isopropyl alcohol. This must be done when the machine is not running. Sharpen the blade when necessary. To sharpen them, never remove the blades from the hub even for sharpening.

## ADJUSTMENT SCREWS

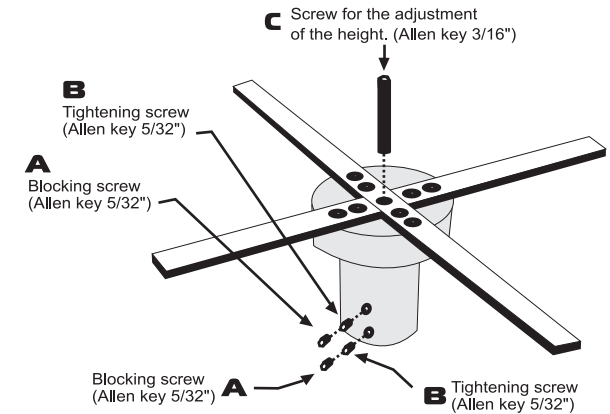

### LOWER THE BLADE

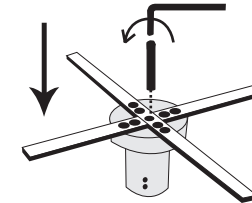

### RAISE THE BLADE

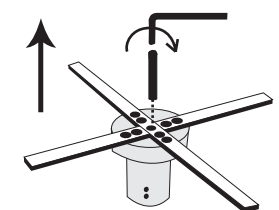

## WARNING



For security, we recommend to keep a distance of at least 1/8 of an inch (3mm) between the grate and the blades.

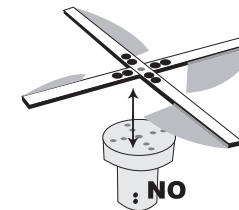

## FOR INFORMATION OR TO ORDER

VISIT: [WWW.TRIMPRO.CA](http://WWW.TRIMPRO.CA)  
Contact: [info@trimpro.ca](mailto:info@trimpro.ca)  
Call (Canada): +1-450-349-0811

PATENT : CAN : 2.470.370 USA : 7.168.643 AUS: 2004269786  
PATENT PENDING : EUR: 04761713.9 CE STANDARD

To be used in accordance with all existing laws and regulations. The manufacturer does not accept any responsibility for damages caused to or by the TRIMPRO AUTOMATIK, resulting from an inadequate use or assembly.