

RD8i digital dry-contact relay interface for HVAC signal control, solenoid and irrigation valve control, and contactor panel control. For controlling building and greenhouse electrical loads such as lighting, exhaust fans, etc..

Connects instantly to Agrowtek's control systems or intelligent sensors via a GrowNET™ port for advanced automated control functions. GrowNET™ port accepts MODBUS RTU communication for PLC control with the LX2 ModLINK.

LED indicators on the front panel provide status of each relay. Rugged metal enclosure for wall mounting. Durable, high current relays. Conduit knock-outs for easy electrical installation.

Flexible and reliable relay controller ideal for many applications.



Features



Eight Independent N.O. Dry Contact Relays with LED Status Indicators



24-120Vac, 24Vdc / 10A per relay



1-Year Warranty



GrowNET™ Digital Communication Port



MODBUS RTU for industrial PLC applications
12-24Vdc



Durable powder-coated steel enclosure



Made in USA

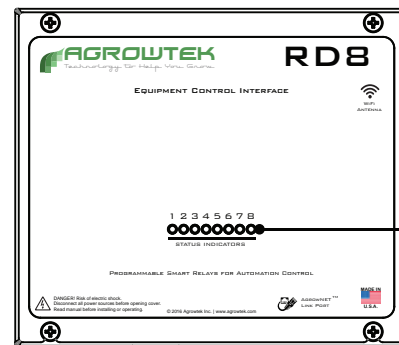
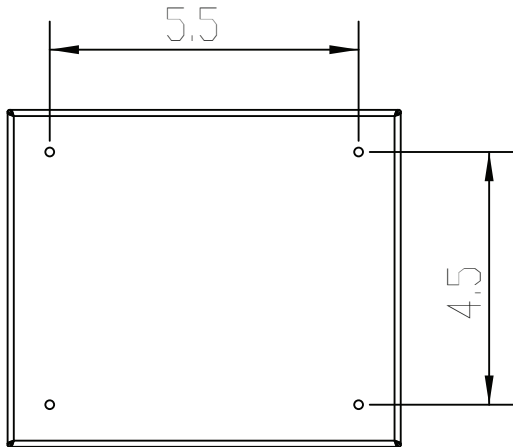

Status LED's

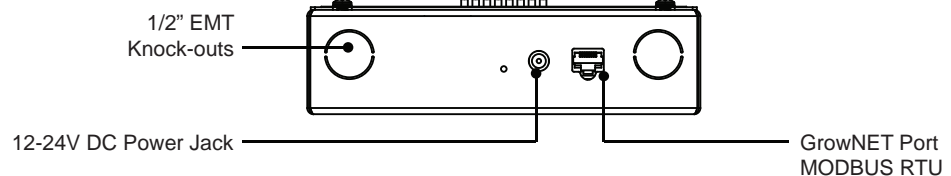

Applications



Load Panel Contactor & Relay Control
Lighting & load control in buildings & greenhouses



Dehumidifiers



HVAC Systems
24Vac heat, cool, fan, valve & other signals



Exhaust & Circulation Fans



Irrigation Solenoid Valves



Custom Equipment

GrowControl™ GCX Controller



Connect to GrowControl™ Cultivation Controllers for advanced functions as part of a complete facility control solution. GrowControl™ GCX systems feature intelligent control functions optimized for today's complex growing environments.

Mini Controller



Connect the RD8i relay directly to Agrowtek's intelligent SXE climate sensors to create a basic environmental control system. Program relay contacts individually for temperature, humidity, or CO2 and cycle timer control. Uses the GrowNET™ ports and a cross-over cable to link the devices together.

MODBUS



GrowNET™ devices are easy to implement on PLC systems with MODBUS RTU and a LX2 ModLINK interface. Multiple GrowNET™ devices can be connected to an interface with HX8 GrowNET™ hubs.

Ordering Options

RD8i

No Options

Optional Accessories



LX1
USB
AgrowLINK™



LX2
RS-485
ModLINK™



HX8
GrowNET™
Device Hub