

## ASSEMBLY - ORIGINAL SPEED CONTROL BOX

- \* The Speed Control Box is not waterproof. Before washing your trimmer, remove the control box using the wing nuts and quick disconnect cable.
- \* The Speed Control Box comes with a 2 years warranty.
- \* Make sure the machine is unplugged.

### STEP 1

REMOVE BELT COVER.

5/32" T-HANDLE ALLEN WRENCH.

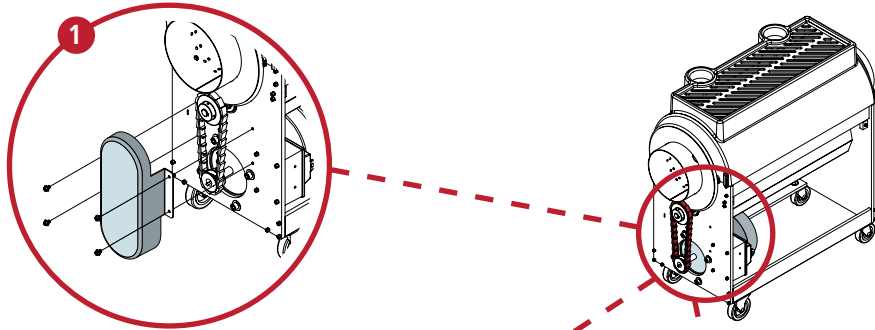

### STEP 2

USE A PRYBAR OR SCREW-DRIVER TO REMOVE BELT FROM PULLEYS.

TO AVOID DAMAGE, DO NOT PRY AGAINST BEARING.

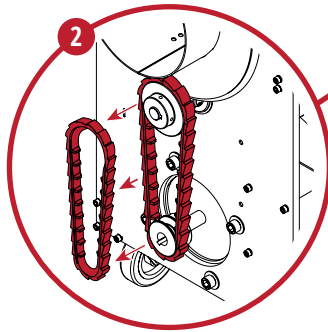

### STEP 3

REMOVE MOTOR BY REMOVING THE FOUR MOUNT BOLTS.

5/16" T-HANDLE ALLEN WRENCH.

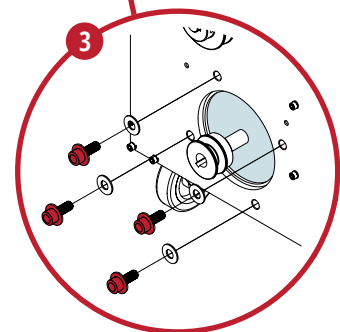

### STEP 4

REMOVE SWITCH BOX BY REMOVING THE SWITCH FACE-PLATE. USE A WRENCH AND ALLEN WRENCH TO REMOVE THE 2 MOUNT SCREWS.

5/32" T-HANDLE ALLEN WRENCH.

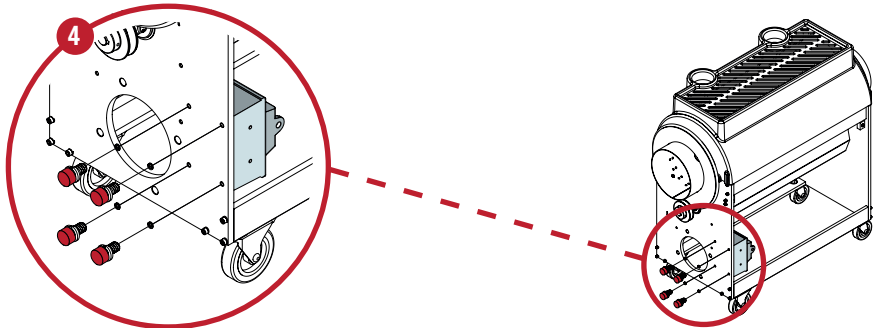

### STEP 5

USE SUPPLIED DRILL TEMPLATE AND DRILL BIT TO DRILL 2 HOLES ON THE SIDE PLATE OPPOSITE OF THE MOTOR.

13/64" DRILL BIT.

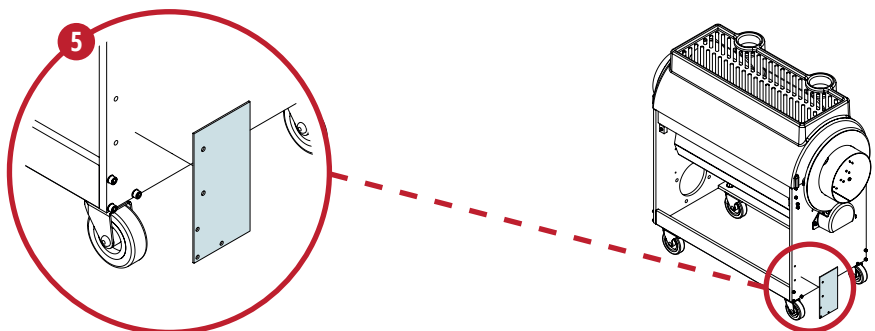

## ASSEMBLY - ORIGINAL SPEED CONTROL BOX

### STEP 6

INSTALL NEW MOTOR WITH NEW PULLEY USING THE FOUR MOUNT BOLTS.

5/16" T-HANDLE ALLEN WRENCH.

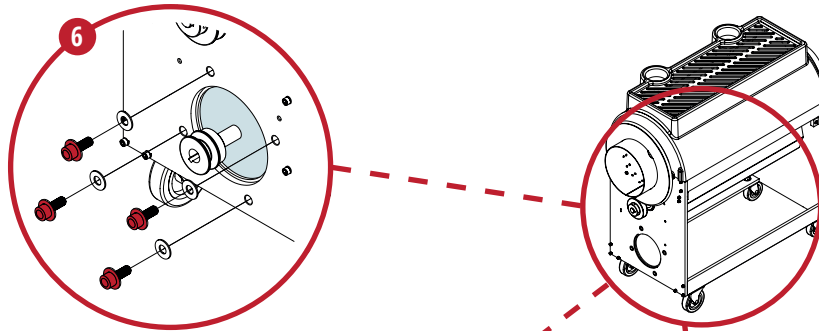

### STEP 7

INSTALL THE CONTROL BOX USING THE 2 HOLES THAT WERE DRILLED WITH 2 NEW SCREWS AND WING NUTS. ORIENTATE CONTROL BOX AS SHOWN.

5/32" T-HANDLE ALLEN WRENCH.

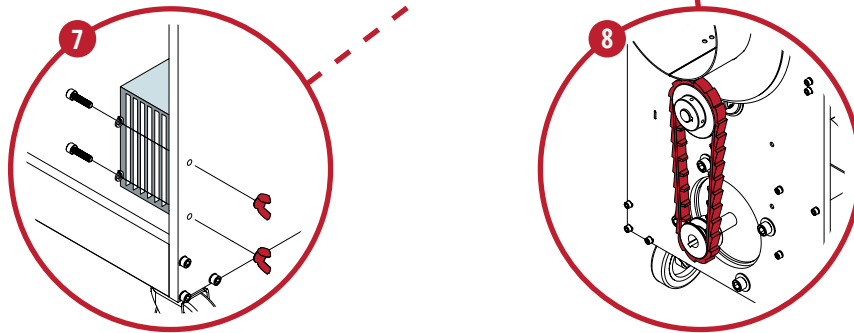

### STEP 8

INSTALL THE NEW BELT ONTO THE PULLEYS USING A PRY-BAR OR SCREWDRIVER. ADJUST PULLEY ALIGNMENT SO THAT BELT RUNS STRAIGHT.

TO AVOID DAMAGE, DO NOT PRY AGAINST BEARING.

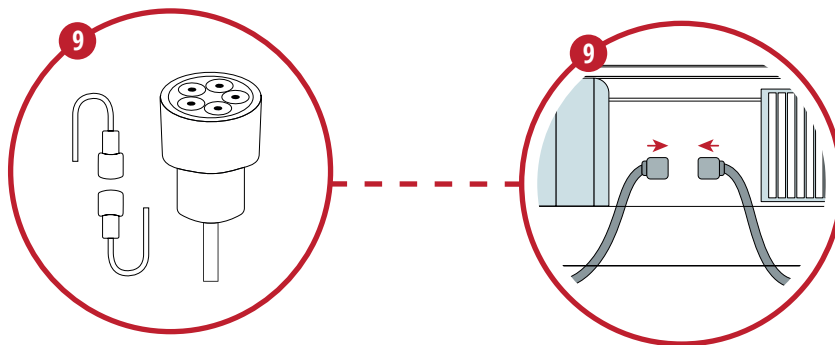

### STEP 9

CONNECT THE CONTROL BOX TO THE MOTOR.

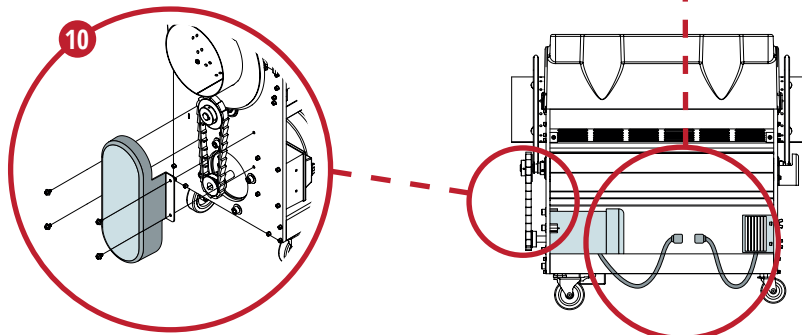

### STEP 10

RE-INSTALL BELT COVER.

5/32" T-HANDLE ALLEN WRENCH.

# ASSEMBLY - ORIGINAL DRILL TEMPLATE

\* Template made to scale.

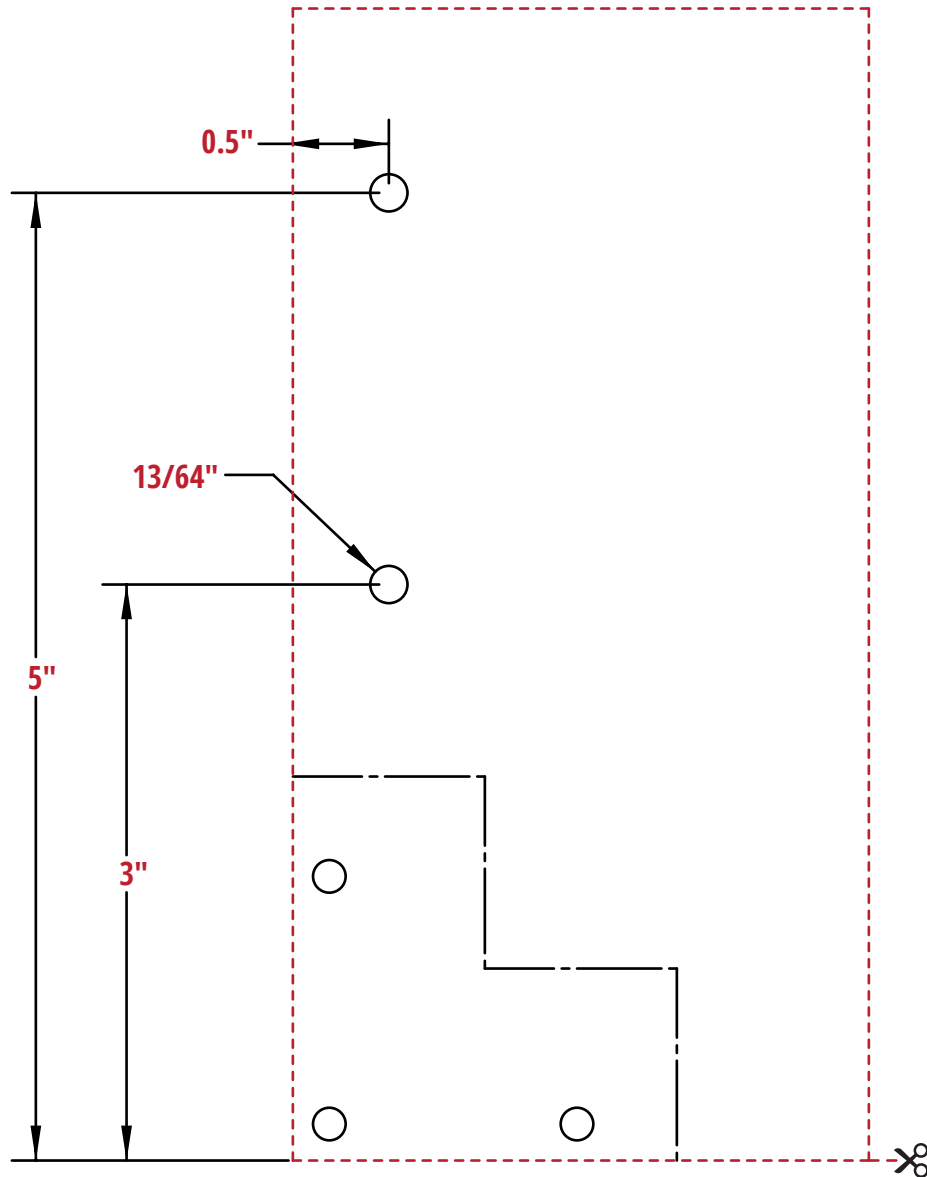

\* ONLY CUT  
ALONG RED  
DOTTED LINE.

TOOLS REQUIRED

SIZE	TOOL ITEM
	Drill
13/64"	Drill Bit (Included)
5/32"	T-Handle Allen Wrench
5/16"	T-Handle Allen Wrench

LEARN  
HOW NOW

