

USER MANUAL

Hooga Red Light Therapy Helmet
Model: HG-Helmet



PRODUCT DESCRIPTION

The Hooga helmet is composed of 26 3R class laser diodes (wavelength 650-660nm, power <5mW) and 30 red light emitting diodes (LED wavelength 640-660nm). The helmet system is designed to automatically pause if the user's head is moved outside of the zone of radiation and will resume therapy when the correct head position is reestablished. This is achieved through the use of sensors. At the end of the therapy cycle, the system signals that the therapy is complete and the helmet is ready to be powered down by emitting an audible beep.

CONTRAINDICATIONS

The Hooga Helmet is contraindicated in the following situations:

- Do not use the device if you have a medical condition that makes your skin sensitive to sun or light or if you are taking photosensitizing medications.

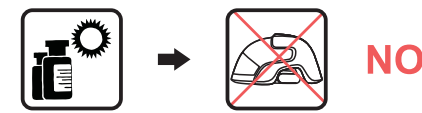

- Do not use the device if you have cancer on your scalp.



- Do not use the device if you have sensitive skin or if you are allergic to this specific wavelength of light (650+10nm). Sensitive skin or an allergic reaction can result in an itchy sensation of the scalp or sunburn like redness. If these occur, seek medical care from a physician.



- The device should be used by or on children under 18 years of age.

WARNINGS AND PRECAUTIONS

- Do not look directly at or use optical instruments like magnifiers or microscopes to look at the laser light or its reflection off of a mirror like surface.
- Discontinue use of the device if scalp itching or tingling occurs.
- Do not get the device or adapter wet.
- Do not place the device or adapter where it can fall or be pulled into a body of water like a sink or a tub.
- If the unit is dropped into water or other liquids, unplug the device from the power outlet immediately.

- Never use the device while sitting in the bathtub or swimming pool.
- Always keep the cord away from hot or heated surfaces such as radiators, stoves, ovens, etc.
- Do not use the device when your hair is wet from showering, swimming, or bathing.
- Use only the power adapter provided with the device.
- Do not operate the device if it has a damaged cord, plug, or helmet.
- Keep the device out of reach of children and pets.
- Always unplug the device from the power outlet prior to cleaning the device.
- Never attempt to repair the device on your own. Contact Hooga.
- Avoid dropping the device as this may cause the device to malfunction and become damaged. If you drop the device or suspect malfunction, contact Hooga.

INTRODUCTION

The various Hooga Helmet Hair Growth Device components are shown below:

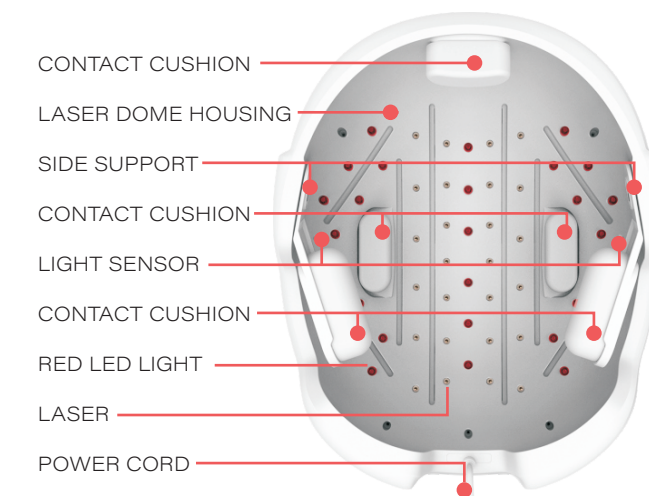

HOW TO USE

Preparation: Remove the helmet from the packaging.

Step 1: Position the device on your head in a comfortable position.

Step 2: Power On

Plug the interface end of the power adapter into the interface of the remote controller of the helmet, then plug the power adapter into an electrical outlet. A "beep" sound indicates that the device has been successfully powered.

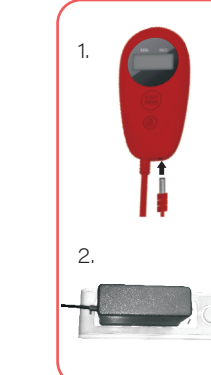
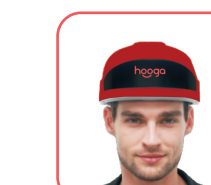

Step 3: Turn On

Hold the "ON/OFF" button for 3 seconds to start the device. The device must be placed on your head at this time, or it will not turn on due to the safety sensors.



Step 4: Use the Device

Press the "START/PAUSE" button to begin treatment and start a 25 minute timer. A "beep" sound indicates the session has started. Once the session is completed, the device will turn off automatically after another "beep" sound. NOTE: Once the device is initially turned on, the START/PAUSE button must be pressed within one minute or the device will turn off.



Step 5: Pausing the Device

If you need to pause the session at any time, press the "START/PAUSE" button and the timer will flash. The device will pause. Press the START/PAUSE button again to resume the session. A "beep" sound will indicate the session has resumed. If the START/PAUSE button is not pressed within 5 minutes during a pause, the device will turn off automatically.



Step 6: Turn Off

- After using for 25 minutes, the device will "beep" and then turn off automatically.
- After the device is powered on, if the "START/PAUSE" button is not pressed after more than one minute, the device will turn off automatically.
- To turn off the device, hold the "ON/OFF" button for three seconds.
- Take off the helmet and place it on a horizontal, flat surface so that the inner surface is facing downward to protect the LEDs and lasers.
- Unplug the power adapter from the electrical power outlet.

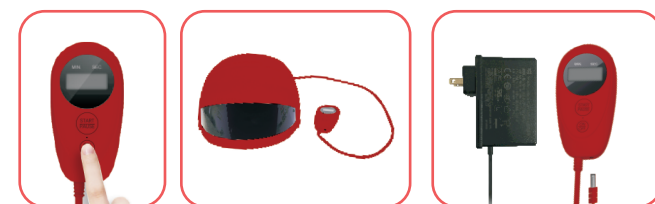

TREATMENT RECOMMENDATIONS

It is recommended that you use the hair growth helmet for 25 minutes every other day for 16 weeks. After 16 weeks you may wish to continue using the device for 25 minutes every other day according to your own hair growth results.



CLEANING INSTRUCTIONS

The device should be unplugged prior to any cleaning. First wipe the helmet surfaces with a clean cloth dampened with water. Inspect the surfaces thoroughly for any remaining visible dirt or contaminants and repeat wiping if necessary until clean. Allow time to air dry. Then, wipe the helmet surfaces with a clean cloth dampened with 70% isopropyl alcohol. Allow contact time of 1 minute and then allow for time to dry. Do not use the device until it is completely dry.

STORAGE INSTRUCTIONS

Keep the device away from direct sunlight and store the device in a cool, dry place.

TROUBLESHOOTING

My device is powered on but pressing the "START/PAUSE" button does not start the treatment.

The lasers and lights will not power on unless the electronic sensor detects that the device is correctly positioned on the user's head. This is a built-in safety feature to protect the eyes from inadvertent direct laser light exposure.

Device is not powering on.

- Check if the socket is loose.
- Check if the power cord has good contact with the remote control.

PRODUCT SPECIFICATIONS

Model:	HG-Helmet
Number of Laser Diodes:	26
Laser Wavelength:	650-660nm
Laser Power Classification:	<5mW per light output, Laser Class 3R
Number of LEDs:	30
Red LED Wavelength:	640-660nm
Laser & LED Mode:	Continuous Light
Electrical Input:	AC100-240V 50/60Hz
Dimensions:	9.8" x 8.1" x 5.2"
Net Weight:	22 ounces

WHAT'S INCLUDED

HG-Helmet Device x 1
Power Adapter x 1
Controller x 1
User Manual x 1



WARRANTY

Hooga warrants that the helmet will function and perform within the specifications for two (2) years after the date of delivery. The 2 year warranty will cover all parts and labor during the warranty period with some exclusions. If required, the buyer is responsible for return shipping to Hooga within the 2 year warranty period. The warranty shall not apply to any device that has been abused, misused, modified, damaged, or fitted with substitute parts other than parts manufactured by Hooga. Hooga shall not be liable for any consequential loss or inconvenience caused by any failure of a Hooga product. After the warranty has concluded, the buyer is required to pay for all parts and labor charges. If the device is re-paired or replaced, either within or outside the warranty period, Hooga reserves the right to provide parts or replacement in different colors than the original device. To obtain warranty service, please email contact@hoogahealth.com.

CUSTOMER SERVICE

Hooga is committed to your well-being by providing you with efficient, effective, and affordable light therapy devices. If at any time you are having trouble with your light therapy device, or you have any questions or concerns about the device, please do not hesitate to contact us at contact@hoogahealth.com and we will be more than happy to answer any questions you may have.

Electromagnetic compatibility complies with IEC 60601-1-2 Standard

BF Symbol, which indicates this device is in accordance to the degree of protecting against electric shock for type BF equipment.

Dispose of the device in accordance with the directive 2002/96/EC-WEEE (Waste Electrical and Electronic Equipment).

LASER WARNING LABEL



hooga