



EVERPURE® QL1-, QL2-, QL3-, QL3B-BH² WATER FILTERS

The Everpure BH² Water Filters reduce chlorine tastes and odors and other substances that produce off-tastes and odors in coffee. The BH² also reduces dirt and rust, and reduces the formation of limescale* which builds up on the brewer heating elements and in the reservoir.

INSTALLATION

The following instructions provide for installation of a QL1-, QL2-, QL3-, QL3B-BH² Filter regardless of whether or not the brewer is already installed. The label on the BH² Cartridge illustrates and explains the procedure for cartridge insertion and removal into the filter head. The filter cartridge should be placed into the head after the system has been installed.

1. Install the filter as close to the brewer as possible. Do not connect this filter to any other equipment. Connect only to the cold water line and do not expose it to high temperatures.
2. Select a location for the filter, nominally 4 x 4 x 18 inches (10 x 10 x 45.7 cm) long, including a 2.5-inch (6.3 cm) drop-down for cartridge changes. Write the installation date and anticipated cartridge replacement date in the space provided on the cartridge label. The cartridge should be replaced every 12 months or after 6,000 pots (3,000 gallons, 11,356 L) have been brewed, whichever occurs first.
3. If required, shut off the incoming water supply and relieve pressure in the tubing. Cut the tubing, allowing a 4-inch (10 cm) space for the filter installation between the water supply and the brewer water inlet.
4. Install appropriate fittings into each port of the head. Use a good grade of pipe dope or plumber tape on the body threads. Do not overtighten the fittings.
5. Position the head assembly so that the arrow shown on top of the head corresponds to the direction of water flow and attach the incoming cold water supply to the inlet of the head.
6. Connect the filter outlet to the brewer water inlet line. Use compression or flare fittings to make water connections to the brewer.
7. Mount the head to the wall using the screws and star washers provided.
8. Install the cartridge into the head following the instructions on the cartridge label.
9. Turn on the water and check for leaks.

NOTE: The cartridge must be flushed before use by running water through it at maximum flow for three minutes to purge the cartridge of air.

Rated Service Flow: 0.5 gpm (1.9 Lpm)

Temperature: 35-100°F, (2-38°C).

Min./Max. Line Pressure: 10-125 psi (0.7-8.6 bar), non-shock.

Capacity of a Single Unit: 3,000 gallons (11,360 liters).

For cold water use only.

This water filtration system must be maintained in accordance with the manufacturer's instructions, including the timely replacement of filter cartridges.

This product is intended for commercial use only. Home or similar consumer use VOIDS THE WARRANTY.

Check for compliance with state and local laws and regulations. Do not use with water that is microbiologically unsafe or of unknown quality without adequate disinfection before or after the system. Systems certified for cyst reduction may be used on disinfected water that may contain filterable cysts.

The term 'bacteriostatic' indicates that the system limits the passage or growth of bacteria that may already exist in the incoming water. It does not mean that the water leaving the system is safer to drink than the water entering the system.

REPLACEMENT PARTS

Contact your local Pentair® Everpure® dealer for filter cartridges or system replacement parts.

Key Letter	Description	Part Number
A	QL3 Head Assembly	EV3076-37
B	BH ² Filter Cartridge	EV9612-00
C	Mounting Screw	EV3061-96
D	Star Washer	EV3055-34
F	Bracket Screw	EV3062-03



Systems Tested and Certified by NSF International against NSF/ANSI Standards 42 and 53 for the reduction of:

Standard No. 42 — Aesthetic Effects **Standard No. 53 — Health Effects**

Bacteriostatic Effects

Mechanical Filtration

Chemical Reduction

Cyst

Taste and Odor

Chlorine

Mechanical Filtration

Nominal Particulate Class I

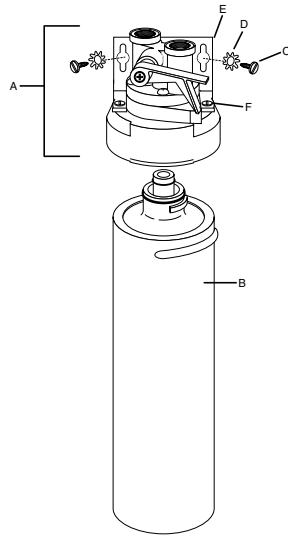

LIMITED WARRANTY

COMMERCIAL WATER TREATMENT EQUIPMENT

You have just purchased one of the finest water treatment units made. As an expression of confidence in this product, Pentair Filtration Solutions, LLC ("PFS") offers the following product warranty. This product is warranted against material defects in materials and workmanship to the original end-user when installed in accordance with the PFS specifications. The warranty period commences on the date of purchase and is administered as follows:

For a period of ONE YEAR

Replaceable elements (i.e., filter & water treatment cartridges)*

For a period of FIVE YEARS

The entire system (excluding replaceable elements)

The unit must be used in operating conditions that conform to PFS's recommended guidelines. This warranty will not apply if the unit has been modified, repaired or altered by someone not authorized by PFS.

If a part described above is found to have a material defect in materials or workmanship within the specified warranty period, you should notify Pentair® Everpure technical service at the phone number listed below. Any part found materially defective within the terms of this warranty will be repaired or replaced [at PFS's discretion] by your local dealer or Pentair Everpure technical service. You pay only freight from our factory and local dealer charges. Any item repaired or replaced pursuant to this warranty will be covered under the original warranty terms of the system.

PFS is not responsible for damage caused by accident, fire, flood, freezing, Act of God, misuse, misapplication, neglect, oxidizing agents (such as chlorine, ozone, chloramines and other related components), alteration, installation or operation contrary to our printed instructions, or by the use of accessories or components which do not meet PFS's specifications. Refer to the specifications section in the Installation and Operating manual for approved application parameters.

Our product performance specifications are furnished with each water treatment unit. TO THE EXTENT PERMITTED BY LAW, EVERPURE DISCLAIMS ALL IMPLIED WARRANTIES, INCLUDING WITHOUT LIMITATION WARRANTIES OF MERCHANTABILITY AND FITNESS FOR PARTICULAR PURPOSE; TO THE EXTENT REQUIRED BY LAW, ANY SUCH IMPLIED WARRANTIES ARE LIMITED IN DURATION TO THE PERIOD SPECIFIED ABOVE FOR THE ENTIRE WATER TREATMENT UNIT.

As a manufacturer, we do not know the characteristics of your water supply or the purpose for which you are purchasing this product. The quality of water supplies may vary seasonally or over a period of time, and your water usage rate may vary as well. Water characteristics can also differ considerably if this product is moved to a new location. For these reasons, we assume no liability for the determination of the proper equipment necessary to meet your requirements, and we do not authorize others to assume such obligations for us. Further, we assume no liability and extend no warranties, express or implied, for the use of this product with a non-potable water source or a water source which does not meet the conditions for use described in the owner's guide or performance data sheet for this product.

OUR OBLIGATIONS UNDER THIS WARRANTY ARE LIMITED TO THE REPAIR OR REPLACEMENT (AT PFS'S DISCRETION) OF THE FAILED PARTS OF THE WATER TREATMENT UNIT, AND WE ASSUME NO LIABILITY WHATSOEVER FOR DIRECT, INDIRECT, INCIDENTAL, CONSEQUENTIAL, SPECIAL, GENERAL OR OTHER DAMAGES.

Some states do not allow the exclusion of implied warranties or limitations on how long an implied warranty lasts, so the above limitation may not apply to you. Similarly, some states do not allow the exclusion of incidental or consequential damages, so the above limitation or exclusion may not apply to you. This warranty gives you specific legal rights, and you may also have other rights which vary from state to state.

*Warranty applies to material defects in materials & workmanship only.



EPA Est. No. 002623-IL-002

FILTRATION & PROCESSING SOLUTIONS

EVERPURE-SHURFLO WORLD HEADQUARTERS, 1040 MUIRFIELD DRIVE, HANOVER PARK, IL 60133 USA • WWW.EVERPURE.COM
800.942.1153 MAIN (US ONLY) • 800.942.1153 (US ONLY) • 630.307.3000 MAIN • 630.307.3030 FAX • CSEVERPURE@PENTAIR.COM EMAIL

PENTAIR AUSTRALIA/NEW ZEALAND, 1-21 MONASH DRIVE, DANDENONG SOUTH, VIC 3175, AUSTRALIA
1300.576.190 TEL • AU.EVERPURE@PENTAIR.COM EMAIL

EVERPURE-SHURFLO CHINA, 21F CLOUD 9 PLAZA, NO 1118, SHANGHAI, 200052, CHINA
86.21.3211.4588 TEL • 86.21.3211.4580 FAX • CHINA.WATER@PENTAIR.COM EMAIL

EVERPURE-SHURFLO INDIA, GREEN BOULEVARD, B-9/A, 7TH FLOOR - TOWER B SECTOR 62, NOIDA - 201301
91.120.419.9444 TEL • 91.120.419.9400 FAX • INDIACUSTOMER@PENTAIR.COM EMAIL

EVERPURE-SHURFLO EUROPE, PENTAIR WATER BELGIUM BVBA, INDUSTRIEPARK WOLFSTEE, TOEKOMSTLAAN, 30 B-2200 HERENTALS, BELGIUM
+32.(0).14.283.500 TEL • +32.(0).14.283.505 FAX • SALES@EVERPURE-EUROPE.COM EMAIL

EVERPURE-SHURFLO JAPAN INC., HASHIMOTO MN BLDG. 7F, 3-25-1 HASHIMOTO, MIDORI-KU, SAGAMIHARA-SHI KANAGAWA 252-0143, JAPAN
81.(0)42.775.3011 TEL • 81.(0)42.775.3015 FAX • INFO@EVERPURE.CO.JP EMAIL

EVERPURE-SHURFLO SOUTHEAST ASIA, 390 HAVELOCK ROAD, #04-01, KING'S CENTRE, SINGAPORE 169662
65.6795.2213 TEL • FAX: 65.6795.2219 FAX • CSEVERPURE@PENTAIR.COM EMAIL

All Pentair trademarks and logos are owned by Pentair, Inc. or its affiliates. All other registered and unregistered trademarks and logos are the property of their respective owners. Because we are continuously improving our products and services, Pentair reserves the right to change specifications without prior notice. Pentair is an equal opportunity employer.

© 2014 Pentair Filtration Solutions, LLC. All Rights Reserved.

EV3956-00 Rev N MY14