



Stainless Steel Pumps

Model OPTIMA

Domestic Submersible Sump Pumps

Optima MA
Automatic pump
with Float Switch

With
Mechanical
Seal



Specifications

Submersible pump with semi open impeller
Maximum solids handling 10 mm
Maximum liquid temperature: 50°C
Maximum submergence: 5m

Materials

Pump casing: 304 Stainless Steel
Impeller: Thermo plastic (PPE + glass fibre)
Outer casing: 304 Stainless Steel
Shaft : 303 Stainless Steel
Motor frame: 304 Stainless Steel
Motor Cap: Polypropylene
Fasteners: 304 Stainless Steel
Seal: Carbon/Ceramic Mechanical Seal
in oil lubricated chamber,
Upper Lip Seal

Motor Data

Air filled, dry submersible, 2 pole motor
Insulation class F
IP68 protection
50 Hz, 1 phase, 240 Volt
In built overload protection

Cable

5 m of cable (with plug)

Range

32mm discharge
0.25 kW motor
Single phase, automatic or manual versions
Magnetic Switch version available

Domestic sump pump manufactured in stainless steel and thermo plastics with a mechanical seal. Suitable for many dewatering usages, including:- draining wells, basements, cellars, etc. emptying of tanks & drums general transfer of clean water.

Performance Curve

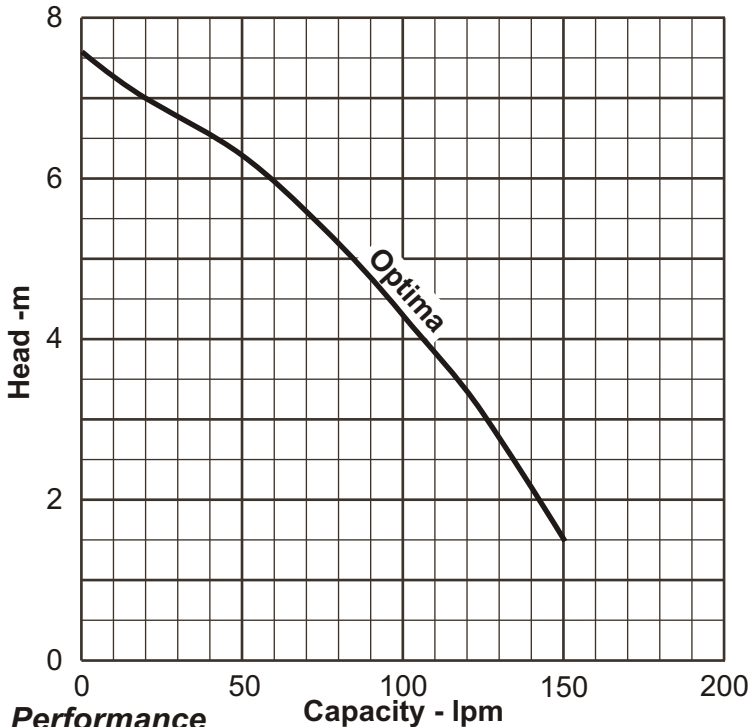

Performance Table

Pump Model	Motor Output	Discharge Ø mm	Power Supply	Full Load Current	Capacitor (1Phase models only)	Q= Capacity - litres/min						
						0	20	50	75	100	125	150
Optima	0.25 kW	32 mm	240V, 50Hz, 1Ph	1.9 A	8µF	H=Total Head - metres (m)						
						7.6	7.0	6.3	5.4	4.3	3.1	1.5

Options



Optima MS
Automatic pump
with Magnetic Switch



Optima M
Manual
Pump



Low level
suction "skirt"
(down to 3mm)



(for manual model)

Sectional Drawing

Model **OPTIMA**

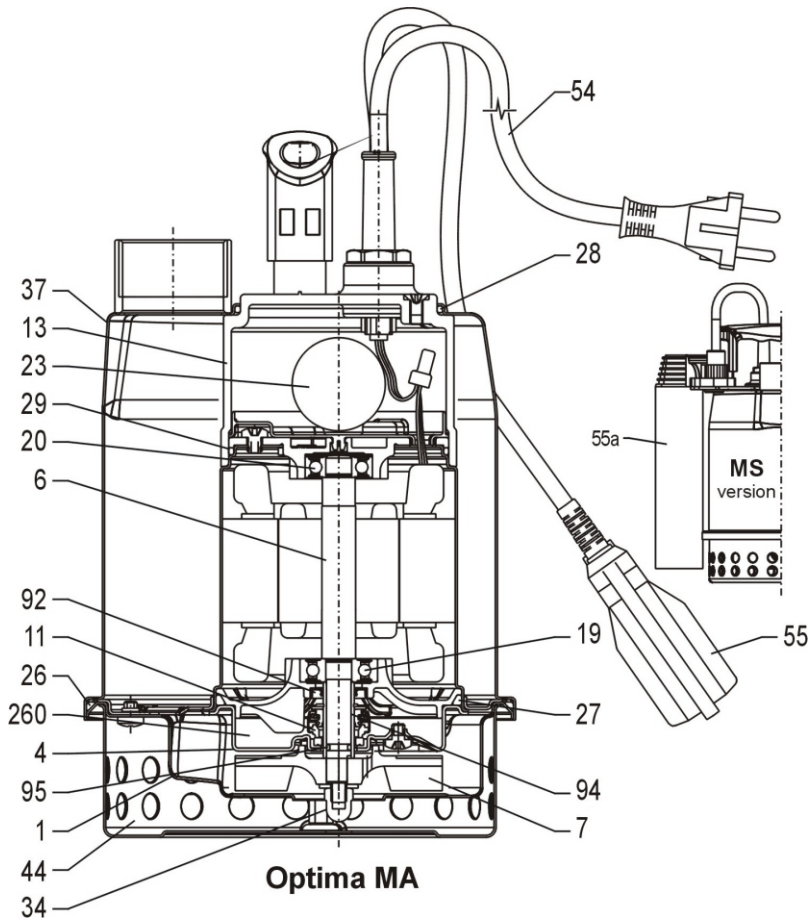

Item Number	Description	Material	Quantity per unit
1	Casing	AISI 304 Stainless Steel	1
4	Casing Cover	AISI 304 Stainless Steel	1
6	Shaft with rotor #	AISI 303 Stainless Steel	1
7	Impeller	Glass reinforced PPE	1
11	Mechanical Seal	Carbon/Ceramic/NBR	1
13	Motor Cover	PP Polypropylene	1
19	Lower Bearing	Sealed Ball Bearing	1
20	Upper Bearing	Sealed Ball Bearing	1
23	Capacitor		1
26	O' Ring	NBR Rubber	1
27	O' Ring	NBR Rubber	1
28	O' Ring	NBR Rubber	1
29	O' Ring	NBR Rubber	1
34	Impeller Nut	AISI 303 Stainless Steel	1
37	Outer Casing	AISI 304 Stainless Steel	1
44	Strainer	AISI 304 Stainless Steel	1
54	Submersible Power Cable		1
55	Float Switch (for MA version only)		1
55a	Float Switch (for MS version only)		1
92	Lip Seal	NBR Rubber	1
94	Shaft Sleeve	Ceramic coated 303 SS	1
95	O' Ring	NBR Rubber	1
260	Oil	Esso MARCOL 172	40cc

refers to pump side of shaft material

Dimensions

Model **OPTIMA**

Units: mm unless otherwise specified

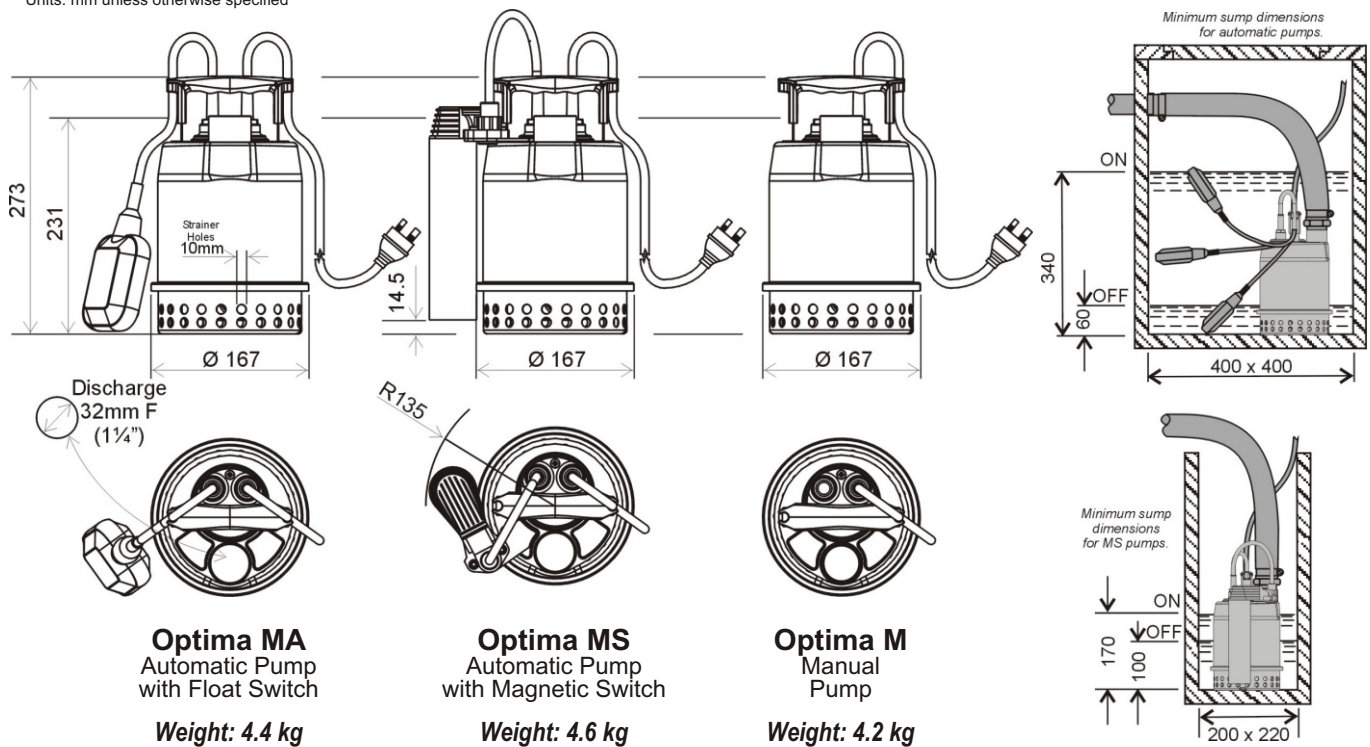

Specifications subject to change without notice



EBARA PUMPS Australia Pty. Ltd

Data Sheet

Optima 07-01