

DSPK

1 & 3 PHASE CUTTER

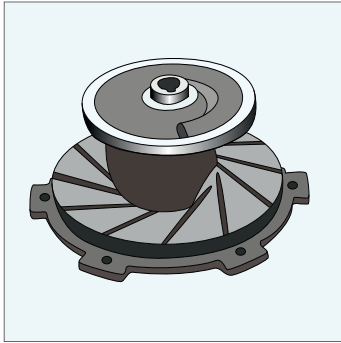

The **DSPK** range of cutter pumps are for sewage where destructible solids need to be reduced and pumped over a short or medium distance. The impeller rotates against a serrated suction cover to cut solids before pumping. Supplied as standard free-standing, an optional auto coupling set is available for guide rail mounting. (see page 84). Single-phase models are available with or without a float switch.

Fluid: Sewage | Water with suspended material | Temperature: 0 - 40°C

Application: Industry | Domestic | Pumping stations | Sewage treatment | Food processing

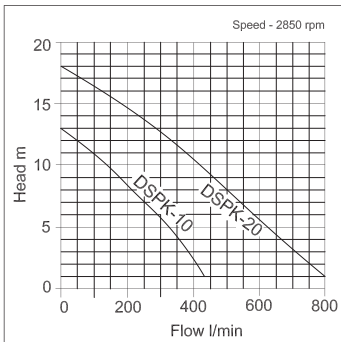
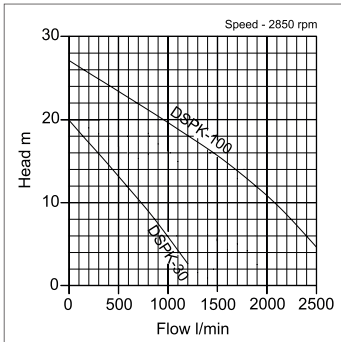

DSPK	Impeller	Shaft seal	Level switch (automatic)	
	Single channel	Double mechanical	Pendant float (optional)	

Pump	Handle (DSPK10)	Handle	Outlet (DSPK10 - 20)	Outlet flange (DSPK10)
	S/S 304 & rubber	Steel	Polypropylene	Grey cast iron
	Pump casing & elbow	Impeller	Shaft seal	Lubrication
	Grey cast iron	Grey cast iron & tungsten	Carbon ceramic	Oil
	Shaft	Suction cover & stand	Level switch	
	S/S 410	Grey cast iron	Polypropylene	

Motor	Poles, protection	Insulation	Thermal protection	Starting 1ph/3ph
	2 pole, IP68	Class B	Integral	Capacitor/D.O.L.
	Motor frame	Head cover	Power cable (10mtr) & switch cable	
	S/S 304	Grey cast iron	Rubber	



DSPK-10A



DSPK-20

item code	model	Manual or Auto	outlet (mm/BSPF)	kW	volt	flow (l/min)	head (mtrs)	free passage (mm)	w x l x h (mm) *inc elbow	dry weight (kgs)	optional item 1 (auto-coupling)
15-10-1098	DSPK-10	M	50	0.75	110	430	13	20	183x250x487	21.0	TOS-SGH
15-10-1104	DSPK-10	M	50	0.75	230	430	13	20	183x250x487	21.0	TOS-SGH
15-10-1085	DSPK-10A	A	50	0.75	230	430	13	20	183x250x487	21.3	TOS-SGH
15-10-1063	DSPK-20	M	75	1.5	230	800	18	40	240x400x545	39.1	TOS-L3 & TOS-L4
15-10-1067	DSPK-20	M	75	1.5	400	800	18	40	240x400x545	39.1	TOS-L3 & TOS-L4
15-10-1029	DSPK-20A	A	75	1.5	230	800	18	40	240x400x546	39.6	TOS-L3 & TOS-L4
15-10-1015	DSPK-30	M	4"	2.2	400	1200	20	40	220x430x625	58.0	TOS-L3 & TOS-L4
15-10-1053	DSPK-100	M	4"	7.5	400	2500	27	65	300x505x815	117.0	TOS-X4