

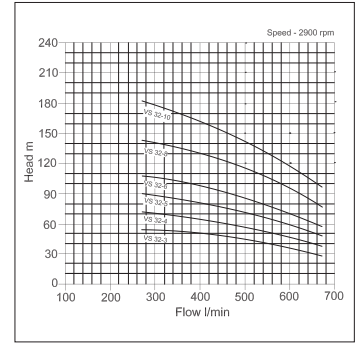

VS 32

VERTICAL MULTI-STAGE

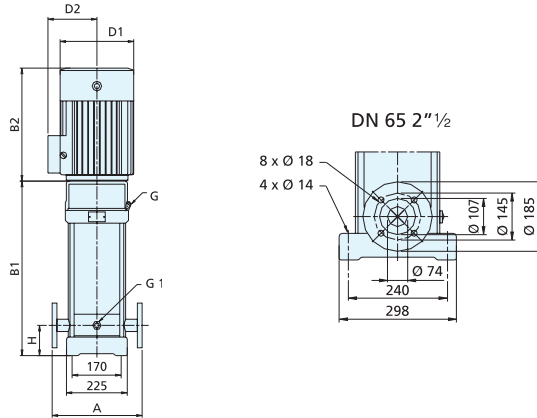

item code	model	flange/BSP	kW	volt	flow (l/min)	head (mtrs)	A	H	B1	B2	B1 + B2	D1	D2	weight (kgs)
19-15-1277	VS32-3	DN65/2½"	5.5	400	666	54	320	105	645	430	1075	260	208	140
19-15-1090	VS32-4	DN65/2½"	7.5	400	666	72	320	105	715	430	1145	260	208	150
19-15-1121	VS32-5	DN65/2½"	11	400	666	90	320	105	890	490	1380	330	255	220
19-15-1131	VS32-6	DN65/2½"	11	400	666	108	320	105	960	490	1450	330	255	230
19-15-1197	VS32-8	DN65/2½"	15	400	666	144	320	105	1100	490	1590	330	255	258
19-15-1236	VS32-10	DN65/2½"	18.5	400	666	182	320	105	1240	550	1790	330	255	290

PREMIUM EFFICIENCY MOTORS (IE3) AVAILABLE FOR ALL 400v MODELS (P.O.A.)

VS 42

VERTICAL MULTI-STAGE

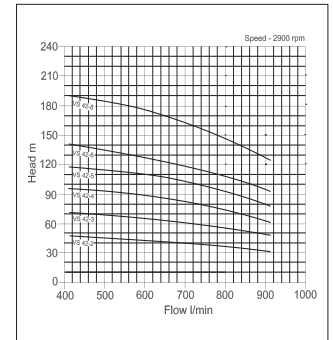
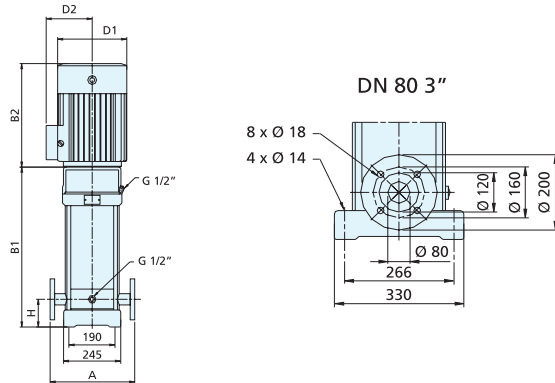

item code	model	flange/BSP	kW	volt	flow (l/min)	head (mtrs)	A	H	B1	B2	B1 + B2	D1	D2	weight (kgs)
19-15-1072	VS42-2	DN80/3"	7.5	400	916	48	365	140	641	430	1071	260	208	130
19-15-1239	VS42-3	DN80/3"	11	400	916	71	365	140	826	490	1316	330	255	205
19-15-1225	VS42-4	DN80/3"	15	400	916	95	365	140	906	490	1396	330	255	215
19-15-1005	VS42-5	DN80/3"	18.5	400	916	119	365	140	986	550	1536	330	255	235
19-15-1130	VS42-6	DN80/3"	22	400	916	143	365	140	1066	590	1656	360	285	274
19-15-1199	VS42-8	DN80/3"	30	400	916	190	365	140	1226	660	1886	400	310	340

PREMIUM EFFICIENCY MOTORS (IE3) AVAILABLE FOR ALL 400v MODELS (P.O.A.)