

CX 80

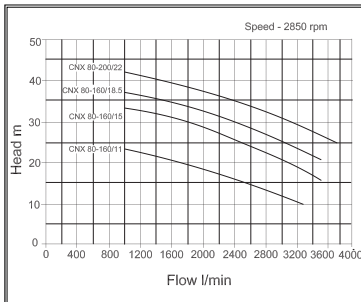

STAINLESS STEEL ENBLOC

- Industry
- Agriculture
- Processing
- Hot water
- Transfer
- Circulation



CX80 series

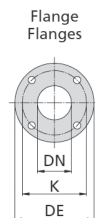
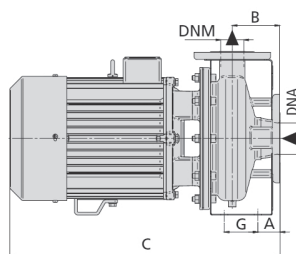
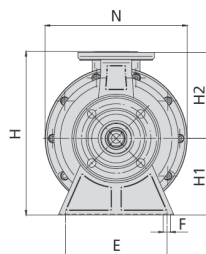

DIMENSIONS mm				
DN	DE	K	Holes	
			n°	Ø
80	200	160	8	18
100	225	180	8	18

item code	model (3PH 230V-400V)	output (kW)	flow (l/min)	head (mtrs)	DNM	DNA	A	B	C	E	F	G	H	H1	H2	N	weight (kgs)	price (£)	code
19-15-1196	CX80-160/11	11.0	3250	26	80	100	78	125	743	250	15	95	430	180	225	333	105	2,050.00	1
19-15-1128	CX80-160/15	15.0	3500	34	80	100	78	125	743	250	15	95	430	180	225	333	114	2,135.00	1
19-15-1081	CX80-160/18.5	18.5	3500	37	80	100	78	125	790	250	15	95	430	180	225	333	126	2,284.00	1
19-15-1069	CX80-200/22	22.5	3750	41	80	100	78	125	830	280	15	95	445	180	250	360	188	2,974.00	1