

LH690-50

Kontroll-Nr. --

2019-02-2C V.01.02.2019

Pos.no	Item no.	Description	Quant.	UP
1	011-101-19	Dichtungs-Oring-Satz	1	Price on req.
2	095-100-18	Shackle 6mm SS	2	Price on req.
3	010-103-21	Chain d5(9-Link) SS	2	Price on req.
4	140-074-15	Cable Clip No.4 SPC	4	Price on req.
5	141-006-19	Hex.Bolt M10x20 SUS304	6	Price on req.
7	009-116-10	Hex.Nut M10 SUS304 (EN X5CrNi18-10)	6	Price on req.
8	009-113-17	Terminal R-2-4 CU	3	Price on req.
9	009-168-17	Terminal R-38-10 CU	6	Price on req.
10	010-129-10	Terminal R-22-S6 CU	2	Price on req.
11	140-056-53	Cable Clip Rubber 115x100x4t NBR	2	Price on req.
12	141-005-47	Hex.Bolt M8x30 SUS304 (EN X5Cr18-10)	8	Price on req.
13	003-106-19	Hex.Nut M8(B=12) SUS304 (EN X5CrNi18-10) Stainless Steel	8	Price on req.
14	004-000-32	Gland No.5 FC	2	Price on req.
15	006-103-28	Cable Bush 58X33.5X26.5L NBR	2	Price on req.
16	140-078-19	Stuffing Box No.5 FC	2	Price on req.
17	142-164-19	Hex.Bolt M10x30 SUS304	8	Price on req.
18	122-264-18	Spring Washer M10 SUS304	8	Price on req.
19	E01-TEG-39	O-Ring 140xd3.5 NBR	2	Price on req.
19	001-007-93	Cabtyre cable set (20m) NSSHÖU3x35+3x16/3E+3x2.5ST	1	Price on req.
20	E01-TEG-39	Cabtyre Cable Set (20m) 380/400/415V-50Hz(EUR) NSSHÖU 4Cx35mm2 No.5	1	Price on req.
20	001-007-94	Cabtyre cable set (20m) NSSHÖU3x35+3x16/3E+3x2.5ST	1	Price on req.
21	008-105-13	Cabtyre Cable Set (20m) 380/400/415V-50Hz(EUR) NSSHÖU Multi-core7Cx35mm2 No.5	1	Price on req.
22	003-149-14	Mould Cover No.3 NBR	2	Price on req.
23	142-162-17	Gland (Lower) No.5 FC	2	Price on req.
24	140-033-12	Spring Washer M6 SUS304 (EN X5Cr18-10)	8	Price on req.
25	141-004-46	Hex.Bolt M6x16 SUS304 (EN X5CrNi18-10) Stainless Steel	8	Price on req.
26	009-108-19	Hex.Nut M6 BSBM	6	Price on req.
27	009-108-19	Terminal R-38-6 CU	6	Price on req.
28	140-029-31	Terminal R-38-6 CU	6	Price on req.
29	002-115-18	Hex.Bolt M6x10 BSBM	6	Price on req.
30	002-116-19	Heat Shrink Tube (Sold per meter) EVA(d16.5x1t) (Vm)	1	Price on req.
31	009-168-17	Heat Shrink Tube (Sold per meter) A4(d20x0.35t) (Vm)	1	Price on req.
32	002-000-20	Terminal R-22-S6 CU	2	Price on req.
33	009-114-18	Earth tube	2	Price on req.
34	009-115-19	Connector PC-4020M	2	Price on req.
35	009-115-19	Connector PC-4020F	1	Price on req.
36	009-114-18	Connector PC-4020F	2	Price on req.
37	002-128-14	Connector PC-4020M	1	Price on req.
38	002-164-12	Heat Shrink Tube (Sold per meter) EVA(d10x1t) (Vm)	1	Price on req.
39	143-000-58	Heat Shrink Tube (Sold per meter)A4(d13x0.3t)(JPY /m)	1	Price on req.
40	009-168-17	Pan Screw (w/Spring Washer/Plain Washer) M6x12 SWRM	2	Price on req.
41	009-001-23	Terminal R-22-S6 CU	4	Price on req.
42	140-033-12	Earth Terminal	2	Price on req.
43	142-162-17	Hex.Bolt M6x16 SUS304 (EN X5CrNi18-10) Stainless Steel	3	Price on req.
44	016-138-10	Spring Washer M6 SUS304 (EN X5Cr18-10)	3	Price on req.
45	127-000-20	Protection BushLH-90/110KW(6) SBR	1	Price on req.
46	140-125-12	Stay LH690/8110 SS	1	Price on req.
47	142-166-11	Hex.Bolt M16x45 SUS304	2	Price on req.
48	142-130-16	Spring Washer M16 SUS304	2	Price on req.
49	142-000-29	Plain Washer M16 SUS304 (EN X5Cr18-10)	2	Price on req.
50	142-165-10	Washer 0.8/1.2/2.3 SS	1	Price on req.
51	140-099-16	Spring Washer M12 SUS304	2	Price on req.
52	140-099-16	Hex.Bolt M12x40 SUS304	2	Price on req.
53	142-165-10	Hex.Bolt M12x40 SUS304	10	Price on req.
54	037-000-56	Spring Washer M12 SUS304	10	Price on req.
55	121-145-19	Flanged Discharge Pipe150mm(GH-370H) FCD	1	Price on req.
56	140-033-12	Packing GH-370 NBR	1	Price on req.
57	214-010-15	Hex.Bolt M6x16 SUS304 (EN X5CrNi18-10) Stainless Steel	2	Price on req.
58	121-517-16	Blind Cover LH890/8110 SS	1	Price on req.
59	148-003-17	Packing 38mm2x2t SBR	1	Price on req.
60	016-137-19	Grease NippleA-PT1/4C3604	1	Price on req.
61	072-129-12	Protection BushLH-90/110KW(3) SBR	1	Price on req.
62	035-102-30	Eye BoltM42SF	2	Price on req.
63	122-259-10	Oil Plug M12x16(B=21) SUS304	1	Price on req.
64	140-135-15	O-Ring 12xd3 NBR	1	Price on req.
65	142-166-11	Hex.Bolt M16x100 EN X5CrNi18-10	8	Price on req.
66	121-457-17	Spring Washer M16 SUS304	8	Price on req.
67	050-429-17	Seal Packing d16xd27x4t NBR	8	Price on req.
68	146-034-11	Motor Bracket FC	1	Price on req.
69	052-148-15	Retaining RingC60 SK5	1	Price on req.
70	061-176-10	BearingNU-312A	1	Price on req.
71	026-273-19	Bearing Collard79xd129x1.2t SS	1	Price on req.
72	113-103-10	Oil SealSC-8010513 NBR	1	Price on req.
73	142-163-34	Greese Pan Gray Iron CastinLH110KW FC	1	Price on req.
74	140-055-49	Spring Washer M8 SWRH	4	Price on req.
75	122-000-22	Hex.Bolt M8x25 SWRM	4	Price on req.
76	065-360-15	O-Ring V-530(524.5xd10) NBR	1	Price on req.
77	122-000-22	Outer Cover SS	1	Price on req.
78	055-728-14	O-Ring V-530(524.5xd10) NBR	1	Price on req.
79	147-005-16	Rotor	1	Price on req.
80	053-306-16	Impeller Key 12x8x40 Stainless Steel	1	Price on req.
81	056-	Motor Protector 9700K-01-215 (H)	3	Price on req.
		Stator	1	Price on req.

LH690-50

Kontroll-Nr. --

2019-02-2C V.01.02.2019

Pos.no	Item no.	Description	Quant.	UP
82	122-256-17	O-Ring 390xd5.7 NBR	1	Price on req.
83	064-499-11	Motor Frame FC	1	Price on req.
84	140-132-12	Hex.Bolt M16x80 SUS304 (EN X5CrNi18-10) Stainless Steel	8	Price on req.
85	142-166-11	Spring Washer M16 SUS304	8	Price on req.
86	142-427-13	Seal Washer WD-12 SPC+NBR	2	Price on req.
87	144-540-19	Stator Set BoltM12x40 SS	2	Price on req.
88	122-256-17	O-Ring 390xd5.7 NBR	1	Price on req.
89	121-520-12	Packing 10x6.4x270 Felt	1	Price on req.
90	062-222-15	Bearing Collar FC	1	Price on req.
91	140-076-33	Hex.Bolt M10x30 SWRM	4	Price on req.
92	142-164-35	Spring Washer M10 SWRH	4	Price on req.
93	061-177-11	Bearing Collard95xd139x3.2t SS	1	Price on req.
94	052-185-14	Bearing7313ADB	1	Price on req.
95	141-078-25	Bearing Nut AN13 SUS304 (EN X5CrNi18-10)	1	Price on req.
96	142-246-29	Bearing Washer AW13 SUS304 (EN X5CrNi18-10)	1	Price on req.
97	060-421-10	Bearing Housing FC	1	Price on req.
98	122-259-10	O-Ring 12xd3 NBR	1	Price on req.
99	035-102-30	Oil Plug M12x16(B=21) SUS304	1	Price on req.
100	122-259-10	O-Ring 12xd3 NBR	2	Price on req.
101	035-102-30	Oil Plug M12x16(B=21) SUS304	2	Price on req.
102	122-016-13	O-Ring P-16(15.8xd2.4) NBR	8	Price on req.
103	144-439-14	Stud Bolt M16x60(28/20) SUS304 (EN X5CrNi18-10)	8	Price on req.
104	090-122-11	Leakage Sensor(Electrode) d9x43L SUS	1	Price on req.
105	142-161-32	Spring Washer M5 SWRH	2	Price on req.
106	140-021-33	Hex.Bolt M5x20 SWRM	2	Price on req.
107	026-274-10	Oil Seal SC-507212 NBR	1	Price on req.
108	071-322-14	Spacerd55xd71x3.2t SS	3	Price on req.
109	122-153-13	O-Ring G-220 NBR	1	Price on req.
110	113-104-11	Greese Pan Gray Iron CastingLH110KW FC	1	Price on req.
111	142-164-35	Spring Washer M10 SWRH	4	Price on req.
112	140-076-33	Hex.Bolt M10x30 SWRM	4	Price on req.
113	025-001-17	Mechanical Seal H-50T SIC	1	Price on req.
114	143-028-13	Pan Screw M5x10 SWRM	3	Price on req.
115	030-133-19	Oil Lifter H-50(T) SPCC	1	Price on req.
116	122-270-17	O-Ring 350xd5.7 NBR	1	Price on req.
117	029-174-21	Oil Casing GH-1100 FC	1	Price on req.
118	122-270-17	O-Ring 350xd5.7 NBR	1	Price on req.
119	142-165-10	Spring Washer M12 SUS304	8	Price on req.
120	140-097-14	Hex.Bolt M12x30 SUS304	8	Price on req.
121	071-142-18	Shaft Sleeve (Upper) GH-550/750 SUS403 (EN X6Cr13)	1	Price on req.
122	071-153-12	Shaft Sleeve (Lower) d45xd49x57.5L SUS403 (EN X6Cr13)	1	Price on req.
123	122-271-18	O-Ring 540xd5.7 NBR	1	Price on req.
124	020-457-11	Pump Casinq (Upper)GH/LH-110KW FC	1	Price on req.
125	144-435-36	Stud Bolt M16x40(28/32) SUS304 (EN X5CrNi18-10)	8	Price on req.
126	142-166-11	Spring Washer M16 SUS304	8	Price on req.
127	141-008-11	Hex.Nut M16 SUS304 (EN X5CrNi18-10)	8	Price on req.
128	122-226-18	O-Ring S-75(74.5xd2.0) NBR	2	Price on req.
129	026-211-19	Labyrinth Ring d55.5xd78x47L SUS403 (EN X6Cr13)	1	Price on req.
130	040-127-11	Impeller Shim d45.2xd68x0.3t SUS304 (EN X5CrNi18-10)	1	Price on req.
131	021-K93-17	Impeller (50Hz)LH690-50 HICRFC	1	Price on req.
132	142-274-13	Impeller Fixing Washer d33xd75x6t SUS304 (EN X5CrNi18-10)	1	Price on req.
133	141-012-50	Hex.Nut M30(H=18) SUS304 (EN X5CrNi18-10)	1	Price on req.
134	141-036-18	Hex.Cap Nut M30 SUS304 (EN X5CrNi18-10)	1	Price on req.
135	020-977-12	Pump Casing (Lower)(50Hz)LH690-50 FCD	1	Price on req.
136	142-166-11	Spring Washer M16 SUS304	8	Price on req.
137	141-008-11	Hex.Nut M16 SUS304 (EN X5CrNi18-10)	8	Price on req.
138	140-101-41	Hex.Bolt M12x50 EN X5CrNi18-10	4	Price on req.
139	144-128-17	Stud Bolt M16x110(24/24) SUS403 (EN X6Cr13)	4	Price on req.
140	122-302-19	O-Ring 215xd3.8 NBR	1	Price on req.
141	120-118-10	Packing (S.Cover) d211xd274x0.5t PE	1	Price on req.
142	034-423-11	Suction Mouth GH-890 HiCrFC	1	Price on req.
143	142-165-10	Spring Washer M12 SUS304	6	Price on req.
144	140-098-15	Hex.Bolt M12x35 SUS304	6	Price on req.
145	141-007-10	Hex.Nut M12 SUS304	3	Price on req.
146	142-129-12	Plain Washer M12 SUS304	3	Price on req.
147	142-165-10	Spring Washer M12 SUS304	3	Price on req.
148	043-102-19	Cathodic Protection Plate AB-1HS(75x70x20t) Al	3	Price on req.
149	023-287-17	Strainer StandLH690/6110 SS	1	Price on req.
150	140-097-14	Hex.Bolt M12x30 SUS304	3	Price on req.
151	141-008-11	Hex.Nut M16 SUS304 (EN X5CrNi18-10)	4	Price on req.
	173-001-26	Packing & O-Ring Set	1	Price on req.
	##oilVG32	ml Turbine Oil ISO VG32	8000	Price on req.

Exploded View LH690-50

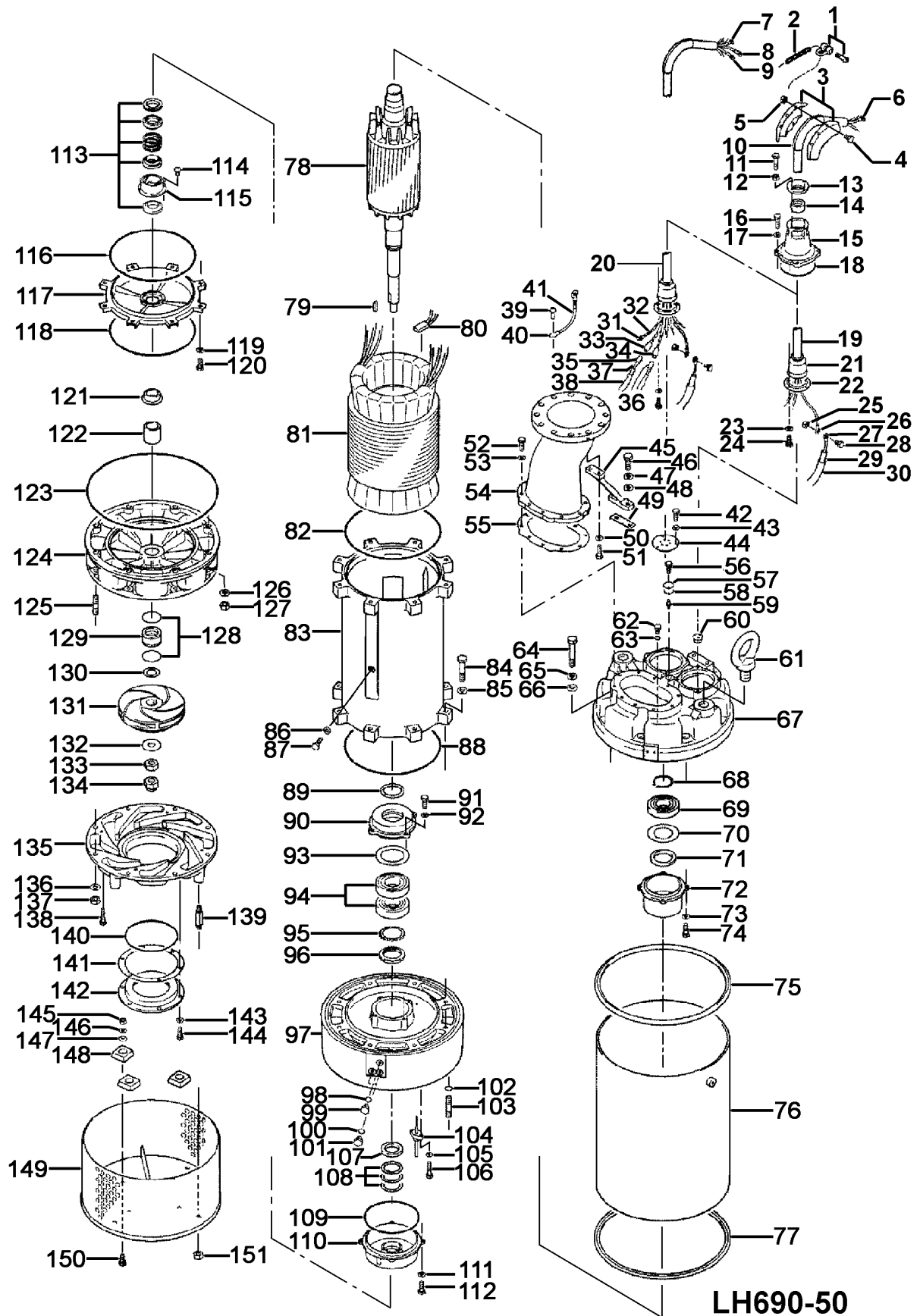

LH690-50