

HS2.4S-53

Kontroll-Nr. --

2019-01-28 V.20 / 1.11.2017

| Pos.no | Item no. | Description | Quant. | UP |
|--------|------------|---|--------|---------------|
| | | Dichtungs-Oring-Satz | 1 | Price on req. |
| 1 | 001-009-48 | Cabletyre Cable Set (10m) 220/230/240V-50HZ(EUR) H07R-F3Cx1mm2 LBD(HAR) | 1 | Price on req. |
| | 061-TEG-05 | Cable Repair Kit | 1 | Price on req. |
| 2 | 010-134-18 | Cable Clip Rubber HS3-4 NBR | 1 | Price on req. |
| 3 | 140-427-17 | Hex.Bolt (w/Plain Washer) M5x15 SUS304 (EN X5CrNi18-10) | 2 | Price on req. |
| 4 | 003-190-10 | Gland SUS316 (EN X5CrNi-Mo17-12-2) | 1 | Price on req. |
| 5 | 140-032-37 | Hex.Bolt M6x15 SWRM | 2 | Price on req. |
| 6 | 068-259-19 | Handle HS-Series | 1 | Price on req. |
| 7 | 140-431-14 | Hex.Bolt (w/Plain Washer) M6x25 SUS304 (EN X5CrNi18-10) Stainless Steel | 3 | Price on req. |
| 8 | 051-250-18 | Motor Head Cover ADC | 1 | Price on req. |
| 9 | 121-546-14 | Packing d120xd142x6.2t NBR | 1 | Price on req. |
| 10 | 076-000-35 | Capacitor 220V/230V/240V-50H SH-CAP.500VAC-8MF | 1 | Price on req. |
| 11 | 143-086-35 | Pan Screw M4x8 BSBM | 1 | Price on req. |
| 12 | 050-486-12 | Motor Bracket SECD | 1 | Price on req. |
| 13 | 142-192-16 | Wave Washer 6201(D=32,t=0.4) SK5 | 1 | Price on req. |
| 14 | 052-100-15 | Bearing 6201ZZC3 | 1 | Price on req. |
| 15 | 055-000-29 | Rotor (HS2.4S-53, LSC1.4S-52, LB-480-53) | 1 | Price on req. |
| 16 | 061-180-17 | Bearing Collar d15.1xd20x1.6t SS | 1 | Price on req. |
| 17 | 052-101-16 | Bearing 6202ZZC3 | 1 | Price on req. |
| 18 | 056- | Stator | 1 | Price on req. |
| 19 | 064-516-15 | Motor Frame ADC | 1 | Price on req. |
| 20 | 122-133-17 | O-Ring G-110 NBR | 1 | Price on req. |
| 21 | 025-000-82 | Mechanical Seal W-14VL SIC+CCBN | 1 | Price on req. |
| 22 | 030-000-09 | Oil Lifter W-14VL Resin | 1 | Price on req. |
| 23 | 141-005-34 | Hex.Nut M8 S35C | 3 | Price on req. |
| 24 | 142-127-23 | Plain Washer M8 SPC | 1 | Price on req. |
| 25 | 029-000-58 | Oil Casing HS2.4(S)-51/61 FC | 1 | Price on req. |
| 26 | 121-246-11 | Packing (Oil Plug) d10.3xd16x2t PE | 1 | Price on req. |
| 27 | 035-124-12 | Oil Plug M10x15 SUS304 (EN X5CrNi18-10) | 1 | Price on req. |
| 28 | 140-256-26 | Hex. Socket Cap Bolt M6x35 SCM | 3 | Price on req. |
| 29 | 121-000-20 | Packing HS-4E NR | 1 | Price on req. |
| 30 | 071-292-14 | Shaft Sleeve LB3-250/480 SUS304 (EN X5CrNi18-10) Stainless Steel | 1 | Price on req. |
| 31 | 021-007-43 | Impeller 50Hz | 1 | Price on req. |
| 31 | 021-007-44 | Impeller (60HZ) 60Hz Urethane Rubber | 1 | Price on req. |
| 32 | 142-127-23 | Plain Washer M8 SPC | 1 | Price on req. |
| 33 | 142-163-34 | Spring Washer M8 SWRH | 1 | Price on req. |
| 34 | 024-174-13 | Stirrer HS2.4(S)(M8) Sintered Alloy | 1 | Price on req. |
| 35 | 140-057-38 | Hex.Bolt M8x35 SWRM | 2 | Price on req. |
| 36 | 032-000-67 | Hose Coupling 50mm(LB2-480) ADC | 1 | Price on req. |
| 36 | 032-432-17 | Hose Coupling (for EUR) HS2.4S.45 Deg.,BSPT2(R2) FC | 1 | Price on req. |
| 37 | 121-138-19 | Packing (Screwed Flange) LB(P.C.84) NBR | 1 | Price on req. |
| 38 | 020-000-41 | Pump Casing HS2.4(S)-52/62 FC | 1 | Price on req. |
| 39 | 142-127-23 | Plain Washer M8 SPC | 2 | Price on req. |
| 40 | 141-005-34 | Hex.Nut M8 S35C | 2 | Price on req. |
| 41 | 023-453-16 | Strainer Stand SK2.4S PVC | 1 | Price on req. |
| 42 | 140-064-12 | Hex.Bolt M8x70 SUS304 (EN X5CrNi18-10) Stainless Steel | 3 | Price on req. |
| | 173-550-12 | Packing & O-Ring Set | 1 | Price on req. |
| | ##oilVG32 | ml Turbine Oil ISO VG32 | 160 | Price on req. |

Exploded View HS2.4S-53

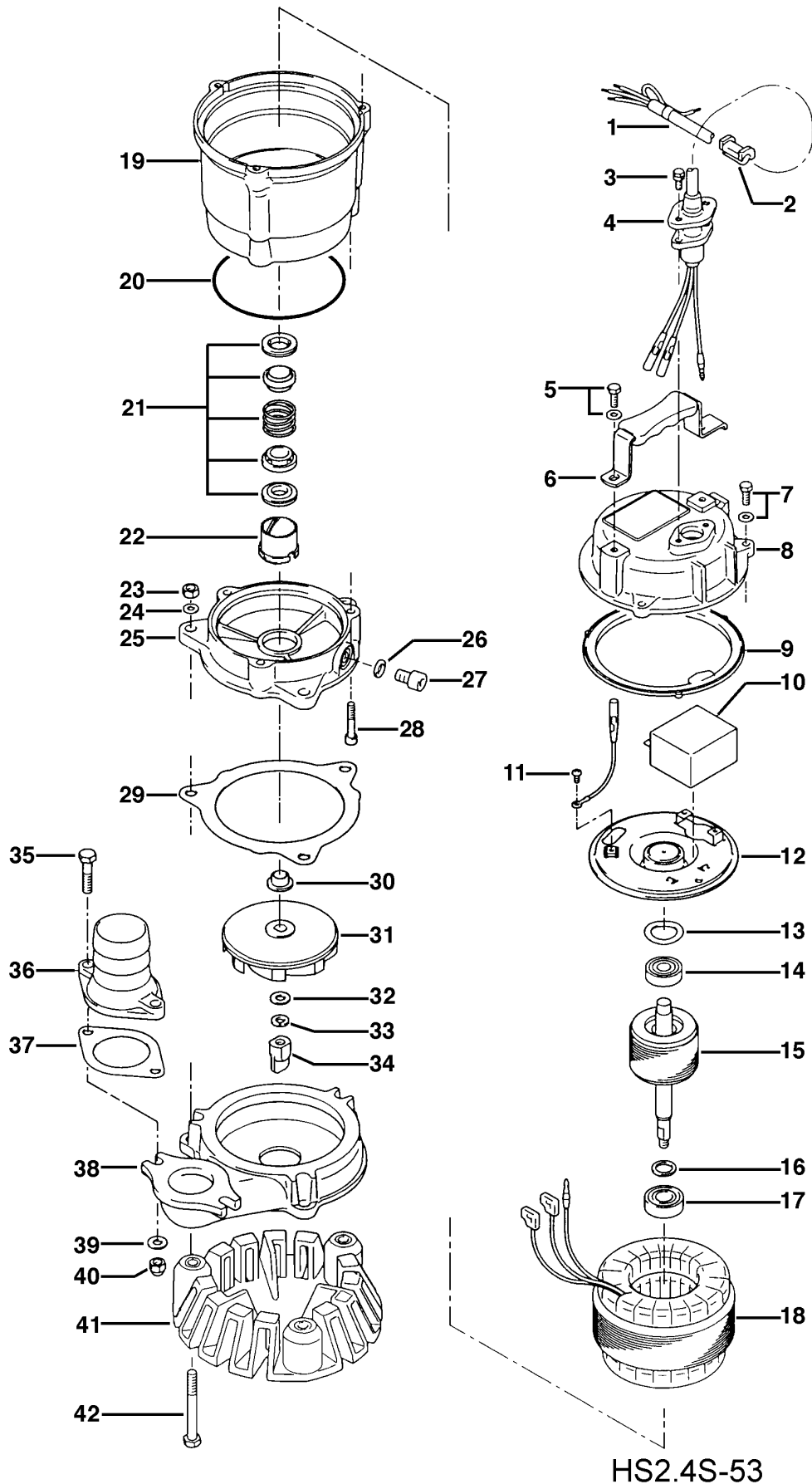

HS2.4S-53