

Electric pump ENM 25 - 30 - 40 - 50

Electric pump ENT 25 - 30 - 40 - 50

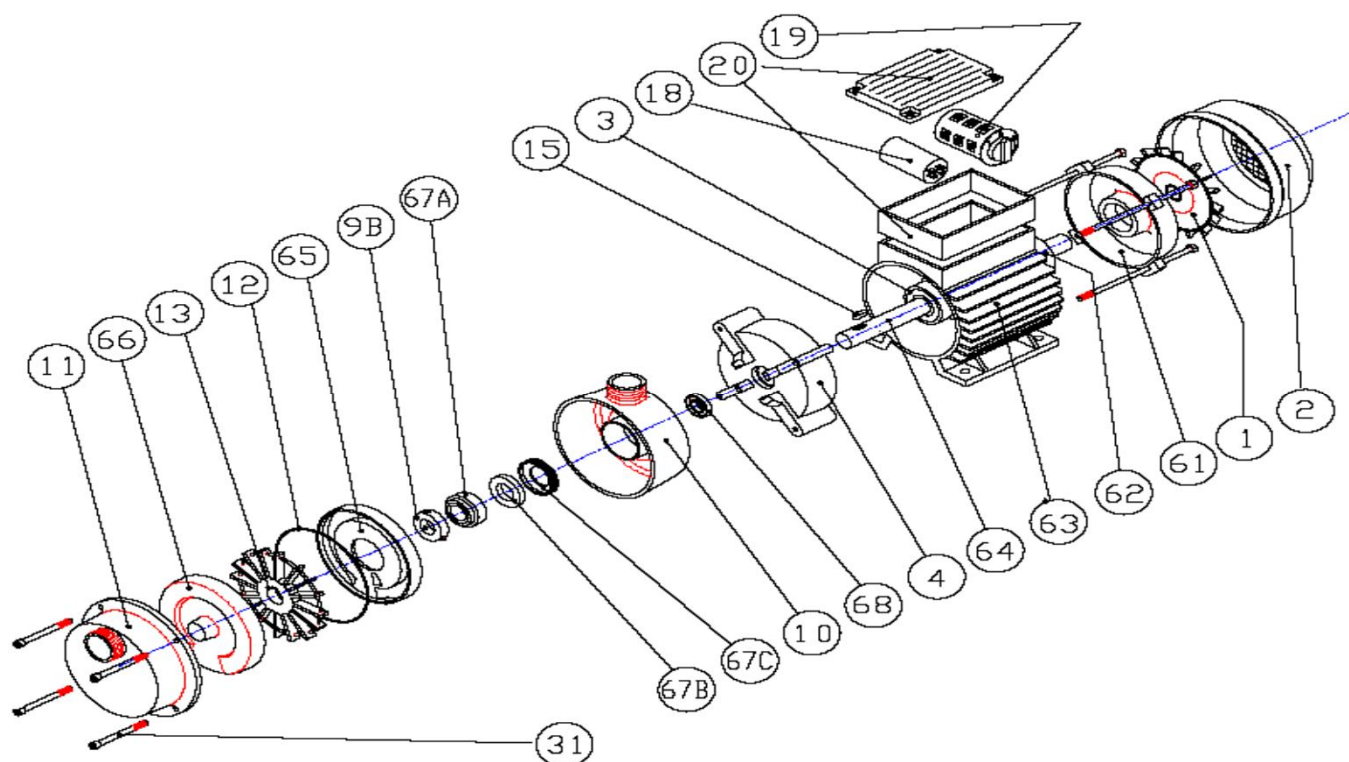

COD.	N°	PART
LN	4	Flange
VN	1	Motor fan
CN	2	Fan cover
M	19	Switchreverser
N	20	Switchreverser box
GI	15	Impeller feather
AR	9B	Seal shaft collar
FI	10	Pump body
AI	11	Pump cover
B	12	O-ring
CI	13	Stainless steel impeller
PP	65	Internal back part
PA	66	Internal front part
TM	67 A+B+C	Mechanical seal
TM	68	Motor lip seal
J 25	31	Hex head hollow screw
	18	Capacitor (only for ENM)
KITAL		Seals set for inox pumps (12+67+68)
	63	Motor frame with stator
	64	Motor shaft with rotor