

# Data sheet 100UZ411-54

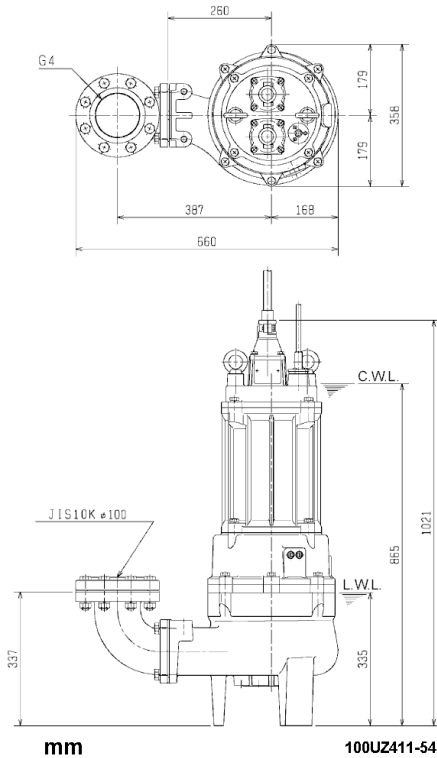

CWL: Continuous running water level  
LWL: Lowest running water level

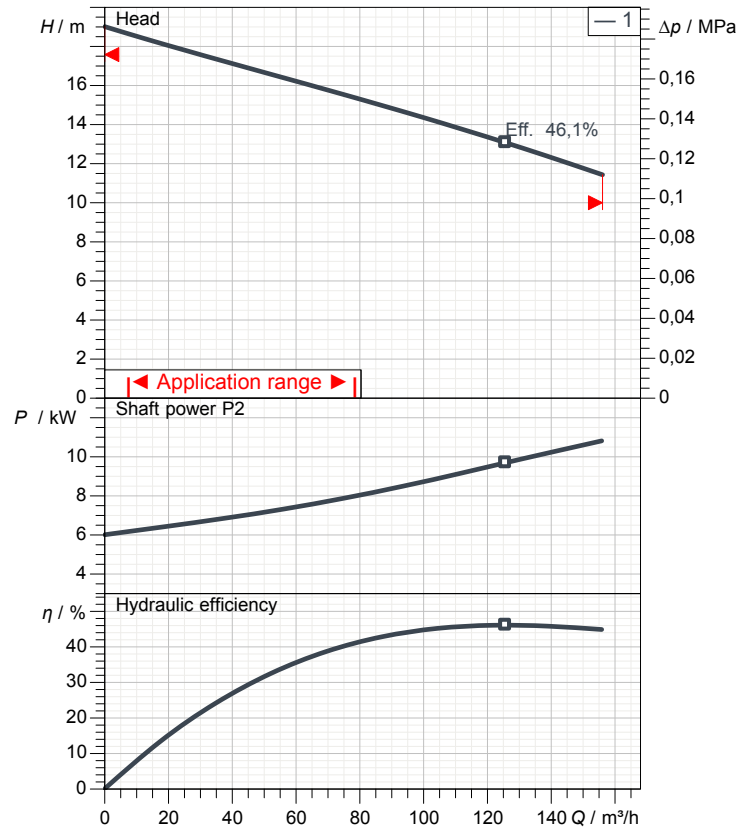

## Specification

Electric submersible pump UZ-series  
Degree of protection IP 68  
Pressure resistance max. 20 m  
Type of impeller Vortex impeller  
Free passage 100 mm  
Suitable for:  
waste water and liquid carrying

## Electric motor

Dry-type submersible induction motor  
Insulation class F 4 Poles 1445 1/min  
Starting mode Star-delta  
Rated voltage 400 V 50 Hz 3~  
Power uptake 13,50 kW  
Rated power 11,00 kW  
Rated current 23,8 A  
Start current 128,0 A

## Cable

10m H07RN-F 4Cx2,5mm²/H07RN-F 3Cx2,5mm²/2PNCT 2Cx2mm²

## Motor Protection

Circle thermal protector  
(snap-action bi-metal device)

## Shaft seal

Double inside mechanical seal in oil bath  
additional lubrication by oil lifting device  
Primary seal  
Silicon carbide on silicon carbide  
Secondary seal  
Silicon carbide on silicon carbide

## Bearings

Shielded ball bearings, maintenance-free

## Materials

Impeller	FC200 (EN-GJL-200)
Pump casing	FC200 (EN-GJL-200)
Motor Frame	FC150 (EN-GJL-150)
Shaft	SUS420J2 (EN-X30Cr13)

## Discharge size

4" (100mm) special screwed-in mating flange  
guide rail fitting optional

## Weight

191 kg (dry weight of the pump only without cable)

# Performance curve

## 100UZ411-54

Discharge port	4"
Head	19,0 m
Flow	156,1 m <sup>3</sup> /h
Rated power	11,00 kW
Power input	13,50 kW
Phases	3~
Voltages	400 V
Frequency	50 Hz
Rated current	23,8 A
Starting current	42,68 A
Number of poles	4
Speed	1445 1/min
Starting mode	Star-delta
Insulation class	F

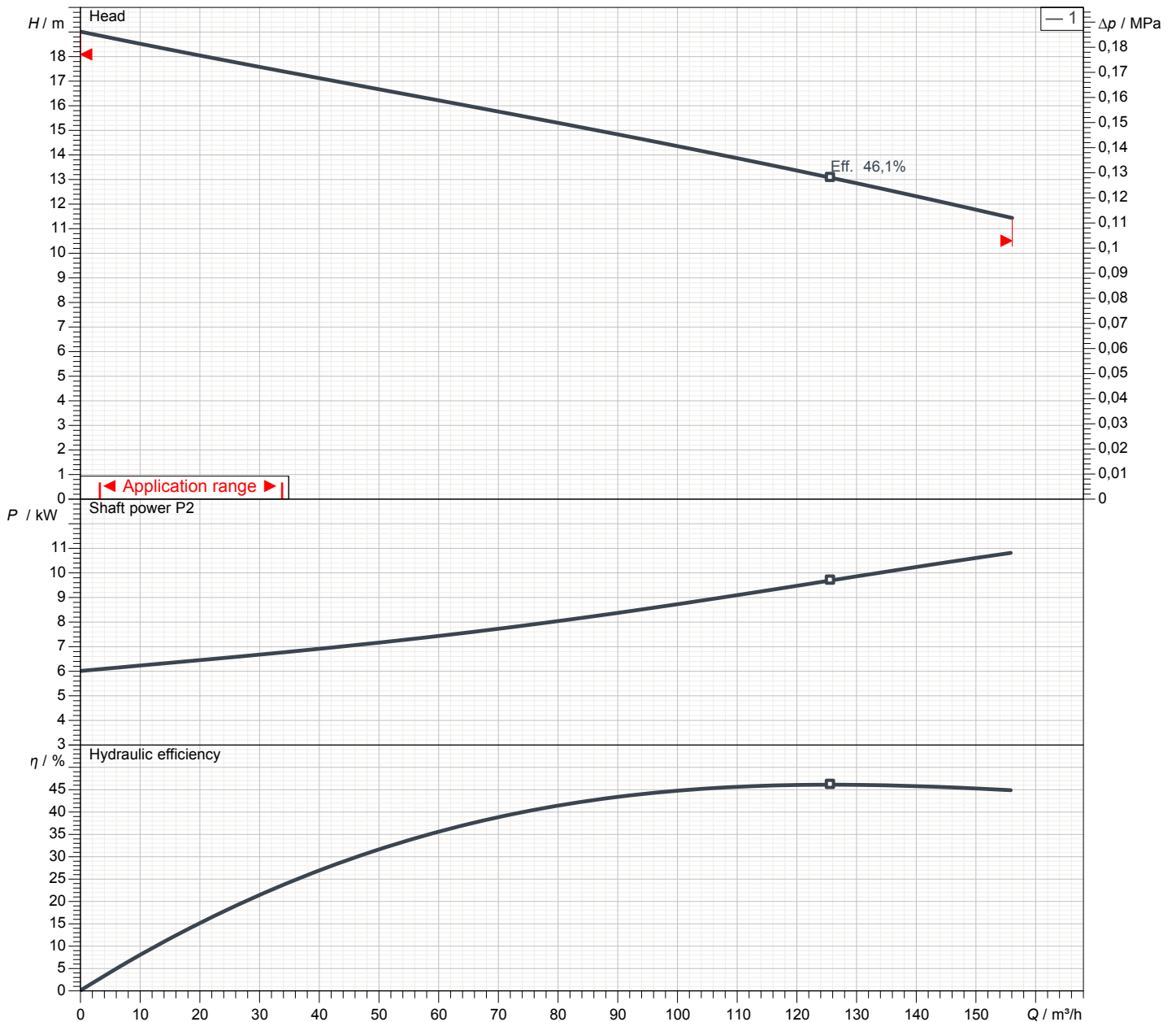

# Dimensions

## 100UZ411-54

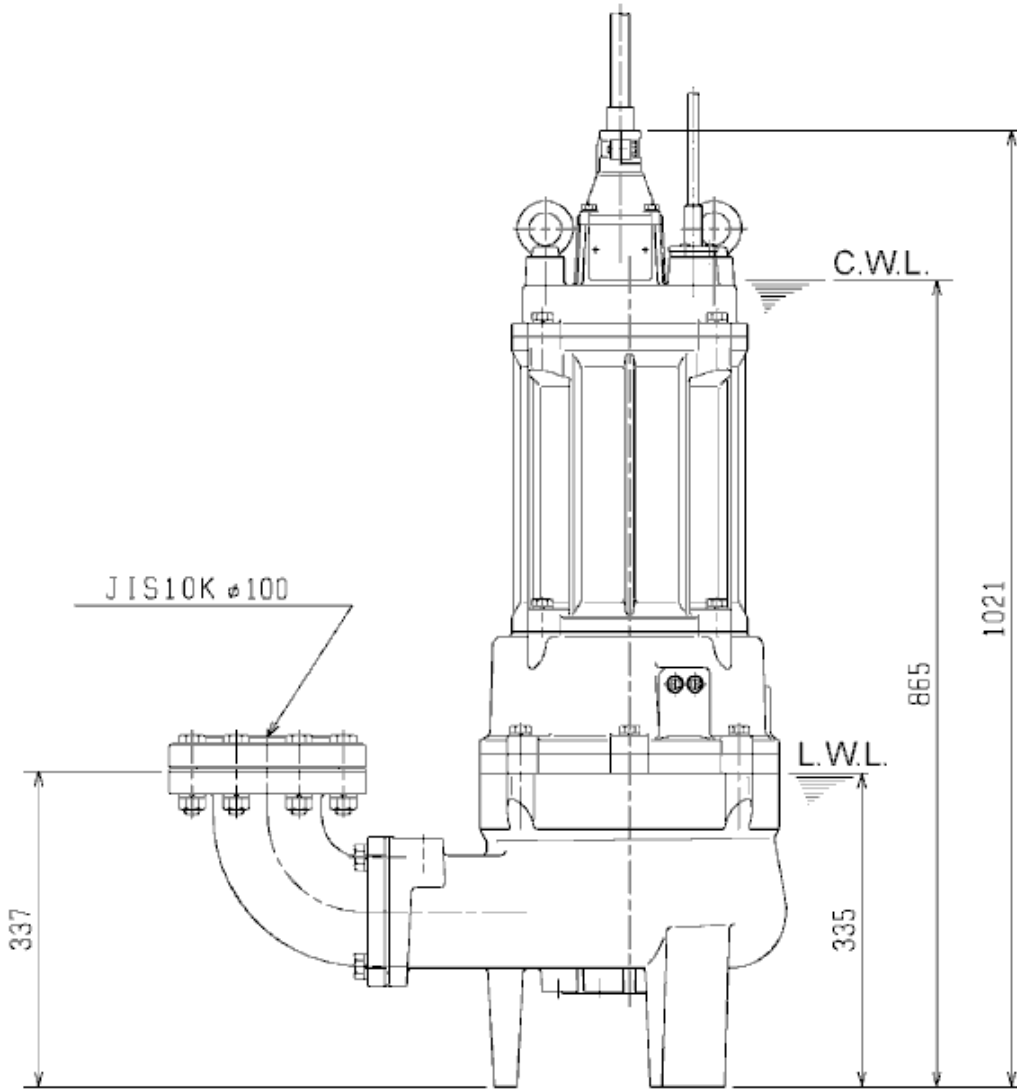
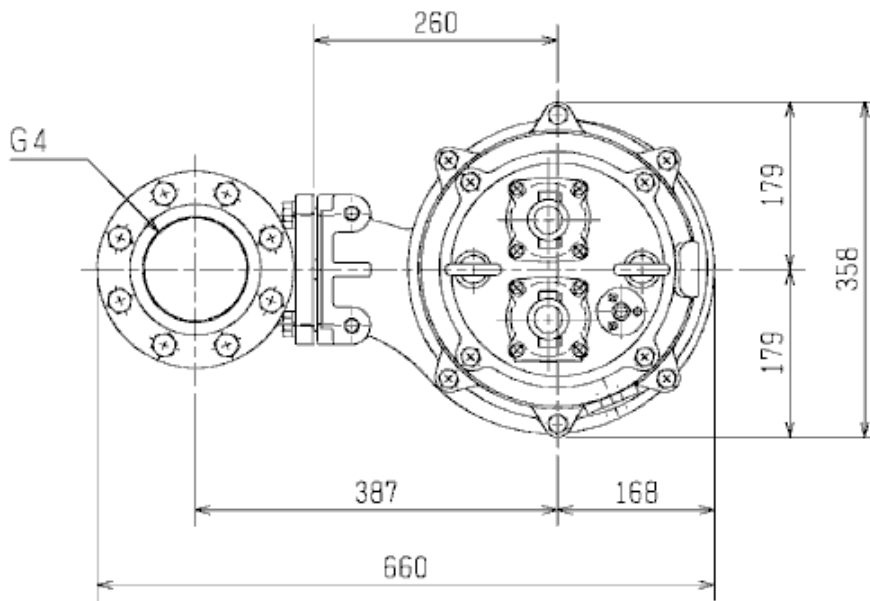

mm

100UZ411-54

CWL: Continuous running water level  
LWL: Lowest running water level

# Sectional drawing 100UZ411-54

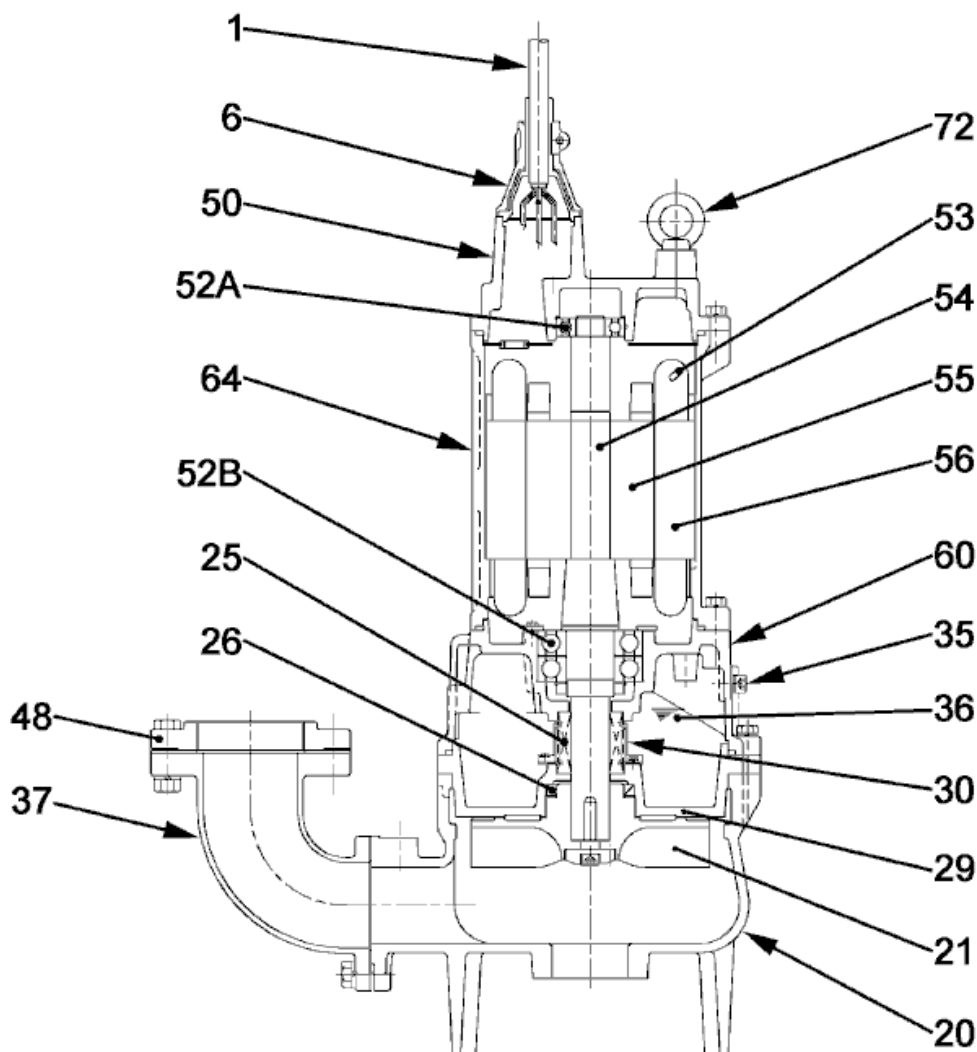

**100UZ411-54**

No.	Description	Remark	No.	Description	Remark
1	Cable (3x)	2x H07RN-F / 1x 2PNCT	55	Rotor	.
6	Stuffing box (2x)	FC200 (EN-GJL-200)	56	Stator	.
20	Pump casing	FC200 (EN-GJL-200)	60	Bearing Housing	FC150 (EN-GJL-150)
21	Impeller	FC200 (EN-GJL-200)	64	Motor Frame	FC150 (EN-GJL-150)
25	Mechanical seal	H-40X	72	Eye screw (2x)	Construction steel SS400
26	Oil seal	TC709212			
29	Oil casing	FC200 (EN-GJL-200)			
30	Oil distributor	Plastic			
35	Oil screw (2x)	SUS304 (EN-X5CrNi18-10)			
36	Lubricant	Turbine oil (ISO VG32)			
37	Discharge bend	FC200 (EN-GJL-200)			
48	Screwed Flange	FC200 (EN-GJL-200)			
52A	Upper bearing	6206ZZC3			
52B	Lower bearing	6310ZZD2C3			
53	Miniature protector (3x)	.			
54	Shaft	SUS420J2 (EN-X30Cr13)			