

Data sheet KTZ33.7-53

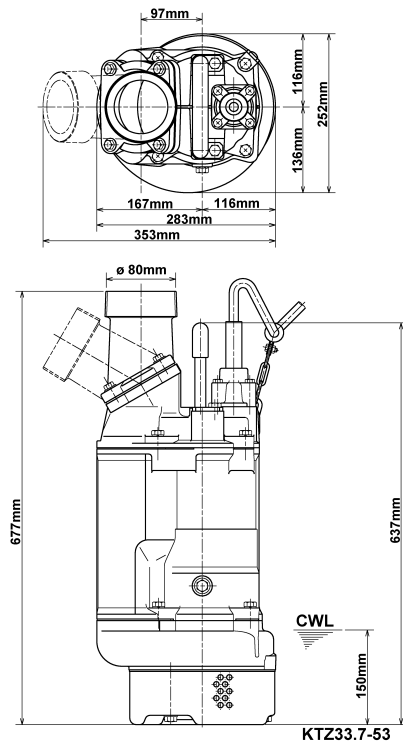

CWL: Continuous running water level

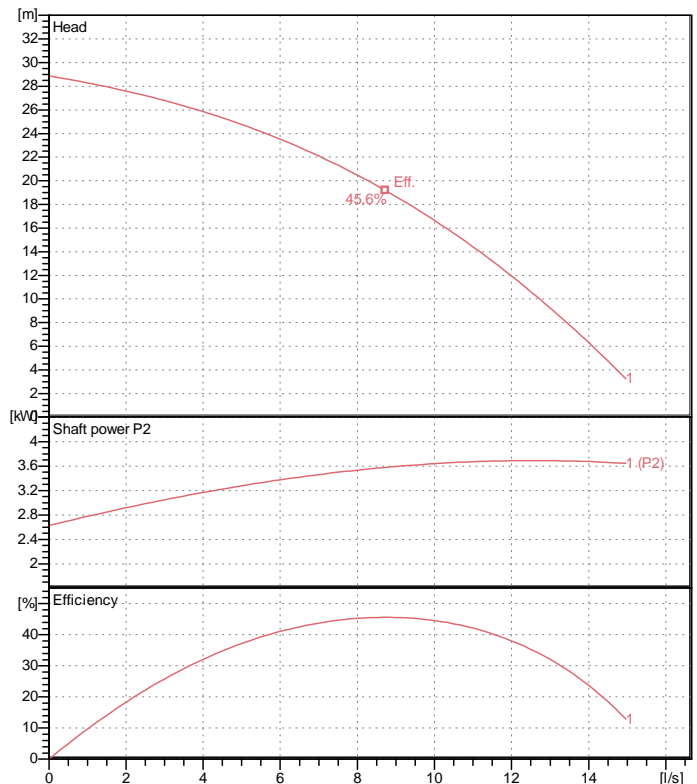

Specification

Electric submersible pump
 Degree of protection IP 68
 Depth of submersion max. 25 m
 Type of impeller Semi-open
 Max. solid handling 8.5 mm
 Suitable for:
 spring-/rain-/waste-/ground water, water containing sand

Electric motor

Dry-type submersible induction motor
 Insulation class F 2Poles 2850 1/min
 Starting mode Directly
 Rated voltage 400 V 50 Hz 3~
 Power uptake 4.91 kW
 Rated power 3.70 kW
 Rated current 7.7 A
 Start current 58.0 A

Cable

20m NSSHÖU 4Cx1,5mm²

Motor Protection

Circle thermal protector
 (snap-action bi-metal device)

Shaft seal

Double inside mechanical seal in oil bath
 additional lubrication by oil lifting device
 Primary seal
 Silicon carbide on silicon carbide
 Secondary seal
 Silicon carbide on carbon

Bearings

Shielded ball bearings, maintenance-free

Materials

| | |
|---------------|-----------------------|
| Impeller | Chromium Iron HiCrFC |
| Pump casing | FC200 (EN-GJL-200) |
| Suction cover | FCD50 (EN-GJS-500-7) |
| Motor Frame | FC150 (EN-GJL-150) |
| Shaft | SUS420J2 (EN-X30Cr13) |

Discharge size

3" (80mm) BS-coupling (threaded flange)

Weight

62 kg (dry weight of the pump only without cable)

Performance curve

KTZ33.7-53

| | |
|------------------|------------|
| Discharge port | 3" |
| Head | 28.9 m |
| Flow | 15.0 l/s |
| Rated power | 3.70 kW |
| Power input | 4.91 kW |
| Phases | 3~ |
| Voltages | 400 V |
| Frequency | 50 Hz |
| Rated current | 7.7 A |
| Starting current | 57.98 A |
| Number of poles | 2 |
| Speed | 2850 1/min |
| Starting mode | Directly |
| Insulation class | F |

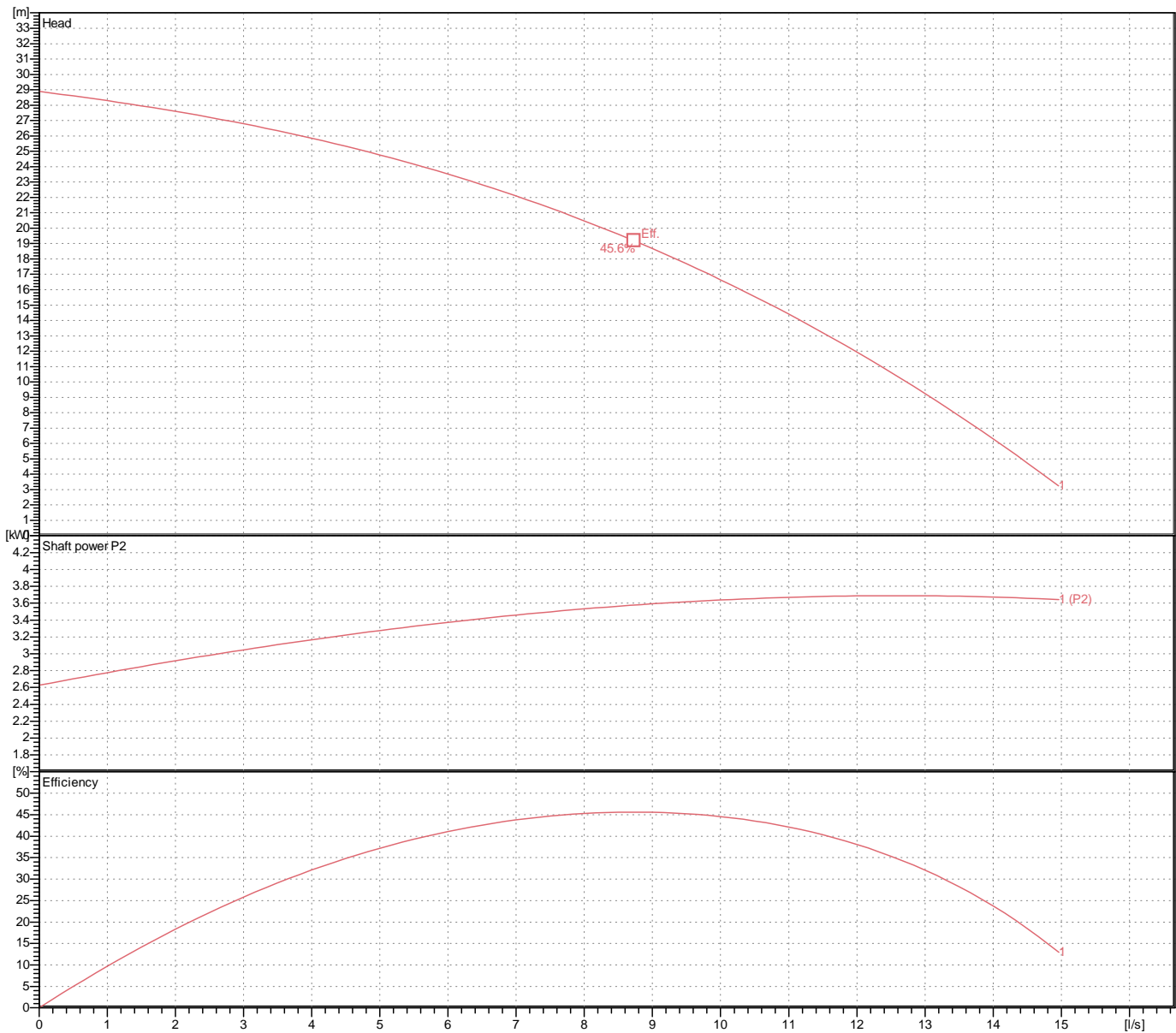

Dimensions

KTZ33.7-53

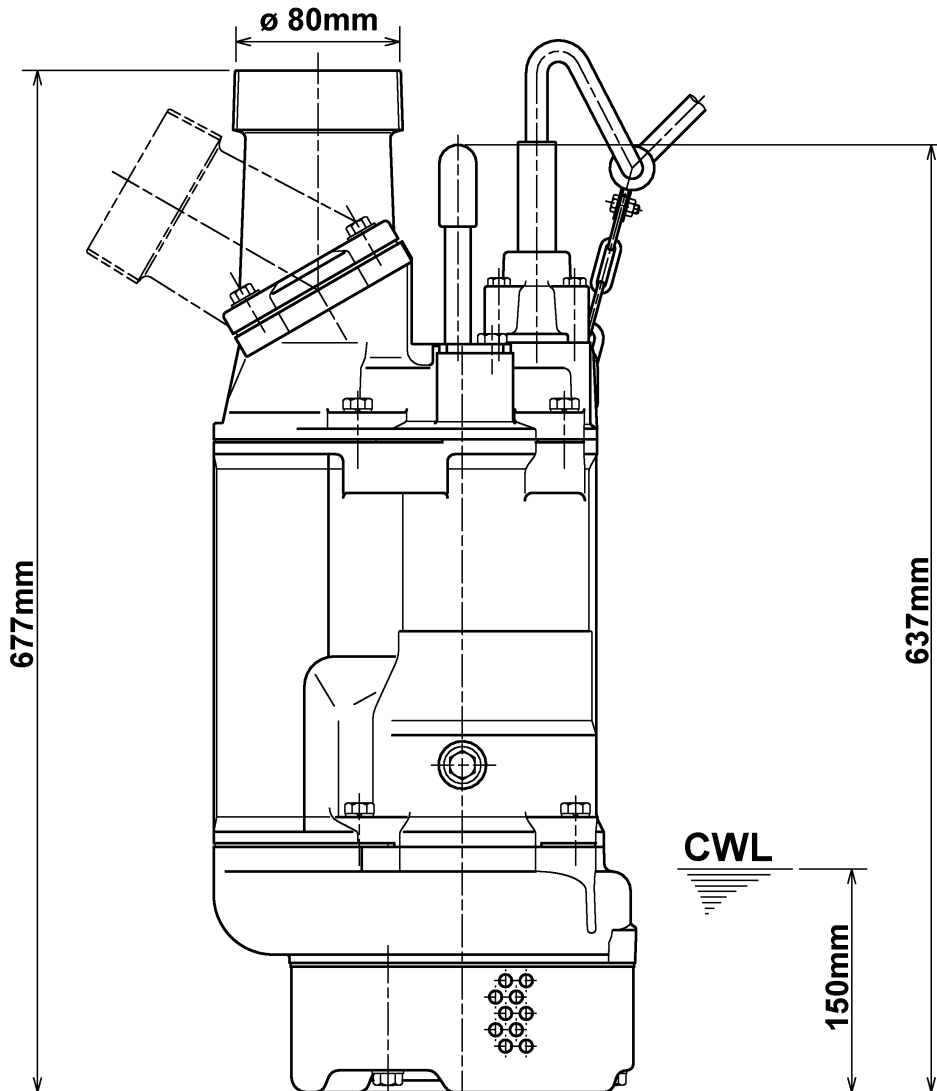
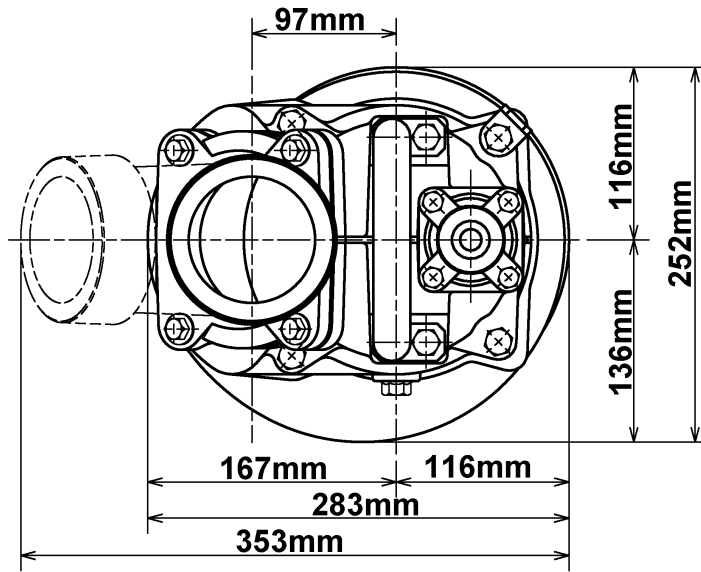

CWL



150mm

KTZ33.7-53

CWL: Continuous running water level
LWL: Lowest running water level

 **TSURUMI PUMP**

Tsurumi Europe GmbH
18.04.2016 V.18 / 1.10.2015

Heltorf Str. 14 * 40472 Düsseldorf * Germany
Tel.: +49-211-4179373 sales@tsurumi.eu
Fax: +49-211-417937-480 www.tsurumi.eu

Sectional drawing KTZ33.7-53

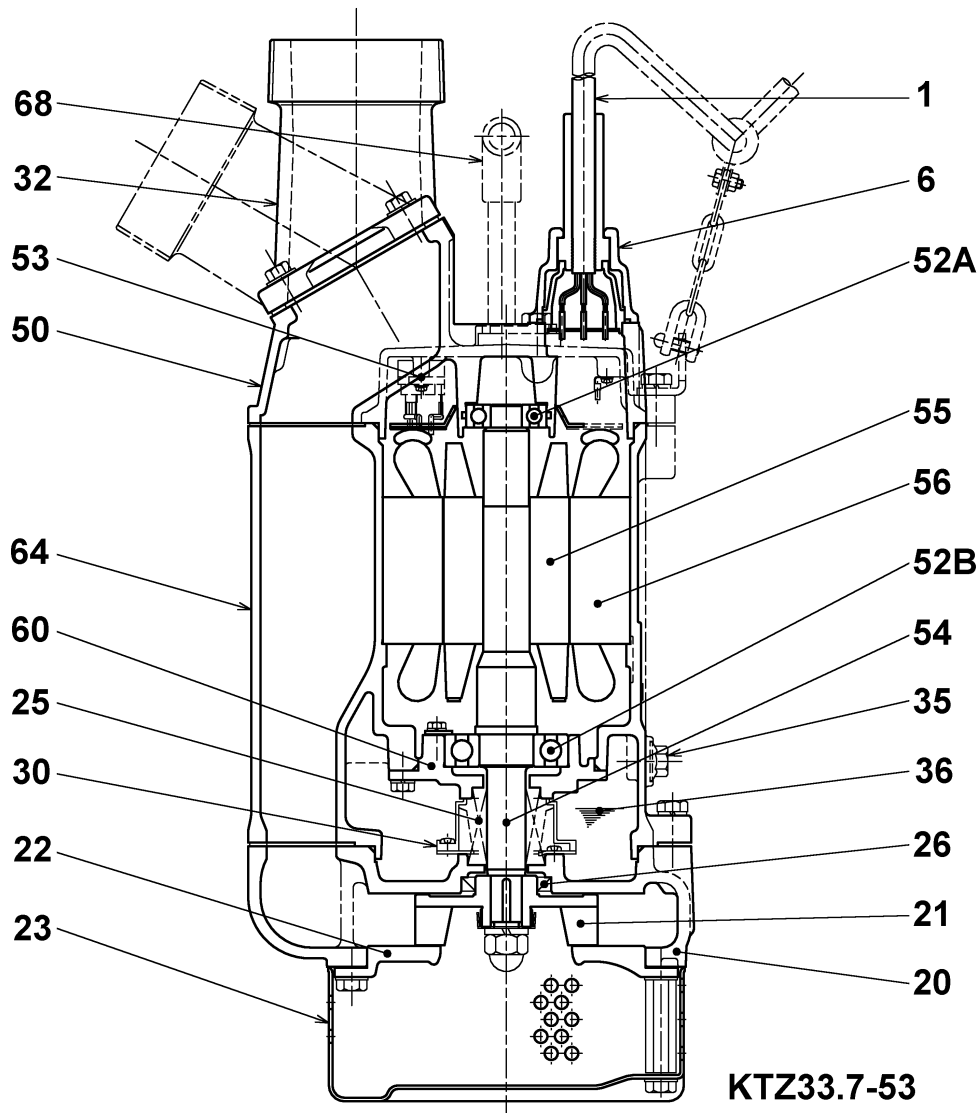

KTZ33.7-53

| No. | Description | Remark | No. | Description | Remark |
|-----|------------------------------------------------------|-------------------------|-----|-----------------|------------------------------|
| 1 | Cable | 20m NSSHÖU | 54 | Shaft | SUS420J2 (EN-X30Cr13) |
| 6 | Stuffing box | FC200 (EN-GJL-200) | 55 | Rotor | . |
| 20 | Pump casing | FC200 (EN-GJL-200) | 56 | Stator | . |
| 21 | Impeller | Chromium Iron HiCrFC | 60 | Bearing Housing | FC150 (EN-GJL-150) |
| 22 | Suction cover | FCD50 (EN-GJS-500-7) | 64 | Motor Frame | FC150 (EN-GJL-150) |
| 23 | Strainer | Steel plate | 68 | Handle | steel pipe / Sectional steel |
| 25 | Mechanical seal | H-25T | | | |
| 26 | Oil seal | TC40588 | | | |
| 30 | Oil distributor | Plastic | | | |
| 32 | Discharge coupling | FC200 (EN-GJL-200) | | | |
| 35 | Oil screw | SUS304 (EN-X5CrNi18-10) | | | |
| 36 | Lubricant | Turbine oil (ISO VG32) | | | |
| 50 | Main cover | FC150 (EN-GJL-150) | | | |
| 52A | Upper bearing | 6304ZZC3 | | | |
| 52B | Lower bearing | 6307ZZC3 | | | |
| 53 | Motor Protector 380/400/415V-50Hz KA314-HRXL00 (H.C) | | | | |