

# Data sheet 80SFQ23.7-53

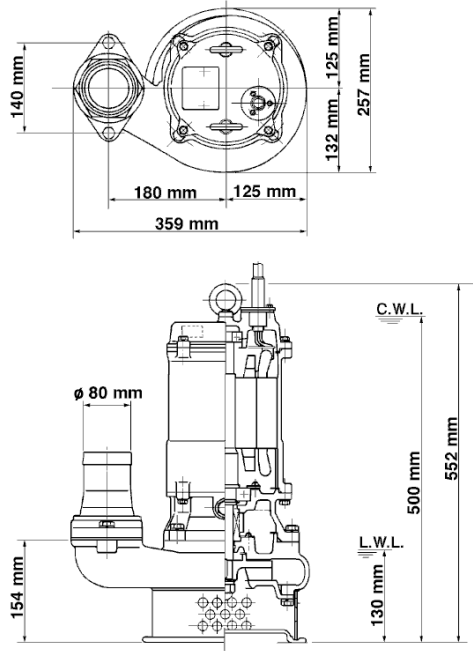

80SFQ23.7-53

CWL: Continuous running water level  
LWL: Lowest running water level

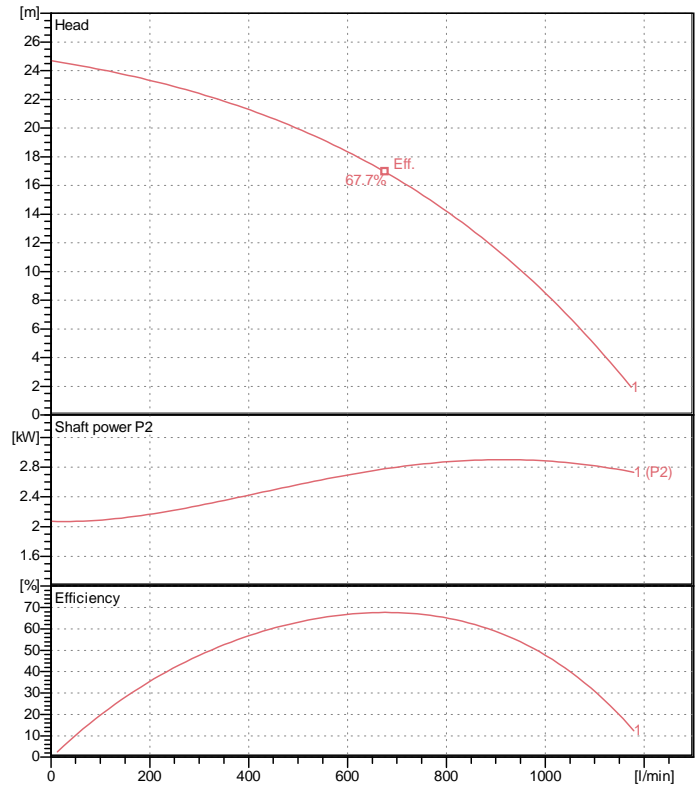

## Specification

Electric submersible pump  
Degree of protection IP 68  
Depth of submersion max. 15 m  
Type of impeller Semi-open  
Max. solid handling 15 mm  
Suitable for:  
corrosive liquids

## Electric motor

Dry-type submersible induction motor  
Insulation class F 2 Poles 2850 1/min  
Starting mode Directly  
Rated voltage 400 V 50 Hz 3~  
Power uptake 4.58 kW  
Rated power 3.70 kW  
Rated current 7.3 A  
Start current 58.0 A

## Cable

10m H07RN-F 4Cx1,5mm<sup>2</sup>

## Motor Protection

Miniature protector in windings  
(snap-action bi-metal device)

## Shaft seal

Double inside mechanical seal in oil bath  
additional lubrication by oil lifting device

Primary seal

Silicon carbide on silicon carbide

Secondary seal

Silicon carbide on silicon carbide

## Bearings

Shielded ball bearings, maintenance-free

## Materials

Impeller	SCS14 (SUS GX5CrNiMo19-11-2)
Pump casing	SCS14 (SUS GX5CrNiMo19-11-2)
Suction cover	SCS14 (SUS GX5CrNiMo19-11-2)
Motor Frame	SCS14 (SUS GX5CrNiMo19-11-2)
Shaft	SUS316 (EN-X5CrNiMo17-12-2)

## Discharge size

80mm JIS10K flange

## Weight

52 kg (dry weight of the pump only without cable)

# Performance curve

## 80SFQ23.7-53

Discharge port	3"
Head	24.7 m
Flow	1173.7 l/min
Rated power	3.70 kW
Power input	4.58 kW
Phases	3~
Voltages	400 V
Frequency	50 Hz
Rated current	7.3 A
Starting current	58.03 A
Number of poles	2
Speed	2850 1/min
Starting mode	Directly
Insulation class	F

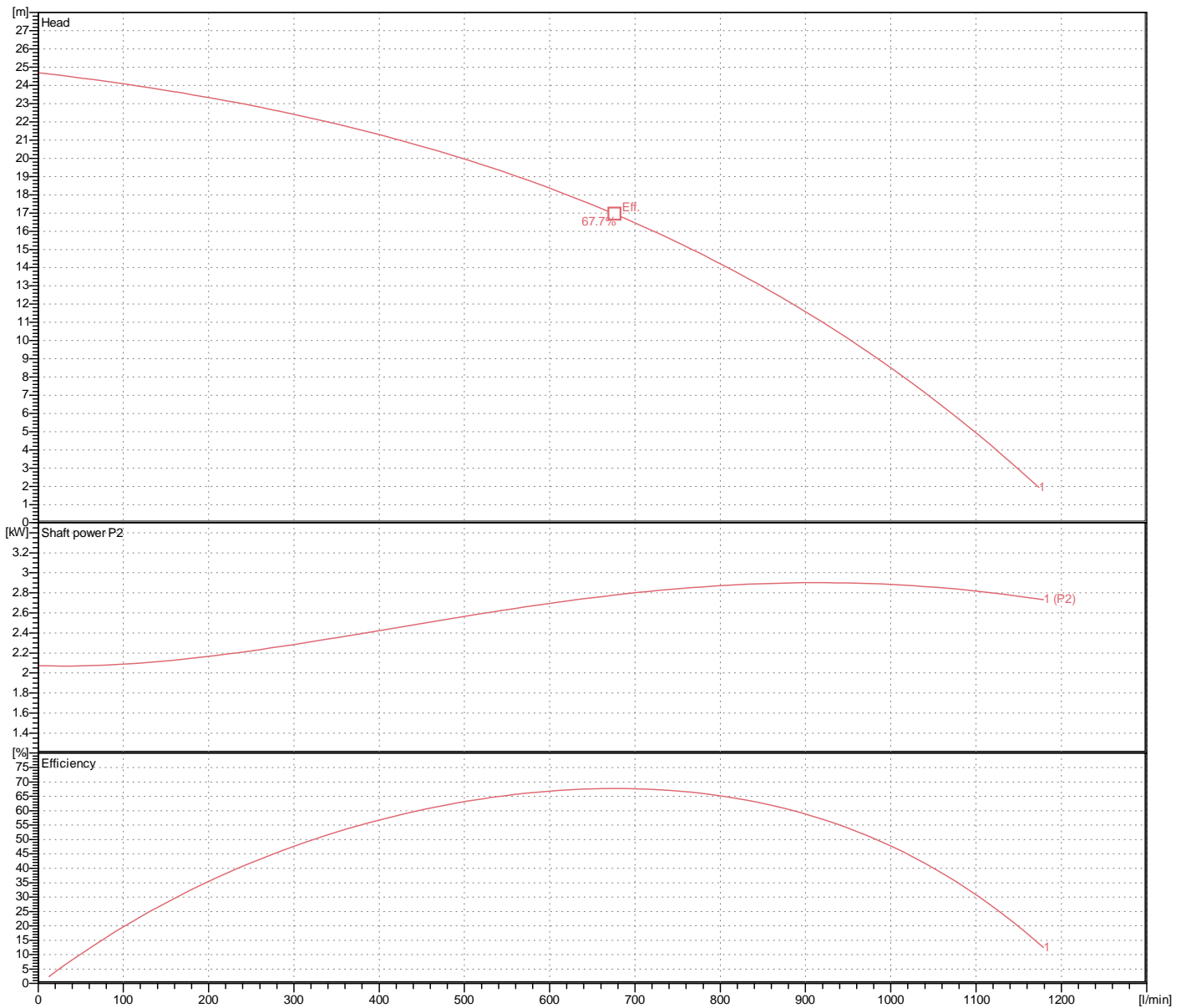

# Dimensions

## 80SFQ23.7-53

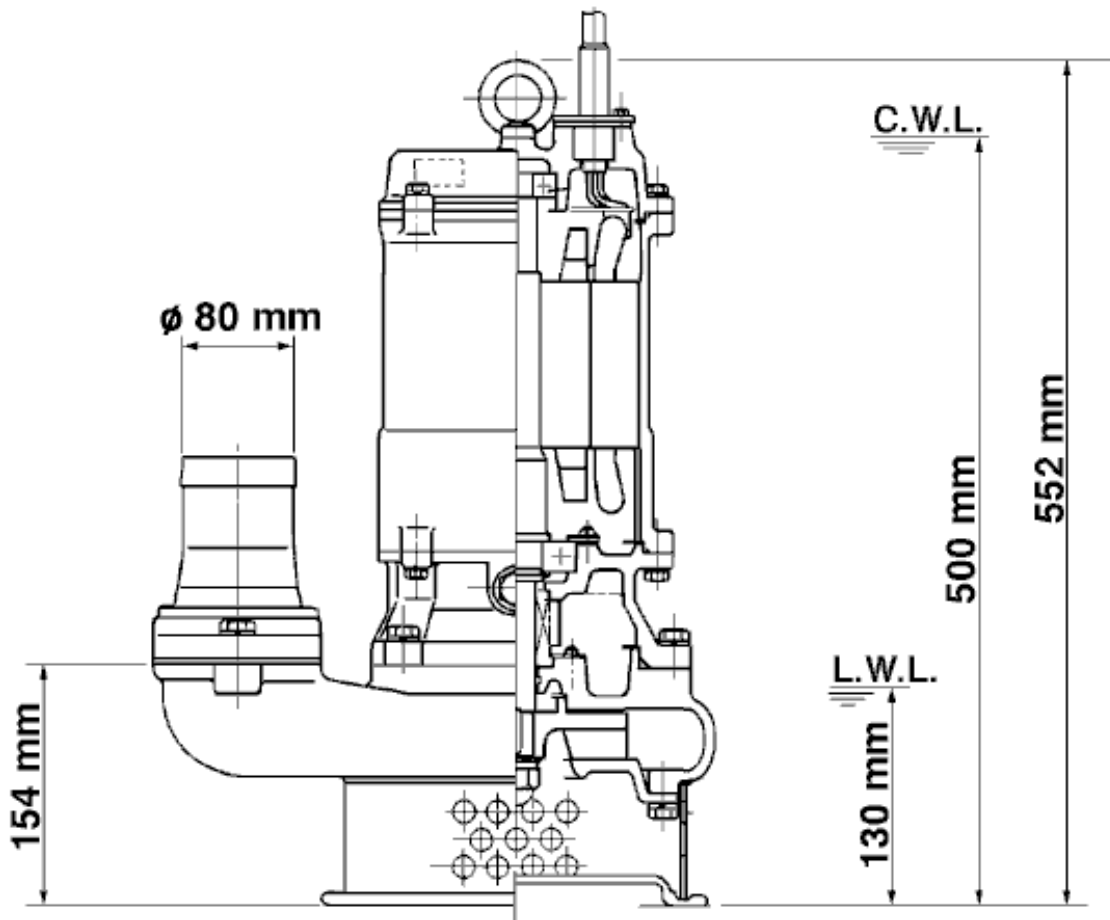
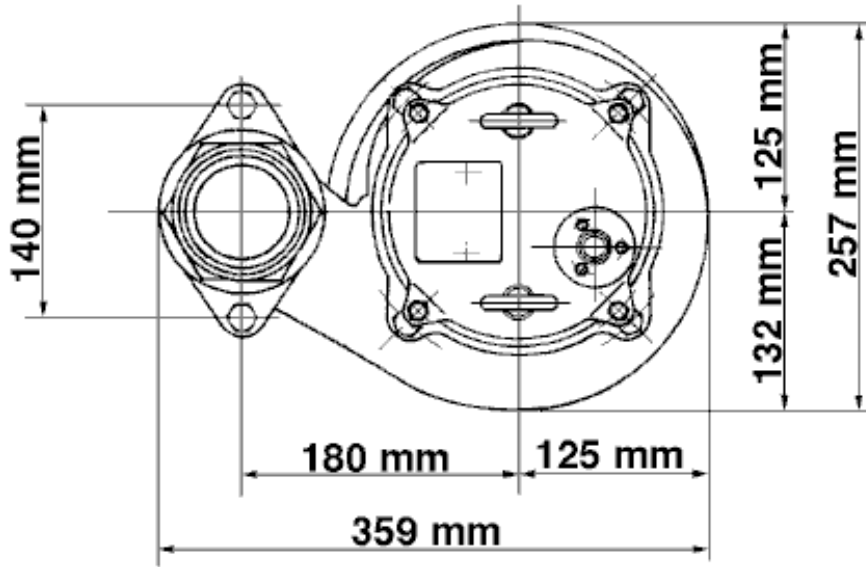

**80SFQ23.7-53**

CWL: Continuous running water level  
LWL: Lowest running water level

 **TSURUMI PUMP**

Tsurumi Europe GmbH  
17.10.2017 V.18 / 1.10.2015

Heltorfer Str. 14 \* 40472 Düsseldorf \* Germany  
Tel.: +49-211-4179373 sales@tsurumi.eu  
Fax: +49-211-417937-480 www.tsurumi.eu

# Sectional drawing 80SFQ23.7-53

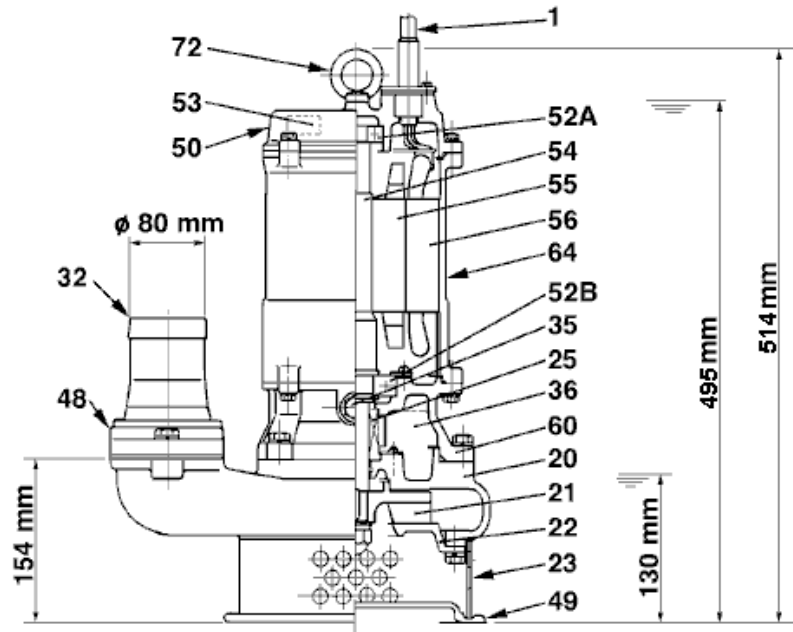
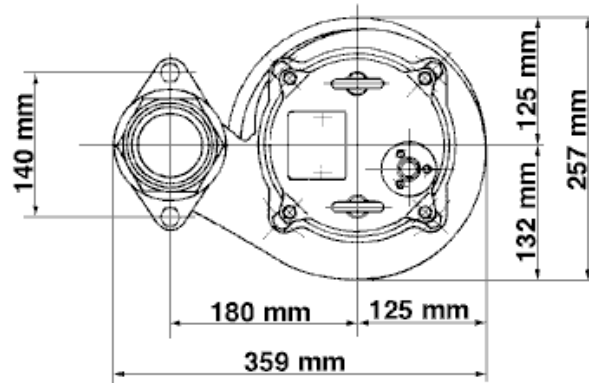

**80SFQ23.7-53**

No.	Description	Remark	No.	Description	Remark
1	Cable	H07RN-F	55	Rotor	.
20	Pump casing	SCS14 (SUS GX5CrNiMo19-11-2)	56	Stator	.
21	Impeller	SCS14 (SUS GX5CrNiMo19-11-2)	60	Bearing Housing	SCS14 (SUS GX5CrNiMo19-11-2)
22	Suction cover	SCS14 (SUS GX5CrNiMo19-11-2)	64	Motor Frame	SCS14 (SUS GX5CrNiMo19-11-2)
23	Strainer	SUS316 (EN-X5CrNiMo17-12-2)	72	Eye screw	SUS316 (EN-X5CrNiMo17-12-2)
25	Mechanical seal	X-25W			
32	Coupling Set	SCS14 (SUS GX5CrNiMo19-11-2)			
35	Oil screw	SUS316 (EN-X5CrNiMo17-12-2)			
36	Lubricant	Turbine oil (ISO VG32)			
48	Screwed Flange	SCS14 (SUS GX5CrNiMo19-11-2)			
49	Bottom Plate	SCS14 (SUS GX5CrNiMo19-11-2)			
50	Motor cover	SCS14 (SUS GX5CrNiMo19-11-2)			
52A	Upper bearing	6304ZZC3			
52B	Lower bearing	6307ZZC3			
53	Motor Protector 380/400/415V	50Hz KA314-HRXL00 (H.C)			
54	Shaft	SUS316 (EN-X5CrNiMo17-12-2)			