

# Data sheet 80C25.5-CR-51

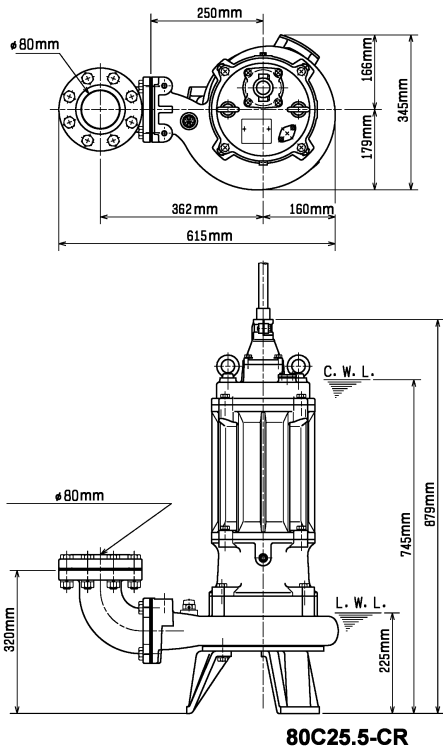

**80C25.5-CR**

CWL: Continuous running water level  
LWL: Lowest running water level

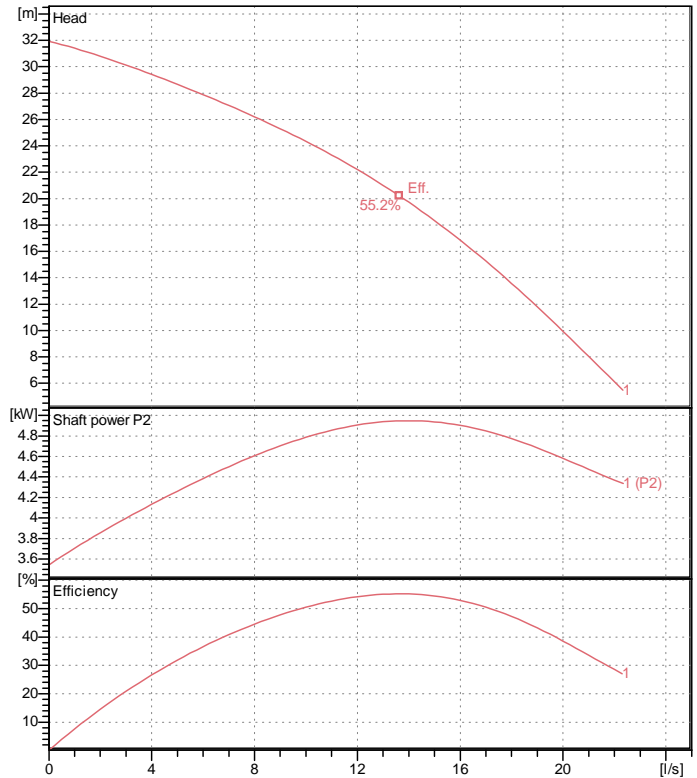

## Specification

Electric submersible pump  
Degree of protection IP 68  
Depth of submersion max. 15 m  
Type of impeller Dual channel impeller  
Free passage 23 mm  
Suitable for:  
sewage water and liquids carrying solids

## Electric motor

Dry-type submersible induction motor  
Insulation class F 2Poles 2945 1/min  
Starting mode Directly  
Rated voltage 400 V 50 Hz 3~  
Power uptake 6.93 kW  
Rated power 5.50 kW  
Rated current 11.6 A  
Start current 85.0 A

## Cable

10m H07RN-F 4Cx2,5mm<sup>2</sup>

## Motor Protection

Circle thermal protector  
(snap-action bi-metal device)

## Shaft seal

Double inside mechanical seal in oil bath  
additional lubrication by oil lifting device

Primary seal  
Silicon carbide on silicon carbide  
Secondary seal  
Silicon carbide on silicon carbide

## Bearings

Shielded ball bearings, maintenance-free

## Materials

Impeller  
Chromium Iron HiCrFC + Tungsten Carbide  
Pump casing FC200 (EN-GJL-200)  
Suction cover Chromium Iron HiCrFC  
Motor Frame FC200 (EN-GJL-200)  
Shaft SUS420J2 (EN-X30Cr13)

## Discharge size

3" (80mm) special screwed-in mating flange  
guide rail fitting optional

## Weight

125 kg (dry weight of the pump only without cable)

# Performance curve

## 80C25.5-CR-51

Discharge port	3"
Head	31.9 m
Flow	22.3 l/s
Rated power	5.50 kW
Power input	6.93 kW
Phases	3~
Voltages	400 V
Frequency	50 Hz
Rated current	11.6 A
Starting current	85.03 A
Number of poles	2
Speed	2945 1/min
Starting mode	Directly
Insulation class	F

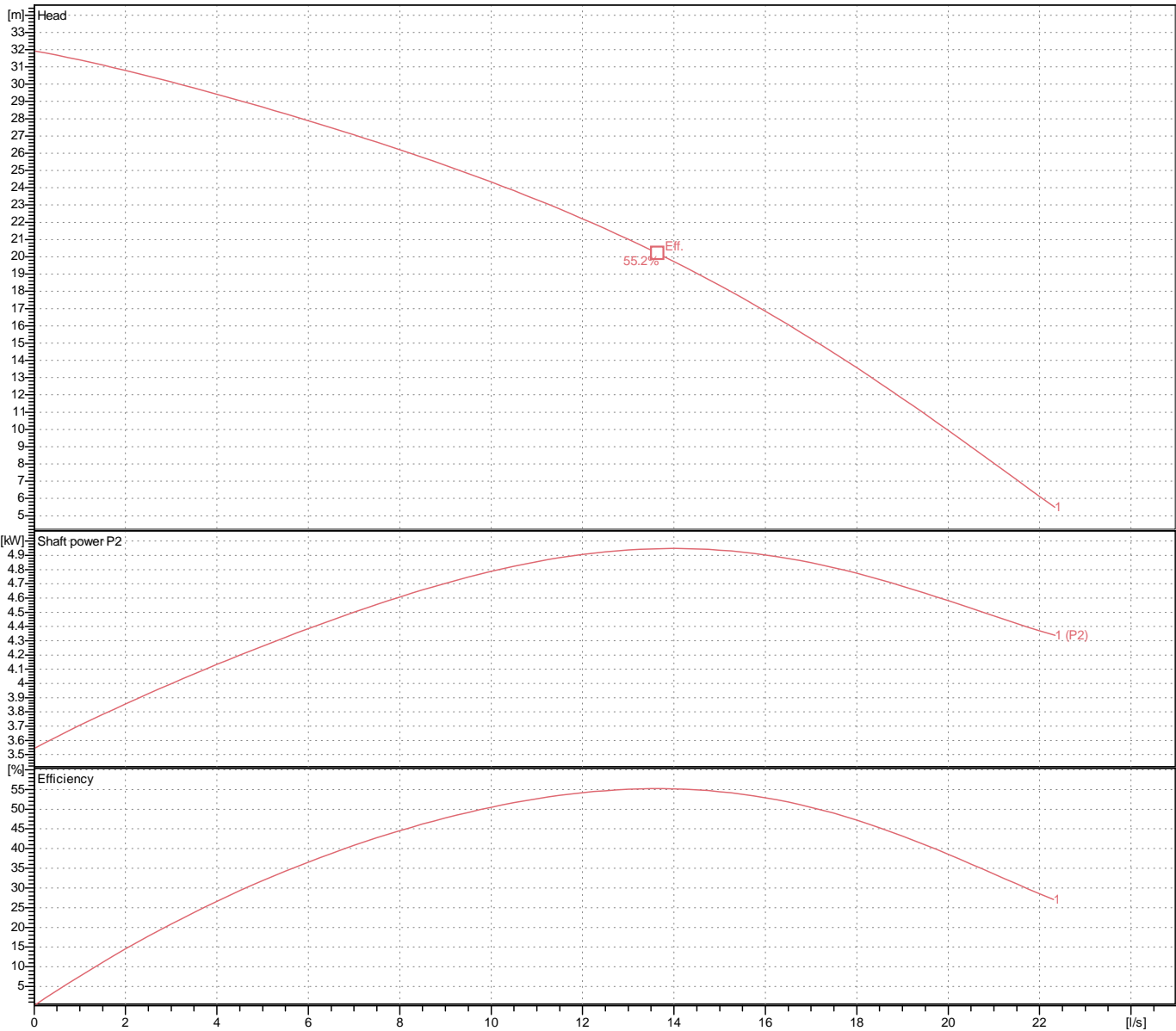

# Dimensions 80C25.5-CR-51

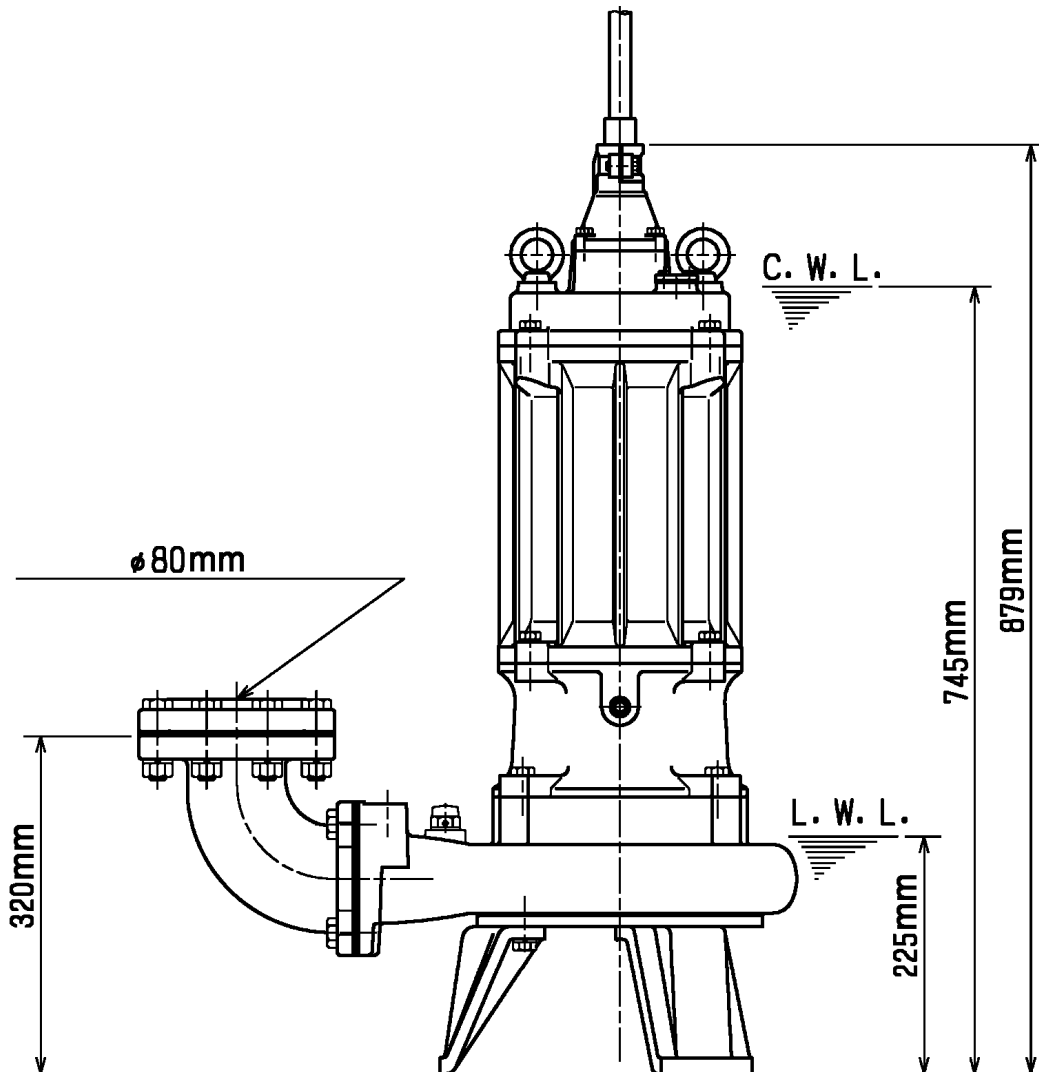
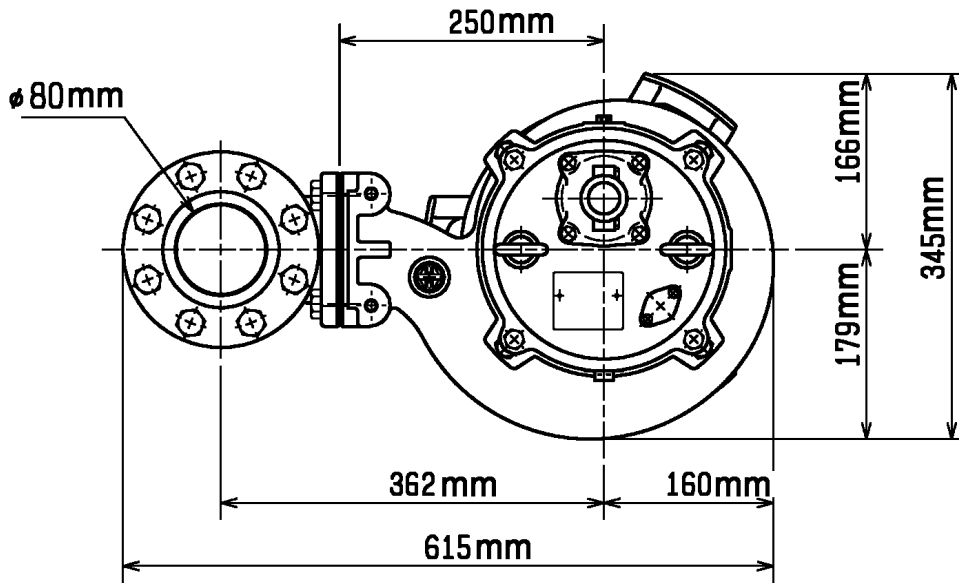

**80C25.5-CR**

CWL: Continuous running water level  
LWL: Lowest running water level

 **TSURUMI PUMP**

Tsurumi Europe GmbH  
17.10.2018 V.18 / 1.10.2015

Heltorfer Str. 14 \* 40472 Düsseldorf \* Germany  
Tel.: +49-211-4179373 sales@tsurumi.eu  
Fax: +49-211-417937-480 www.tsurumi.eu

# Sectional drawing 80C25.5-CR-51

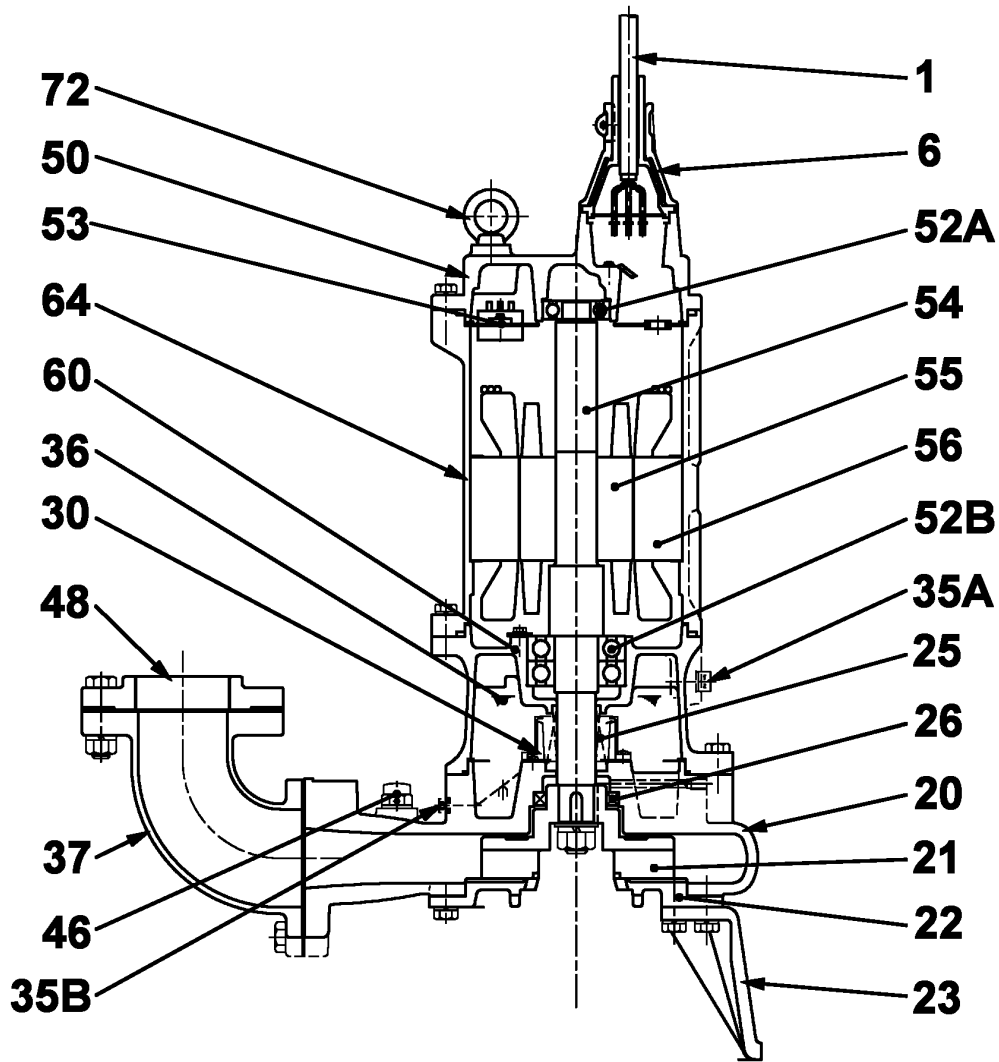

**80C25.5-CR**

No.	Description	Remark	No.	Description	Remark
1	Cable	H07RN-F	53	Motor Protector 380/400/415V-50Hz KA314-HRXL00 (H.C)	
6	Stuffing box	FC200 (EN-GJL-200)	54	Shaft	SUS420J2 (EN-X30Cr13)
20	Pump casing	FC200 (EN-GJL-200)	55	Rotor	.
21	Impeller	Chromium Iron HiCrFC + Tungsten Carbide	56	Stator	.
22	Suction cover	Chromium Iron HiCrFC	60	Bearing Housing	FC200 (EN-GJL-200)
23	Stand support (3x)	FC200 (EN-GJL-200)	64	Motor Frame	FC200 (EN-GJL-200)
25	Mechanical seal	H-30	72	Eye screw (2x)	Construction steel SS400
26	Oil seal	TC557812			
35A	Oil screw	SUS304 (EN-X5CrNi18-10)			
35B	Oelschraube.	SUS304 (EN-X5CrNi18-10)			
36	Lubricant	Turbine oil (ISO VG32)			
37	Discharge bend	FC200 (EN-GJL-200)			
46	Air vent screw	Nylon			
48	Screwed Flange	FC200 (EN-GJL-200)			
52A	Upper bearing	6305ZZC3			
52B	Lower bearing	6308ZZD2C3			