

50TMA2.4-53

2023-01-23

Pos.no	Item no.	Description	Qty.
--------	----------	-------------	------

50TMA2.4-53

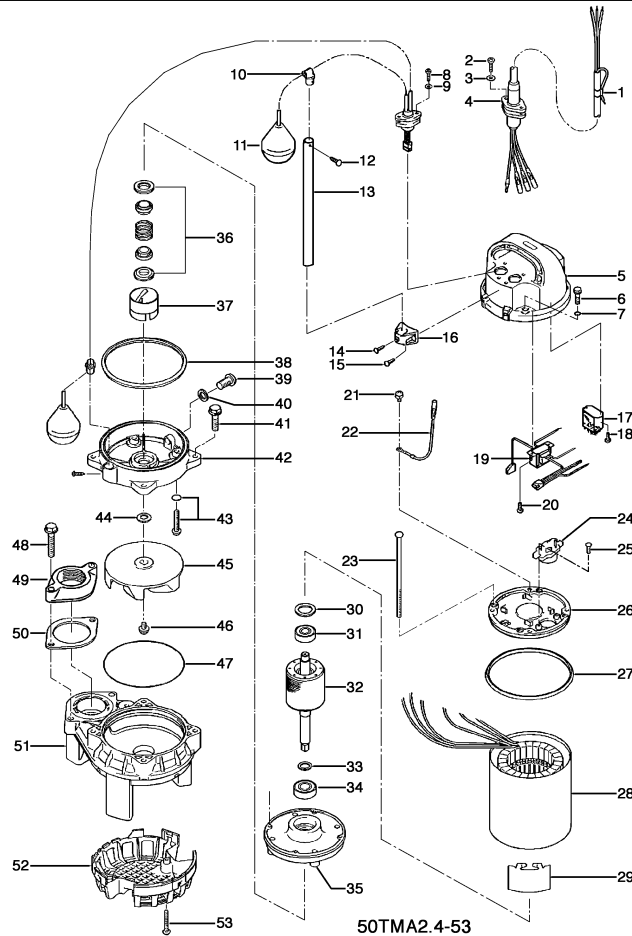

Pos.no	Item no.	Description	Qty.
1.1.1	173-000-07	Packing & O-Ring Set	1
1	001-912-23	Cable Set (6m) 220V-60HZ(TWN) VCT4Cx1.25mm2 LBT	1
2	143-000-37	Hex.Tapping Screw M5x20 Titanium	2
3	142-357-11	Plain Washer d5xd12x0.8t Titanium	2
4	003-100-26	Gland Titanium	1
5	051-000-03	Head Cover Resin	1
6	140-000-15	Hex.Bolt (w/Plain Washer) M6x30(22L) Titanium	4
7	122-004-18	O-Ring P-6 NBR	4
8	143-105-28	Tapping Screw M5x20 Titanium	2
9	142-357-11	plain Washer d5xd12x0.8t Titanium	2
10	109-129-19	Float Support Bush d14 Rubber	2
11	106-484-16	Float Set AOT2-2	1
12	143-143-28	Tapping Truss Screw M4x16(D=8) Titanium	2
13	109-000-01	float Support Pipe VP-14x250L(w/Hole, Black) VP	1
14	143-143-28	Tapping Truss Screw M4x16(D=8) Titanium	1
15	143-174-15	Tapping Screw (w/Plain Washer) M4x14 SUS304 (EN X5CrNi18-10) Stainless Steel	2
16	109-000-20	Holder Resin	1
17	115-	Transformer (230V-50HZ)	1
18	143-152-17	Tapping Truss Screw M3x8 SWCH	2
19	115-000-08	Transformer T200/20	1
20	143-152-17	Tapping Truss Screw M3x8 SWCH	2
21	143-085-34	pan Screw (w/Spring Washer) M4x6 C3604 (EN CuZn39Pb3)	1
22	009-000-01	Earth Terminal 2mm2x195L	1
23	143-000-04	pan Screw M5x118(20L) SWRM	4
24	053-446-19	Motor Protector 200/220V-60HZ KA311-DAVL66 (T)	1
25	143-136-15	Truss Screw M4x10 SWRM	2
26	050-000-02	Motor Bracket ADC	1
27	121-471-17	packing d126.6xd135.6x6t NR	1
28	056-000-42	Stator (w/M. Frame)	1
29	071-000-01	Collar 37L SECC	1
30	142-192-16	Wave Washer 6201(D=32,t=0.4) SK5	1
31	052-100-15	Bearing 6201ZZC3	1
32	055-000-26	Rotor	1
33	061-157-15	Bearing Collar d15.1xd21x1.6t Kaltgewalztes BlechC	1
34	052-101-16	Bearing 6202ZZC3	1
35	060-000-03	Bearing Housing ADC	1
36	025-000-78	Mechanical Seal W-14HC SSIC	1
37	030-000-01	Oil Lifter VANCS2 Type Resin	1
38	121-001-12	packing For VANCS2 NBR	1
39	035-128-16	Oil Plug M10x15 Titanium	1

50TMA2.4-53

Kontroll-Nr. --

2023-01-23 V.01.02.2022

Pos.no	Item no.	Description	Qty.
40	121-246-11	Packing (Oil Plug) d10.3xd16x2t PE	1
41	140-000-11	Hex.Bolt (w/Plain Washer) M6x25 Titanium	4
42	029-000-01	Oil Casing VANCS2 Type Resin	1
43	143-000-08	Truss Screw (w/O-Ring) M6x20(P-5,NBR) Titanium	4
44	142-360-17	Impeller Fixing Washer d11.2xd22.5x0.8t Titanium	1
45	021-G28-21	Impeller Resin PPO+GF20	1
46	143-140-25	Truss Screw (w/Plain Washer) M6x12 Titanium	1
47	122-000-07	O-Ring 122xd3.0 NBR	1
48	140-000-12	Hex.Bolt (w/Plain Washer) M8x45 Titanium	2
49	048-000-07	Screwed Flange 50mm(P.C.90)For Stainless Steel Pump (Resin)	2
50	121-469-12	Packing d90xd58x2t NR	1
51	020-000-07	Pump Casing For (40/50)TM.25/.4/.75 Resin	1
52	023-000-01	Strainer (40/50)PN/TM/TQ2.25/.4/.75 Resin	1
53	143-000-11	Tapping Truss Screw M4x18 Titanium	2
	173-000-07	Packing & O-Ring Set	1
	##whiteoilVG32	ml White Oil ISO VG32	250