

50TM2.75-53

2023-01-23

| Pos.no | Item no. | Description | Qty. |
|--------|----------|-------------|------|
|--------|----------|-------------|------|

50TM2.75-53

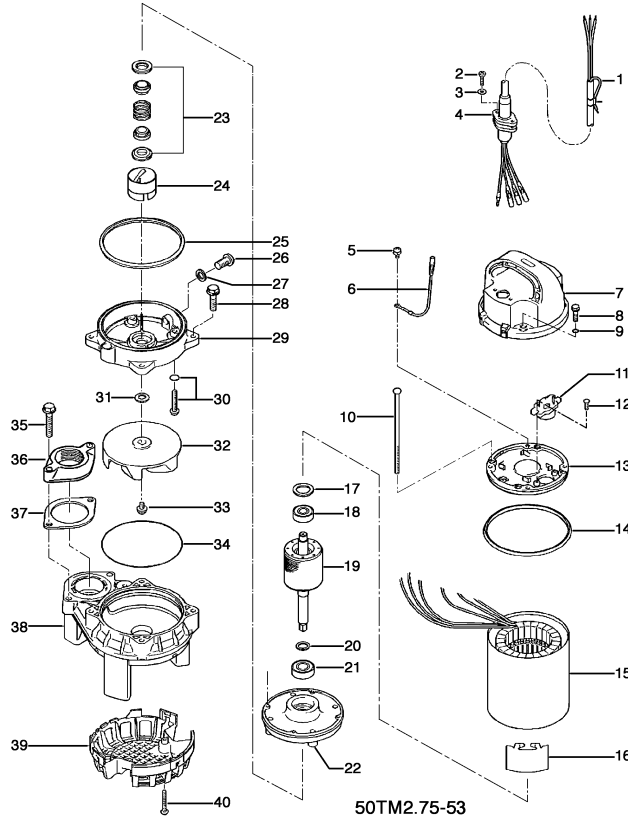

| | | | |
|-------|------------|--|---|
| 1.1.1 | 173-000-07 | Packing & O-Ring Set | 1 |
| 1 | 001-009-18 | Cabletyre Cable Set (10m)380/400/415V-50Hz NSSHOEU-J 4Gx1,5mm2 | 1 |
| 2 | 143-000-37 | Hex.Tapping Screw M5x20 Titanium | 2 |
| 3 | 142-357-11 | Plain Washer d5xd12x0.8t Titanium | 2 |
| 4 | 003-100-26 | Gland Titanium | 1 |
| 5 | 143-085-34 | Pan Screw (w/Spring Washer) M4x6 C3604 (EN CuZn39Pb3) | 1 |
| 6 | 009-187-12 | Earth Terminal 1.25mm2x150L | 1 |
| 7 | 051-000-46 | Head Cover Resin | 1 |
| 8 | 140-000-15 | Hex.Bolt (w/Plain Washer) M6x30(22L) Titanium | 4 |
| 9 | 122-004-18 | O-Ring P-6 NBR | 4 |
| 10 | 143-000-07 | pan Screw M5x132(20L) SWRM | 4 |
| 11 | 053-283-16 | Motor Protector 220V-50HZ KA311-DPXL63 (T) | 1 |
| 12 | 143-136-15 | Truss Screw M4x10 SWRM | 2 |
| 13 | 050-000-02 | Motor Bracket ADC | 1 |
| 14 | 121-471-17 | Packing d126.6xd135.6x6t NR | 1 |
| 15 | 056- | Stator | 1 |
| 16 | 071-000-01 | Collar 37L SECC | 1 |
| 17 | 142-192-16 | Wave Washer 6201(D=32,t=0.4) SK5 | 1 |
| 18 | 052-100-15 | Bearing 6201ZZC3 | 1 |
| 19 | 055-000-27 | Rotor | 1 |
| 20 | 061-157-15 | Bearing Collar d15.1xd21x1.6t Kaltgewalztes BlechC | 1 |
| 21 | 052-001-06 | Bearing 6302ZZC3 | 1 |
| 22 | 060-000-04 | Bearing Housing ADC | 1 |
| 23 | 025-000-78 | Mechanical Seal W-14HC SSIC | 1 |
| 24 | 030-000-01 | Oil Lifter VANCs2 Type Resin | 1 |
| 25 | 121-001-12 | packing For VANCs2 NBR | 1 |
| 26 | 035-128-16 | Oil Plug M10x15 Titanium | 1 |
| 27 | 121-246-11 | packing (Oil Plug) d10.3xd16x2t PE | 1 |
| 28 | 140-000-11 | Hex.Bolt (w/Plain Washer) M6x25 Titanium | 4 |
| 29 | 029-000-01 | Oil Casing VANCs2 Type Resin | 1 |
| 30 | 143-000-08 | Truss Screw (w/O-Ring) M6x20(P-5,NBR) Titanium | 4 |
| 31 | 142-360-17 | Impeller Fixing Washer d11.2xd22.5x0.8t Titanium | 1 |
| 32 | 021-G29-22 | Impeller (50Hz) 50Hz Resin | 1 |
| 33 | 143-140-25 | Truss Screw (w/Plain Washer) M6x12 Titanium | 1 |
| 34 | 122-000-07 | O-Ring 122xd3.0 NBR | 1 |
| 35 | 140-000-12 | Hex.Bolt (w/Plain Washer) M8x45 Titanium | 2 |
| 36 | 048-000-07 | Screwed Flange 50mm(P.C.90)For Stainless Steel Pump (Resin) | 2 |
| 37 | 121-469-12 | packing d90xd58x2t NR | 1 |
| 38 | 020-000-07 | pump Casing For (40/50)TM.25/.4/.75 Resin | 1 |
| 39 | 023-000-01 | Strainer (40/50)PN/TM/TQ2.25/.4/.75 Resin | 1 |

50TM2.75-53

Kontroll-Nr. --

2023-01-23 V.01.02.2022

| Pos.no | Item no. | Description | Qty. | |
|--------|---|---|---------------|--|
| 40 | 143-000-11 173-000-07 #whiteoilVG32 | Tapping Truss Screw M4x18 Titanium Packing & O-Ring Set ml White Oil ISO VG32 | 2 1 250 | |
| | | | | |