

Data sheet 100C47.5-53

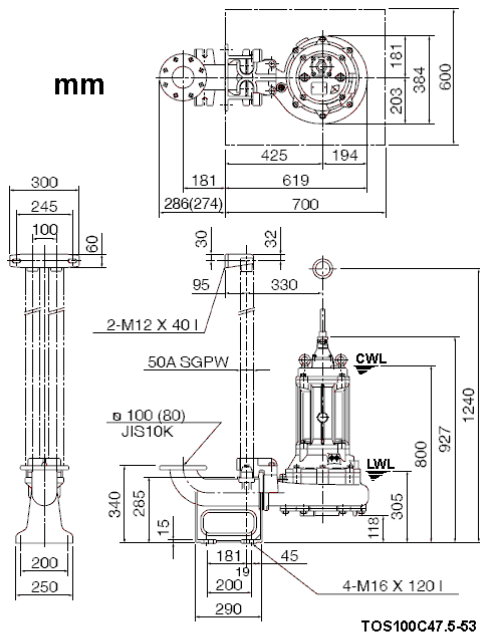

CWL: Continuous running water level
LWL: Lowest running water level

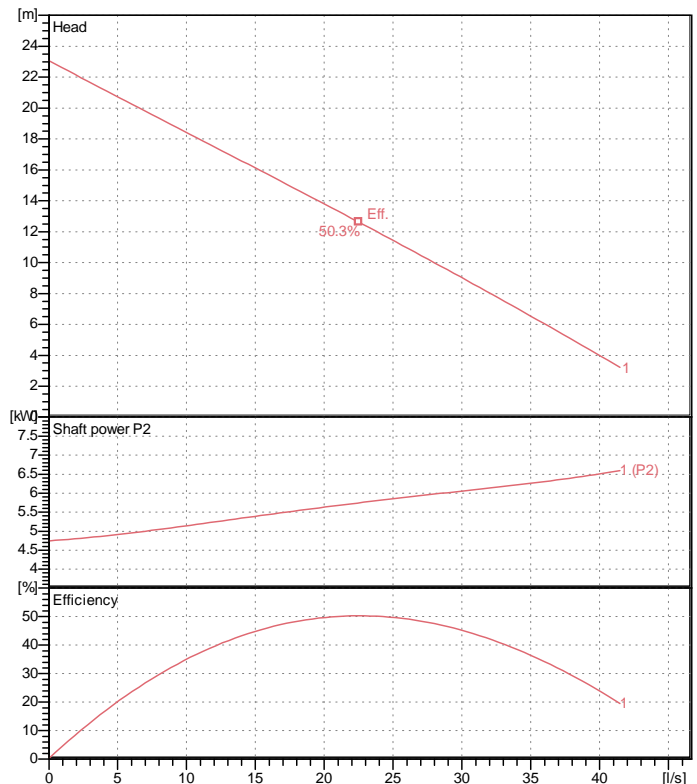

Specification

Electric submersible pump with cutter mechanism
Degree of protection IP 68
Depth of submersion max. 15 m
Type of impeller Single channel impeller
Free passage 40 mm
Suitable for:
sewage water and liquids carrying solids

Electric motor

Dry-type submersible induction motor
Insulation class F 4Poles 1455 1/min
Starting mode Directly
Rated voltage 400 V 50 Hz 3~
Power uptake 9.16 kW
Rated power 7.50 kW
Rated current 15.9 A
Start current 89.0 A

Cable

10m H07RN-F 4Cx4mm²

Motor Protection

Miniature protector in windings
(snap-action bi-metal device)

Shaft seal

Double inside mechanical seal in oil bath
additional lubrication by oil lifting device

Primary seal

Silicon carbide on silicon carbide

Secondary seal

Silicon carbide on silicon carbide

Bearings

Shielded ball bearings, maintenance-free

Materials

Impeller

FC20 (EN-GJL-200) + Tungsten carbide

Pump casing

FC200 (EN-GJL-200)

Suction cover

FCD700 (EN-GJS-700-2)

Motor Frame

FC200 (EN-GJL-200)

Shaft

SUS403 (EN-X6Cr13)

Discharge size

4" (100mm) JIS 10K screwed-in mating flange
guide rail fitting optional

Weight

152 kg (dry weight of the pump only without cable)

Performance curve

100C47.5-53

Discharge port	4"
Head	23.1 m
Flow	41.5 l/s
Rated power	7.50 kW
Power input	9.16 kW
Phases	3~
Voltages	400 V
Frequency	50 Hz
Rated current	15.9 A
Starting current	89.04 A
Number of poles	4
Speed	1455 1/min
Starting mode	Directly
Insulation class	F

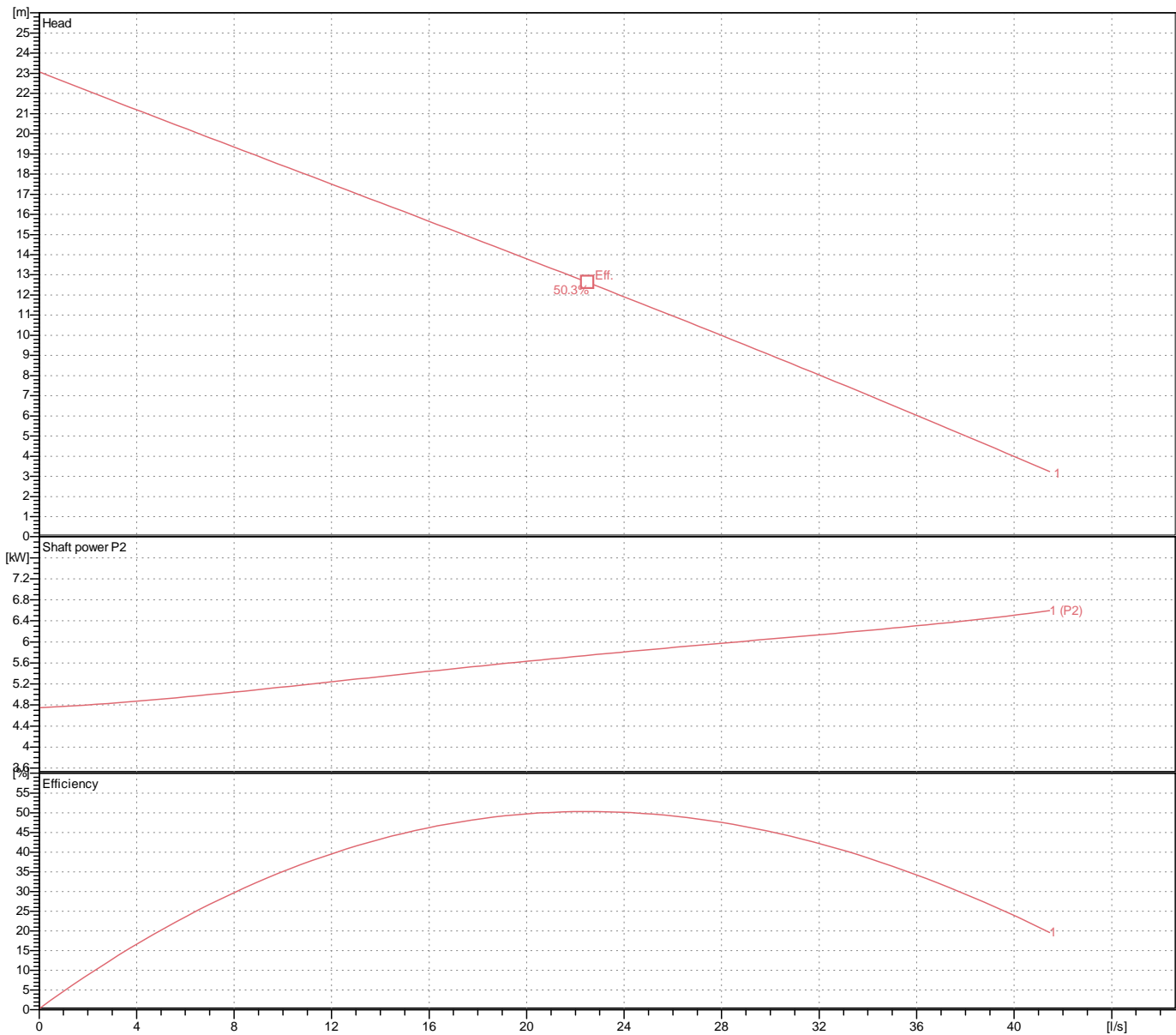

Dimensions TOS100C47.5-53

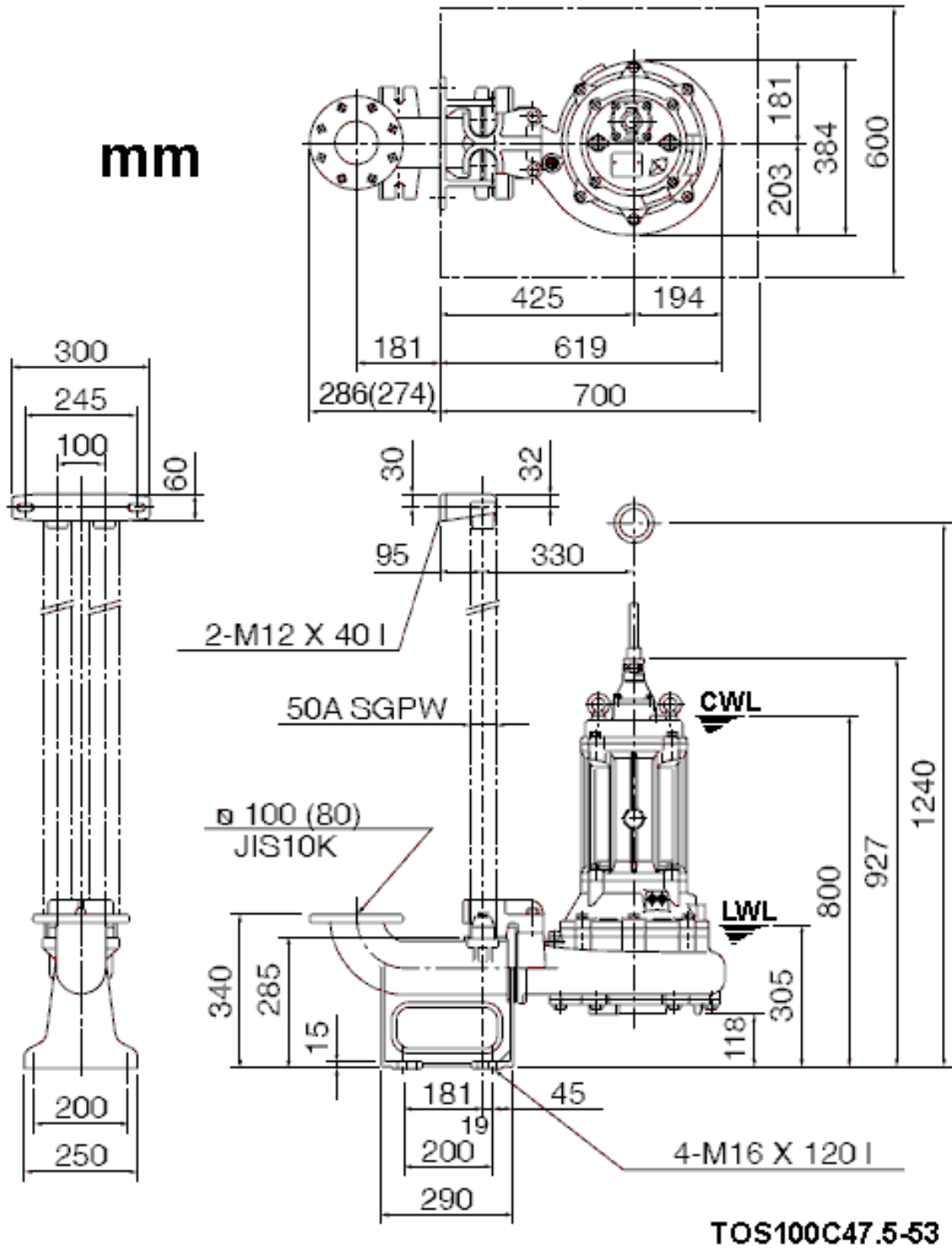

TOS100C47.5-53

CWL: Continuous running water level
LWL: Lowest running water level



Tsurumi Europe GmbH
17.10.2018 V.18 / 1.10.2015

Heltorf Str. 14 * 40472 Düsseldorf * Germany
Tel.: +49-211-4179373 sales@tsurumi.eu
Fax: +49-211-417937-480 www.tsurumi.eu

Sectional drawing TOS100C47.5-53

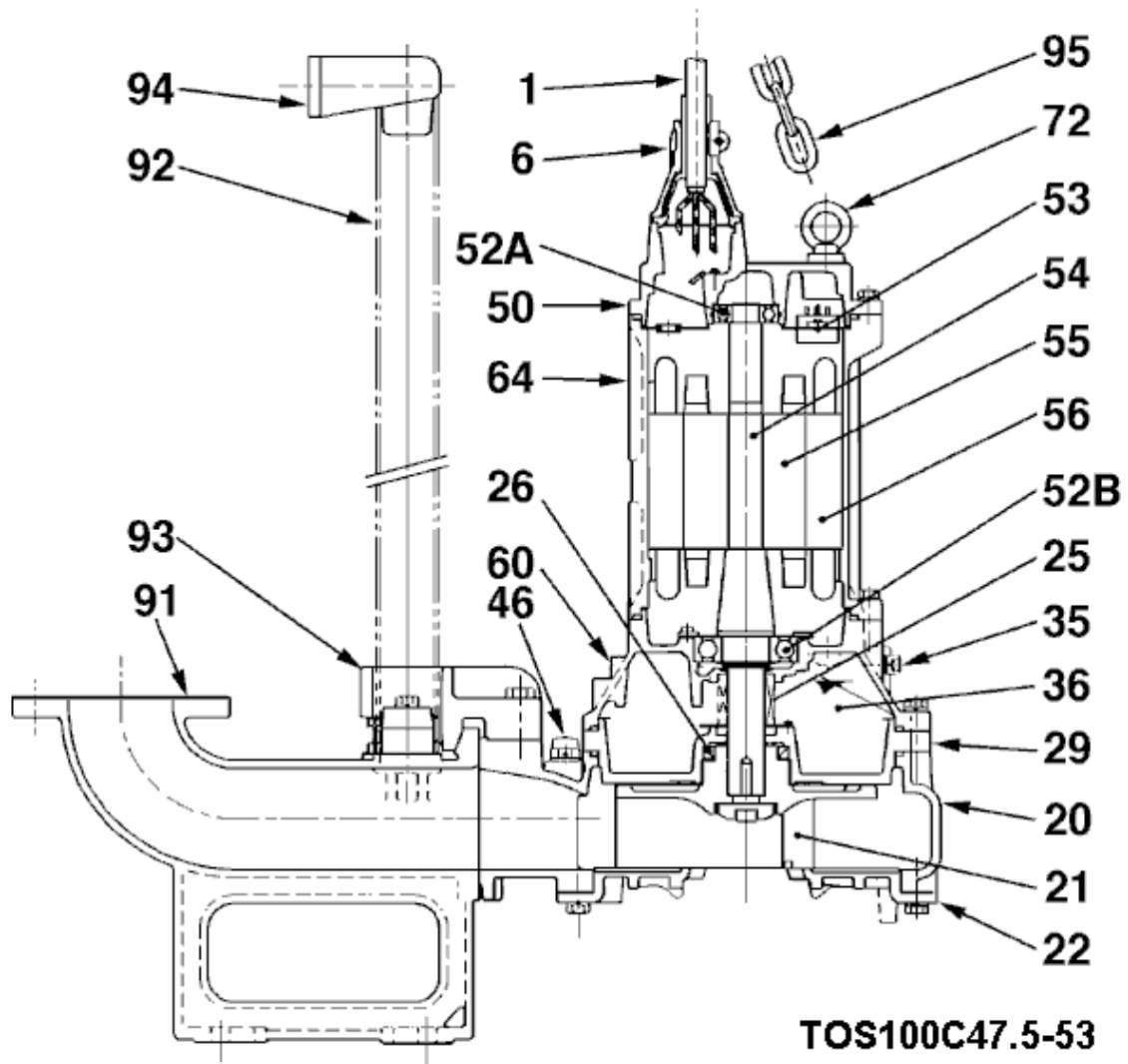

TOS100C47.5-53

No.	Description	Remark	No.	Description	Remark
1	Cable	10m H07RN-F 4Cx4mm ²	55	Rotor	.
6	Stuffing box	FC200 (EN-GJL-200)	56	Stator	.
20	Pump casing	FC200 (EN-GJL-200)	60	Bearing Housing	FC200 (EN-GJL-200)
21	Impeller	FC20 (EN-GJL-200) + Tungsten carbide	64	Motor Frame	FC200 (EN-GJL-200)
22	Suction cover	FCD700 (EN-GJS-700-2)	72	Eye screw (2x)	Construction steel SS400
25	Mechanical seal	H-35A	91	duck foot bend	FC200 (EN-GJL-200)
26	Oil seal	TC608212	92	Guide pipe (option) (2x)	Steel pipe
29	Oil casing	FC200 (EN-GJL-200)	93	guide support	FCD45 (EN-GJS-450-10)
35	Oil screw (2x)	SUS304 (EN-X5CrNi18-10)	94	Guide pipe holder	FCD45 (EN-GJS-450-10)
36	Lubricant	Turbine oil (ISO VG32)	95	Chain	Construction steel SS400
46	Air vent screw	Nylon			
50	Motor cover	FC200 (EN-GJL-200)			
52A	Upper bearing	6306ZZC3			
52B	Lower bearing	6309ZZC3			
53	Motor Protector 380/400/415V	50Hz KA314-HRXL00 (H.C)			
54	Shaft	SUS403 (EN-X6Cr13)			