



Performance Shortram Air Intake Kit

Part Number: 827-685

**2000-2005 Volkswagen Jetta 1.8L Turbo
2000-2005 Volkswagen Golf GTI 1.8L Turbo**

Installation Instructions

For technical inquiries please email us at tech@hpsperformanceproducts.com

In the email, please include the following information for faster response:

- Year / Make / Model / Engine of your vehicle.
- If it is a fitment issue, please include pictures showing the fitment problem.
- If there are missing parts, please list the part number(s) from the bill of materials on the 2nd page.
- Optional but recommended – Your contact phone number and preferred call back time.

You can also give us a call via 626-747-9200 for tech support Monday-Friday, 9:00am-5:00pm Pacific Time.

Bill of Materials

Kit Number: 827-685

Description	Prep	Part Number	Qty	Check
Air Intake Pipe	1	529-514	1	
Heat Shield	2	531-593	1	
Heat Shield Bracket #1	3	530-513	1	
Heat Shield Bracket #2	3	530-514	1	
HPS Breather Air Filter	4	HPS-4330	1	
HPS Performance Air Filter	4	HPS-4275	1	
2.75" Straight Coupler x 2.50" Long	5	P3SC-275-L25	1	
T-Bolt Clamp for 2.75" Hose	5	SSTC-73-81	2	
M6 Bolt x 12mm long	5	HW-B6-12	1	
M6 Bolt x 16mm long	5	HW-B6-16	4	
6mm Flange Nut	5	HW-N6	5	
M6 Flat Washer x 16mm OD	5	HW-FW6L	10	
Rubber Vibration Mount M6 x 1/2" Tall	5	HW-RM6-50	1	
Breather Filter Adapter	5	CNC-MK4-05	1	

- Before installing any parts of this intake system, please read the instructions thoroughly.
- Verify the contents of this intake kit before disassembling your vehicle.
- Report any defective or missing parts to HPS directly. The HPS dealer you purchased this product from might not have the replacement parts you need.
- Installation requires moderate mechanical skills. A qualified mechanic is highly recommended.
- Do not attempt to install the intake system while the engine is hot.
- This installation may require removal of coolant lines that may be hot.
- For technical inquiries, please e-mail us at tech@hpsperformanceproducts.com

PLEASE READ CAREFULLY BEFORE INSTALLATION!

This installation is not for the novice customer. Install this product with EXTREME caution! Misuse of this product can destroy your engine! If you are not mechanically inclined, please have a professional automotive mechanic install this kit.

NOTE: HPS holds no responsibility for any engine damage that results from misuse of this product.

GETTING STARTED

NOTE: Disconnecting the negative battery cable erases pre-programmed electronic memories. Write down all memory settings before disconnecting the negative battery cable. Some radios will require an anti-theft code to be entered after the battery is reconnected. The anti-theft code is typically supplied with your owner's manual. In the event your vehicles' anti-theft code cannot be recovered, contact an authorized dealership to obtain your vehicles anti-theft code. We also highly recommend NOT discarding any stock parts after the installation.

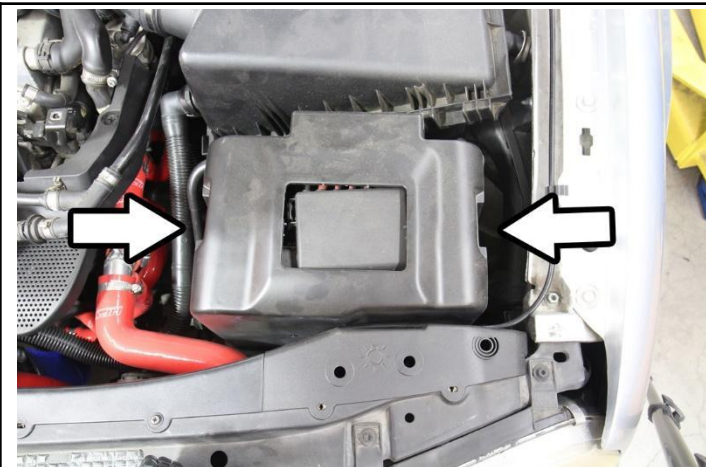

1. Push the tabs on the side of the battery cover and remove it from the vehicle, then disconnect the negative battery terminal.

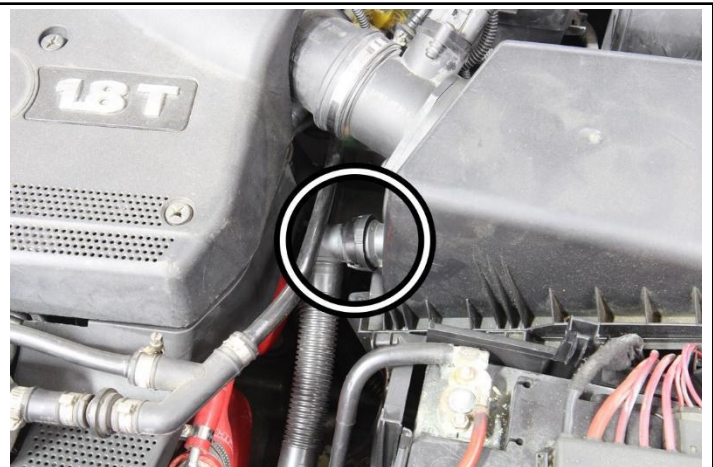

2. Disconnect the air pump vent hose from the air box.

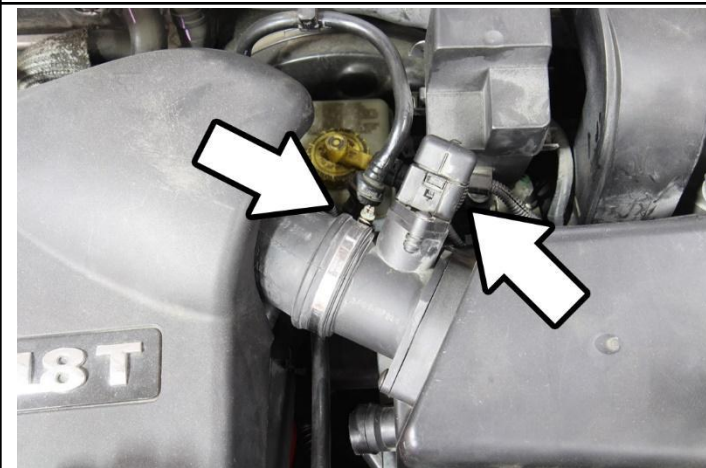

3. Disconnect the mass air flow sensor harness connector from the MAF sensor. Loosen the hose clamp securing the factory intake tube from the MAF sensor housing.

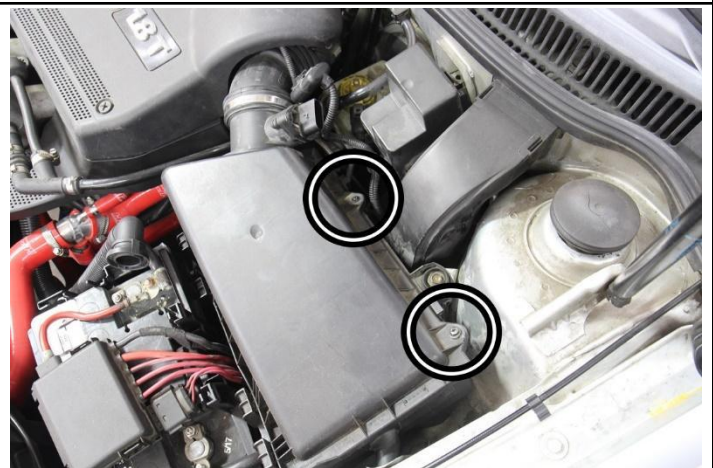

4. Loosen the two screws securing the upper air box assembly.



5. Remove the upper air box assembly from the vehicle.

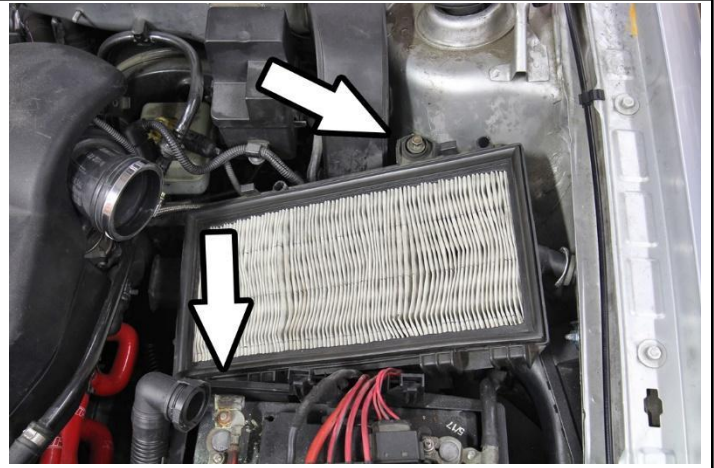

6. Remove the two 10mm bolts securing the lower air box assembly and remove the air box from the vehicle.



7. Loosen the screws securing the MAF sensor housing to disconnect it from the upper air box.

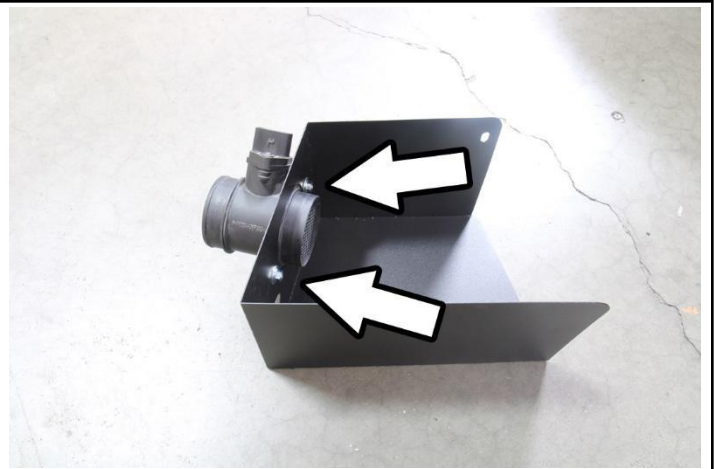

8. Attach the factory MAF sensor housing onto the provided heat shield using the M6x16mm bolts, nuts, and washers.

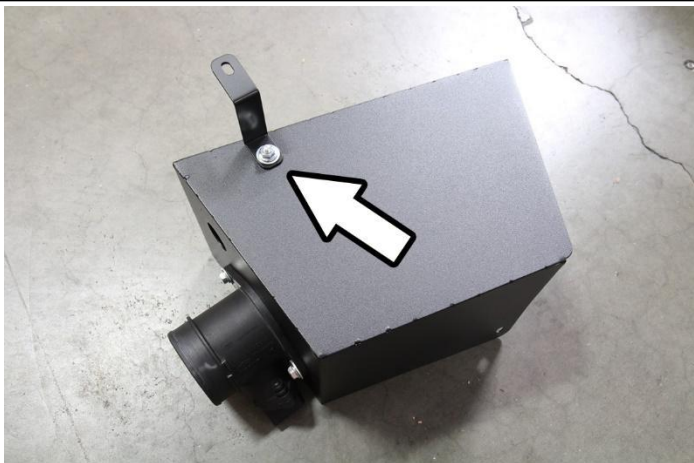

9. Attach and secure the short side of the "Z" bracket on the bottom of the heat shield using the provided M6x16mm bolt, nut and washer.

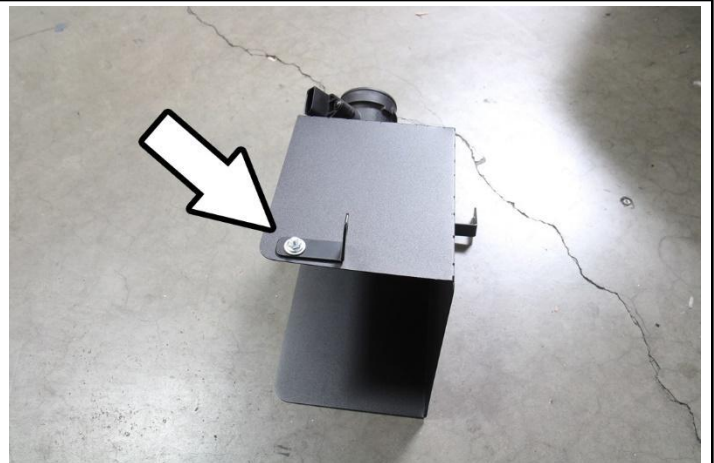

10. Attach and secure the long side of the "L" bracket to the side of the heat shield using the provided M6x16mm bolt, nut and washer.



11. Insert the provided vibration mount onto the factory air box mount.



12. Re-insert and secure the MAF sensor housing back into the factory intake tube.

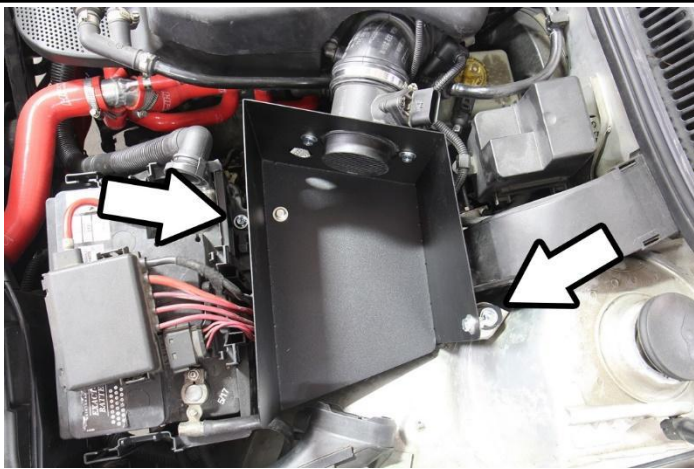

13. Align and secure the brackets onto the vibration mount and the lower air box mounting slot. Use the provided M6x12mm bolt and washer to secure the bracket near the battery. Use the provided nut and washer to secure the bracket to the vibration mount.

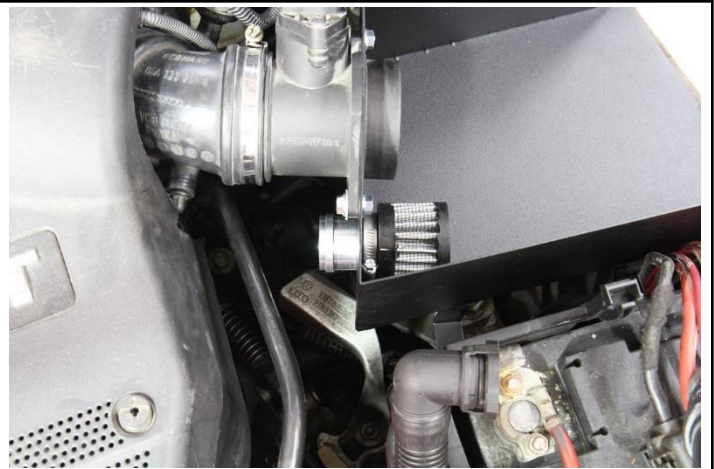

14. Insert the air pump vent hose adapter into the heat shield and secure the adapter using the provided breather air filter.

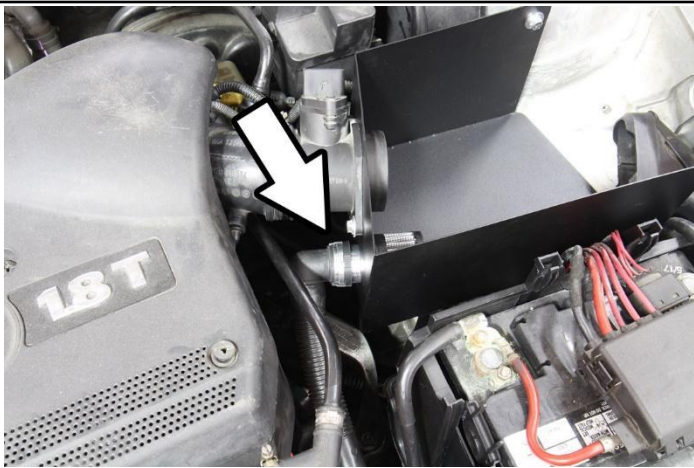

15. Attach the air pump vent hose onto the adapter.

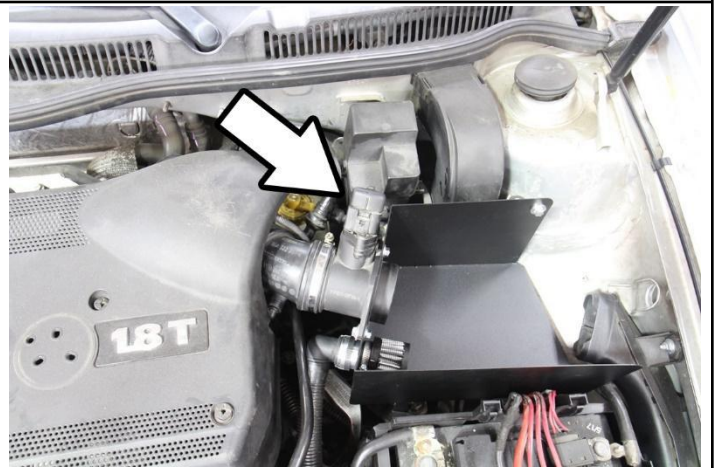

16. Re-connect the MAF sensor harness connector.



17. Install the 2.75" coupler onto the MAF housing along with the provided T-bolt clamps.



18. Insert the HPS performance air filter onto the HPS intake pipe.



19. Insert and secure the HPS intake pipe into the coupler.



20. Re-connect the negative battery terminal and install the battery cover.

Final Steps

Once the intake has been positioned, tighten all of the clamps and secure all of the parts.

Upon completion of the installation, reconnect the negative battery terminal before you start the engine. Double check to make sure everything is tight and properly positioned before starting the vehicle.

Start the engine. Let the car idle for 3 minutes. Perform a final inspection before driving. Listen carefully for any odd noises, rattles and/or air leaks prior to taking it for a test drive. If any problems arise go back and check the vacuum lines, hoses and clamps that may be causing leaks or rattles and correct the problem.

Periodically, recheck the alignment of the intake system and make sure there is proper clearance around and along the length of the intake. Failure to follow proper maintenance procedures may cause damage to the intake and will void the warranty.

HPS Performance Air Intake Kit with Heat Shield (827 Series)
2000-2005 Volkswagen GTI / Jetta 1.8T MK4
Part Number: 827-685

Maximum Horsepower Gains = 7.8 whp @ 5900 rpm

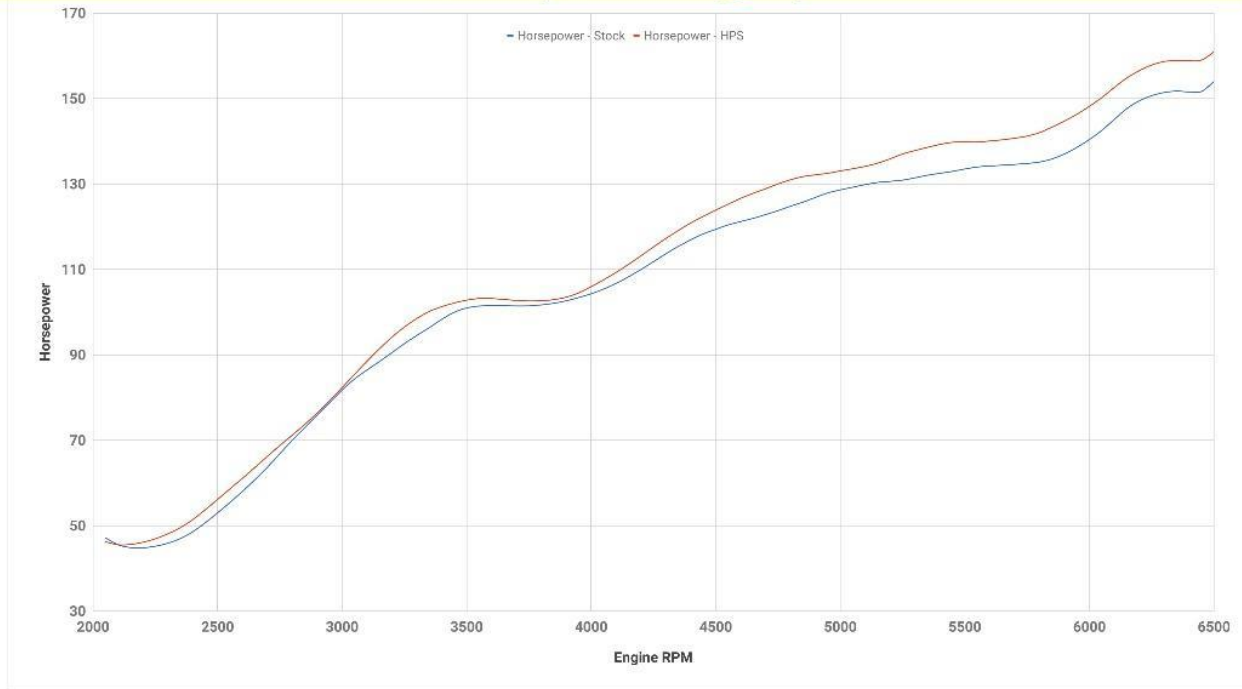

HPS Performance Air Intake Kit with Heat Shield (827 Series)
2000-2005 Volkswagen GTI / Jetta 1.8T MK4
Part Number: 827-685

Maximum Torque Gains = 7 ft/lb @ 4750 rpm

