

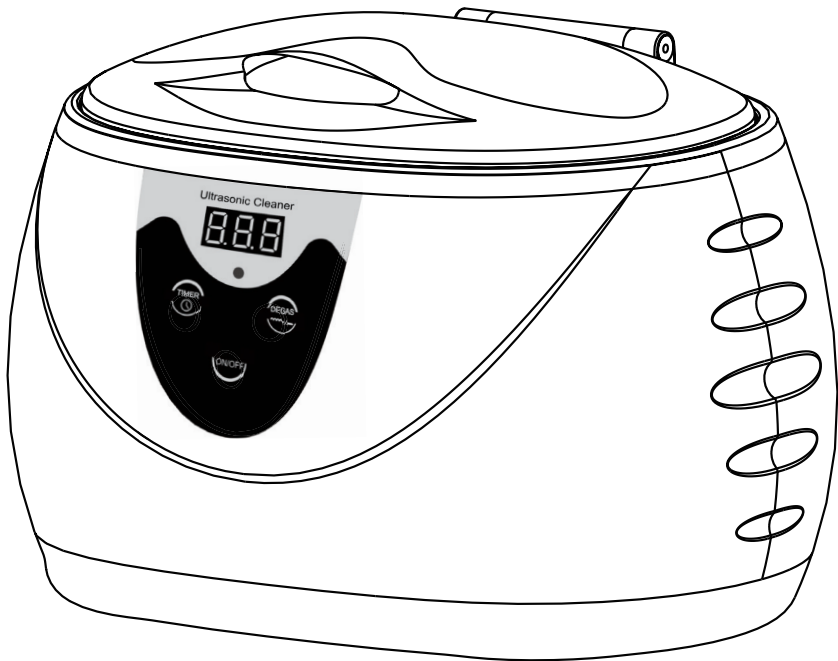

» UKOKE *Ultrasonic Cleaner*

3800 S/T Instruction Manual



Application:

Cleaner for jewelry, glass, dentures, eyeglasses, watches, coins, lab instruments and more.





Product Introduction

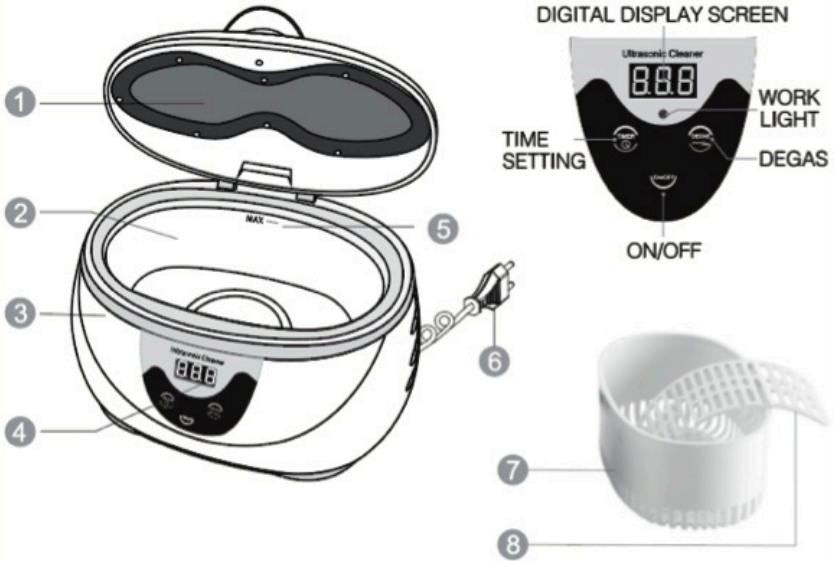

- | | | |
|------------------|------------------------|--------------|
| ① LID | ② STAINLESS STEEL TANK | ③ HOUSING |
| ④ CONTROL PANEL | ⑤ MAX.MARK | ⑥ POWER CORD |
| ⑦ PLASTIC BASKET | ⑧ WATCH STAND | |

Specifications:

Name: Ultrasonic Cleaner

Power Supply:

AC 100 - 120V 60 Hz

Model: 3800 S/T | **Power:** 35W

Overall Size: 210x145x140mm

Frequency: 40KHz

Tank Size: 155x95x52mm | **Time Setting:** 0 - 8 min | **Volume:** 600ml | **G.W:** 980 +_ 5g





Available For



Glasses and Watch

Glasses, Sun Glasses, Watch Chains, Waterproof Watches and etc.

Daily Used

Electric Shaver Heads, Razor Blades, Dentures, Combs, Toothbrushes and etc.

Metal Dishware

Forks, Knives, Spoons, and etc.

Jewelry

Necklaces, Rings, Earrings, Bracelets, and etc.

Metal Articles

Watch Parts, Ancient Coins, Badges, Machine Nozzles and etc.

Stationary

Penheads, Printers-heads, Inkjet Cartridges, Seals, etc.

Dirt Elimination Process Through Ultrasonic Technology

- Cleaning effect will be more efficient if using the machine together with proper solvent.

During the high pressure stage, the bubbles implode releasing enormous amounts of energy. They work in all directions, attacking surface and invading all recesses and openings.

As the sound waves from the transducer radiate through the solution in the tank, they cause alternating high and low pressures in the solution.

During the low pressure stage, millions of microscopic bubbles form and grow. This process is called "CAVITATION".





4 Ways of Cleaning



1 General Cleaning

Use warm tap water for general cleaning. The item should be immersed in the water completely, not to exceed the "MAX" mark.



2 Enhanced Cleaning

Add a few drops of detergent or non-corrosive detergent or cleaning solution (ie. jewelry cleaner, mild liquid dish soap, hand soap etc.) into water for enhanced cleaning. Using a cleaning agent or solution improves the cleaning result. Set the cleaning cycle time to 90s, 180s or 280s.



3 Partial Cleaning

For large articles that will not submerge completely, rotate item to clean.



4 Deep Cleaning

For extensive cleaning or disinfecting, add warm water and a few drops of detergent or non-corrosive detergent or cleaning solution. Then set the cleaning cycle time to 380s or 480s.





Operation *Instructions*



1 Open the lid, and fill stainless steel tank with water. !! **Running without water may damage the cleaner !!** When filling the unit, do not exceed the **"MAX"** mark. Once filled, submerge the item to be cleaned into water.



2 Use the basket for small items. Item(s) should be submerged in the water completely. Water level should not exceed **"MAX"** mark. Close the lid and plug in the unit. (The indicator light will flash).



3 After plug in, the digital screen will display the default time - 180 seconds. Press the **"ON/OFF"** button. A red light indicates the machine is ready to work.



4 Press **"TIMER"** to select cycle time. (Choose from five setting times according to severity of cleaning: 180s, 280s, 380s, 480s, 90s).



5 Press **"DEGAS"** for better performance and to protect item from oxidization. It also prevents chemical reactions with air molecules. The cycle will work for 9 seconds and stop for 6 seconds. For best results, use this function after adding water solution and prior to cleaning your items.

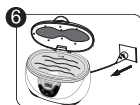

6 Empty the unit after using. Do not keep water in the tank after use. Promptly wipe the unit and tank with a dry cloth.

The ultra-sonic cleaner is working when you can hear a vibrating noise during cleaning.





Important *Safety Instructions*



WARNING - To reduce the risk of burns, electrocution, fire or personal injury:



Do not disassemble the cleaner except by an authorized serviceman.

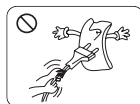

Never leave the unit unattended when plugged in.



Do not fill the tank with abrasives or corrosive chemicals.

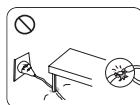

Do not operate this cleaner if power cord is damaged. Please refer to a service center for repair.



Unplug the cleaner before filling. Do not exceed the MAX mark.



Do not immerse the cleaner in water to reduce the risk of electrocution.

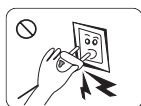

To avoid electric shock, never touch the power cord or electrical socket with wet hands.

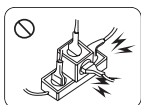

Only use this cleaner as intended by the instruction manual.





Important *Safety Instructions*

WARNING - To reduce the risk of burns, electrocution, fire or personal injury:



Unplug the cleaner immediately after use.



The unit should never be left unattended when plugged in.



Appliance should be stored in a safe place to prevent it from falling or being pulled.



Do not immerse the cleaner into water or other liquid.

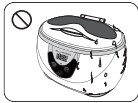

Do not reach for the unit if it has fallen into water. Unplug immediately.



Do not use while bathing.



Keep the cleaner away from heat. Store on a dry and flat surface.

• Do not put items that are not waterproof, such as your mobile phone, into the tank. Avoid cleaning artware or spectacles made from shell into the tank for cleaning.

Machine must stop 5 minutes after continued work for 30 minutes.





User Maintenance



1 Unplug and empty the cleaner after using. Do not keep water in the tank for a long time.

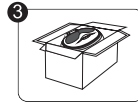

3 Keep the cleaner in a cool, dry place.



2 Wipe the tank and unit with a dry towel. **Do not wash the cleaner with water to avoid electrocution.**



Usage of Optional Accessories

Plastic Basket

Use plastic basket when cleaning small item(s) in order to protect small articles from absorbing excess ultrasonic energy.

Note:

Using plastic basket absorbs 30% of the ultrasonic energy, reducing the amount of friction. This may affect the cleaning results; try ENHANCED CLEANING for better results.

Watch Stand:

Similar to the plastic basket for small items, the watch stand will also absorb ultrasonic energy. It is recommended to use the watch stand when cleaning watches in order to avoid watch damage. Use ENHANCED CLEANING.

Please read instructions before using. Keep this manual for reference.

