



# **FIRECAN™**

**PORTABLE FIRE PIT**

OWNER'S MANUAL



MODEL # IGPRO-00121

**⚠ WARNING:**

If the information in this manual is not followed exactly, a fire or explosion may result causing property damage, personal injury or loss of life.

**⚠ FIRE OR EXPLOSION HAZARD**

If you smell gas:

1. Shut off gas to the appliance
2. Extinguish any open flame.
3. If odor continues, keep away from the appliance and immediately call your gas supplier or fire department.

Failure to follow these instructions could result in fire or explosion, which could cause property damage, personal injury, or death.

**⚠ WARNING**

Do not store or use gasoline or other liquids with flammable vapors in the vicinity of this or any other appliance.

An LP cylinder not connected for use shall not be stored in the vicinity of this or any other appliance.

**INSTALLER:** Leave this manual with the appliance.  
**CONSUMER:** Retain this manual for future reference.

**⚠ DANGER**



**CARBON MONOXIDE HAZARD**

This appliance can produce carbon monoxide which has no odor.

Using it in an enclosed space can kill you.

Never use this appliance in an enclosed space such as a camper, tent, car or home.

**⚠ WARNING: FOR OUTDOOR USE ONLY**

Installation and service must be performed by a qualified installer, service agency, or gas supplier.

**⚠ WARNING:**

Improper installation, adjustment, alteration, service or maintenance can cause injury or property damage. Read the installation, operating and maintenance instructions thoroughly before installing or servicing this equipment.

## WARNING

### FOR RECREATIONAL USE ONLY

It is impossible to foresee every use for this product. If you have any concerns about the use of this product in your environment, contact your local fire safety authority. Additional standards govern the use of fuel gases and heat producing products for specific uses. Your local authorities can advise you about these standards.

- Never refill disposable propane cylinders.
- Only use the regulator that came with your unit. Do not adjust the regulator.
- Check all the fittings for leaks during setup using soapy water as described in this manual. Never use a flame.
- Never leave heater/burner unattended when hot or in use.
- Extreme caution is necessary when any heater/burner is used by or near children or invalids. Keep out of reach of children.
- Do not move the unit while lit. Use extra care when touching carry handle while unit is hot, severe burns can result.

## DANGER

### CARBON MONOXIDE HAZARD

- This heater/burner is a combustion appliance. All such appliances produce Carbon Monoxide (CO) during the combustion process. Do not block air flow into the or out of the heater/stove.
- Carbon Monoxide (CO) poisoning produces flu-like symptoms, watery eyes, headaches, dizziness, fatigue, nausea and possibly death. You can not see or smell Carbon Monoxide gas. It is an invisible killer. If these symptoms are present during the operation of this heater/stove, get fresh air immediately!
- FOR OUTDOOR USE ONLY
- Never use inside house, camper, tent, vehicle or any other enclosed areas. This heater/stove consumes air (oxygen). Do not use in unventilated or enclosed areas to avoid endangering your or other lives.

## CAUTION

### MAINTENANCE SAFETY

- Keep all connections and fittings clean. Inspect propane cylinder and connection for damage before attaching.
- During setup of your unit, check all the connections and fittings for leaks using soapy water. Never use a flame. Bubbles in the water indicate a leak. Check that your connections are not cross-threaded and they are tight. Perform another leak test. If there is still a leak, remove the cylinder and contact IGNUK for service or repairs.
- Use as a temporary heating appliance only. Never alter the unit in any way or install any device or part not included with your unit.
- Clean your unit frequently to avoid any debris build-up.

## DANGER

### INSPECT PRODUCT BEFORE USING

Inspect hose prior to each use of the unit. The hose assembly must be replaced prior to the appliance being put into operation if there is evidence of excessive abrasion or wear, or if the hose is damaged. Contact Ignik Outdoors should you require a replacement hose.

Inspect burner prior to each use. Burner must be replaced prior to the appliance being put into operation if there is evidence of damage. Replacement burners are available from Ignik Outdoors.

Should any part of this appliance (including the burner) become soiled or dirty, wipe lightly with a damp cloth. Do not use flammable or corrosive cleaning products on or near this unit.

Ensure that gas hose is placed in an area where it is unlikely to be tripped over (such as pathways or trails) or subject to other accidental damage.

Keep the appliance area clear and free from combustible materials, gasoline and other flammable vapors and liquids.

Solid fuels shall not be burned in this appliance.

- This is not a toy. Keep out of the reach of children.
- Do not place any objects inside the burner component of the FireCan™.
- Do not add wood or any other material to the fire. It is designed to safely combust propane only.
- Do not connect to a remote gas supply.
- Do not use this appliance if any part has been under water. Immediately call a qualified service technician to inspect the appliance and to replace any part of the control system and any gas control which has been under water.
- Do not leave this appliance in the rain.
- Do not obstruct flow of combustion air and/or ventilation air for the FireCan™
- Do not wear loose clothing while operation the FireCan™. Always wear fully covered shoes while operating the FireCan™.
- The unit should be placed on the ground area out of traffic where it will not be tipped over. Do not leave unit unattended or where children or adults may cause the heater/stove to tip-over.
- Do not operate this unit in any moving vehicle.
- Do not use heater/stove when tired or under the influence of alcohol, drugs or any medication. Any inattentive activity may result in serious personal injury.
- Do not leave FireCan™ unattended while in use. Operate the FireCan™ with close supervision.
- Do not operate this unit in areas where the surroundings can ignite in the presence of combustible materials such as paper or cardboard, volatile or airborne combustibles such as gasoline, flammable liquids, explosive powders, solvents, paint thinner, dust or unknown chemicals. Sparks that occur during heater/stove operation may ignite these materials, leading to serious injury.

## FireCan™ Portable Fire Pit - Model # IGPRO-00121

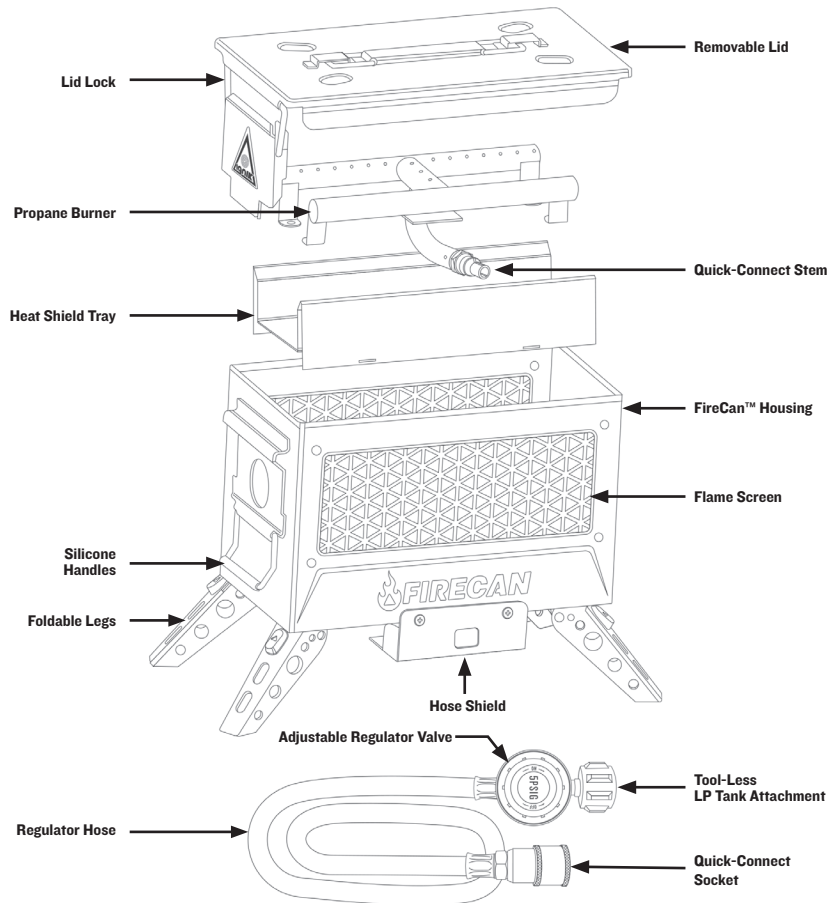

### DIMENSIONS:

<b>Assembled, Legs Open</b>	12 x 6 x 7.5 in   30.4 x 15.2 x 19 cm
<b>Assembled, Legs Closed</b>	7.1 x 12.3 x 9.1 in   18 x 31 x 23 cm
<b>Weight</b>	14.1 lbs.   6.4 kg
<b>Hose Compatibility</b>	Inlet - QCC-1   Outlet - Quick Connect

### FIRST TIME SETUP:

Ensure the following steps are completed:

1. Using the lid lock, remove lid completely from FireCan™
2. Remove all items from inside the unit including the regulator hose.
3. Fold open all foldable legs and place FireCan™ on a flat, non-flammable surface.
4. Pull back spring collar of Quick-Connect socket and push on to Quick-Connect stem attaching the regulator hose to the FireCan™.
5. With the Quick-Connect attached to the FireCan™, follow the LP SETUP direction on the next page to connect the regulator hose to the LP Tank and test for leaks.

### ⚠ WARNING

Installations must conform with local codes warning.

### TANK PRESSURE:

Minimum Supply Pressure - 5 PSI  
Maximum Supply Pressure - 200 PSI

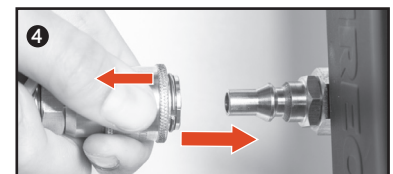
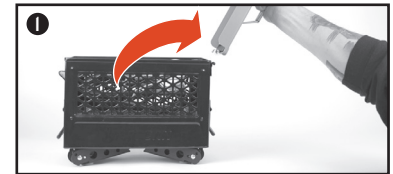
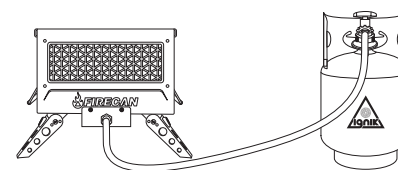

### All LP cylinders to be used with this appliance must be:

- Constructed and marked in accordance with the specifications for LP-gas cylinders Standard, CAN / CSA B339, Cylinders, Spheres and Tubes for the Transportation of Dangerous Goods
- Provided with a listed overfilling prevention device.
- Provided with a cylinder connection device compatible with the connector for outdoor appliances.
- The LP gas cylinder used for this appliance must not have a capacity larger than 20 lb. (9 kg).
- Approximately 18" (46 cm) high & 12" (30 cm) diameter.
- The use of an approved LP gas cylinder stabilizer, must be used when using this appliance in order to prevent the LP gas cylinder from tipping over.

# LP SETUP - LEAK TESTING

## WARNING

Ensure that the LP gas cylinder is kept at a minimum distance of 36 in (91 cm) away from appliance.

- Installation must conform with local codes or, in the absence of local codes, with either the *National Fuel Gas Code, ANSI Z223.1 / NFPA 54, Natural Gas and Propane Installation Code, CSA B149.1 or Propane Storage and Handling Code, B149.2*

APPLIANCE ← MINIMUM 36 in / 91 cm → PROPANE SOURCE

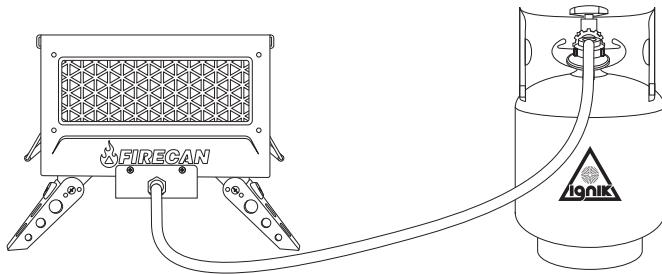

## CONNECTING THE LP TANK

1. Check that the LP tank valve knob on the LP tank is turned clockwise to closed position.
2. Check that the red flame adjustment knob on the FireCan™ regulator hose is turned counter-clockwise to off position.
3. Remove the protective cap from the LP tank valve and coupling nut, if present.
4. Hold the regulator in one hand and tighten the QCC coupling turning clockwise until it comes to a full stop. Firmly tight by hand only.
5. Place the tank to the side or rear of the FireCan™. Make sure the hose does not touch any part of the FireCan™ housing.

## CAUTION

The burner must be inspected before each use of the appliance. If it is evident that the burner is damaged it must be replaced before the appliance is put into use. The burner must be replaced only by factory authorized parts as specified by the manufacturer.

## CHECKING FOR LEAKS

1. After all connections are completed, check all connections and fittings for leaks with a soap solution.
2. With all valves closed, apply leak check solution (50/50 mix of dish washing soap detergent and water) to all gas carrying connections and fittings.
3. Open tank valve. Presence of bubbles at areas of wet solution indicated a gas leak. If leaks are detected or you smell or hear gas, shut off the valve and repair the leak or replace the defective part.

*\* Do not use the fire pit until all leaks are corrected.*

## CAUTION

Not intended for commercial use. For outdoor use only. Use only in well-ventilated spaces. Do not operate in a building, garage or any other enclosed area.

Minimum Clearance from sides and back of appliance to any material is 36" and from top is 72". Do not use under overhead structure.

# LIGHTING & ADJUSTMENT

## WARNING

Make sure lid is completely removed from FireCan™ and legs are fully extended before lighting.

## INSTRUCTIONS FOR USE:

1. Slowly rotate LP tank valve knob Counter-Clockwise to fully "OPEN" position (approximately 2.5 full rotations).
2. With hand ready on red Flame Adjustment Knob, place elongated lighter (BBQ style lighter) in Ignition Hole on side of FireCan™ and ignite lighter.
3. Slowly rotate Flame Adjustment Knob clockwise, about 1/2 of a rotation until you hear fuel starting to flow.
4. Place lighter flame near FireCan™ burner and wait for FireCan™ to Ignite. Warning: If FireCan™ does not ignite within 10 seconds, turn Flame Adjustment Valve to "OFF" and repeat from step #2.
5. After burner is ignited, adjust Flame by rotating red Flame Adjustment Knob Clockwise for larger flame, and Counter-Clockwise for smaller flame.

## TIPS:

- 3 full rotations is full pressure and maximum flame. This should be reserved for extreme conditions and use at higher elevations.
- One to 1-1/2 rotations is generally a good flame height

**• GOT A LOW FLAME?:** If your FireCan™ experiences low flame, or flame height does not appear to be normally adjusted by the Flame Adjustment knob, it is likely that the CSA excess flow safety device has been tripped in the hose regulator. If this occurs, turn the LP tank knob to the closed position and the Flame Adjustment Knob to the off position and start over from step one above.

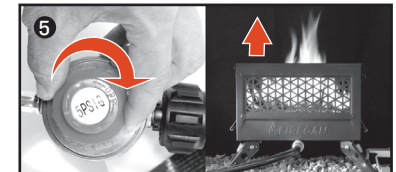
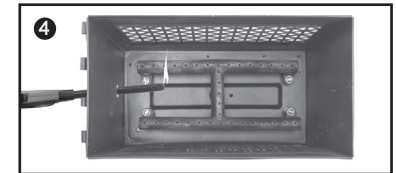
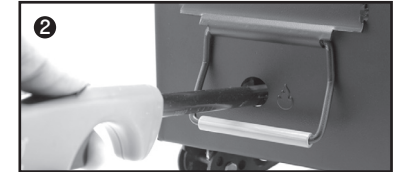
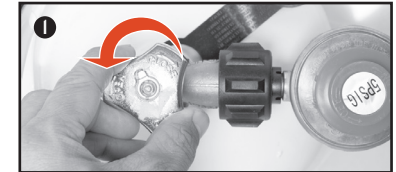

## CAUTION

DO not move or re-position the FireCan™ while in-use.

# EXTINGUISHING & BREAK DOWN

## **⚠ CAUTION**

FireCan™ will get VERY HOT. Do not touch while in use or after use until product has cooled down.

### TO DISCONTINUE USE:

1. Turn Flame Adjustment Knob (Red Plastic) Counter-Clockwise until valve is fully closed. Flame will start to diminish within 1 minute.

2. After flame is extinguished, rotate valve on Propane Tank Clockwise to fully close.

3. LET THE FIRECAN™ COOL DOWN FOR AT LEAST 10 MINUTES BEFORE MOVING OR REMOVING HOSE.

4. After cool, remove Quick-Connect Socket from FireCan™, and remove hose connector from LP tank valve..

5. When FireCan is cool to the touch, it is safe to coil and place hose inside.

6. Reconnect lid by placing lid hinge on FireCan™ bar in an approximately 90-degree "open" position. Rotate lid closed to engage hinge.

7. Engage clasp-lock, and press down firmly until handle snaps down in closed position.

8. Break down Quick-Snap legs for easy packing and storage.

### PERIODIC INSPECTION:

- Keep your FireCan™ out of the rain and store it in a dry place.
- This device has been engineered to provide the maximum amount of heat and comfort. If you experience any signs of your propane cylinder 'freezing off' or start to experience lower flames than usual, please simply turn the burner control setting to low for 5-10 minutes, or replace the cylinder with a full one.
- Ensure that you clean the inside and outside of the housing of your FireCan™ by wiping down combustion particulates with a rag after the housing has fully cooled down.

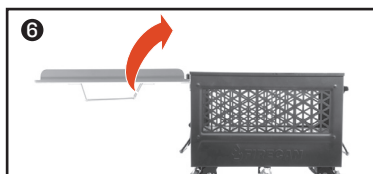
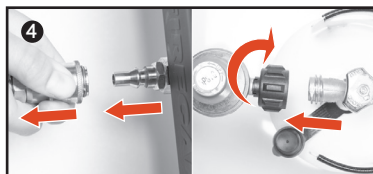
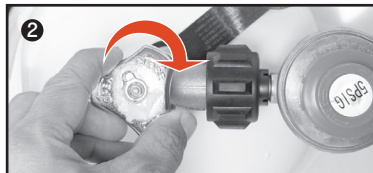

# PERFORMANCE PROMISE



## WE BELIEVE PRODUCTS SHOULD WORK.

If you have a problem with an Ignik product, let us know and we will make it right. Ignik stands behind what we design and offer. When things are less than perfect, we will repair, replace, or refund, whatever it takes to make things right.

## GOT QUESTIONS?

FIND OUT MORE:

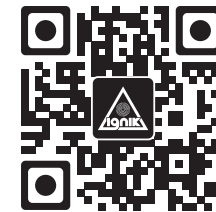

If you have a comment, suggestion, or issue, please let us know.

Contact us at:  
[customerservice@ignik.com](mailto:customerservice@ignik.com)  
[www.ignik.com](http://www.ignik.com)



## BE THE CHANGE

Our journey began on a family sailboat in the Arctic where we saw the impact of climate change on the landscapes we love. We started Ignik to create products that actually work and work for the planet.



KEEP UP ON THE LATEST  
& HELP US BE THE CHANGE

@ignikoutdoors  
#sustainableoutdoorheat  
#bethechange

WWW.IGNIK.COM

IGNIK Outdoors  
403 Madison Ave N #240,  
Bainbridge Island, WA 98110



WE GIVE 1% OF ALL SALES TO FIGHT CLIMATE CHANGE IN THE ARCTIC

COMMITTED TO RECYCLED MATERIALS AND MANUFACTURING