



Visioner
Instruction Manual

I Device Layout

Front View of Camera



Rear View of Camera



I Steps to Installation

1. Use the screws to attach the magnetic base to the bottom of device.



2. The camera would be attached to the base based on magnetic field.
3. Connect the power cords.
4. If the status light is showing a constant red light, it is correctly connected to the power source. Follow the App instructions to connect device to internet. If the constant red light didn't appear, please hold down on reset button for 6 seconds to restart process.

I Steps to Set Up Internet Connection

1. Scan the QR code below to be redirected to App Store/Google Play or search “Alcidae” directly in stores to access download page.



QR code

2. Register and log in with an Alcidae account.
3. To ensure successful internet connection, please make sure your phone is connected to your commonly used 2.4G indoor Wi-Fi with strongest signal.

4. When the device status light is showing constant red, click on “Add device” button on App and enter your Wi-Fi information. Wait for the phone to discover your device.

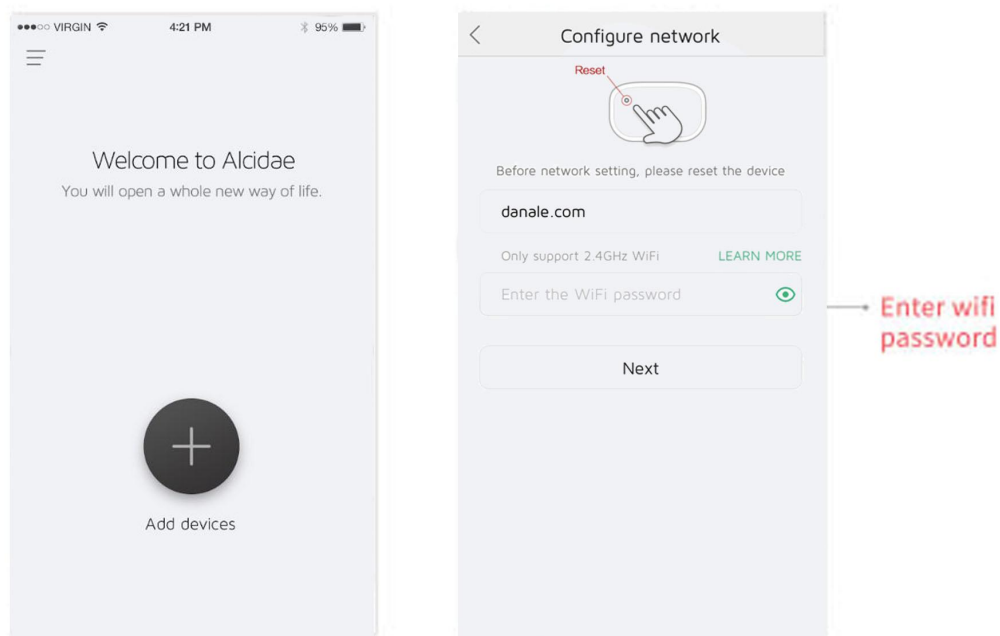

5. Wait for the device status light to change from a slowly blinking blue light to a fast blinking blue.

6. When the device is successfully discovered, hit the “Add” button to continue process.

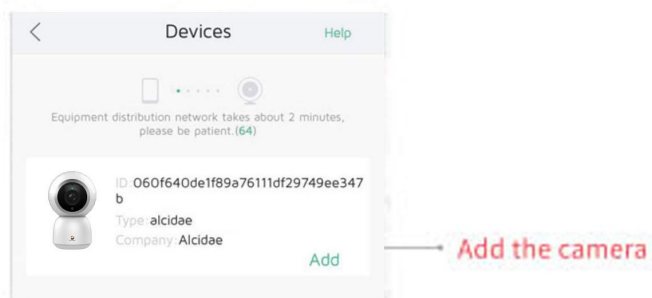

7. After you name the device you can start using the device through the App.

I Reset Internet Connection

Whenever in a situation to switch internet environments, please hold down on device reset button for 6 seconds to start reset process. Your reset process has completed when you hear the device sound “Wi-Fi reset success”. Follow the “Set up internet connection” procedure to reset internet settings.

I Device Status Light

Step 1. Constant red light means the device is activating, it will enter the next stage when process is completed.



Step 2. Blinking red light means the device is waiting for internet connection to be established.



Step 3. Blinking blue light means the device is connecting to the internet access point.



Step 4. Faster blinking blue light means the device has successfully connected to the internet access point and is connecting to our cloud service.



Step 5. Constant blue light means the device has successfully established connection to cloud service.



I Product Introduction

Packing List:

- Camera x1
- Magnetic Base x1
- Power Adaptor x1
- Power Cable x1
- Installment Accessories x1
- Instruction Manual x4



Camera



Instruction Manual



Power Adaptor



Power Cable



Installment Accessories

| Technical Specifications

Product Name: Visioner

Power Input: 5V/1A

Camera Angle: 150 °

DC Power: 5W/Max

Working Humidity: 90%

Product Model: Q1 Lite

Resolution: HD1080P

Cloud Service: Danale Cloud Service

Working Temperature: 0 °C ~40 °C

Wi-Fi Standard: 802.11 b/g/n

I Purchase Warranty

Alcidae Inc Warranty Policy

1. 7 days return period: Within 7 days of purchase if you encountered any issues with our product, you are eligible for a full refund or product replacement with valid purchase receipt.
2. 15 days return period: Within 15 days of purchase if you encountered any issues with our product, you are eligible for a product replacement with valid purchase receipt.
3. 12 months maintenance period: Within 12 months of purchase if you encountered any issues with our product, you are eligible for our product repair and maintenance service with valid purchase receipt.

Outside of Warranty Policy

- 1.Request without a valid warranty card and purchase receipt.
- 2.Outside of warranty time period.
- 3.Determined as malfunction or damage caused by user product misuse.
- 4.Damage or malfunction caused by force-majeure circumstances.
- 5.Damage of the device exterior.

This device complies with part 15 of the FCC Rules.Operation is subject to the following two conditions:

- (1) This device may not cause harmful interference, and
- (2) this device must accept any interference received, including interference that may cause undesired operation.

| Warranty Card

Customer Information (Please be sure to provide accurate and true information for us to fulfil promised purchase warranty)

Name _____ Phone Number _____

Email _____ Zip Code _____

Contact Address _____

Product Information

Name _____ Model _____

Color _____ Model Serial Number _____

Required Service: ☐ Return ☐ Replace ☐ Maintenance

Brief Description _____

Date _____ Request Received Personnel _____

FCC Statement

This equipment has been tested and found to comply with the limits for a Class B digital device, pursuant to Part 15 of the FCC Rules. These limits are designed to provide reasonable protection against harmful interference in a residential installation. This equipment generates uses and can radiate radio frequency energy and, if not installed and used in accordance with the instructions, may cause harmful interference to radio communications. However, there is no guarantee that interference will not occur in a particular installation. If this equipment does cause harmful interference to radio or television reception, which can be determined by turning the equipment off and on, the user is encouraged to try to correct the interference by one or more of the following measures:

- Reorient or relocate the receiving antenna.
- Increase the separation between the equipment and receiver.
- Connect the equipment into an outlet on a circuit different from that to which the receiver is connected.
- Consult the dealer or an experienced radio/TV technician for help.

This device complies with part 15 of the FCC Rules. Operation is subject to the following two conditions:(1) This device may not cause harmful interference, and (2) this device must accept any interference received, including interference that may cause undesired operation. Any Changes or modifications not expressly approved by the party responsible for compliance could void the user's authority to operate the equipment. This equipment complies with FCC radiation exposure limits set forth for an uncontrolled environment.

This equipment should be installed and operated with minimum distance 20cm between the radiator & your body.