



Google Home/Assistant Instructions

1. Download the Google Home and Google Assistant App from App Store or Play store.
2. Login with you google account in both Apps.
3. Set up devices in Google Home (see next page)

***For Google Assistant Commands (see last page)**

4. Tap on the + sign top left corner.

5. Tap on "Set up device"

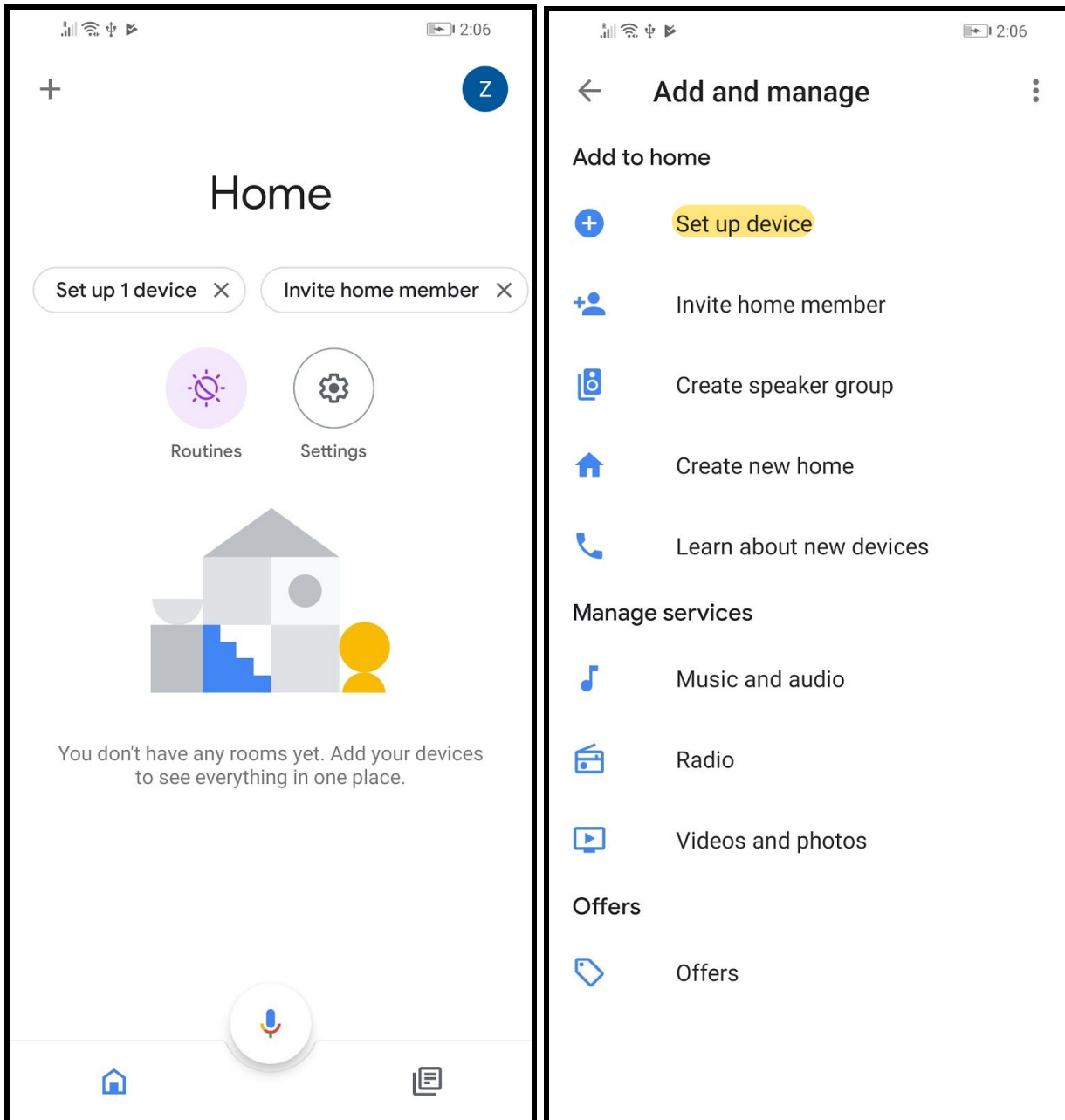

6. Under 'Works with Google' tap 'Have something already set up?'.

7. Scroll down and tap on 'Alcidae Smart Home'

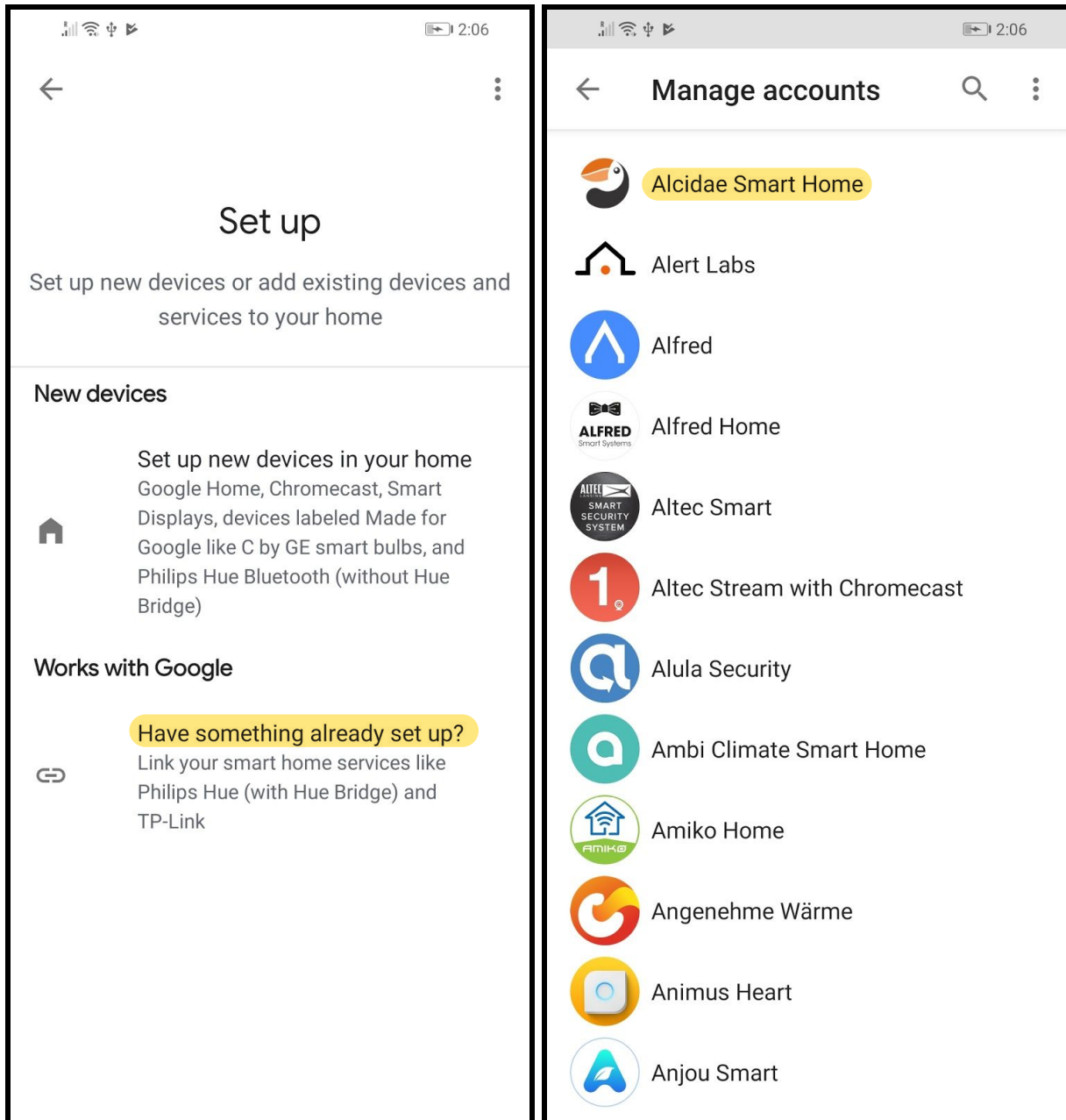

8. Enter your Alcidae account and password

9. Tap “Allow” then any compatible device will appear on the home page.

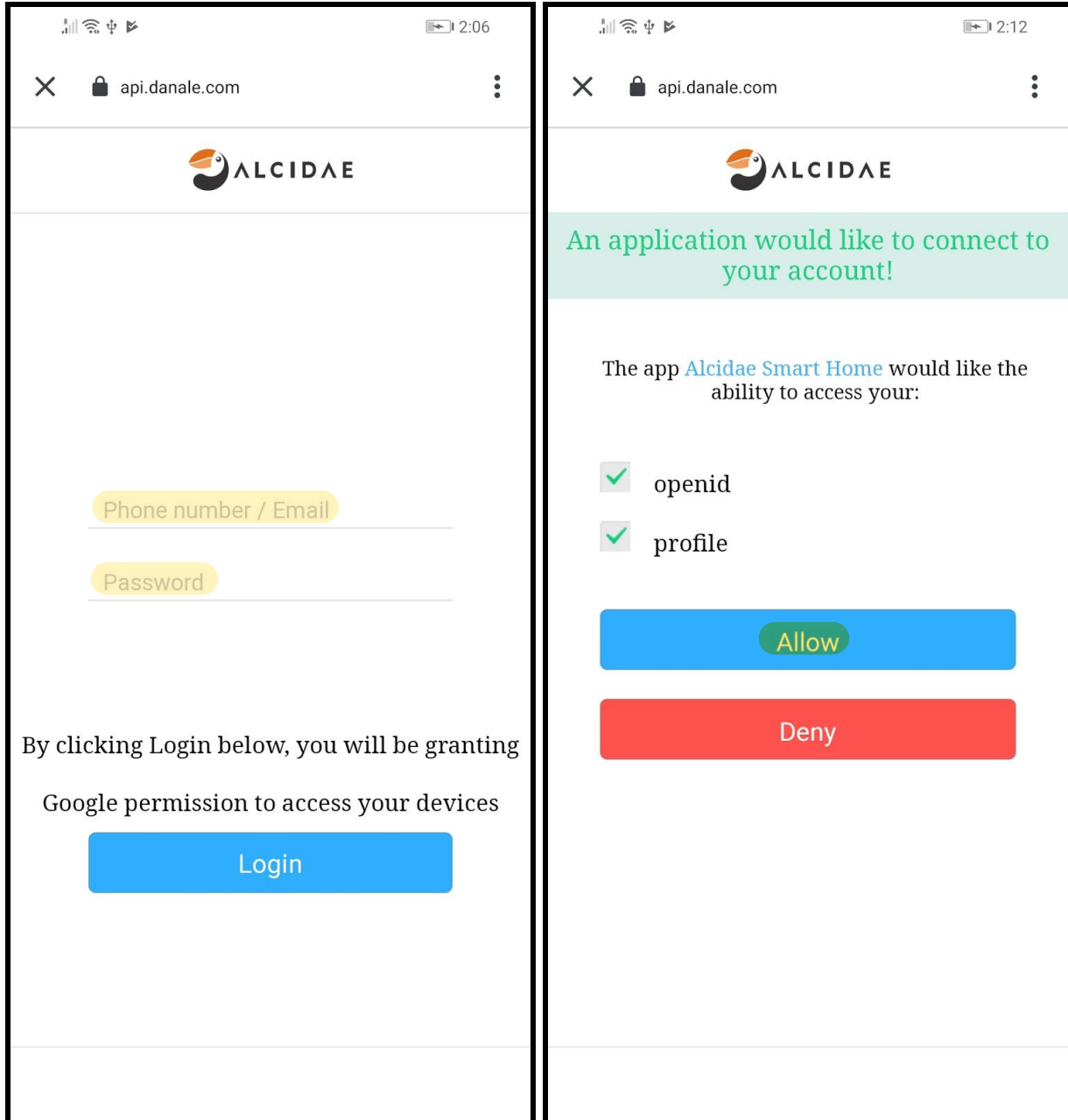

10. Next go to Google Assistant and tap on 'Explore'

11. Search 'Alcidae' in the search bar.

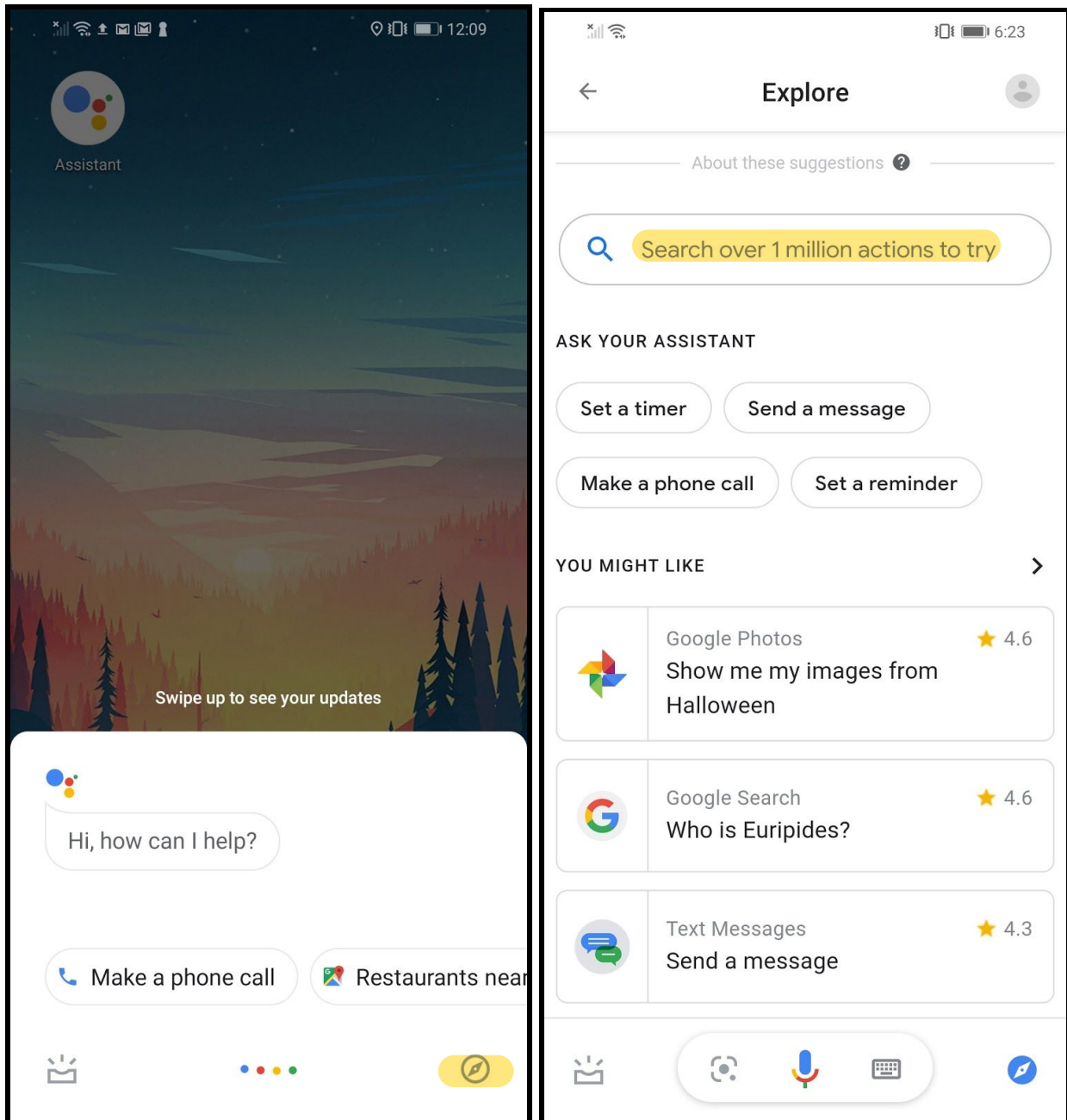

12. Tap “Alcidae Garager”.

13. Enter your Alcidae account and password again.

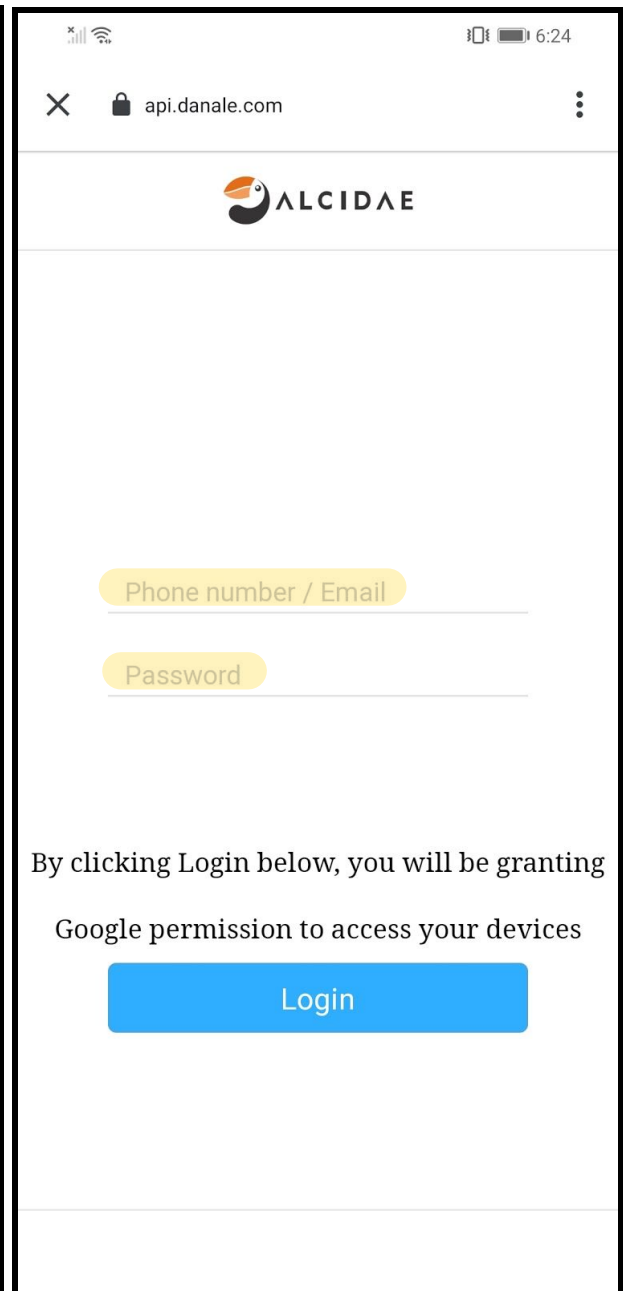
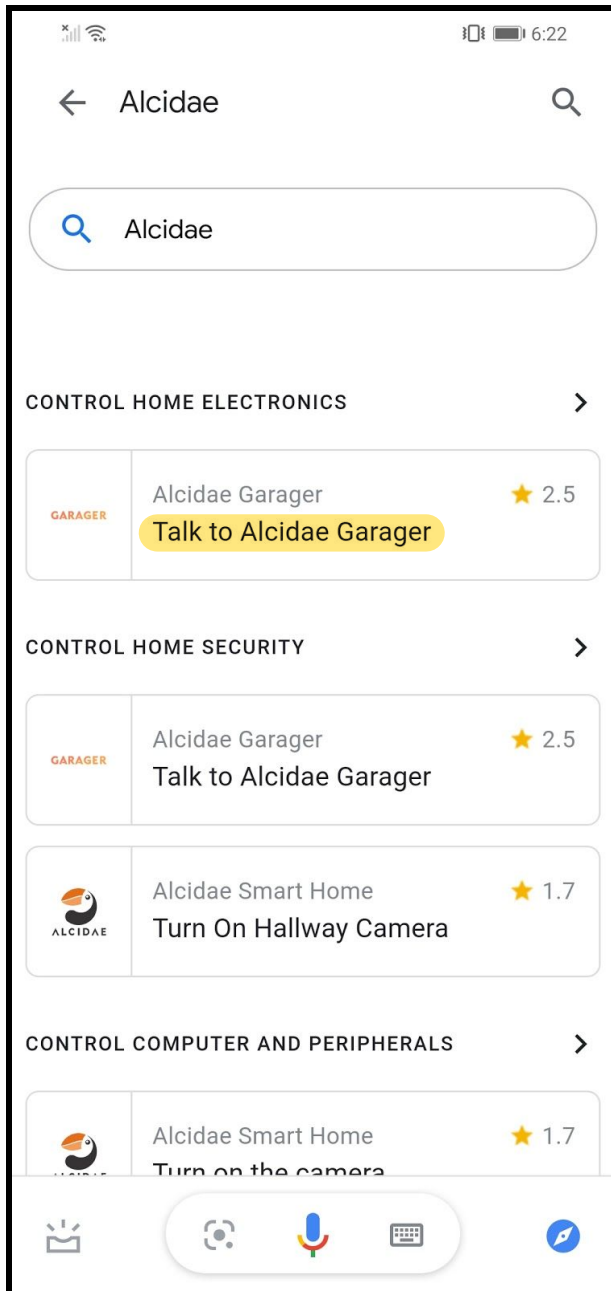

By clicking Login below, you will be granting Google permission to access your devices

Login

14. Tap 'Allow'.

15. You'll see voice command is ready.

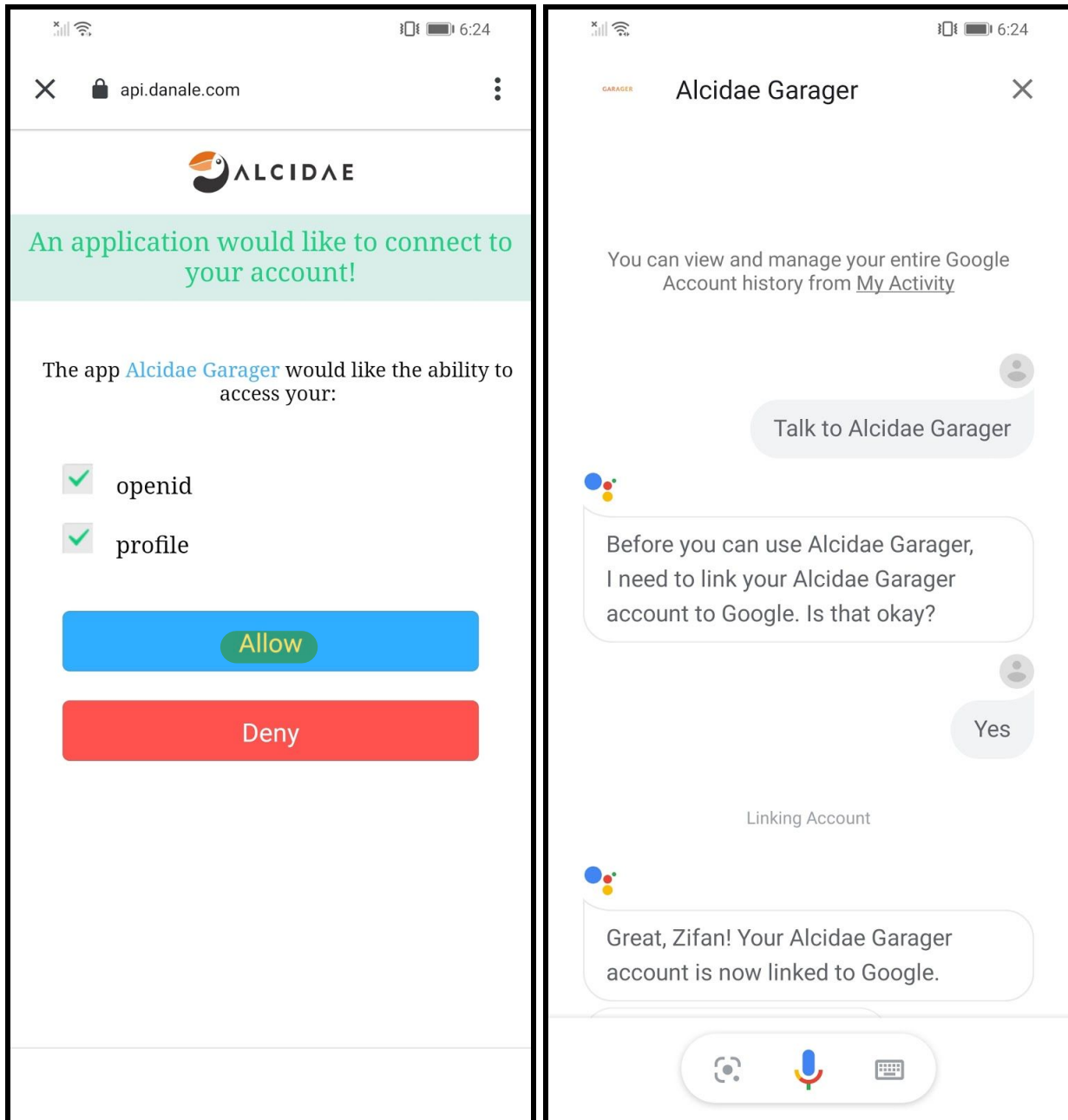

Google Assistant Commands for Garager 2

After installing Garager Skill, start by Saying **“Hey/Okay Google, Talk to “Alcidae* Garager”** then ...

Open and Close the Garage Door

Action	Command
Open the Garage Door	Open my garage door
Close the Garage Door	Close my garage door

* How to pronounce **Alcidae** : Al·ci·dae | \ 'al-sə-,dē \ | Al·sa·day

Fun fact:

Definition of Alcidae: a family of diving birds (order Charadriiformes) having short wings and tail, webbed feet, a large head and heavy body, and thick compact plumage, being confined to the northern parts of the northern hemisphere, and including the auks, puffins, guillemots, murre, and related forms