

INCLUDED COMPONENTS

BEFORE ASSEMBLING YOUR FLEXFRAME TRAILER FOLLOW INSTRUCTIONS IN YOUR SPOT SPRAYER ASSEMBLY MANUAL

TOOLS REQUIRED



1/2" & 9/16" SOCKET WRENCH

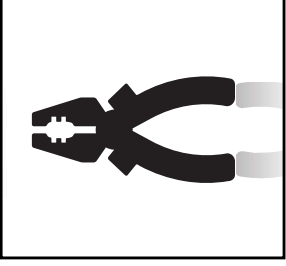

PLIERS

NOTE:
ONCE YOU HAVE FINISHED THE SPOT SPRAYER AND TRAILER ASSEMBLY, MOVE ON TO THE BOOM ASSEMBLY CARD, TO COMPLETE YOUR SPRAYER.

1.

TOOLS

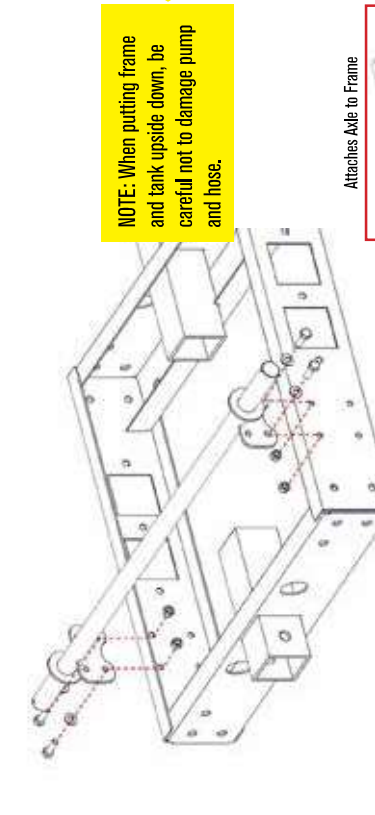

NOTE: When putting frame and tank upside down, be careful not to damage pump and hose.

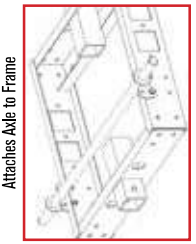

Turn frame and tank upside down, position the Axle on the bottom of the FlexFrame as shown above.

Align holes in axle plate with FlexFrame. Secure with 5/16" - 1" Hex Bolts and Flange Nuts. Tighten securely with Socket Wrench.

2.

TOOLS

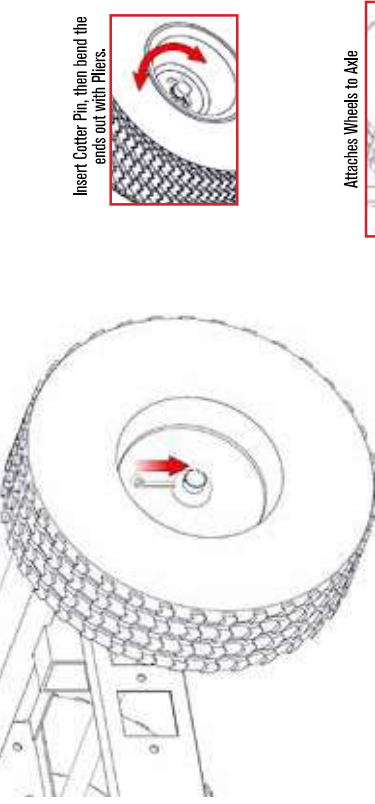

Insert Cotter Pin, then bend the ends out with Pliers.

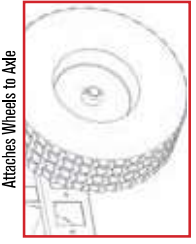

Attaches Wheels to Axle

Slide Wheels over Axle making sure Valve Stems are facing out away from the FlexFrame.

Insert Cotter Pins through the holes on each Axle. Use Pliers to bend the ends of the Cotter Pins, to ensure the Wheels can't slide off the Axles.

FLEXFRAME TRAILER ASSEMBLY

PARTS

PARTS

3-

PARTS

TOOLS

TOOLS

Insert QA Boom Post into the open 2" Receiver. Align holes with 2" Receiver and QA Boom Post.

Insert Hitch Pin through the holes between Receiver and QA Boom Post. Secure Hitch Pin with Hair Pin.

PARTS

PARTS

4-

PARTS

TOOLS

TOOLS

Insert and secure the 2.75" Carriage Bolt to the Boom Mount with the 3/8" Push Nut.

Slide Boom Mount into one of the open slots on QA Boom Post and slide 2.75" Carriage Bolt through open hole on QA Boom Post. Thread on Knob to 2.75" Carriage Bolt.

NOTE: Boom Mount can be adjusted to other open slots on the QA Boom for the ideal broadcast spray height.

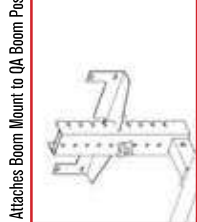

Attaches Boom Mount to QA Boom Post

PARTS

PARTS

5-

PARTS

TOOLS

TOOLS

Align the holes on the Adjustable Hitch and Tongue.

Insert 3/8" - 1" Hex Bolts and tighten with 3/8" Hex Nuts with Socket Wrench.

PARTS

PARTS

B-

PARTS

Attaches Adjustable Hitch to Tongue

ID	Part Number	Description
1	32-100100	Axle
2	32-100103	Boom Mount
3	32-100104	QA Boom Post
4	32-100106	Tongue
5	34-140191	Hitch Clamp
6	32-100066	Adjustable Hitch
7	722HP	Hitch Pin
8	33-100127	Cotter Pin
9	TWA16X6.50-8/1"	Wheel
10	32-100107	FlexFrame Mount
11	P-7825	Hair Pin
12	TDS1.5-67	Tank Strap
13	TD-150	Tank Strap Mount
14		Sprayer Tank