

Mini Grip
Fast Wireless Charger
Cup Holder Phone Mount

User Manual

■ CUP HOLDER INSTALLATION

1. Make sure the cup holder expanding grips are all the way in.
2. Put the mount in the cup holder.
3. Twist the release knob clockwise in your cup holder until secure.

Caution:

Please make sure that the mount is installed in the center of the cup holder to avoid shaking while driving.



■ CHARGING CRADLE OVERVIEW

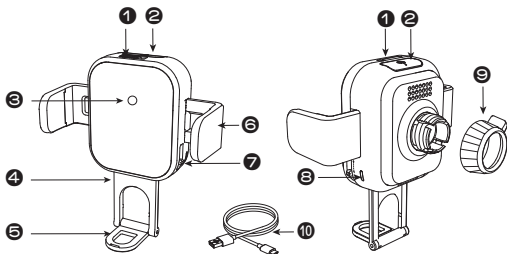

- 1 Cradle Foot Switch
- 2 Grip ON/OFF Button
- 3 Wireless Charging Coil
- 4 Cradle Foot
- 5 Prop
- 6 Automatic Grip
- 7 Charging Coil Slider
- 8 Wireless Charging Indicator
- 9 Joint Ring
- 10 Type-C USB Cable (1.2M)

■ HOW TO USE WIRELESS CHARGER

POWER CONNECTION

Connect the car charger and cradle with the included Type-C cable and PD car charger.

Figure 1



Be sure to use a 9V high-speed charger for high-speed wireless charging. Using a low-capacity charger can cause product malfunction or slow wireless charging.



Type-C
USB Cable
Figure 1

■ WIRELESS CHARGING

1. Touch the Grip ON/OFF button to open the grip.
2. The grip opens, and when the phone is taken it out, the wireless charging is interrupted, and the grip closes automatically about two seconds later.
3. When the phone is placed on the cradle foot, the cradle foot is lowered under the weight of the phone, and the grip is automatically closed to start charging wirelessly. Also, the wireless charging indicator lamp turns blue.

⚠ Wireless charging might not perform normally in the following cases.

A. Charging Coils are not aligned.

→ Move the Charging Coil Slider Up or Down.

B. Insufficient capacity of the car charger.

→ Use a charger that is at least 5V/2.0A.

C. There are metallic materials such as magnets and steel plates in the phone case.

→ Remove the corresponding metallic material.

D. In case of over-heating on the wireless charger.

→ Stop wireless charging for a period of time to allow your phone and cradle to cool down sufficiently.

3. When you hold your phone horizontally, put the cradle foot inside and move it from side to side.

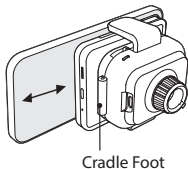

■ BEFORE USING WIRELESS CHARGER

- Location of the wireless charging coil of the phone to be mounted
- Only when the wireless charging coil built into the wireless charger and the phone is accurately matched, heat generation is low and fast charging is possible. Please refer to the pictures below to check the wireless charging coil of the phone to be mounted. Most phones have a built-in wireless coil in the center of the phone, as shown. **Figure 2**

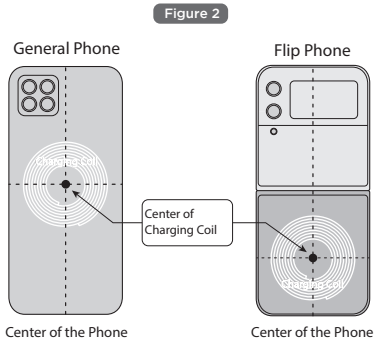

- ⓘ For flip phones (Galaxy Z Series), the wireless charging coil is located in the center of the lower end of the phone.

ADJUST CRADLE FOOT LENGTH & COIL POSITION

GENERAL PHONE

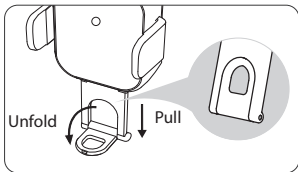

1. Pull out the cradle foot down as shown in the picture and unfold the pedestal.

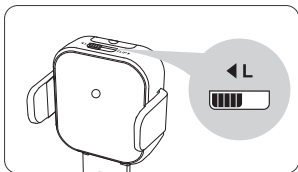

2. Move the Cradle Foot Switch to the L position.

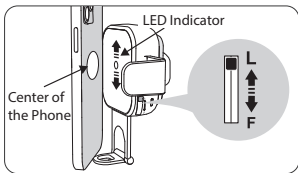

3. Adjust the charging position by moving the Charging Coil Slider so that the upper and lower centers of the phone and the LED Indicator position match.

FLIP PHONE

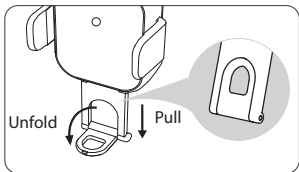

1. Pull out the cradle foot down as shown in the picture and unfold the pedestal.

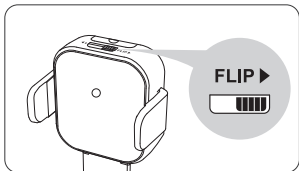

2. Move the Cradle Foot Switch to the FLIP position.

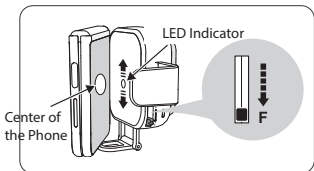

3. Move the Charging Coil Slider all the way down to the F position.



■ DISABLE WIRELESS CHARGING

Frequent charging, or continuous charging while fully charged, significantly reduces the battery life of the phone. In this case, disable the wireless charging function in the following ways:

1. Unplug the cable from bottom of the mount or car charger.
2. The grip can still be opened or closed using residual power.

■ RESIDUAL POWER

The number of times the grip can be operated with residual power is about 3 to 4 times. Wireless charging cannot be performed with residual power.

■ LED INDICATORS

The Wireless charging indicator operates as follows:

Power ON	White LED on for 3 seconds and then off
Standby State	Blue LED in Wireless charging coil position indicator
Charging	Blue LED
Charging Error	Cross-lit in white and blue LED

- Reason for charging error (protection circuit operation)
 1. Over voltage and over current
 2. Low voltage and low current
 3. Overheating
 4. Metallic substance detection
 5. Leaving the charging position

■ CAUTION

- If the thickness of the phone case exceeds approximately 2mm, wireless charging may slow or stop.
- The normal wireless charging temperature is 0-26°C degrees. If wireless charging is performed in a high-temperature state or in a place where direct sunlight such as a dashboard, the protection circuit may be activated and the charging may be temporarily stopped. In this case, Wireless charging indicator is cross-lit in white and blue.
- If you charge wirelessly while running an app that uses GPS, such as navigation, the app may temporarily stop working in areas where the GPS signal is extremely weak. In this case, press and hold the Multifunction button for at least 3 seconds to temporarily disable the wireless charging function.
- Depending on the phone's model, the wireless charging coil is built into an extremely high or low position than the center of the phone, so auto-scanning may not occur normally. In this case, put the cradle foot inside and scan the coil position.