

### STEP 3

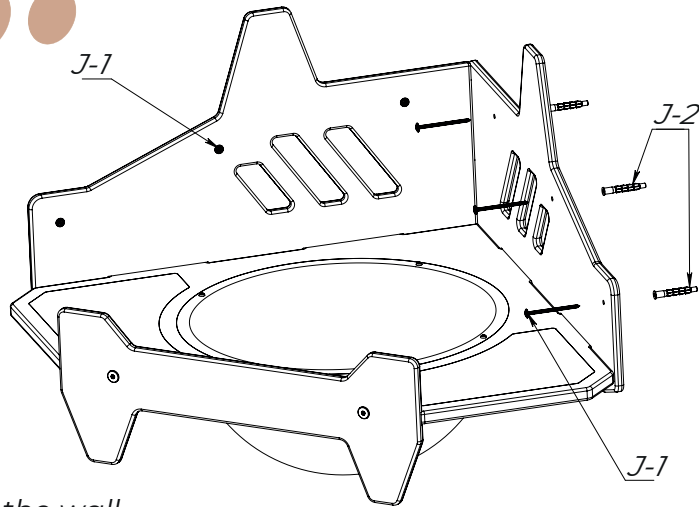

1. Detail J-2 hammer into the wall.
2. Fasten the assembled part and fix with screws J-1.

### Our social media



@wowhelperperco



<https://www.facebook.com/wowhelperperco/>



<https://www.pinterest.com/PetsHelperCo/>



Instagram



Facebook



Pinterest



wowhelperperco



### Corner shelf



Email: [petshelperperco@gmail.com](mailto:petshelperperco@gmail.com)



Etsy

## ASSEMBLY PARTS



A		B		C	
1pc		1pc		1pc	
D		E		F	
1pc		1pc		3pcs	small
G		H		I	
6pcs	big	2pcs		4pcs	
J		K		L	
6pcs	J-1 J-2	1pc	small	1pc	big

## STEP 1

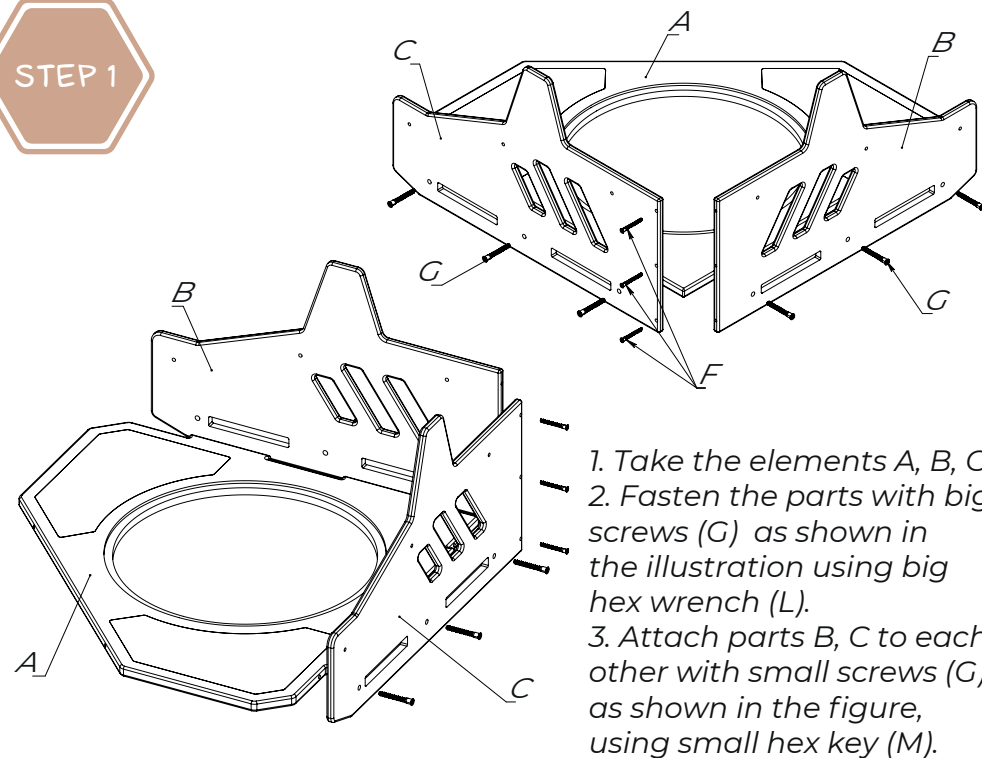

## STEP 2

1. Take elements E, D.
2. Part (D) Fix with screws (H) as shown in the figure, using a large hex key (L).
3. Fasten the transparent(E) dome with screws (I) as shown in the figure, using a screwdriver

