





Feature:

- Mounts easy on round & square shaft (with option -8).
- External clutch for manual adjustments.
- Maintenance free.
- Position indicator.
- Fail safe by *Enerdrive System*¹ (on model 60 & 80).
- Auxiliary switches (on model 20 & 80).

SM000S
SM020S
SM060S
SM080S
SM100S
SM120S
SM160S
SM200S
SM220S
SM260S

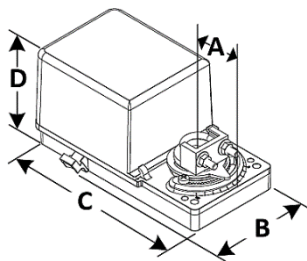
Technical Data	SM000S	SM020S	SM060S	SM080S	SM100S	SM200S	SM120S	SM160S	SM220S	SM260S
Auxiliary switches	No	Yes (2)	No	Yes (2)	No	No	Yes (2)	No	Yes (2)	No
Fail safe - <i>Enerdrive</i>	No		Yes		No			Yes	No	Yes
Power consumption	8 VA		20 VA Peak, 8 VA		8 VA			20 VA Peak 8 VA	8 VA	20 VA Peak 8 VA
Power supply	22 to 26 VAC or 28 to 32 VDC				110 to 130 VAC 50/60Hz	220 to 250 VAC 50/60Hz	110 to 130 VAC 50/60H		220 to 250 VAC 50/60Hz	
Approvals					 Class 2					
Ingress protection	IP22 equivalent to Nema type 2, IP54 equivalent to Nema type 3R if water tight inlet bushings (not supplied NEP617) are installed						IP22 equivalent to Nema type 2			
Torque	70 in.lb. [8 Nm] at rated voltage									
Running time through 90°	90 - 110 sec (Fail-safe20-30 sec)									
Electrical connection	18 AWG [0.8 mm²] minimum									
Inlet bushing	2 inlet bushings: 13/16" [20.6mm]									
Control signal	2 to 10 VDC or 4 to 20 mA (factory set 2 to 10 VDC)									
Angle of rotation	0 to 90 degrees, mechanically adjustable (factory set with 90° stroke)									
Direction of rotation	Reversible, Clockwise (CW) or Counterclockwise (CCW) (factory set with CW direction)									
Ambient temperature	-22°F à +122°F [-30° C à +50° C]									
Storage temperature	-22°F to +122°F [-30° C to +50° C]									
Relative Humidity	5 to 95 % non condensing.									
Weight	3 lbs. [1.4 kg]									
Warning: Do not press the clutch when actuator is powered										

Dimensions

Dimension		Inches	Metric (mm)
A		1.50	38.1
B		3.64	92.5
C		6.60	167.5
D	model 000, 060, 100 & 200	3.02	76.8
	model 020, 080, 120, 160, 220 & 260	3.81	96.8

Caution

We strongly recommend that all neptronic® products be wired to a separate transformer and that transformer shall service only neptronic® products. This precaution will prevent interference with, and/or possible damage to incompatible equipment.
 When multiple actuators are wired on a single transformer, polarity must be observed. Long wiring runs create voltage drop which may affect the actuator performance.

¹ *Enerdrive System* U.S.A. Patent #5,278,454

Mechanical installation

MOUNTING BRACKET

CLUTCH

1. Manually close the damper blades and positioned the actuator at 0° or 90°.
2. Slide the actuator onto the shaft.
3. Tighten the nuts on the “U” bolt to the shaft with a 8mm wrench to a torque of 60 in.lb. [6,7 Nm].
4. Slide the mounting bracket under the actuator. Ensure free movement of the slot at the base of the actuator. The bracket pin must be placed in the mid distance of the slot.
5. Fix the bracket to the ductwork with #8 self-tapping screws.

Wiring Diagrams

Models SM000S, 020S, 060S & 080S	Models SM100S, 120S, 160S, 200S, 220S & 260S
<p>2 to 10 VDC</p>	<p>2 to 10 VDC</p>
<p>4 to 20 mA</p>	<p>4 to 20 mA</p>

PC Board

Potentiometer

BM060VAV

SW1

Rotation direction

Fail safe direction (Only on model 60S & 80S)

SW2

JP1

Control signal selection

Terminal

TB1 2 3

Line voltage terminal (Only on model 100S, 120S, 160S, 200S, 220S & 260S)

TB2 1 2

N L

!!! HIGH VOLTAGE

Dip switch settings

Rotation direction (SW1)

CW
(0 to 90°)

CCW
(90 to 0°)

Fail safe direction (SW2)
(only on model 60 & 80)

Fail safe
return at 0°

Fail safe
return at 90°

Stroke adjustment

To adjust the stroke, move the adjustment screws at the desired position.