

Supercharger Preliminary Notes

VORTECH SUPERCHARGER Model V3.

The Vortech V3 supercharger unit is a self contained unit. It contains its own oil in an internal reservoir cavity that is used for internal lubrication. The unit is supplied pre-filled with oil. The oil is a unique blend and can be purchased from Vortech directly or VF-Engineering. The supercharger unit is also supplied with a silver braided line fitted to the underside. When installing the supercharger kit, you can route this line to a location convenient for easy access. It will be used to drain the oil out of the supercharger explained below.

When in use, the supercharger unit gets hot and the oil inside will expand and will need to ventilate. The unit is supplied with a ventilation fitting that you must install on the supercharger after initially mounting it. The ventilation port on the supercharger is supplied with a blocked fitting so that the oil does not leak out during transportation.

The unit has 2 rounded brass fittings (gold colored) on the upper most end (when mounted in the engine). One is a dipstick and the other is the ventilation port. You may carefully open both to check them. Make sure you use the proper size allen/hex key (**3/16**) or else you may strip the fitting. [

Once the supercharger unit is installed, remove the blocked "shipping plug" fitting and install the ventilation fitting. Check the oil level and proceed. The oil must be changed after the first 2500 miles of use and then every 7500 miles.

The supercharger unit drain line should not be connected to anything. When it is time for an oil change, unscrew the fitting on the end of it and allow the oil to drain out in to a disposable container. Then close the fitting and refill the supercharger from the top through the dipstick port by removing the dipstick fitting. It will require approx 6-7 fluid oz.

The Vortech V3 unit is known as "super quiet" however it will make a rattle sound on idle and this is normal. The sound will quieten as rpm increases and with the hood shut, the unit will be almost silent when driving at part throttle. At certain specific RPM you may hear a harmonic resonance from the Vortech unit which is normal. If during the use, the sound is not the same and changes dramatically compared to before, you may wish to consult Vortech Engineering directly at www.vortechengineering.com. All servicing of the supercharger is performed by Vortech.

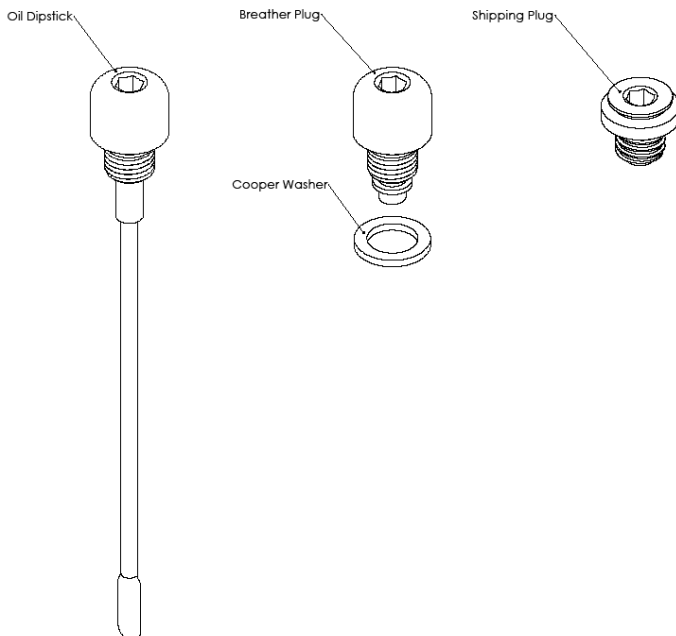
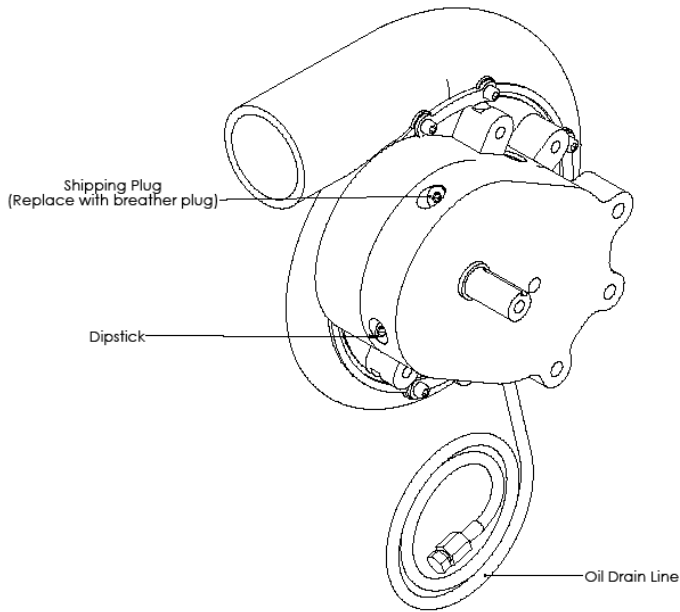

[Doc # 008221 v1.0

Internally lubricated S/C tag / warning text:]

IMPORTANT

- This supercharger has been factory pre-filled with special synthetic lubricant. Oil does not need to be added to a brand new unit; however, a fluid level check should be performed.
- Prior to operating the supercharger on the vehicle and after installation onto the vehicle:
 1. Remove the factory installed flat head brass shipping plug (not the dipstick) from the top of the supercharger case.
 2. Replace the sealed shipping plug with the supplied “vented” plug. Do not operate the supercharger without it.
 3. Check the supercharger fluid level.
- Fluid level checking procedure:
 1. Ensure that the .06” copper sealing washer is located on the dipstick base.
 2. Thread the clean dipstick into the unit until it seats.
 3. Once the dipstick has seated, remove the dipstick from the unit. Fluid should register in the crosshatched area on the dipstick.
 4. **DO NOT OVERFILL!!** Drain excess fluid from the unit if it is above the maximum level on the dipstick.
- Check the fluid level using the dipstick at least every 2,500 miles.
- Initial supercharger fluid change must be performed at 2,500 miles. The supercharger fluid must then be changed at least every 7,500 miles.
 1. Drain the fluid, re-fill the unit only with 4 oz. of manufacturer supplied lubricating fluid
 2. Confirm proper oil level using the dipstick. **DO NOT OVERFILL!!**
- The use of pulleys not supplied by the original supercharger manufacturer may void your warranty. NEVER force or hammer a pulley into place. Only precision fit pulleys and keys should be used.

WARNING

Use of any fluid other than the supercharger manufacturer supplied special lubricating fluid will void the warranty and may cause component failure.

Do not attempt to disassemble the supercharger in any way or warranty will be void.

READ LIMITED WARRANTY POLICY COMPLETELY before beginning installation or altering supercharger or supercharger system in any way.

[Print on: Neon red/pink/orange .015” thick plastic coated paperstock. Reinforced 3/8” diameter hole at one end, centered]