



Affordable Balance to Achieve Reliable Results

The Pioneer PX combines essential weighing functionality with competitive performance, offering high accuracy and repeatability for applications in laboratory, industrial and education settings. The PX is affordably priced, intuitively designed for intelligent operation with a second line display for additional information, and USB and RS-232 connectivity for easy communication.

Standard Features:

- **Competitive Performance at an Economical Price**
The PX offers high accuracy and repeatability for essential weighing applications in laboratory, industrial and education settings at an economical price point.
- **Durably Constructed for Long-Term Use**
Featuring a cast metal lower housing, sub-pan and stainless steel weighing pan, the PX is durably constructed for versatile, long-term use.
- **Designed for Simple, Intelligent Operation**
PX features a second line display for additional information and guidance, along with USB/RS232 connectivity for easy communication. Draftshield models feature a static removal (ESR) bar for convenient grounding.

PIONEER® Semi-Micro, Analytical and Precision Balances

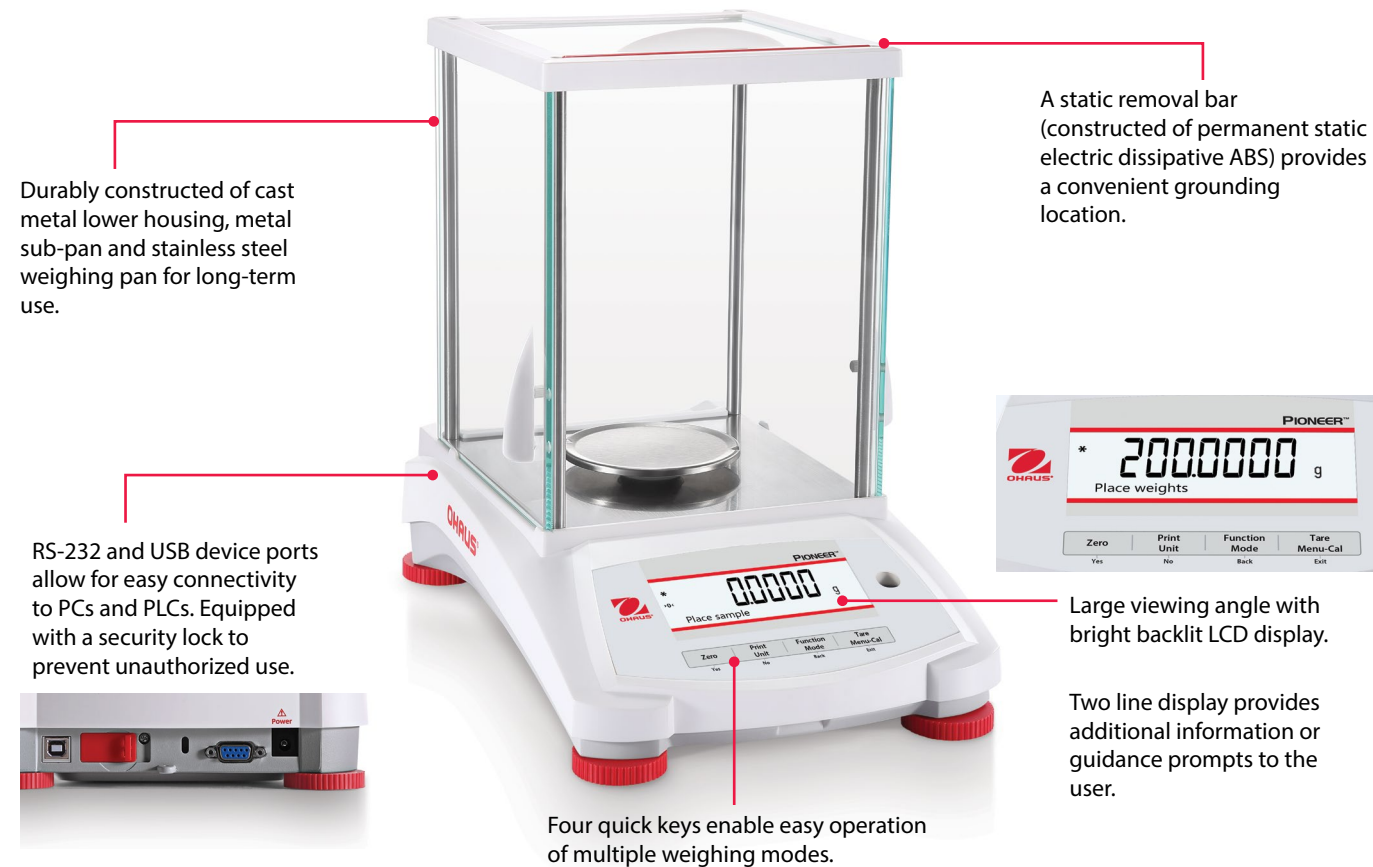

PIONEER® Semi-Micro, Analytical and Precision Balances



InCal™ Models	PX85	PX225D	PX84	PX124	PX224	PX163	PX323	PX523
ExCal Models			PX84/E	PX124/E	PX224/E	PX163/E	PX323/E	PX523/E
Capacity (g)	82	82/220	82	120	220	160	320	520
Readability (g)	0.00001	0.00001/0.0001		0.0001			0.001	
Repeatability (STDEV) (g)	0.00002	0.00002/0.0001		0.0001			0.001	
Linearity (g)		± 0.0001		± 0.0002			± 0.002	
Stabilization Time (s)		10		3			2	
Units	Milligram, Gram, Kilogram, Ounce, Pound, Carat, Pennyweight, Troy Ounce, Grain, Newton, Hong Kong Tael, Singapore Tael, Taiwan Tael, Momme, Tical (MM), Mesghal, Tola (India), Baht, 1 custom unit							
Applications	Basic Weighing, Parts Counting, Percent Weighing, Animal Weighing, Density Determination							
Pan Size (Ø)	3.15 in. / 80 mm		3.54 in. / 90 mm			4.72 in. / 120 mm		
Draftshield Size	6.8 × 5.2 × 8.1 in. / 172 × 131 × 205 mm							
Power Supply	Power Input: 100–240V ~ 200mA 50–60Hz 12–18VA Power Output: 12 VDC 0.5A							
Assembled Dimensions (W × D × H)	8.2 × 12.6 × 12.2 in. / 209 × 321 × 309 mm							
Operating Conditions	Operating conditions for ordinary lab application: 50° F to 86° F / +10 to 30° C (operability guaranteed between +5 and 40° C)							
Storage Conditions	14° F to 140° F / -10° C to 60° C at 10% to 90% relative humidity, non-condensing							
Net Weight	10 lb / 4.5 kg							
Shipping Weight	15.4 lb / 7 kg							
Shipping Dimensions (W × D × H)	21.7 × 15.2 × 11.5 in. / 507 × 387 × 531 mm							

InCal™ Models	PX1602	PX2202	PX3202	PX4202	PX2201	PX4201
ExCal Models	PX1602/E	PX2202/E	PX3202/E	PX4202/E	PX2201/E	PX4201/E
Capacity (g)	1600	2200	3200	4200	2200	4200
Readability (g)			0.01			0.1
Repeatability (STDEV) (g)			0.01			0.1
Linearity (g)			± 0.02			± 0.2
Stabilization Time (s)			1			
Units	Milligram, Gram, Kilogram, Ounce, Pound, Carat, Pennyweight, Troy Ounce, Grain, Newton, Hong Kong Tael, Singapore Tael, Taiwan Tael, Momme, Tical (MM), Mesghal, Tola (India), Baht, 1 custom unit					
Applications	Basic Weighing, Parts Counting, Percent Weighing, Animal Weighing, Density Determination					
Pan Size (Ø)	7.09 in. / 180 mm					
Draftshield Size	N/A					
Power Supply	Power Input: 100–240V ~ 200mA 50–60Hz 12–18VA Power Output: 12 VDC 0.5A					
Assembled Dimensions (W × D × H)	8.2 × 12.6 × 3.9 in. / 209 × 321 × 98 mm					
Operating Conditions	Operating conditions for ordinary lab application: 50° F to 86° F / +10 to 30° C (operability guaranteed between +5 and 40° C)					
Storage Conditions	14° F to 140° F / -10° C to 60° C at 10% to 90% relative humidity, non-condensing					
Net Weight	7.7 lb / 3.5 kg					
Shipping Weight	11 lb / 5 kg					
Shipping Dimensions (W × D × H)	21.7 × 15.2 × 11.5 in. / 550 × 385 × 291 mm					

PIONEER® *Semi-Micro, Analytical and Precision Balances*

Outline Dimensions

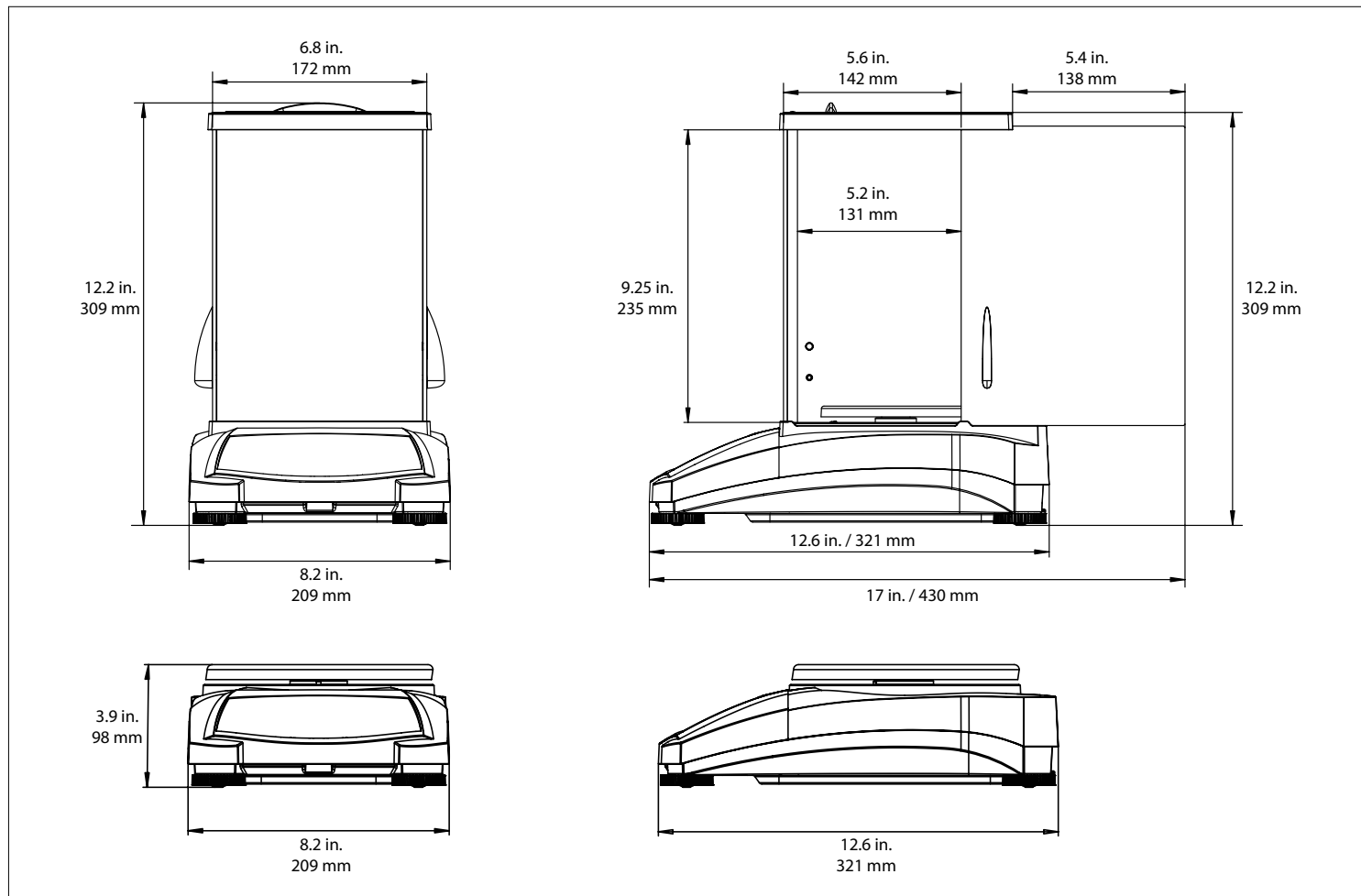

Other Standard Features and Equipment

Metal base, plastic top housing, removable stainless steel pan, removable glass draftshield or side doors, Real Time Clock with GLP/GMP Data, integrated weigh-below-hook, security bracket, calibration lock and in-use cover, user-selectable environmental filters and brightness settings, auto-tare, auto-dim, user-selectable span calibration points, overload indicator, software lockout and reset menu, user-selectable communication settings and data print options, user-definable project and user IDs, software overload/underload indicator, stability indicator, four operating languages

Compliance

- **Product Safety:** IEC/EN 61010-1; CAN/CSA C22.2 61010-1; UL 61010-1
- **Electromagnetic Compatibility:** IEC/EN 61326-1 Class B, Basic Environments; FCC Part 15 Class A; Canada ICES-003 Class A
- **Compliance Marks:** CSA

Accessories

Auxiliary Display	30472064
Density Kit	80253384
Sinker Glass for Density Determination.....	83034024
USB Interface Cable	83021085
Security Device	80850043
RS-232 Cable (25-pin)	80500524
RS-232 Cable (9-pin).....	80500525
Dust Cover	30093334
In-Use Cover	30372546
Printer SF40A	30064203
ION-100A	30130302

OHAUS CORPORATION

7 Campus Drive
Suite 310
Parsippany, NJ 07054 USA

Tel: 800.672.7722
973.377.9000
Fax: 973.944.7177

www.ohaus.com

The management system governing the manufacture of this product is ISO 9001:2015 certified.

