

**GOTRAX**

**FLEX**

ELECTRIC SCOOTER

**USER MANUAL**







# Congratulations on your purchase!

This user manual will help you assemble and operate your new Electric Scooter. Be sure to read **ALL OF THE INFORMATION** in this manual before riding.

**NOTE TO ALL RIDERS UNDER 13 YEARS OLD:**  
It's very important that you get parental permission before riding your electric scooter. Electric scooter for kids age of 13 .





# Don't Ride Until You Read This:



**Always** wear a helmet when riding your electric bike.



Make sure your electric bike has a **full battery** before taking it out to ride.



**Always** be aware of local road laws, and follow them.



**Do not** ride the bike under the influence of drugs or alcohol.



**Always** respect pedestrians.



**Do not** ride under wet conditions. The electric bike may slide from under your feet causing injury. Wet conditions may damage the electronics and void the warranty.



## Warning Message

1. **Avoid water** - The scooter is not waterproof. The electronics may be damaged due to water and water damage is not covered by our warranty. Riding in wet conditions is also very dangerous and may result in injury.
2. **Abuse** - We do not cover physical damage due to negligent care and extreme riding.
3. **Whenever you ride the GOTRAX scooter**, you risk severe injury or even death from loss of control, collisions, and falls. Use caution and ride at your own risk.
4. **Do not** modify the product from the manufacturer's original design.
5. **Keep** hands and all body parts away from moving parts while operating the scooter.
6. **Before riding** - Be sure to check the scooter over and make sure the scooter is operating correctly before each use.
7. **Before riding** - Be sure to check that the braking system is functioning properly; also be sure to check that all safety labels are in place and you understand the safety warnings.
8. **Before riding** - Be sure that any and all axle guards, chain guards, or other covers or guards supplied by the manufacturer are in place and in serviceable condition.
9. **Before riding** - Be sure to check that the tires are in good condition, inflated properly, and have sufficient tread remaining.
10. **Never** exceed the 264lbs (120 kg) maximum load rating.
11. The electric scooter should **never** be used by children under the age of 13.
12. **Maximum Speed** - Your electric scooter goes the maximum speed of 15.5 mph (25km/h).

# Unpack

You should find each of these items in your box:

1. Electric Scooter
2. Saddle
3. Carrier
4. Battery charger
5. 6mm hex socke

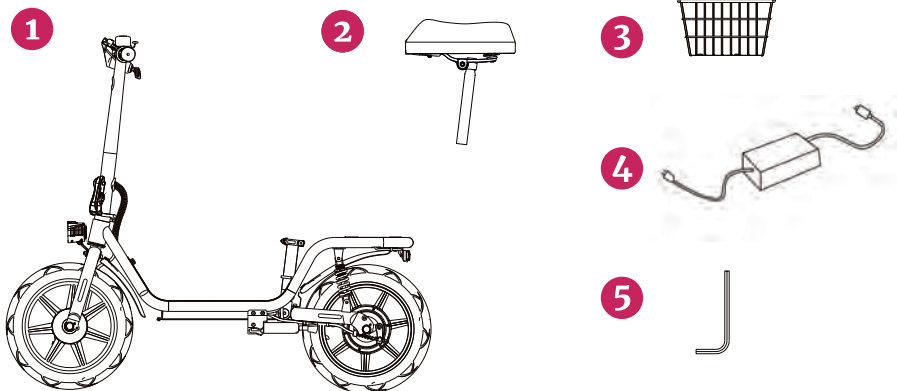

Remove all packaging material, then inspect each item for any accidental damage that may have occurred during shipping.



# Get To Know Your Scooter



## Specifications

Top Speed:	15.5 mph
Distance per Charge:	16 miles
Weight Range Up To:	264 lbs (120 kg)
Battery Type:	36V 7.8Ah
Battery Charger:	DC42V 1.5A
Charge Time:	About 5.5 hours
Motor Power:	400W
Power Requirements:	AC 100-240V~50/60Hz 1.8A



# Assemble Your Scooter

1. Stand the pole upright and lock the folding safety catch.

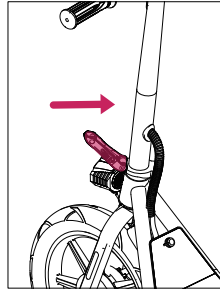
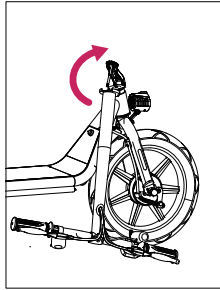

2. Use the tool to loosen the handlebar to fix the pressing block, load the handlebar hand, and lock the pressing block (the horizontal handlebar must be centered).

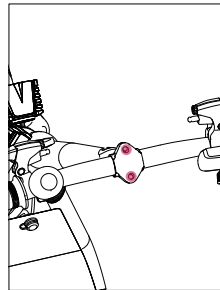
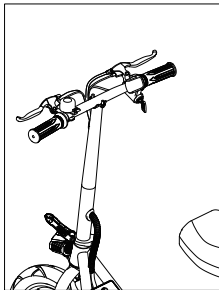
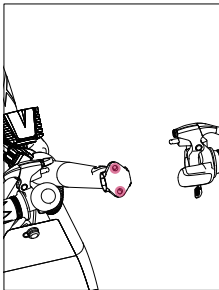



3. Install the saddle: Open the quick release handle and insert the saddle, adjust the right height for you and lock the quick release.

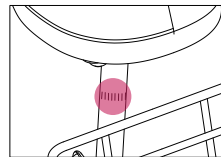
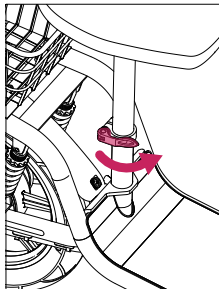
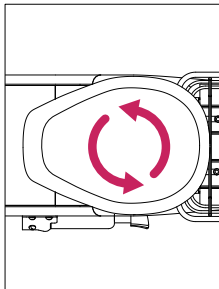
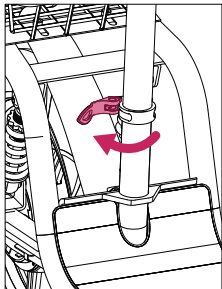

**CAUTION:** Make sure post at least is inserted to minimum insertion marking are NOT visible.

4. The screw holes on the basket correspond to the screw holes on the rear bracket, locking 4 screws to fix.

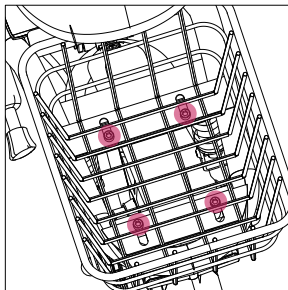



# Charge Your Scooter

Before using the scooter, you must fully charge the battery.

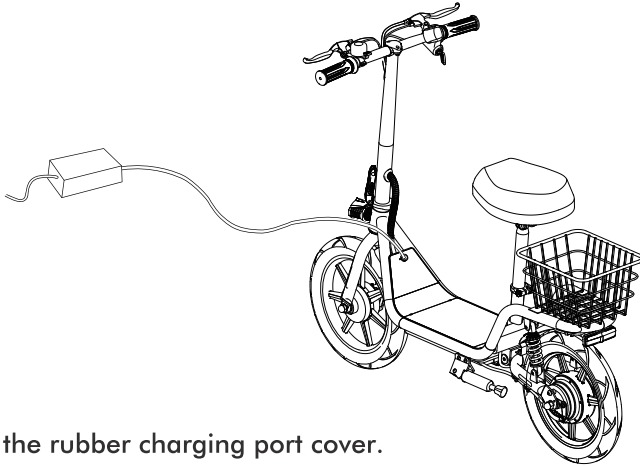

1. Open the rubber charging port cover.
2. Insert the charging plug into the port.
3. The charge box will show a green light when fully charged and a red light when charging.
4. When you are done charging be sure to cover the charging port to keep it clear of dust and debris.
5. Charging Time: About 5.5 hours.

**Charging Requirement:** Make sure to charge your scooter in conditions that do not exceed 104 degrees Fahrenheit or below 32 degrees Fahrenheit.



# Scooter function mode

1. First turn the key to the right to turn on, turn it twice to the right to turn on the headlights, and turn it in reverse to turn off the headlights or power.
2. Battery power display: When the battery is fully charged, it shows full charge (4 grids). According to the use of the battery power gradually decreases and the battery grid decreases in turn. When there is one grid left, it is marked as low power and needs to be charged in time.
3. Bell use: finger plucks the bell.



# Riding Tips

When you start riding your scooter, you need sit on the saddle, put one foot on the pedal, keep the other foot on the ground, press the accelerator and start moving.



# Fold/unfold your scooter

Before folding the scooter , make sure that the scooter is powered off.

**Folding:** Ensure the electric scooter is powered off, open the folding buckle and fold the tiller in the direction of the front wheel (as shown).

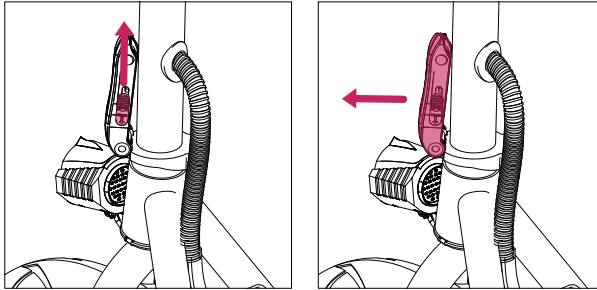

**Unfolding:** Pull the tiller up and pull the folding buckle towards the pole so that the folding buckle is locked (make sure the folding buckle is locked before riding).

# Maintenance & Repair

If you regularly clean and maintain your electric scooter, it will extend its life.

**Cleaning and storage:** If the scooter is dirty, wipe it clean with a soft damp cloth.

## **Brake adjustment:**

If the brake is too tight against the brake, turn the brake cable nut counterclockwise to loosen the brake cable.

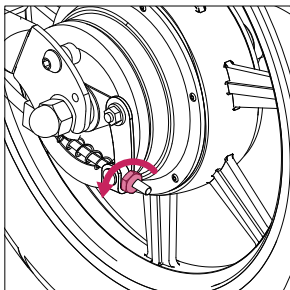

If the brake is too loose, turn the brake cable nut clockwise to tighten the brake cable.

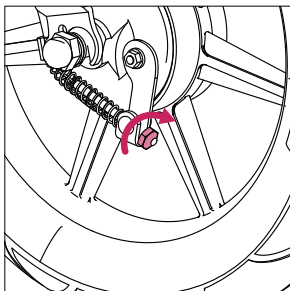

**Shock absorbing adjustment:** If the shock absorbing is too hard, turn the shock absorbing nut counterclockwise to loosen the spring, and the adjustment of the shock absorbing on both sides should be consistent.

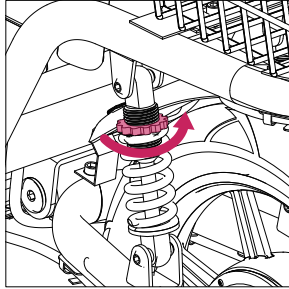

If the shock absorbing is too soft, turn the shock absorber nut clockwise to compress the spring, and the adjustment of the shock absorbers on both sides should be consistent.

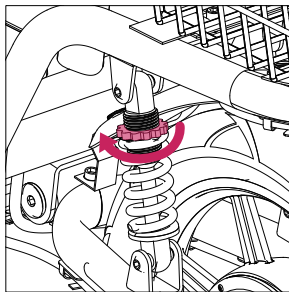

**Tires:** If you notice that the tire pressure is low, please fill to the recommended PSI on the side of the tire. Recommended PSI: 36

**DO NOT** use alcohol, gasoline, kerosene, or other corrosive chemical solvents to clean the scooter. It can severely damage the appearance and structure of the scooter. Please do not use a pressure washer as it may also cause damage to the electronics.

**Storage:** When you're not using your scooter, store it in a dry and cool location. Avoid storing your scooter outdoors because sun exposure can damage it's appearance and may cause wear on the life of the battery and tires.



# Battery Information

Only use the approved GOTRAX power adapter to charge your scooter, others may cause risk of fire & equipment may be damaged.

Improper disposal of used batteries may seriously pollute the environment. Please comply with local disposal regulations.

Make sure to store your scooter and power adapter in conditions that do not exceed 122 degrees Fahrenheit or below -4 degrees.

**Warning** - Risk of Fire - No User Serviceable Parts, The prolonged exposure to UV Rays, Rain and the Elements may damage the enclosed materials. Store indoors when not in use.

## Troubleshooting

We frequently update our user manuals at **GOTRAX.com**, and reserve the rights to update and change manuals online.

**Please contact our customer service team if you are experiencing problems or need more detailed information. They can be reached at GOTRAX.com**





# Warranty

Please contact our customer service team if you are experiencing problems or need more detailed information.

US team after-sales email: **support@gotrax.com**

CA team after-sales email: **canada@gotrax.com**

1. Users should operate in accordance with the product manual. In case of any performance fault caused by production quality, the company shall perform the obligations of the three guarantees in accordance with the provisions of relevant laws and regulations of the state.
2. The company is still responsible for the after-sales service of the faults beyond three guarantees and the major components in the three guarantees, but there will be a cost for repair.
3. If the battery replacement is over the warranty time, our company will supply the battery at factory price. To ensure safety, and avoid pollution.
4. We do not cover physical damage due to negligent care and extreme riding.





WWW.GOTRAX.COM

#RideGOTRAX





## **(US) GOLABS, INC**

GOTRAX.com  
2201 Luna Rd.  
Carrollton, TX 75006

## **(CA) Tao Motor Canada Inc.**

170 Bartor Road, Unit 1 North York,  
Ontario M9M 2W6,  
Canada.