

# GO TRAX

## Honeycomb Tire Installation (Front)

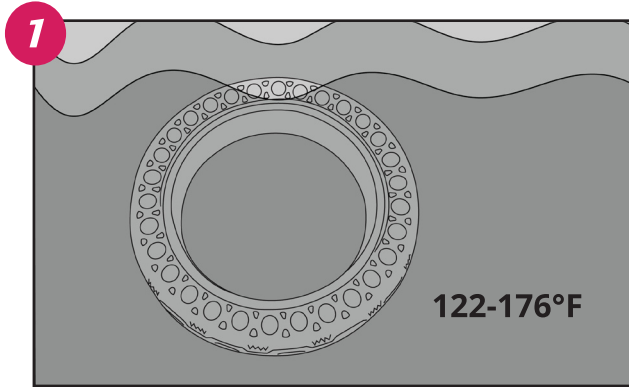

**STEP 1:** Soak tire in hot water for 5-10 minutes to make it softer and easier to install. Immerse tire completely.

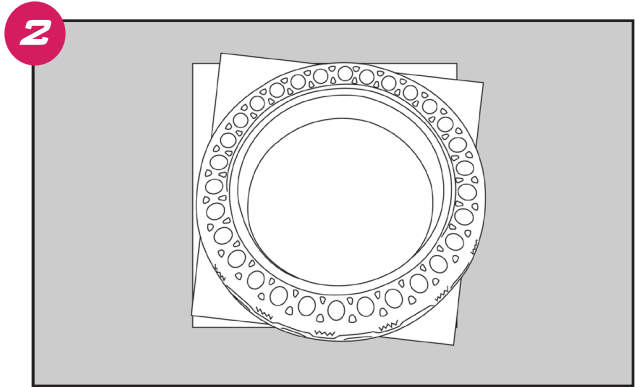

**STEP 2:** Set the honeycomb tire on a soft surface or on top of a folded towel to protect the rim and axle from damage during installation.

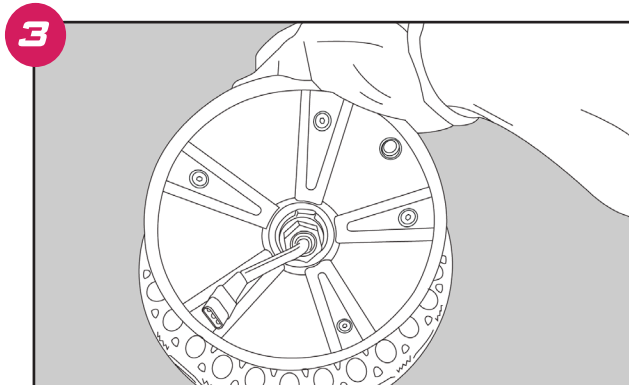

**STEP 3:** Angle the rim and press it onto one side of the honeycomb tire.

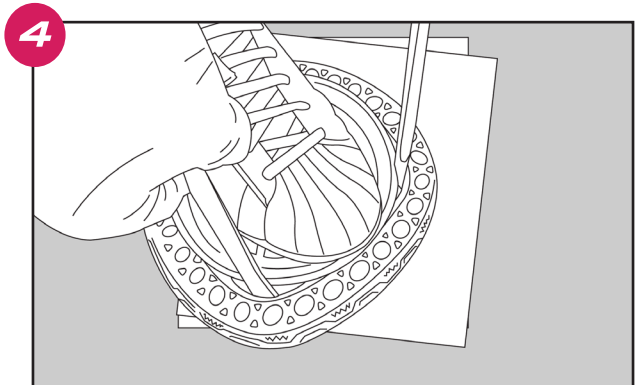

**STEP 4:** Using your foot apply pressure and install 2 tire levers. Apply pressure to the tire levers while pressing down with your foot. The tire will stretch around rim with the proper amount of force.

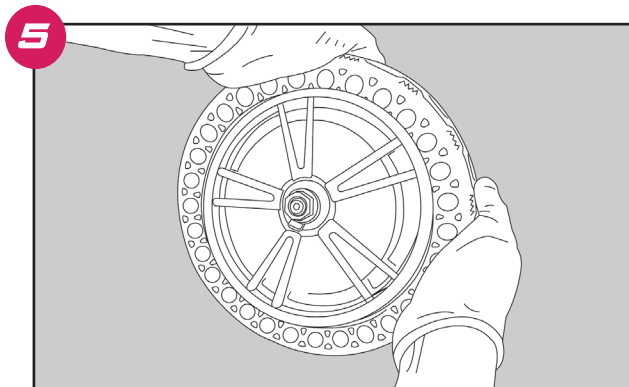

**STEP 5:** Once the tire is stretched around the rim remove the tire levers. Using your hands you can massage the tire onto the rim to seat the bead correctly.

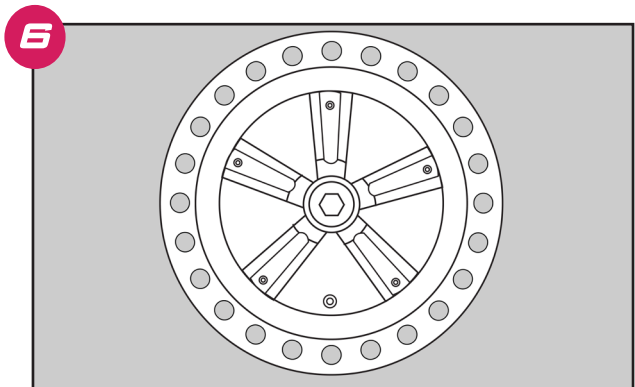

**STEP 6:** Once the bead is seated properly on the rim reinstall tire onto the scooter.