

**Mi-ONE** Brands

@mipodvape

**Mi-POD  
PRO**

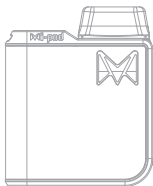

User Manual



## MI-POD PRO FILLING INSTRUCTIONS

\*The Mi-Pod Pro Pods take Nic Salts, E-Liquid PG/ VG ratios 70/30, 60/40, 50/50, & CBD.\***DO NOT OVERFILL THE POD.**  
**\*DO NOT GET E-LIQUID IN THE CENTER AIRFLOW.**

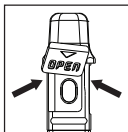

1) Open the side filling cover.

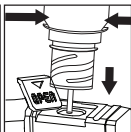

2) Inject directly into the Chamber slot and put the cover back.



3) Let Sit for 5 minutes to soak the cotton

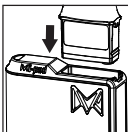

4) Put the filled cartridge into the Mi-pod body with the gold pins facing each other.

## MI-POD PRO FEATURES



1) Connect the lanyards through the lanyard slot

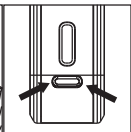

2) Click the power button 5X fast for on/off

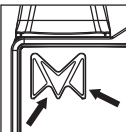

3) Battery level indicated in LED viewing window

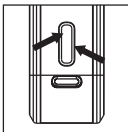

4) USB-C Charging port.  
\*Use 1AMP Charging.\*

**PLEASE READ THE USER MANUAL CAREFULLY BEFORE USING.**

**SAVE THESE INSTRUCTIONS**

## MI-POD PRO DEVICE DIAGRAM

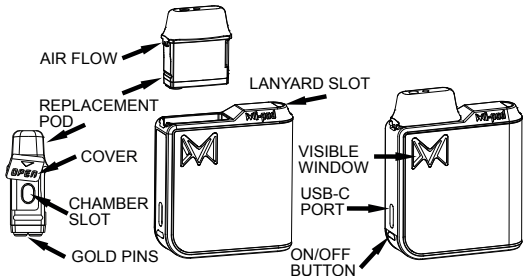

## ABOUT MI-POD PRO

The Mi-Pod Pro is a super compact & innovative electronic vapor starter kit with 2mL E-Juice capacity and a custom made 950mAh built-in battery. Featuring a patented OAS system (Oil and Air Separated), with top air flow and no leaking, the Mi-pod brings you a new vaping experience. Furthermore, the Mi-pod is made with an auto draw function, 3-color power indicators and pass-through charging with USB-C, making it very convenient to use and charge.

## MAIN FEATURES

- The first innovative dual air flow design, Oil and Air Separated, top flow, no leaking
- Compact size and large battery capacity (950mAh and 2mL E-Juice Capacity)
- Replaceable Cartridge (Disposable/Refillable)
- Auto-Draw & On/Off Button
- Power Display: Blue, Purple and Red (High, Med, Low)
- 10 Seconds Cut Off
- Short Circuit Protection
- Low Voltage Protection
- Low Resistance Protection
- Over Heating Protection (PCBA Temperature)

## TECHNICAL SPECIFICATIONS

- ⦿ Power Mode: Full-Power Output
- ⦿ Maximum Current: 15A
- ⦿ Cartridge Resistance Range: 0.9ohm
- ⦿ Battery: Built-in 950mAh Square High-Drain Lithium Battery
- ⦿ Output Voltage: 3.0-4.2V
- ⦿ Power Display: Blue, Purple, & Red
- ⦿ Working Mode: Auto Switch & ON/OFF Button

## HOW TO USE

1. E-Juice Filling: Take out the cartridge and open the cover, inject directly into the chambered slot and put the cover back (Refillable Cartridges)
2. Install: Put the filled cartridge into the Mi-pod body properly.
3. On/Off: Press the button rapidly 5 times, the Mi-Pod will flash red 5 times to indicate the Mi-pod is ready to use. In the same way to turn the Mi-Pod off rapidly press the button 5 times.
4. Vaping: Start to inhale and the window light will turn on at the same time. (The window light will change color due to power level.)

## STEALTH MODE

Hold the power button for 5 seconds. The light will flash 2 times. This will indicate that the stealth mode is active. No light will illuminate when inhaling. To turn the light back on, hold the button for 5 seconds again. The light will flash 2 times indicating that the stealth mode is inactivated.

## WORKING TIME

10 Second Cut Off: If inhaling more than 10 seconds, the Mi-pod will turn off. Press the power button rapidly 5 times to activate your Mi-pod.

## CHARGING

**REMOVE THE POD FROM THE MI-POD PRO DEVICE BEFORE CHARGING.** Simply charge the Mi-Pod device by connecting it with a 1 AMP wall adapter via USB- C cable supplied in kit. LED is lighting and showing the current power status. During the charging duration, the LED light will change from red, to purple, then to blue. When its fully charged, the LED light will turn off. If the Mi-pod is fully charged when plugging in to the wall charge the LED Light will flash blue 10 times to indicate the Mi-pod is fully charged. **ONLY CHARGE THE MI-POD DEVICE WITH 1AMP WALL CHARGERS AND THE SUPPLIED USB -C CABLE. INDOOR CHARGING ONLY.**

## LED INDICATORS

### WHILE IN USE:

- Blue 3.7V-----Full Battery
- Purple 3.4-3.7V-----50% Battery
- Red 3.4V-----Low Battery

### SAFETY PROTECTION:

- Red Light Flashes 10 times: -----Low Voltage Protection  
Over Using (Seconds Cut Off)
- Red Light Flashing 4 Times: -----Short Circuit Protection  
Low Resistance Protection  
Over Heating Protection (PBA Temperature)

### FULLY CHARGED:

- Blue Light Flashes 10 times: -----Fully charged Mi-Pod Pro.

## IMPORTANT SAFEGUARDS

### PLEASE READ THE USER MANUAL CAREFULLY BEFORE USING:

1. This product is not intended for persons under the age of 21 years, non-smokers, pregnant or breast-feeding women, persons at risk of heart disease, person with hypertension and diabetes, or anyone taking medication for depression or asthma, persons who are sensitive to nicotine.
2. This product contains small parts, please keep out of reach of children and pets.
3. Keep away from high temperature or moist and excessively cold environments.
4. Please dispose properly.
5. This product is not a smoking cessation device.

## CAUTIONS-IMPORTANT SAFEGUARDS

1. If using this device with e-liquids containing nicotine, always read the safety instructions from the e-liquid manufacturer that accompany the e-liquids.
2. Nicotine is an addictive chemical. Do not use nicotine containing liquids if you are pregnant or breastfeeding. Avoid e-liquid with nicotine coming in contact with skin. Should nicotine containing e-liquid come in contact with skin, wash affected area immediately.
3. If at any time you are feeling ill from exposure to liquid nicotine or from using this product in conjunction with nicotine containing e-liquids, discontinue use and call the Poison Control Center at 800-222-1222.

# CAUTIONS-IMPORTANT SAFEGUARDS

1. Please turn off the device when it is not in use.
2. Do Not leave the charging device unattended.
3. Do not drop, throw or abuse your device, which may cause damage.
4. Please use the USB -C charger your device came with properly charging with 1AMP wall charger.
5. Keep away from water and any flammable gas or liquid.
6. Do not expose the device to direct sunlight, dust, moisture or mechanical shock.
7. Do not expose the device to extreme temperature. (Recommended temperature range: -10~60°C/14~140°F while using and -10~45°C/14~113°F while storing).
8. Battery Recycling: The product battery should not be treated as household waste, instead, it should be handed over to the applicable battery collection point for recycling.
9. Only have your device repaired by Mi-One® Brands; do not attempt to repair the device by yourself as damage or personal injury may occur.
10. Should you experience any adverse effects from using this product, please visit <https://mipod.com/pages/vapevigil>

## WARRANTY

Warranty period is 180 days from date of purchase by the end users. Please consult with Mi-One® Brands directly or your Mi-One® Brands distributors on warranty or return policy details. Mi-One® Brands reserves the right of final decision in all warranty cases, Mi-One® Brands may interpret and revise the content of this warranty terms. For more warranty or return policy information, please visit the official website [mipod.com](https://mipod.com). Contact Customer Service online at <https://mipod.com> via live chat or email [support@mipod.com](mailto:support@mipod.com) also by phone (800) 768-9982



\*Scan QR Code with phone camera for easy Online access\*

## REGISTER YOUR AUTHENTIC DEVICE

**REGISTER ONLINE**  
**MIPOD.COM**

**MIPOD.COM/REGISTER**



\*Scan QR Code with phone camera for easy Online access\*

## MI-POD PRO NEWS & NEW ITEMS



**STAY UP TO DATE ON LATEST NEWS**  
**GET THE HOTTEST DEALS**  
**MIPOD.COM**

**CHECK OUT WHAT'S NEW SCAN THE QR CODE**

\*Scan QR Code with phone camera for easy Online access\*

## MANUFACTURER CUSTOMER SERVICE

Customer Service Hours: Mon - Fri 9am - 5pm AZT

Instagram: mipodvape  
Phone: 800-768-9982

Email: Support@mipod.com  
Live Chat: smokingvapor.zendesk.com

 @mipodvape



Designed in the USA, Made in China

[WWW.MIPOD.COM](http://WWW.MIPOD.COM)