

# The Clipper Prelude 526



## Technical Specifications

● Extreme Height	91" /232 cm
● Extreme Width	78.5"/200 cm
● Extreme Length	91.5"/233 cm
● Width on Floor	69.5"/177 cm
● Length on Floor	73.5"/187 cm

## Electrical Requirements

● Main Fan Motor	10 H.P./7.5 Kw
● Eccentric Motor	2 H.P./1.5 Kw
● Vibratory Feeder Motor	Optional

## Air Output

6,000 CFM

## Capacities\*

● Small Seed	100 Bu./Hr. (1.3 MT/Hr.)
● Medium Seed	175 Bu./Hr. (3.1MT/Hr.)
● Large Seed & Wheat	200 Bu./Hr. (5.4 MT/Hr.)
● Market Cleaning	600 Bu./Hr. (16.3 MT/Hr.)

## Options

- Electronic Variable Speed hopper
- Electronic Variable Speed Shoe Shake
- Grease Line Package

## Features

- Heavy duty construction – Easily Portable

\*Note: Capacities may vary depending on seed condition, moisture content, seed varieties, types and volumes of contaminants to be separated and the percentage of foreign materials acceptable in the final product.



2293 S. Mount Prospect Rd., Des Plaines IL 60018  
Toll Free: 800-284-5779 sales@seedburo.com / www.seedburo.com

RIGHT HAND SIDE VIEW  
PRE-SCALP, SPLIT SIFT

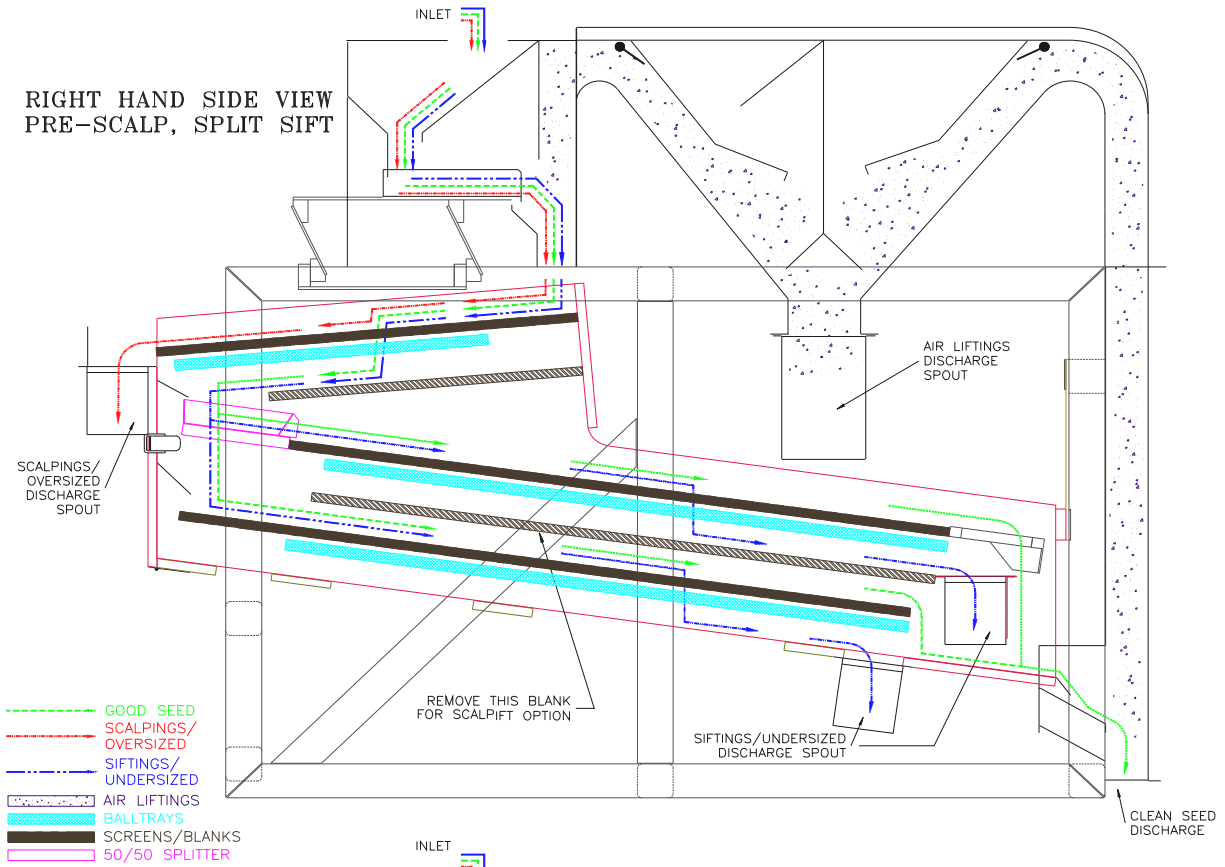

- GOOD SEED
- SCALPINGS/  
OVERSIZED
- SIFTINGS/  
UNDERSIZED
- AIR LIFTINGS
- BALLTRAYS
- SCREENS/BLANKS
- 50/50 SPLITTER

RIGHT HAND SIDE VIEW  
PRE-SCALP, SCALP/SIFT

