

# people power press

## Custom Button Template

Once you have read the instructions below, turn off the Instructions Layer to access the template

- Open the template and create your artwork in the file - do not copy the template into a new file.
- Create your artwork at 300 dpi in CMYK format.
- Everything inside the **BUTTON FACE GUIDE LINE** will be on the front of your button.
- Any background colour or pattern must extend to the **CUT LINE** but not past it (no bleed).
- All text **MUST** be outlined or flattened.
- Keep any front text inside the **SAFE AREA** line or it may be cut off at the edge.
- Text on the edge of the button must fit between the black ——— lines.
- The **CUT LINE** must be completely visible.
- Turn OFF or delete **BUTTON FACE** and **SAFE AREA** guide lines so they are not visible
- Send us your artwork as a JPEG, TIFF or PDF or as a PSD or AI File.

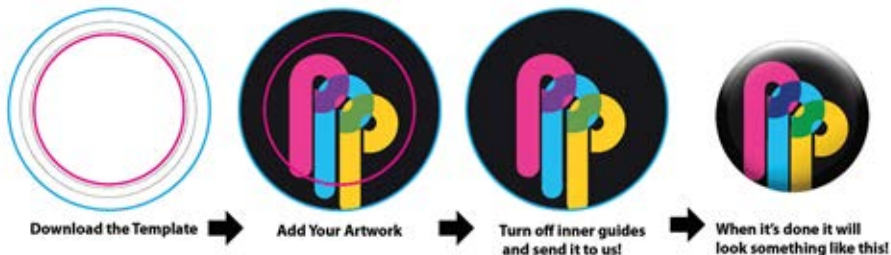

## 2.5" Diamond