

Feature

- ☆ $\pm 0.5, \pm 1\%$ F.S Accuracy
- ☆ High stability, High reliability
- ☆ Ceramic sensor from Germany
- ☆ Multiple connectors and ports
- ☆ CE, RoHS approved

Application

- ☆ Compressor
- ☆ Building water supply
- ☆ Hydraulic control
- ☆ Air conditioner
- ☆ Auto Engine
- ☆ Automatic detecting system
- ☆ Hydraulic pressure station
- ☆ Refrigerator



Description

CS-PT1200 series of pressure transmitters feature high quality, high stability, small size, low weight, compact structure, low cost and mass production. The products are widely used to measure pressure of air compressors, auto engines, air conditioning equipment, etc.

Stainless steel housings are ideal for industrial environment. Pressure sensing elements are selected from well known international brands. The products have been approved with CE, intrinsically safe, and explosion-proof certificates.

Non-polar two-wire current and three-wire voltage output are provided.

Products are produced according to military standards of advanced design, perfect technology, scientific management, strict production and quality control and have been sold to over 50 countries.

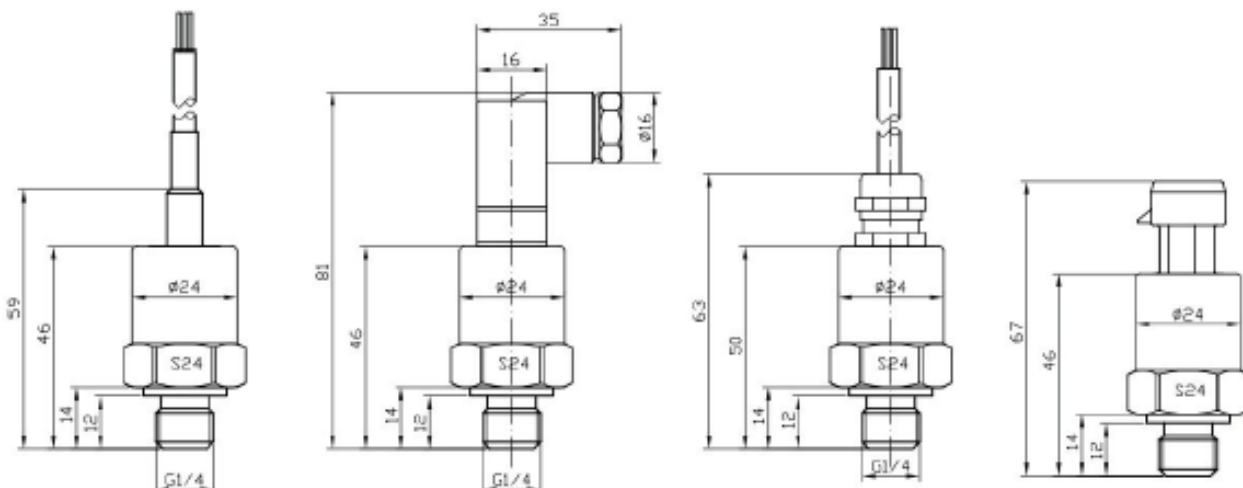

| Parameter | Value | | Note |
|--------------------------|---|-----------------|-------------|
| Measurement range | -1-0bar...600bar | | 1bar=100kpa |
| Overload pressure | 1.5 * pressure range | | |
| Broken pressure | 3 * pressure range | | |
| Accuracy | ±0.5%F.S ±1%F.S | | |
| Stability | Typical 0.5% F.S, maximum: 1 %F.S | | |
| Operating temperature | -40℃~100℃ | | |
| Compensation temperature | -10℃~80℃ | | |
| Medium compatibility | Corrosive medium compatible with 1Cr18Ni9Ti,Ceramic | | |
| Wires | Two-wire | Three-wire | |
| Output signal | 4~20mA | 0.5-4.5V | |
| Supply voltage | 10~30Vdc | 5Vdc 10-30Vdc | |
| Load resistance | (U-10)/0.02(Ω) | >100KΩ | |
| Insulation | >100M Ω@50V | | |
| Electrical connection | DIN43650A/C, Packard,M12 Seial, Cable | | |
| Shell/Wire protection | IP65 | | |
| Pressure form | Gauge G, Absolute A | | |
| Pressure port | G1/2 G1/4 NPT1/4 M20×1.5 7/16-20UNF | | |
| Response time | 10ms | | |
| Certification | CE,Intrinsic-safety explosion E, Isolated explosion-proof D | | |
| EMC | EMI:EN50081-1/-2, EMS:EN50082-2 | | |

Type Selection Guide

