

SERVICE & IMPORTANT NOTICE

- If the supply cord is damaged, it must be replaced by the manufacturer or its service agent or a similarity qualified person in order to avoid a hazard.
- **WARNING:** This appliance is not intended for use by persons (including children) with reduce physical, sensory or mental capabilities, or lack of experience and knowledge, unless they have been given supervision or instruction concerning use of the appliance by a person responsible for their safety.

Toyomi®

INSTRUCTION MANUAL

Please read carefully and keep the instruction well

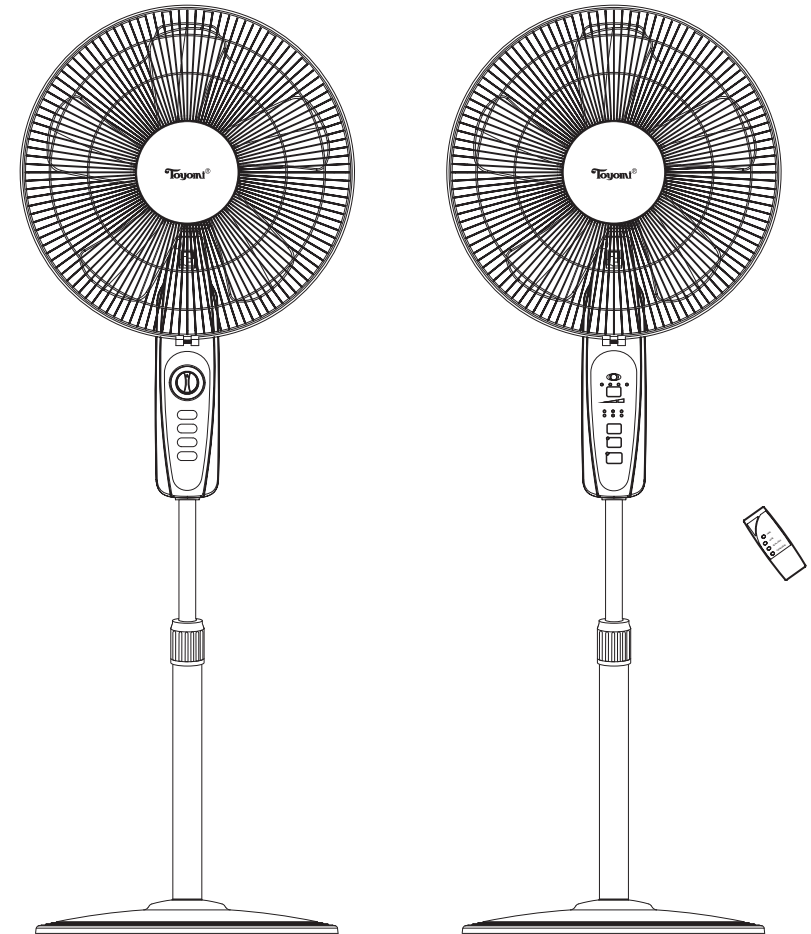

**16" ELECTRIC STAND FAN
MODEL: FS 1688
220-240V~50Hz, 60W**

**16" ELECTRIC REMOTE STAND FAN
MODEL: FS 1654R
220-240V~50Hz, 60W**

IMPORTED BY NATIONAL ELECTRICAL TRADERS

The remote control must face to the receiver

1. The using range of the remote control must be within 7 meters away from the receiver. If the remote control isn't faced to the receiver, it's using range will be narrowed.
2. If this fan is used in the room with operating high-power machines, the remote control may be out of order.
3. Don't put any obstructions between the receiver and the remote control.
4. If you don't use the remote control, please take the cell out and keep it well.
5. Please take good care of the remote control and avoid knocking and breaking it.

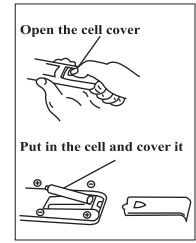
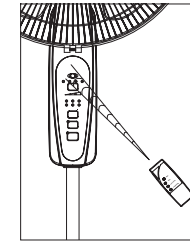

Soft-touch Control (for FS 1654R only):

Controlled with soft-touch type key: The functions of the key are the same with remote control type respectively.

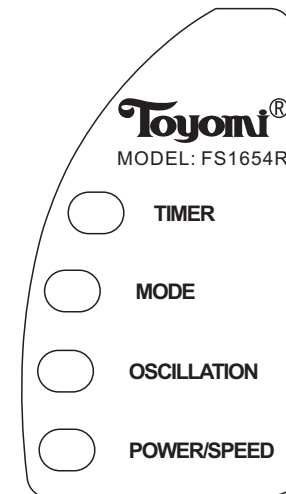

CLEANING AND STORAGE

1. Be sure your fan is in the OFF position.
2. Unplug the fan from the electricity supply.
3. Loosen the tightening Plastic Ring and remove the Front Grille.
4. Unscrew the Spinner by turning it CLOCKWISE (REVERSE THREAD).
5. Pull the Fan Blade away from the motor housing.
6. Gently Wipe the Fan Blade and Grilles with a damp cloth.
7. DO NOT immerse the fan in water and never allow water to enter into the motor housing.
8. DO NOT use gasoline. Paint thinner or other chemicals to clean the fan.
9. For storage, disassemble and clean the fan carefully as instructed and store in its original box. You may leave the fan assembled and covered to protect it from dust. Store the fan in a cool dry place.

OPERATION

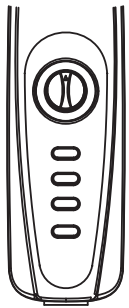
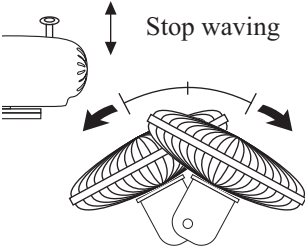
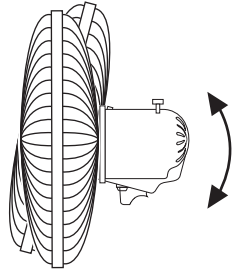
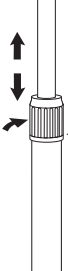
 <p>Turn the knob of Timer Switch to the right and set the timer. The Timer Switch is cut at time within 120 min.. To run fan continuously, set the Timer Switch to ON. (For FS 1688 only)</p> <p>Press the Switch of 0 to turn off the fan, 1 for low wind speed, 2 for medium wind speed and 3 for high wind speed. (For FS 1688 only)</p>	 <p>Stop waving</p> <p>Press the Oscillation Knob, the fan begins to wave. Pull the Knob, the fan stops waving. (For FS 1688 only)</p>
 <p>You can choose the up and down angle and control the wind direction freely.</p>	 <p>Height regulation: Loosen the Height Adjustment Knob, regulate the chrome pipe to the needed height, tighten the knob.</p>

Remote Control (For FS 1654R only):

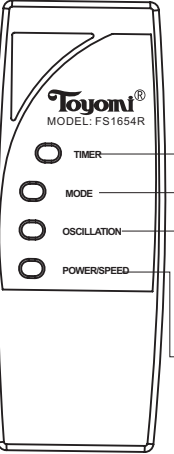
	<p>Press this key, you can set the time needed. The following diagram shows the order of the timer setting. Do not press the timer key, when the fan will be required to operate continuously. At the moment, all timer LED don't light.</p> <p>→ 0.5→1.0→1.5→2.0→2.5→3.0→3.5→4.0→4.5→5.0→5.5→6.0→6.5→7.0→7.5</p> <p style="text-align: center;">Continue</p>
	<p>Press this key, there are three feature wind mode could be choose, press this key as you desired.</p> <p style="text-align: center;">→ NOR.→NAT.→SLEEP</p> <p style="text-align: center;">Recycle</p>
	<p>This key serves to start or stop the fan oscillation. IMPORTANT NOTE: Do not try to change the fan head direction forcibly by hand; otherwise the fan will be damaged.</p>
	<p>Press this key, it will be in wind speed state, the relative indicator light will be on. Press this key again, the following diagram shows the order of the wind flow.</p> <p>→ LOW→MED.→HIGH→OFF→LOW→MED.→HIGH→OFF→...</p> <p style="text-align: center;">Recycle</p>

Thank you for choosing our Electric Fan. Your new fan has been designed using the latest technology. With normal maintenance, your Electric Fan will provide years of satisfactory performance. Please read and save this Owner's Manual carefully before using this fan!

SAFETY INSTRUCTIONS

When using electrical appliances, basic precautions should always be followed to reduce the risk of fire, electric shock and injury to persons, including the following:

1. Use this fan only as described in this manual. Other use not recommended may cause fire, electric shock or injury to persons.
2. DO NOT use outdoors.
3. To protect against electric shock, do not place fan in window, immerse unit. Plug or cord in water or spray with liquids.
4. This fan requires a grounded power source. Never connect this fan to any power source other than properly grounded ones. DO NOT attempt to defeat this safety feature.
5. Close supervision is necessary when any appliance is used by or near children.
6. Avoid contact with moving fan parts.
7. Turn the fan to the OFF position and unplug the fan from the outlet when not in use. when moving the fan from one location to another, assembling and before cleaning.
8. To disconnect the fan, first turn control to the OFF position, grip the plug and pull it from the wall outlet. Never pull by the cord.
9. DO NOT operate the fan in the presence of explosive and/or flammable fumes.
10. Place the fan on a dry level surface.
11. DO NOT operate the fan with a damaged cord or plug or if the product malfunctions, is dropped or damaged in any manner.
12. The use of attachments not recommended by the manufacturer may be hazardous.
13. DO NOT place the fan or any parts near an open flame, cooking or other heating appliance.
14. DO NOT hang or mount fan on a wall or ceiling.
15. DO NOT operate if the fan housing is removed or damaged.
16. A loose fit between the AC outlet (receptacle) and Plug may cause overheating and a distortion of the Plug. Contact a qualified electrician to replace loose or worn outlet.
17. DO NOT operate the fan without the protective front and rear grilles in position.

MAIN PARTS

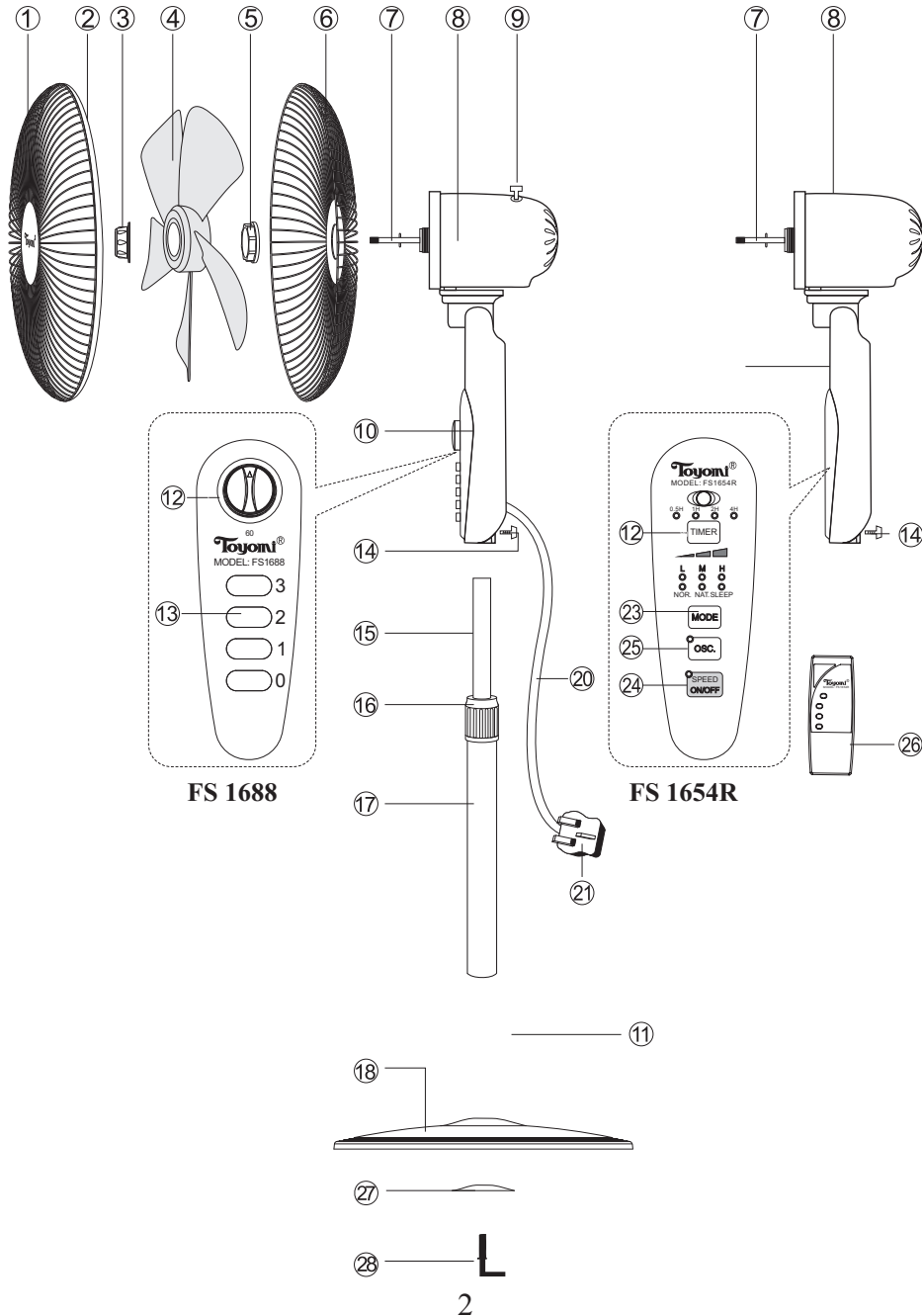

1	Front Grill	15	Adjustable Pole
2	Plastic Ring	16	Adjustable Pole Tightening Knob
3	Spinner	17	Pillar
4	Blade	18	Base
5	Plastic Nut	19	Pillar Tightening Nut
6	Rear Grill	20	Power Cord
7	Motor Housing Axis	21	Plug
8	Motor Housing	22	LED Indicator Light (For FS 1654R only)
9	Oscillation Knob (For FS 1688 only)	23	MODE Switch (For FS 1654R only)
10	Manual Control Panel	24	ON/Speed Switch (For FS 1654R only)
11	Decorative Base Cover	25	Oscillation Switch (For FS 1654R only)
12	Timer Switch	26	Remote controller (For FS 1654R only)
13	Speed Button (For FS 1688 only)	27	Washer
14	Screw of Control Panel	28	L Screw

ASSEMBLY

Assembling the Base, Pillar, Adjustable Pole and Manual Control Panel.

- Step 1. Align the pillar over the base, making sure that the holes in the pillar align with the holes in the base. Screw the Pillar Tightening Nut onto the Pillar clockwise to tighten into the base until secure.
- Step 2. Hold the Adjustable Pole & loosen the Height Adjustment Knob by twisting it counter-clockwise, adjust the pole to the desired height and tighten the Height Adjustment Knob.
- Step 3. Place the Manual Control Panel onto the Adjustable Pole and tighten the Screw of Control Panel.

BLADE AND GRILLS ASSEMBLY

1. Remove the spinner and the plastic nut from the front side of the motor. Fix the rear grill and plastic nut to the motor shaft then tighten the plastic nut. Take the plastic ring out of packing carton, slip the ring of the rear grill into the deep slot of the plastic ring. (Figure 1)
2. Discard PVC sleeve on shaft. Insert the blade into shaft, make sure the stopper pin is clipped into the groove of the blade. Screw the spinner counter-clockwise to tighten the blade. (Figure 2)
3. After put the centre piece of the front grill upright, slip the ring of the front grill into the another slot of the plastic ring, tighten the bolt in the joint of the ring by a screwdriver. (Figure 3)

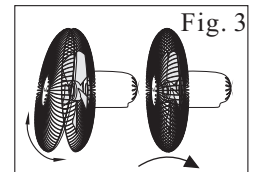
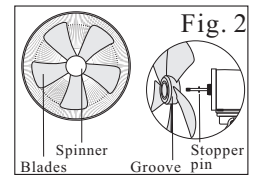
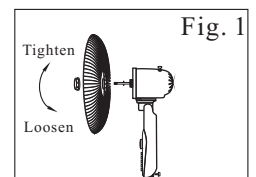

Caution: To avoid the risk, make sure the Plastic Ring tie the Front Grille and Rear Grill up before operating.