

## SERVICE & IMPORTANT NOTICE

- If the supply cord is damaged, it must be replaced by the manufacturer or its service agent or a similarity qualified person in order to avoid a hazard.
- WARNING:** Please **do not** use where children can touch the unit, nor let children use the unit by themselves.

**Toyomi**<sup>®</sup>

## ELECTRIC WATER DISPENSER

MODEL: EWP 747

220-240V~, 50-60Hz, 750-890W

CAPACITY: 7.0L

## INSTRUCTION MANUAL

Please read carefully and keep the instruction well

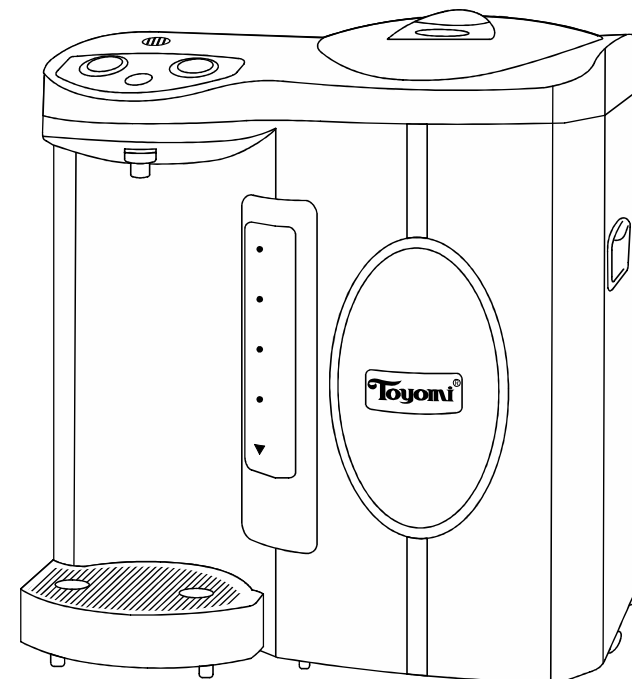

## IMPORTANT NOTICE

- Firstly empty all warm water by taking out rubber stopper before empty hot water.
- Be careful of steam when opening the lid, keep away from touch of children.

IMPORTED BY NATIONAL ELECTRICAL TRADERS

# PARTS NAMES

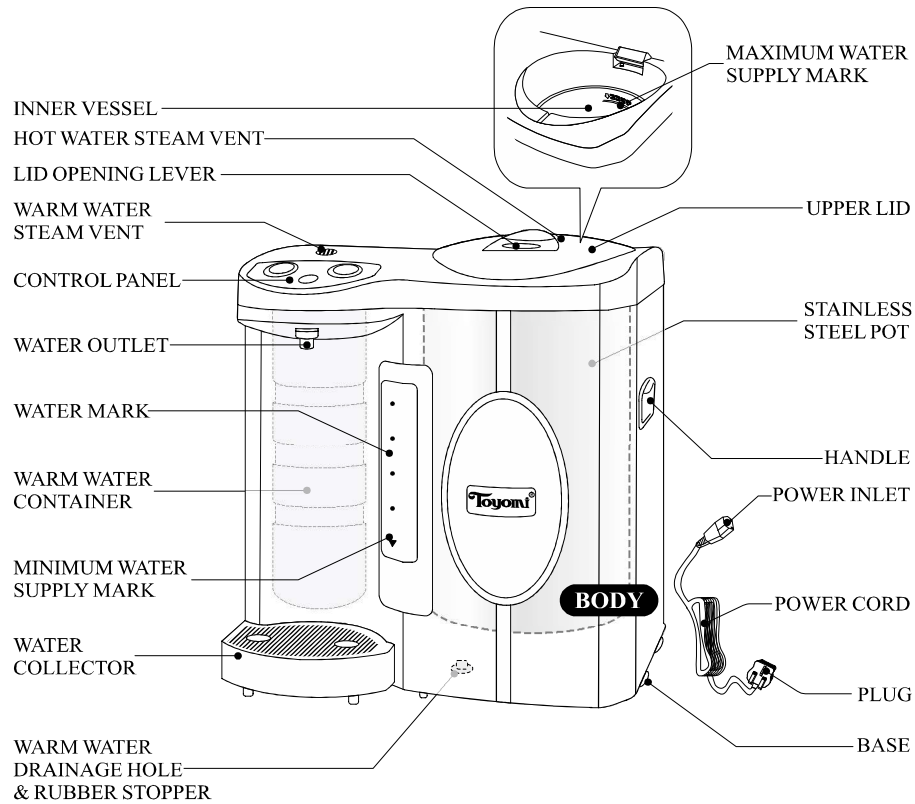

## CONTROL PANEL

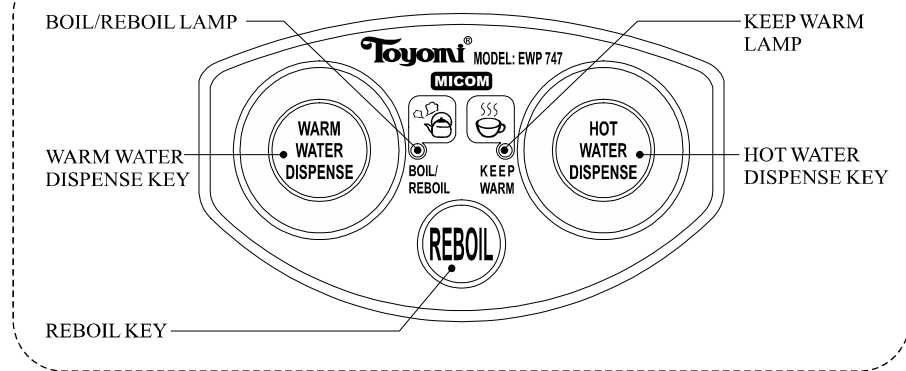

2	输水泵发出抽干水噪音	不锈钢内胆无水及温水箱未 满水	加水
3	指示灯亮不加热	(1) 中间接线松脱 (2) 电热管元件烧坏	送指定的维修部维修
4	保温指示灯闪烁并发出 “哔...”声	不锈钢内胆无水	加水

## BEFORE CALLING FOR SERVICE

NO.	CONDITION	CAUSE	REMEDY
1	Press Hot Water Dispense Key, Water does not pour.	Hot Water Dispense Key lock is engaged automatically during heating.	After boiling, Water Dispense Key will be unlocked automatically.
		Stainless steel pot is empty.	Refill
	Press Warm Water Dispense Key, Water does not pour.	After above-mentioned remedy, still not recovered.	Deliver to its service agent.
		Transportation pump lock is engaged automatically during heating, Warm Water Container is empty.	After boiling, 60sec. After a buzzer sound 1 time, transportation pump will fill Warm Water Container from Stainless Steel Pot, Warm water supply normally.
	Both pot & container is empty.	Refill	
		After above-mentioned remedy, still not recovered.	Deliver to its service agent.
2	Loud noise of exhaust pump	Stainless steel pot is empty & Warm Water Container is not full.	Refill
3	Lamps work normally, water does not become hot.	1) Heating element is damaged 2) Fuse is blown.	Deliver to its service agent.
4	Keep Warm Lamp begin flashing with buzzer sounds arise.	Stainless steel pot is empty.	Refill

## 故障的判断与维修

序号	现象	产生原因	恢复、排除方法
1	按热水开关不出水	加热至沸腾过程中, 热水开关自动锁定	沸腾完毕后, 热水开关自动解锁, 恢复正常出水
		不锈钢内胆无水	加水
	按温水开关不出水	等以上恢复及实施排除方法后还是未能出水	送指定的维修部维修
		加热至沸腾过程中, 温水箱无水, 输水泵暂时被锁定	沸腾完毕发出“哔”一声60秒后, 输水泵自动启动, 将开水输入温水箱, 温水供应恢复正常
	不锈钢内胆及温水箱均无水	加水	
	等以上恢复及实施排除方法后还是未能出水	送指定的维修部维修	

## HOW TO USE

Before using your dispenser for the first time, boil and discard one full pot of water by following the instruction below. You may notice a smell of plastic for the first time, when you see dispenser. This is normal and will fade over time.

### 1 Open the lid and pour water into the pot.

- Press the depression in the **Lid Opening Lever** and lift the lid.

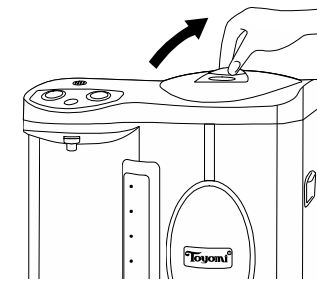

- Fill the container by pouring cold water from another container such as a kettle.

Maximum water supply mark, fill up to here.

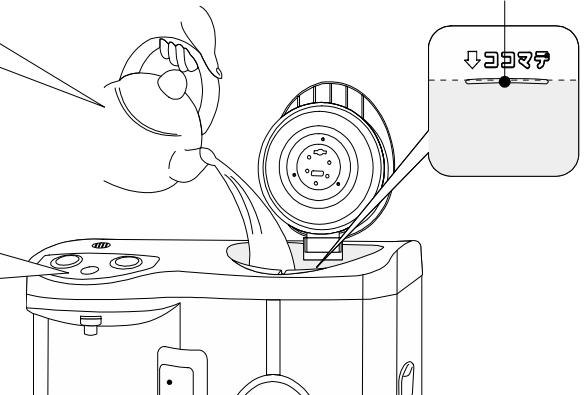

- Be careful not to splash water on the operation panel or on the outside of the dispenser. ( Splashing water can damage the dispenser and cause an electric shock or malfunction. )

- Do not fill the container directly from the tap, as over-flowing water could cause a short circuit or electric shock.
- Do not add water above maximum water supply mark on the inside of the container. Hot water may overflow, causing scalds.

## 2 Close the lid

- Close the lid until a snap sound is heard
- If the lid is not close completely, boiling may not stop or much hot water may flows out when the dispenser fall down, resulting in burns.

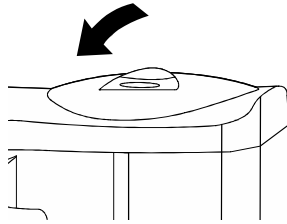

## 3 Connect the plugs

- Attach the power cord to the dispenser. Plug the other end of the power cord into a wall outlet.

- Be sure no water, foreign matter, or metal object is in contact with the electrical plug.

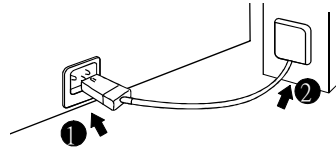

- When you plug in the power cord, the Boil/Reboil Lamp will light, then the water will automatically begin to boil and dechlorinate.
- To ensure serving 100°C hot water, Hot Water Dispense Key is locked during boiling / reboiling.

While the water is boiling, avoid burns as follows:

- Do not open the upper lid.
- Do not touch the steam coming out of the steam vent.
- Do not place a cloth or any other items over the steam vent.
- Do not dispense hot water while the water is boiling.

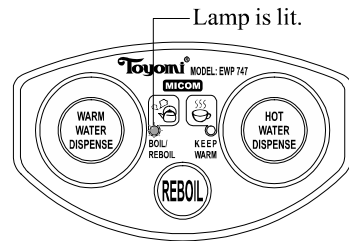

## 4 Clean container for the first time

- Pour out all remaining water by pressing Hot Water Dispense Key and Warm Water Dispense Key.
- Disconnect plug from electrical outlet, and allow the body to cool.
- Wash the Stainless Steel Pot with a soft sponge, pour out all the water in pot.
- Discharge remaining warm water in Warm Water Container by taking out Rubber Stopper on Warm Water Drainage Hole under Warm Water Container, Fix the Rubber Stopper well before using.

**When carrying the main unit, do not touch the Lid opening lever.**  
If you do, the lid may open, and you may be seriously burned.

**Add water into the inner pot when the water level is at or below the REFILL Mark.**  
The inner pot may become empty and this may result in empty heating (an empty inner pot being heated). The color of the inner pot may become yellow. The main unit may be damaged by the long time empty heating which may cause a fire.

**Do not rotate the main unit while dispensing hot water.**  
You may be burned by splashing hot water.

**Do not use the unit near a wall or close to furniture and other electric appliances.**  
The wall, the furniture or the electric appliances may be damaged due to steam or heat. They may become discolored or deformed.

## ELECTRIC PUMP AIRPOT USAGE TIPS

1. When unpacking, there maybe have some peculiar smell in inner pot due to the close packing. Please fill water to “**보충수준**” mark & put two slices of lemon into it, boil twice or three times to lighten the smell.
2. When unpacking, there maybe have some water in inner pot and/or in water level gauge, it is frost of steam, is normal.
3. If being used for a long time, the inner pot may be scaled, or the deposited impurity of water may cause some yellow spots on the bottom. You could also use the above-mentioned method. Even if worse off, you could choose citric acid or special scale - cleanser for the electric pump air pot instead of lemon.
4. Please keep filling water in time to avoid empty - boiling, or the inner pot will become yellow and nondurable.

## 电热水瓶使用小贴使

- 1、产品的封闭包装会令开箱时内胆有少许异味, 将内胆满水加入两片柠檬煮沸二至三次, 即可减退异味。
- 2、开箱时, 内胆和/或水尺里可能会有蒸气凝结成的水珠, 这是出厂包装前清洗电热水瓶余留的蒸气, 请放心使用。
- 3、长时间使用后内胆可能会出现的水垢, 或由于水含杂质沉淀于内胆底部出现黄斑, 也可用上述方法处理, 而严重的可用柠檬酸或电热水瓶专用除垢剂煮水除去。
- 4、请注意及时加水避免干烧, 经常干烧会令内胆变黄及影响产品耐用性。



**Do not lift, tilt or shake the unit. Do not move the unit by the lid.**

If the main unit is tilted, hot water may flow out from the dispensing spout or from the steam vent. You may get burned.



**Do not force the lid to close.**

Hot water can spill causing burns.

**Close the lid securely.**

If the unit tips over with the lid unsecured, hot water will gush out and you may be seriously burned.



**Do not allow the children to use the unit and do not leave the unit within the reach of infants.**

They may get burned, an electric shock or get injured.



**Do not boil anything other than water. Do not put ice into the inner pot and try to keep the water cool.**

If tea bags, tea leaves, milk or alcohol are put into the inner pot, they may cause it to spout hot liquid or steam and you may be seriously burned. Those items may also cause the water tube to become clogged. The inner pot may burn or corrode.



**Do not allow infants access to the unit plug.**

You must pay special attention to preventing infants from putting the unit plug into their mouths. This may result in electric shock or injury.



**Do not connect or disconnect the power plug or the unit plug with wet hands.**

You may receive an electric shock.



## CAUTION



**Do not press the Hot Water Dispense Key within 5 minutes after water is boiling.**

Hot water may splash on you and you may be seriously burned. The unit may not dispense due to the racing electric pump caused by boiling bubbles.



**Do not open the lid or dispense hot water while it is boiling.**

You may be burned by the splashing hot water or steam.



**Do not use the unit on an unstable surface or on a plush carpet.**

The unit may tip over and you may be seriously burned.



**Wait until the unit gets cool before performing any maintenance.**

When discarding hot water, be careful not to get burned.

## 5

### Pour hot water

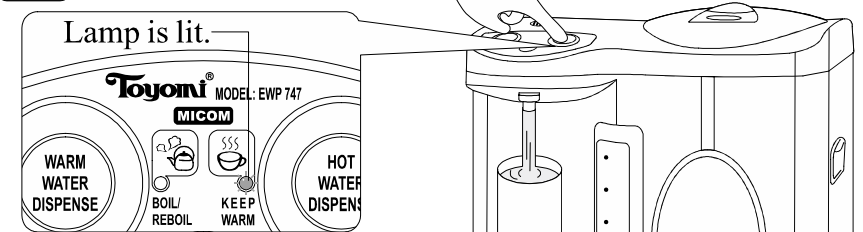

- After Keep Warm Lamp is lit, Push Hot Water Dispense Key to dispense hot water.
- The hot water might not dispense smoothly right after boiling.

- Avoid being scalded by steam when opening the upper lid.
- Do not press the Hot Water Dispensing Key, when the Stainless Steel Pot is empty. (Doing so can cause damage.) Refill water on time.

## 6

### Pour warm water

- Under keep-warm state, the pump will automatically fill/refill the boiled water into the Warm Water Container until it is full.
- Takes about 3 hours & 40 minutes to cool the boiled water to around 60 degrees (with a full container of hot water in a room temperature of about 20 degrees, Time differs according to regions.).
- Push Warm Water Dispense Key to dispense warm water.

- If Stainless Steel Pot is empty and warm water container is not full, a noise of exhaust pumping will be heard, Do refill water on time, otherwise heating element may be damaged.

## 7

### Refill the water dispenser with water

- When the water gets close to the REFILL mark, open the lid and refill the water dispenser with water. It will begin to boil water automatically.

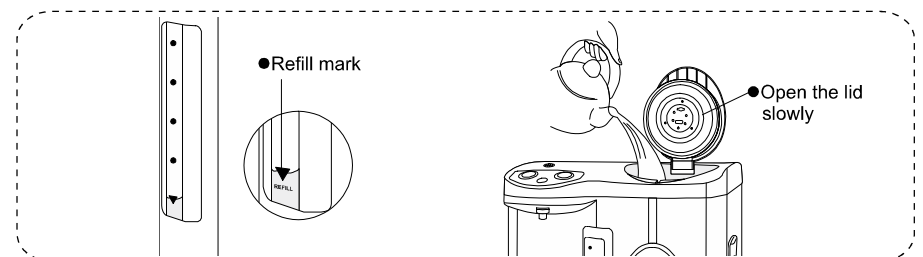

- If the water is lower than "REFILL" mark on scale, DO refill water on time.
- To ensure water was boiled before serving, Micom Anti-Unboiled-Water system will activate "REBOIL" switch, if lid is opened and closed during Keep-Warm.

## CLEANING AND MAINTENANCE

- Before cleaning the dispenser, always disconnect the plug from the electrical outlet, pour out all remaining hot water, and allow the body to cool.
- The condition of the container depends on local water quality and how often you boil water. For best results, clean the container regularly.
- Wash the container with a soft sponge.
- **Inner lid**  
Wash with a soft sponge and rinse with water.
- **Upper lid and body**  
Wipe the lid outside of dispenser with a slightly dampened cloth.
- **If the warm water is not use for long period**
- Discharge all remaining warm water by taking out rubber stopper under the warm water container after boiling water for the first time. Take out the stopper only after unplugging & warm water is cool.
- To keeping healthy, please discharge discarded water by the same way, if the warm water is not used for long period.
- Fix the stopper well before using.
- **If you do not use dispenser for long period**  
Clean the lid, dispenser body, inner vessel, etc., wipe them with a dry cloth, and allow to air dry. (Dry the inner vessel completely.) Put the components in a polyethylene bag, etc. and seal the bag to keep out insects etc.

- Never immerse it in water.
- Never splash water on the operation panel.

## SAFETY INSTRUCTION

- Read through the instructions shown below before using the product. Be sure to observe them.
- Be sure to observe the safety instructions shown below in order to prevent you and other people from being injured.
- Do not peel off the caution label from the product.
- Keep this manual for your further reference.

## SYMBOL MARKS



General prohibition



Dismantling decomposing prohibition



Drench prohibition



Touch prohibition



Wet hand prohibition



Forced prohibition



## WARNING



**Use a single outlet that matches the rated power. Unplug the power cord from the outlet when the unit is not being used.**

The outlet may get hot and it can cause a fire if this unit and another appliance are plugged into an outlet at the same time.



**Be sure that the unit plug is properly inserted into the outlet.**

**Be very careful not to damage the power cord and plug.**

If the plug is inserted improperly, and a damaged cord or damaged plugs are used you may receive an electric shock or they may cause hot, a short circuit or a fire.



**Never disassemble, repair or modify the unit by yourself.**

It may cause a fire. The unit may operate abnormally and you may get injured. For repairs (other than replacing consumable parts), please contact our Service Center.



**When pour water into the unit, water level should not be over the Maximum water supply mark.**

The hot water may splash out and you may get burned.



**Do not immerse the water dispenser in water or splash it with water.**

Immersing or splashing may result in short-circuiting or electric shock.



**Do not cover the steam vent with cloth etc.**

The hot water may splash out and you may get burned.



**Do not touch the steam vent with your hands.**

You may be burned. Pay special attention so that infants can not reach the steam vent.