

COOKING BLENDER

MODEL: BLC 9811

220-240V~50/60Hz

Power: 1200W

INSTRUCTION MANUAL

Please read carefully and keep the instruction well

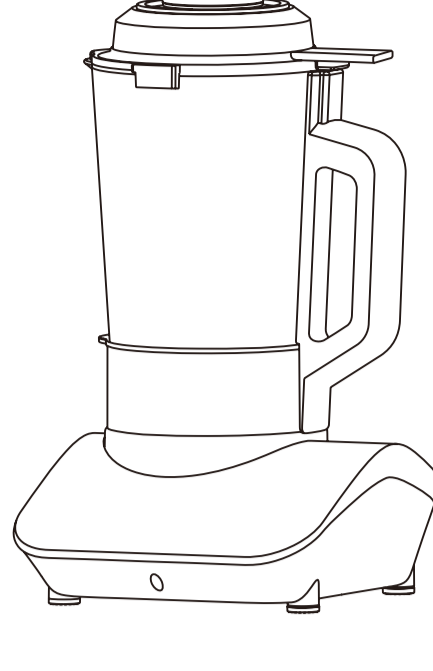

FOR HOUSEHOLD USE ONLY.

SERVICE & IMPORTANT NOTICE

- If the supply cord is damaged, it must be replaced by the manufacturer or its service agent or a similarly qualified person in order to avoid a hazard.
- **WARNING:** This appliance is not intended for use by persons (including children) with reduced physical, sensory or mental capabilities, or lack of experience and knowledge, unless they have been given supervision or instruction concerning use of the appliance by a person responsible for their safety.

Name of Part

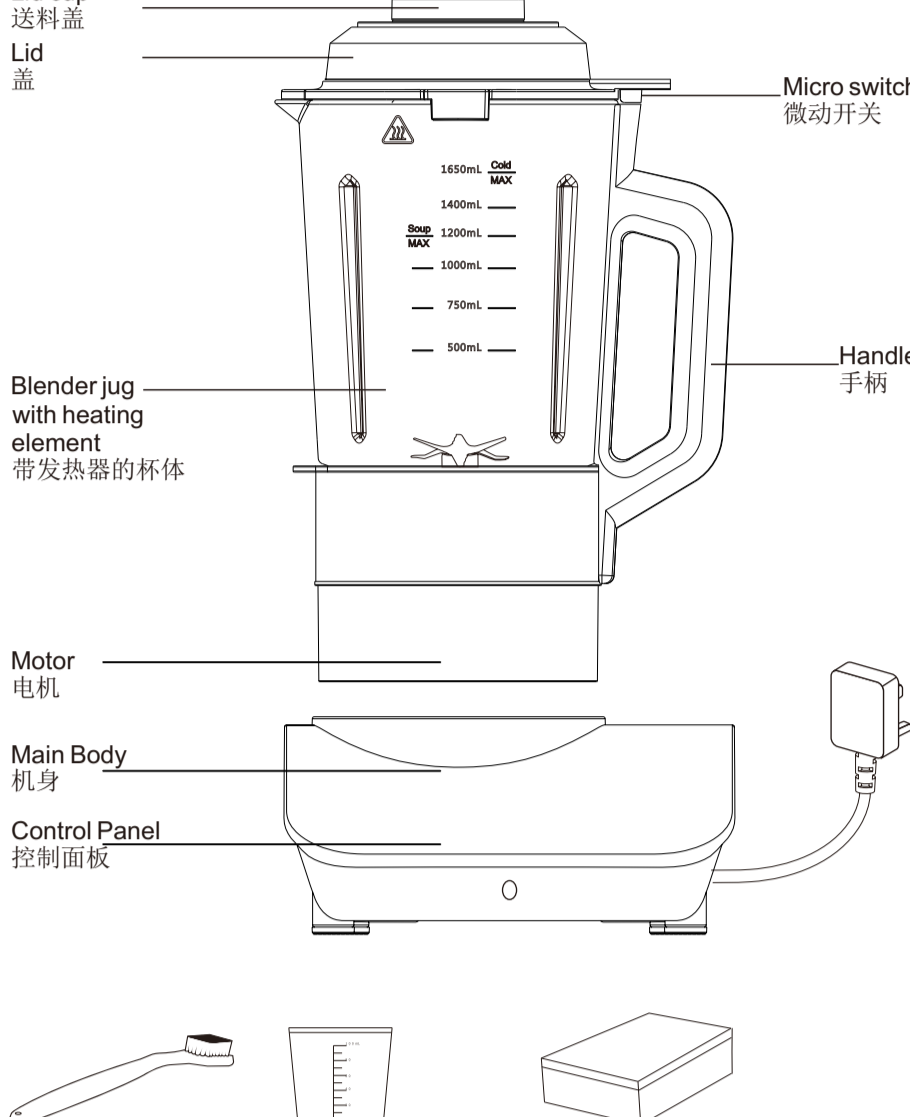

- cup is inserted properly in the lid before you switch on the appliance.
- Ensures that you can only switch on the appliance if the blender jar is assembled on the motor unit properly. If the blender jar is not placed properly, the machine will not start to blend.
- Do not add ingredients while blending hot preparations as this may cause risk of splashing.
- Do not remove the lid cap from the lid during hot preparations, or it can reach high temperature and cause burns.
- During the process of heating porridge or soybean milk, if you stop or if there is a power failure, do not continue heating with the remaining food. It may burn the food at the bottom of the heating plate and cause damage to the appliance. Remove the food and replace with new ingredients.
- When blending is complete, make sure the cutter/blades stop before lifting up the glass jug.
- Operating timing: Ensure to follow the operating time as each function has a default timing.
- Boil-dry protection: This appliance is equipped with a boil-dry protection. It switches off automatically if the appliance is too hot from long usage or if there is not enough liquid. Unplug the appliance and let it cool down for 30 mins. Reconnect the appliance to the power supply and resume blending.
- Do not exceed the maximum indication on the blender jar.

Control Panel

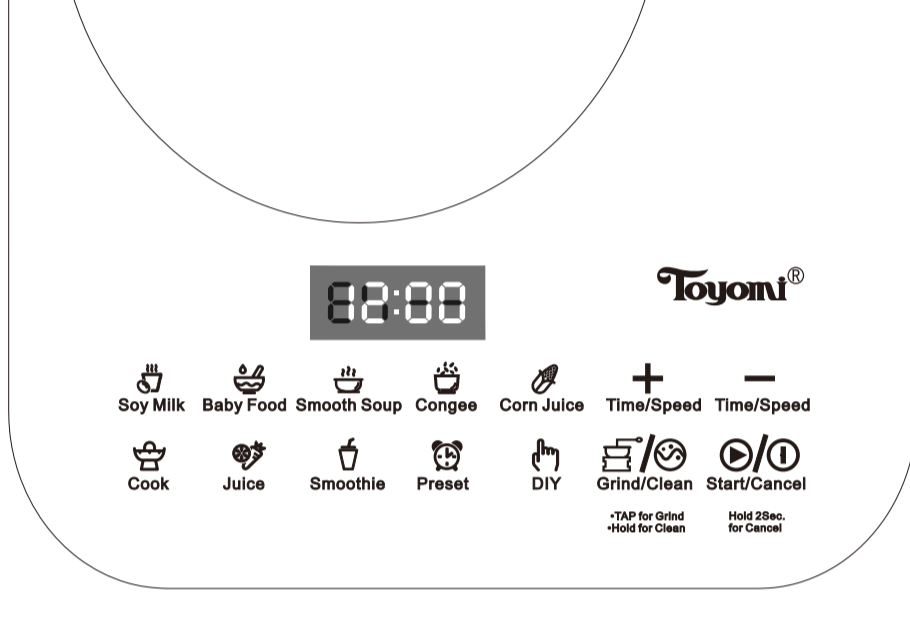

- Amount of food or water may follow according to our recipes. For function with heating (hot food), do not exceed 1200ml. For function of DIY, Juice or Smoothie must not exceed 1650ml. For Grind, do not exceed 4 cups.
- For blending vegetables or Fruit Juice, make sure to remove the seeds before placing into the jug.
- Do not use this blender to reheat cooked soya bean, Milk, porridge or sticky food as it may get burnt and damage the heating element.
- Do not let the appliance run continuously. Let the appliance cool down to room temperature before you continue next processing.
- If food is burnt and stuck on the heating element, do not use any metallic or sharp-edged utensils on the unit to avoid scratching on the surface. The best way is to soak it with some hot water for 2 hours and clean it with the cleaning brush.

Cleaning & Maintenance

1. Please turn off and unplug the power before cleaning.
2. Do not touch the heating element, motor coupling and blade unit after use. Let it cool down before cleaning.
3. Careful of the sharp blade while washing.
4. Do not use abrasive chemical or alcohol to clean the appliance.
5. Do not use any metallic or sharp-edged utensils to avoid scratching on the surface.
6. Do not immerse the glass jug, motor body or power cord in water.
7. Do not rinse the whole glass jug, motor body under running water. Only fill and rinse the inner glass jug under running water and avoid other parts.
8. After cleaning, wipe with a dry cloth and air dry it.
9. Do not place the appliance under the sun to dry.
10. If there are still some stains, fill in some water into the jug and soak for 1-2 hours, after that slightly scrub away with the brush.
11. For stubborn stains like limescale or brown patches, you may add some lemon or vinegar and soak for a while and clean it off with a sponge or brush.

Thank you for purchasing our products.

Please read the instructions carefully before use and keep for future reference.

Important

- This appliance is intended for household use only.
- Do not immerse the appliance in water or any other liquid.
- Place the appliance on a flat, stable, heat-resistant surface away from sources of heat or water splashes.

Warning

- This appliance is not intended for use by persons (including children) with reduced physical, sensory or mental capabilities, or lack of experience and knowledge, unless they have been given supervision or instruction concerning use of the appliance by a person responsible for their safety.
- Do not touch the sharp blades when the appliance is plugged in. If the blades get stuck, unplug the appliance before you remove the ingredients. Be careful when handling the sharp cutting blades, emptying the bowl and during cleaning.
- Do not touch socket or plug with wet hands to prevent electric shock.
- While blending hot liquid, please make sure the cover lid is close tightly, do not touch the glass jug while it is hot to prevent scalding.
- Operate the blender on a flat, stable, heat resistance surface. Do not place any towel, plastic cover under the blender.
- Never use any accessories or parts from other manufacturers which may be hazardous.
- Beware, the appliance releases steam which can cause burns. Handle the lid and cup carefully.
- Do not place glass jug into disinfection appliances or dish-washer machine to prevent damage to the parts.

Caution

- Check that the power supply voltage corresponds to that shown on the appliance.
- If using the appliances other than in Singapore, make sure the voltage is the same as stated.
- Switch off and unplug the appliance from the power supply before removing it from the stand, changing accessories or parts that move in use, during assembling, disassembling or cleaning it.
- If the supply cord is damaged, it must be replaced by a special cord or assembly available from the manufacturer or its service agent. If the blades get stuck, unplug the appliance before you remove the ingredients.
- Be careful when handling the sharp cutting blades, emptying the bowl and during cleaning.
- Always make sure the lid is properly closed/assembled on the jar and the lid

Operation

- Cut ingredients into 2cm small cubes. (Fig 1)
- Using the measuring cup for ingredients depending on your recipes. (Fig 2)
- Pour all ingredients into the Glass Jug. Make sure there is no other residue in the jug. (Fig 3)
- Add water or other liquid only up to the maximum level or amount depends on the recipes.
- Place the lid and lock securely. (It will not work if the cover is not securely lock, an error code E01 will show). See (figure 4) the way to lock the cover.
- Place the jug onto the main body at the right position. (fig 5 & 6)
- After the power, the buzzer sounded with all indicators will light up for 1 second. By default, the digital screen displays "----" and Start/Cancel light begin flashing, enters **SLEEPING** mode. All other LED lights are off.
- Tap Start/Cancel button, all the light except "-" & "+" will be on, screen displays "----", enter into **STANDBY** mode.
- Within 15 seconds, select Function, Pulse/Clean or Preset button, and the corresponding indicator light flashes. Tap the "Start/Cancel" button to enter the **WORKING** state of the function within 15S, and the corresponding indicator light will be on, the digital screen will display as **FUNCTION & TIME TABLE**
- After the working state, the digital screen will show "END" and enter **SLEEPING** mode, the digital screen displays "----" and Start/Cancel light begin flashing.
- In any working state, tap the "Start/Cancel" button and the buzzer will ring once, and return to the **SLEEPING** mode.
- After food is ready, turn off the power and unplug the power point, turn the lid anti-clockwise by the side lever and push up the lid slowly. (If using heating function, please be aware that the lid and the blender jar will be hot after cooking. Be aware of the steam release when you lift the lid and measuring cup. (Fig 7)
- Pour out the food slowly, add any flavouring and ready to be serve. (Fig 8)
- Wash the blender after it has cooled down, do not leave the food inside the jug too long as you may have difficulties in cleaning. After cleaning, wipe with a dry cloth. (Fig 9)

Note:

- For cooking under procedure of function with heating, make sure to choose the right function or it may cause bad taste, uncooked or burnt to the food. Do not add sugar before or during the cooking process as it may cause lots of foaming and cause spillage.
- During the operating process, if there is any current interruption within 30 secs, you may continue with the process. After more than 30 secs, the blender will go back to **SLEEPING** mode and we suggest to change the ingredients and restart again.
- Press the "Start/Cancel" button, if the wrong function is selected, or if the food/ liquid inside is not hot, you may reselect the right function and press Start/Cancel button again. If the food/liquid has been hot around 70-80°C, let it cool down, then restart again.

FUNCTION & TIME TABLE

Function	Timing	Display	Adjustable
Juice	25Minutes (default)		Not
Smoothies	2.5Minutes (default)	Time left	Not
DIY	Speed +2mins(default) (adjustable)	Before confirm: 2:00-1:59-1:58-...-0:00 After confirm: Bottom to top cycling	MAX.SPEED 9P MAX.TIME:200Min
	Baby food	After boiling: Time left Bottom to top cycling	Not
Cook	30Minutes after boiling	Before boiling: Bottom to top cycling After boiling: Time left	Not
	Soy milk	24Minutes after boiling	Before boiling: Bottom to top cycling After boiling: Time left
Congee	17Minutes after boiling	Before boiling: Bottom to top cycling After boiling: Time left	Not
	Smooth Soup	17Minutes after boiling	Before boiling: Bottom to top cycling After boiling: Time left
Corn Juice	24Minutes after boiling	Before boiling: Bottom to top cycling After boiling: Time left	Not
	Preset	12:00Hours(default) from 5min. to 24hr. adjustable Presetting: Cooking As Function with heating	Yeah
Grind/Clean	Tap Grind/Clean	60Seconds	Operating time Not
	Hold Grind/Clean	As long as you press (suggest not longer than 30Sec. each press)	Reducing time Not

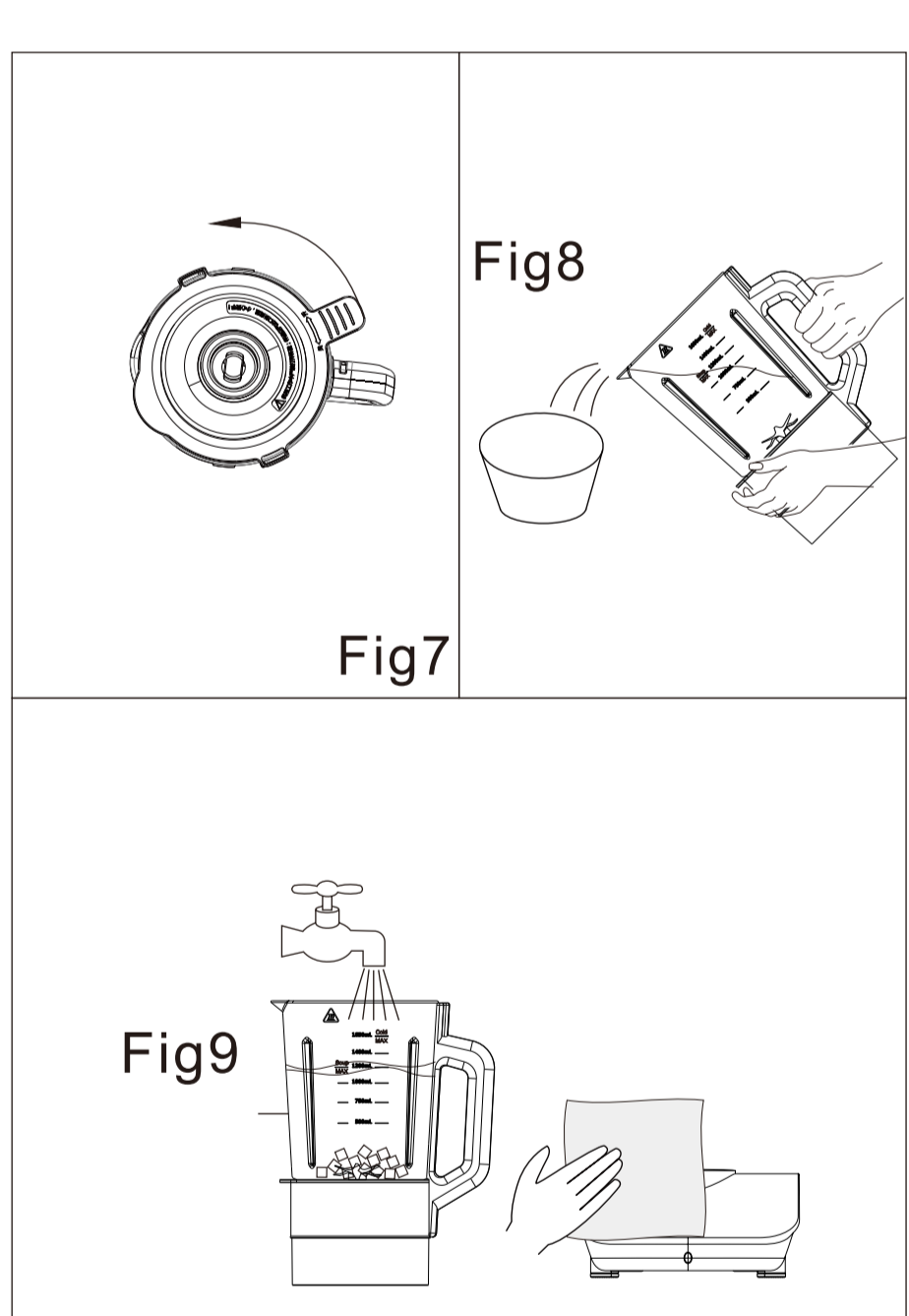
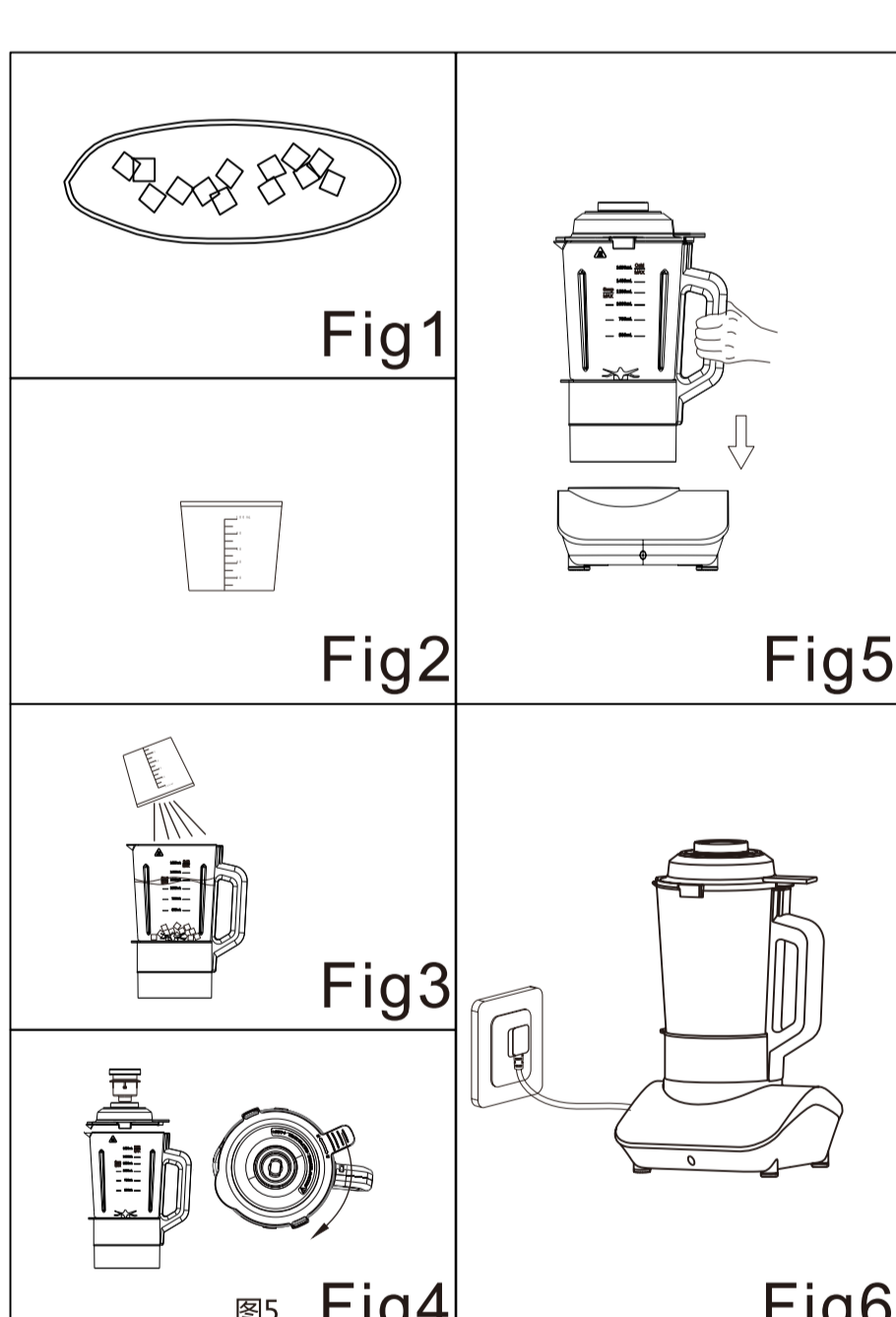

Demo of cleaning

<p>Do not directly wash or soak the body with water.</p> <p>请勿直接用水冲洗或者浸泡机体。</p>	<p>Do not use near fire source or high temperature (over 40°C).</p> <p>请勿在火源附近或高温(40°C以上)场所中使用。</p>
<p>Keep the blender in a flat, firm place and away from walls or other valuables.</p> <p>请将机器放置于平坦、坚固的地方,并远离墙壁或其他贵重物品保持距离。</p>	<p>To remove or place the cup on main body, please "cancel" the current function or cut off the power.</p> <p>杯体拿出或放入主体前,请先取消当前功能或切断电源。</p>
<p>When the blender is working, do not touch the enclosure of the cup to prevent accidental scalding.</p> <p>机器工作时,请勿触摸杯体,防止意外烫伤。</p>	<p>When filling water, close attention should be paid to the scale on the cup body.</p> <p>加水时,请注意杯体内刻度。</p>
<p>When finished, please cut off the power before taking out the cup.</p> <p>制作完成后,请先切断电源,再取出杯体。</p>	<p>When cleaning, please be careful of the sharp blade in the cup from scratching your fingers.</p> <p>清洗时,请小心杯体内锋利刀片,以防划伤手指等。</p>
<p>Do not put the cup in the freezer for sudden cooling. Before storage, should be cleaned, rubbed, dried naturally.</p> <p>请勿将杯体置于冷藏柜中骤然冷却。存放前,应清洗干净,擦干,存放前请清洗或自然晾干。</p>	

故障分析及排除

指示灯不亮	● 电源线未插好 ● 杯体与主机没有装配好 ● 杯盖没有扣好	● 检查电源线并确保插好 ● 杯体盖到主机上确认听到开关合上“嗒”的一声 ● 检查杯盖扣位是否与杯手柄相对好位置
指示灯亮,产品不工作	● 杯体加水多 ● 工作过程中出现鸣叫报警 ● 未按“开始/取消”键	● 请正确加水到相应功能的水位线之间 ● 拔掉电源后,再通电,按正常工作步骤操作 ● 选好相应功能后,按“开始/取消”键
数码管显示E01	● 温度传感器断路	● 装好杯盖旋转到正确位置 ● 联系客服
数码管显示E02	● 温度传感器短路	● 联系客服
数码管显示E03	● 温度过高或干烧	● 断电15分钟后再通电使用 ● 正常现象
数码管显示E04	● 电压低于160V	● 使用220-240V~50/60Hz电源
数码管显示E05	● 电压高于270V	● 使用220-240V~50/60Hz电源
加热不停止	● 产品本身故障	● 联系客服
按键无反应	● 断电间隔短,系统未复位 ● 产品已在执行程序	● 断电3分钟后再通电使用 ● 正常现象
食物打不碎	● 加水过多或过少 ● 食材太多或太少 ● 食材太多或太大块 ● 产品本身故障	● 请加水至正确的水位线 ● 可用家用稳压压器 ● 请按食谱或说明书配方操作 ● 联系客服
食物煮不熟	● 加水过多或过少	● 请加水至正确的水位线 按标准加食材
糊底	● 杯内未清洗干净 ● 食材加水多	● 请将杯内清洗干净 ● 请按食谱或说明书配方操作 ● 选择正确的功能键
启动时刀片不旋转	● 加入食材太多或太大块 ● 档位设置错误 ● 产品本身故障	● 取出小块再加入 ● 调高转速档位 ● 联系客服
工作中有异常噪音	● 未正确安装搅拌杯、杯垫 ● 材料粘在搅拌杯上 ● 产品本身故障	● 安装机器、取下搅拌杯检查杯垫上是否有异物,重新正确放置搅拌杯 ● 清理搅拌杯 ● 联系客服

注: 发生粘糊可自行清理,不影响正常使用。如产品问题用以上办法还不能解决,联系客服。以上内容如型号或零件的变更与实物不符,请以实物为准,恕不另行通知,敬请见谅。

Trouble Shoot:

Problems	Causes	Solutions
Indicator does not light up	<ul style="list-style-type: none"> • The plug is not connected • The glass jug is not position properly to the motor unit • The lid is not securely locked 	<ul style="list-style-type: none"> • Check the plug, make sure it is plugged properly • Please make sure glass jug is on position properly to the motor unit • Make sure the lid is lock at the right position
Indicator lights up, appliance is not working	<ul style="list-style-type: none"> • Glass Jug has no water • Appliance has alarm beeping • Did not press the ON/OFF button 	<ul style="list-style-type: none"> • Add water to the glass jug • Unplug the appliance, wait for 1 minute and plug in again • Send to service centre
LED indicators E01	• Temperature sensor not detected	<ul style="list-style-type: none"> • The glass jug is not positioned properly • Send to service centre
LED indicators E02	<ul style="list-style-type: none"> • Over-heat • Temperature sensor is faulty 	<ul style="list-style-type: none"> • Unplug & wait for a min., plug in & try it again • It is normal
LED indicators E03	• Appliances is overloaded or overheating	• Off the power and let it cool down for 15-20 mins
LED indicators E04	• Current voltage is lower than 160V~	• Check local current should be 220-240V~
LED indicators E05	• Current voltage is higher than 270V~	• Check local current should be 220-240V~
Heating did not cut off	• Appliances is malfunction	• Send to service centre
No response when pressing function or any button	<ul style="list-style-type: none"> • Safeguard function may be activated • Selected function is activated 	<ul style="list-style-type: none"> • Off the power and wait for 15-20 mins • It is normal
Food does not blend well	<ul style="list-style-type: none"> • Water is too much or less • Current power is lower • Places of food is too large, hard or too much • Appliances is malfunction 	<ul style="list-style-type: none"> • Please add appropriate water amount • Use the right current for this appliance. • Please follow instruction manual for the recipes or reduce the size and quantity of ingredients processed. • Send to service centre
Food not heating up or not cooked	• Water is too much or less	• Please add appropriate water amount according to recipes
Food burnt	<ul style="list-style-type: none"> • The heating element is not clean with balance residue • Ingredients is too much • Chosen wrong function 	<ul style="list-style-type: none"> • Please follow instruction manual thoroughly before using • Clean the heating element for the recipes or reduce the size and quantity of ingredients processed • Choose the right function
The blades does not turn	<ul style="list-style-type: none"> • Places of food is too large, hard or too much • Selected wrong speed to blend • Appliances is malfunction 	<ul style="list-style-type: none"> • Reduce the size and quantity of ingredients processed. • Adjust to the higher speed • Send to service centre
Abnormal Sound when operating	<ul style="list-style-type: none"> • The glass jug is not on position properly to the motor unit • Some food sticks on the blade or the Jug • Appliance is malfunctioned 	<ul style="list-style-type: none"> • Off the power, check whether any residue is stuck between the jug and the base motor. • Clear the excess food • Send to service centre

Note: For burnt food or residue stuck on the element, cleaning will not affect the appliance's operation. If problem still persists, please kindly send to our service center.