



CIRO DRIVER FOOTREST ADAPTERS

2018 AND NEWER SOFTAIL

PARTS INCLUDED

2	Adapters
2	5/16-18 SHCS
2	5/16 narrow washers

INSTALLATION INSTRUCTIONS:

1. Park on a level surface and shut off the motorcycle. Ensure that the engine has time to cool before installation.
2. Remove the retaining clip (3) and pin (4) then set aside for installation. Remove torsion spring (2) and set aside for installation.
3. Insert the short leg of the torsion spring into the hole (a) in the Ciró footrest adapter.
4. Align the long leg of the torsion spring into the footrest mount and insert it.
5. Install the pin through the Ciró footrest adapter and spring. Install the retaining clip.
6. Place the footrest (5) onto the adapter and adjust the angle. Insert the 5/16 washer and screw (6,7)
ATTENTION: Torque the 5/16 SHCS to 15 lb.ft.

7. Repeat on the other side.

NOTE: Check all fasteners for tightness.

* Items 2, 3, 4, are not included.
They are factory H-D components.

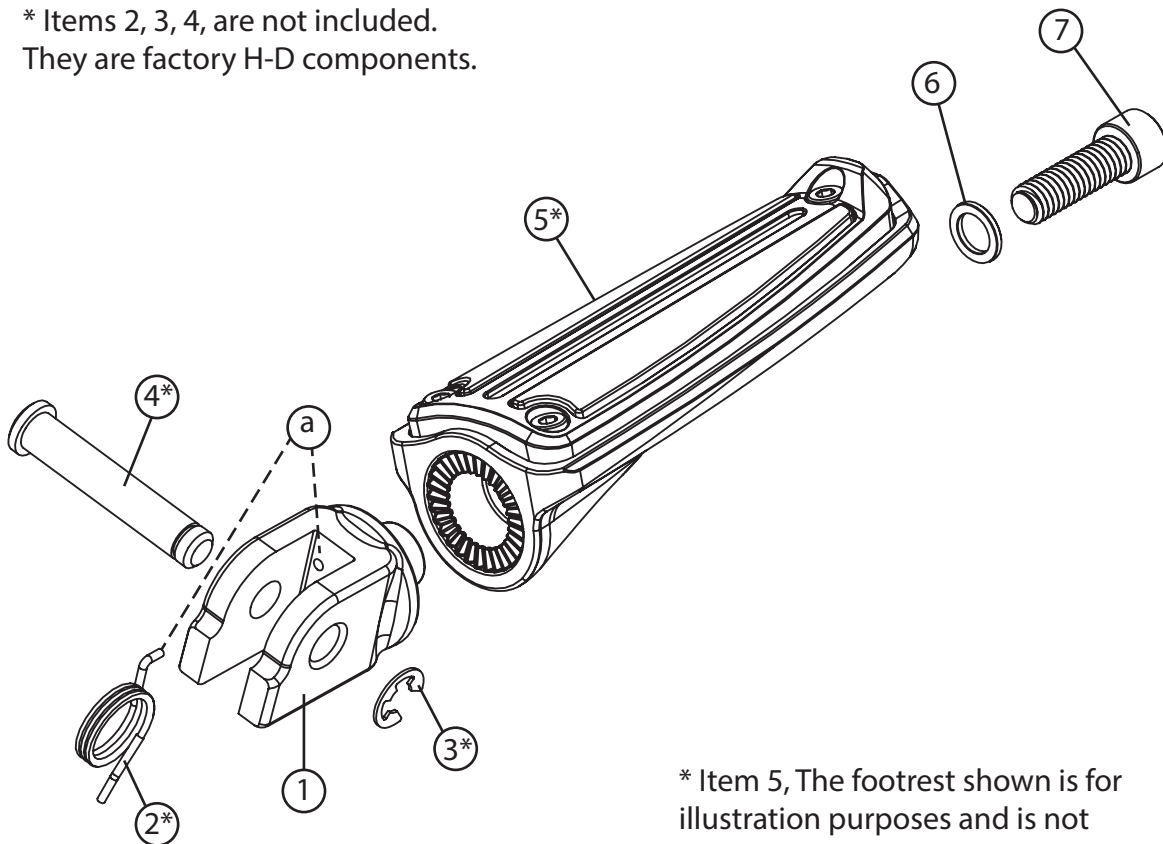

* Item 5, The footrest shown is for illustration purposes and is not included. Your footrest may look different. Follow the installation procedures for the footrest you have.

WARNING:

This indication alerts you to the fact that ignoring the contents described herein can result in potential serious injury or death if not followed.

CAUTION:

This indication alerts you to the fact that ignoring the contents described herein can or will result in material damage and/or personal injury.

ATTENTION:

This indication alerts you to the fact if you ignore this detail you will affect the performance or functionality of the product.

All Ciró products are designed for "easy assembly" and/or "plug and play". We recommend a competent mechanic install our products, using standard mechanical procedures to assure a safe and successful installation.

NOTE:

Ciró® warrants that products sold hereunder to the original purchaser, if maintained and operated under normal conditions, shall be free from any defects in materials and workmanship for a period of (3) years from date of purchase, and a lifetime warranty against LED failure.

Ciró will have no obligation if the customer cannot show proof of purchase.

Warranty will not be granted unless the part is properly installed and maintained.

Ciró will not be liable for any consequential and incidental damages, including labor, or non-Ciró products.

Please visit our website Ciro3d.com for our complete warranty policy.