



TWIN RAIL FOOTRESTS WITH ADAPTERS

Parts Included:

- 2 Twin Rail Footrests
- 2 Footrest Adapters
- 2 Narrow Flat Washers
- 2 5/16-18 x 1.0 SHCS

Installation Instructions:

1. Remove the stock footpegs and save all OEM hardware. (Fig. 1)
2. Install the Ciro footrest adapters using the OEM hardware. (Fig. 2)

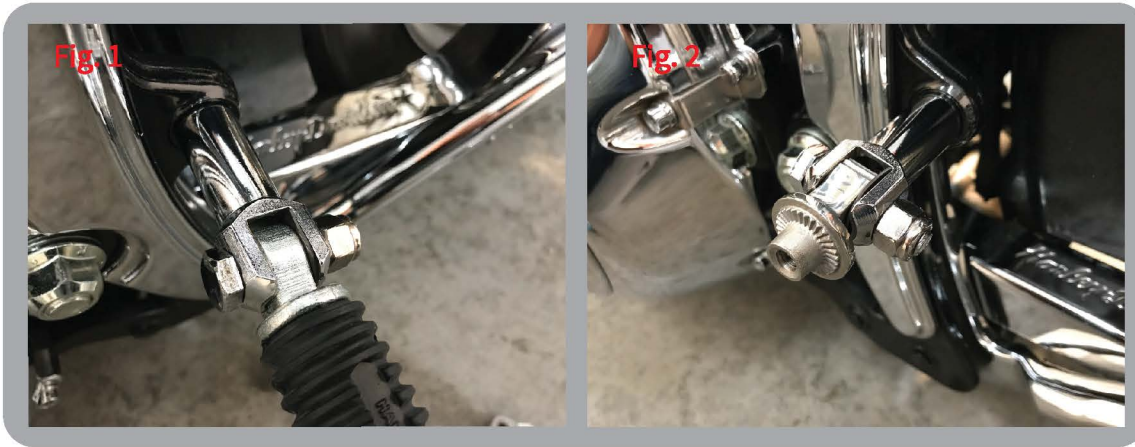

3. Insert the 5/16 screw and washer into the footrest. (Fig. 3)

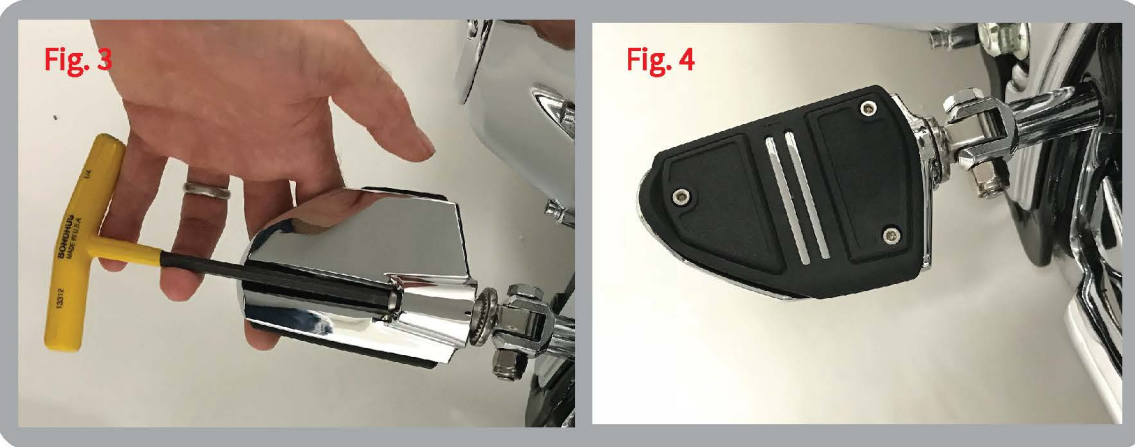

4. Using a 1/4 Hex wrench to hold the screw in place, align the screw threads with the female threads in the adapter, then tighten. (Fig. 3 & Fig. 4)
5. Set the preferred angle then torque to 25 ft. lbs.

WARNING:

This indication alerts you to the fact that ignoring the contents described herein can result in potential serious injury or death if not followed.

CAUTION:

This indication alerts you to the fact that ignoring the contents described herein can or will result in material damage and/or personal injury.

ATTENTION:

This indication alerts you to the fact if you ignore this detail you will affect the performance or functionality of the product.

All Ciro products are designed for "easy assembly" and/or "plug and play". We recommend a competent mechanic install our products, using standard mechanical procedures to assure a safe and successful installation.

NOTE:

Ciro products are designed and manufactured under very strict quality control. Ciro warrants that products sold to the original purchaser shall be free from any defects in materials and workmanship for a period of 3 (three) years from the date of purchase, and a lifetime warranty against LED failure. Ciro will have no obligation if the customer cannot show proof of purchase. Warranty will not be granted unless the part is properly installed and maintained. Ciro will not be liable for any consequential and incidental damages, including labor, or non-Ciro products. Please visit our website Ciro3d.com for our complete warranty policy.