



CLAMP CLEVIS PEG MOUNT BLACK OR CHROME

Parts Included:

- 1 Clamp Clevis Mount Right Assembly**
- 1 Clamp Clevis Mount Left Assembly**

Installation Instructions:

- 1. Park on a level surface and shut off the motorcycle. Ensure that the engine has had time to cool before installation.**
- 2. Prepare clamp and engine guard surfaces by using an ammonia based glass cleaner to remove any wax or dirt.**
- 3. Remove 1/2" hex bolt from clamp assembly. Separate clamp halves and place around engine guard. Serrated face of clamp should be facing outward and away from motorcycle.**
- 4. In your approximate final location, reinstall hex bolt and thread into clevis until finger tight. Adjust to desired position. Repeat process on opposite side of motorcycle.**

3/8" SHCS



1/2" Hex Bolt

- 5. Install footpeg by tightening 5/16" socket head cap screw into the peg mount. Adjust footpeg location to your liking. Tighten to 15 ft.-lb torque.**

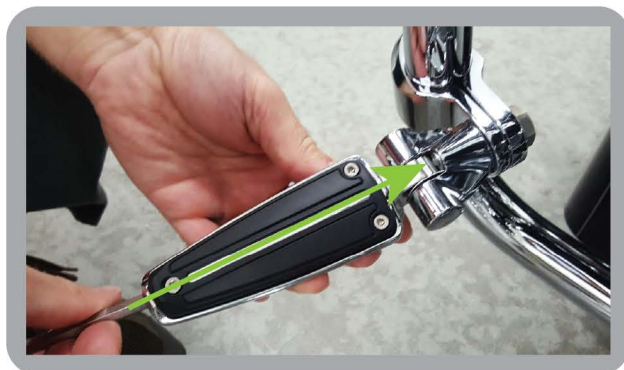

- 6. Check and securely tighten all fasteners. 1/2" hex bolt should be tightened to 65-75 ft.-lb torque.**

WARNING:

This indication alerts you to the fact that ignoring the contents described herein can result in potential serious injury or death if not followed.

CAUTION:

This indication alerts you to the fact that ignoring the contents described herein can or will result in material damage and/or personal injury.

ATTENTION:

This indication alerts you to the fact if you ignore this detail you will affect the performance or functionality of the product.

All Giro products are designed for "easy assembly" and/or "plug and play". We recommend a competent mechanic install our products, using standard mechanical procedures to assure a safe and successful installation.

NOTE:

Giro products are designed and manufactured under very strict quality control. Giro products are warranted to be free of defects in material and workmanship for 1 (one) year from date of purchase by the consumer.

Giro will have no obligation if the customer cannot show proof of purchase.

Warranty will not be granted unless the part is properly installed and maintained.

Giro will not be liable for any consequential and incidental damages, including labor, or non-Giro products.

Please visit our website Ciro3d.com for our complete warranty policy.

CIRO3D.COM