



PASSENGER BALL MOUNT

Parts Included:

- 1 Passenger Accessory Mount
- 1 Passenger Accessory Arm
- 2 10-32 x 3/8" Screws
- 1 Shrink Tube

Installation Instructions:

1. Park on a level surface and shut off the motorcycle. Ensure that the engine has time to cool before installation.
2. Remove the Tour-Pak liner. **Note:** on '96-'13 models, you will need to remove two bolts at the rear of the Tour-Pak in order to free the liner.
3. Choose which side you would like to install the **Ciro Passenger Ball Mount** on and loosen the three bolts opposite the speaker, enough to slide the fingers of the mount in place.

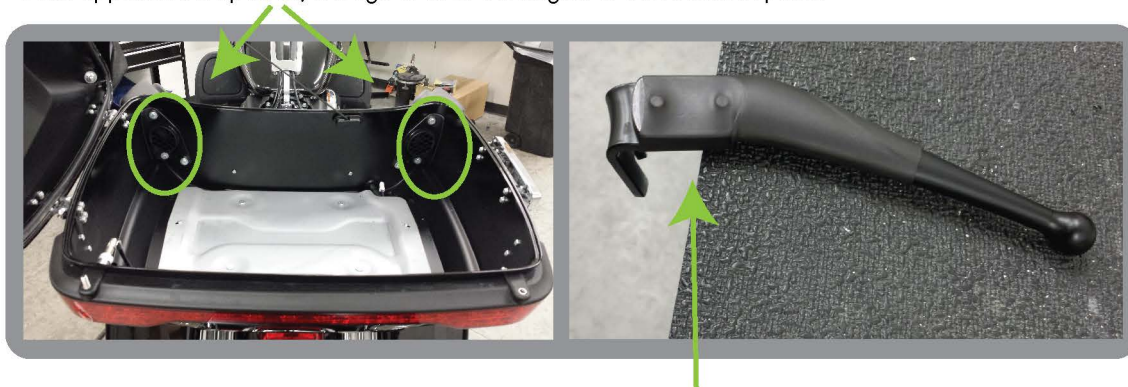

4. Use the two included screws to attach the mount arm to the top of the mount. Next, slide the heat shrink tubing over the joint and apply an appropriate amount of heat. The arm should face away from the motorcycle on the side you have chosen. **Note:** the arm is shorter for '96-'13 models so it is necessary to trim the heat shrink.
5. Slide the mount between the speaker housing and the Tour-Pak. Hold mount down firmly, then tighten the bolts on the back of the speaker. Reinstall the Tour-Pak liner.
6. Install **Ciro** accessory holder on Passenger Ball Mount.

WARNING:

This indication alerts you to the fact that ignoring the contents described herein can result in potential serious injury or death if not followed.

CAUTION:

This indication alerts you to the fact that ignoring the contents described herein can or will result in material damage and/or personal injury.

ATTENTION:

This indication alerts you to the fact if you ignore this detail you will affect the performance or functionality of the product.

All **Ciro** products are designed for "easy assembly" and/or "plug and play". We recommend a competent mechanic install our products, using standard mechanical procedures to assure a safe and successful installation.

NOTE:

Ciro products are designed and manufactured under very strict quality control. **Ciro** warrants that products sold to the original purchaser shall be free from any defects in materials and workmanship for a period of 3 (three) years from the date of purchase, and a lifetime warranty against LED failure.

Ciro will have no obligation if the customer cannot show proof of purchase. Warranty will not be granted unless the part is properly installed and maintained. **Ciro** will not be liable for any consequential and incidental damages, including labor, or non-**Ciro** products. Please visit our website Ciro3d.com for our complete warranty policy.