



CALADE™ TAIL LIGHTS FOR TRI GLIDE

- WARNING** This indication alerts you to the fact that ignoring the contents described herein can result in potential serious injury or death if not followed.
- CAUTION** This indication alerts you to the fact that ignoring the contents described herein can or will result in material damage and/or personal injury.
- ATTENTION** This indication alerts you to the fact if you ignore this detail you will affect the performance or functionality of the product.

All Ciro products are designed for "easy assembly" and/or "plug and play". We recommend a competent mechanic install our products, using standard mechanical procedures to assure a safe and successful installation. Read completely and understand the instructions prior to starting installation.

NOTE: Ciro products are designed and manufactured under very strict quality control. Ciro warrants that products sold to the original purchaser shall be free from any defects in materials and workmanship for a period of 3 (three) years from the date of purchase, and a limited lifetime warranty against LED failure. Ciro will have no obligation if the customer cannot show proof of purchase. Warranty will not be granted unless the part is properly installed, unmodified and maintained. Ciro will not be liable for any consequential and incidental damages, including labor, or non-Ciro products. Please visit Ciro3d.com for our complete warranty policy.

Included Items



Installation Instructions:

1. Park motorcycle on level surface and shut off engine. Ensure motorcycle has time to cool before installation.
2. Remove seat and right side cover.
3. Identify the main lighting connector under the seat and install the provided adapter. Fig. 1
4. Test each of the Calade lights to understand all functions by plugging in temporarily. The reverse light can be tested by applying 12v power to the yellow wire while the lights are plugged in. Unplug lights when done.
5. Apply masking tape in general area to be drilled. Position template on side of motorcycle where light is to be installed with straight side of template to the inside. Tape down and use centerpunch at hole in template to mark location of required drilled holes. Remove template before drilling. Template will be reused on other side by flipping over. Fig. 2
6. Open trunk door and remove contents, including any liners.
7. Drill small pilot hole, verifying clearance for the larger hole needed. Enlarge holes to 5/8" using a step drill bit. Fig. 3
8. Remove masking tape and clean area very well using an ammonia based cleaner to ensure all wax is removed.
9. Feed the wires through the hole and test fit light into place. Mark edges of light with masking tape. Fig. 4
10. Remove tape backer and carefully press light into place along the length. Hold firmly for 60 seconds. Fig. 4
11. Apply masking tape for the two exit holes inside the trunk at the front wall. These will exit to the underseat area of the motorcycle and should be up 12-14" from bottom and approximately 1 1/2" either side of center. Fig. 5



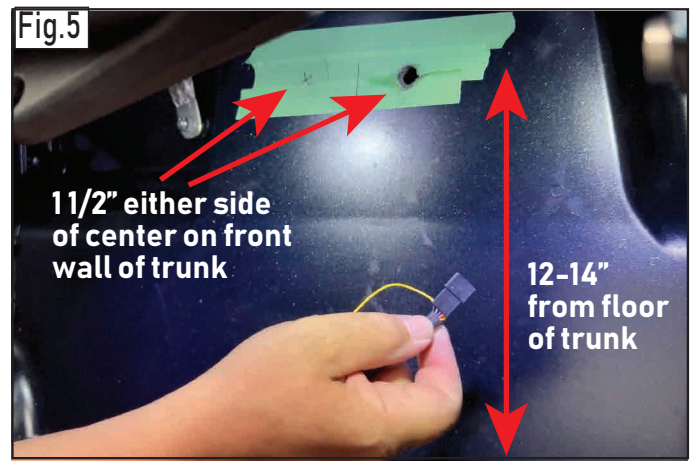

12. Center punch and drill pilot holes. Enlarge the holes to 5/8" using a step bit in drill. Remove tape and clean surfaces.
13. Feed wires out of the trunk and connect to the previously installed underseat adapter using a small amount of dielectric grease on the terminals. Place the provided rubber grommets on the wires at the exit holes on the trunk and push them in place.
14. Run each of the yellow wires down to the reverse relay area of the motorcycle, located under the right side cover.
15. Unplug 2-pin reverse relay wire, and install included 3-way connector. Reconnect the reverse relay connector previously disconnected. Figs. 7-8

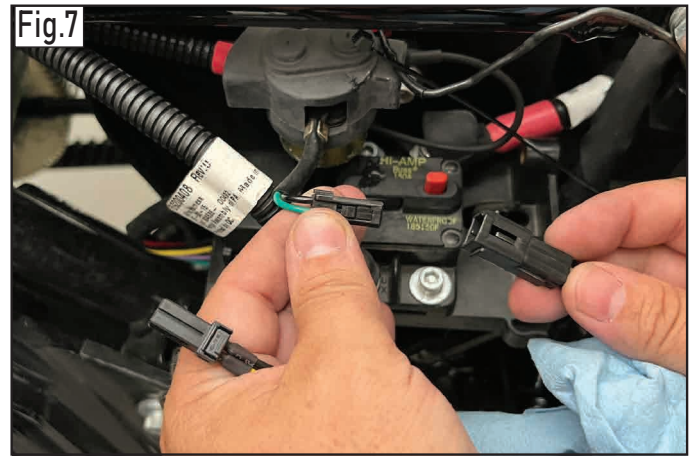
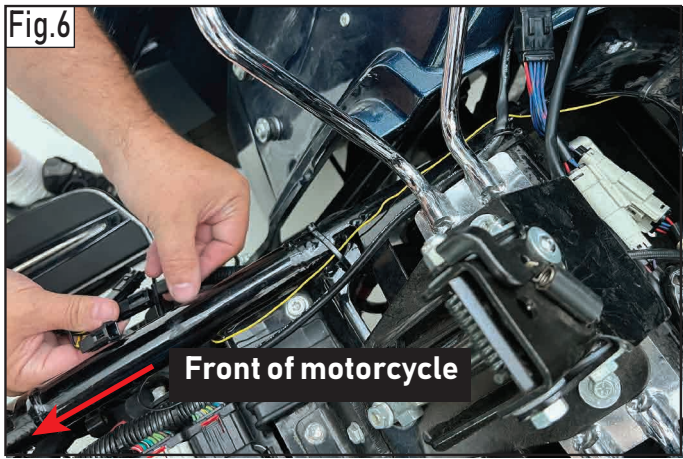

16. Loosely install included connectors into 3-way connector, then push yellow wire terminal into place, aligning with the yellow wires of the installed 3-way connector. Connector will snap into place. Pay careful attention to the orientation of the terminal. Close terminal lock once connector wire is in place. Fig. 9
17. Turn on motorcycle and carefully test all functions. Run, turn and brake should all be activated by normal use of the motorcycle's controls. The reverse light will come on when the reverse button is operated, and stay illuminated for approximately 10 seconds after releasing the reverse button.
18. Secure wires using included cable ties and retainers. Additional customer supplied tape may be used if needed. Replace trunk liners.
19. Reinstall side cover and seat.

