



DUDLEY LAKE

3-5 Bedrooms | 2.5-3.5 Baths | 3 Car Garage

MAIN LEVEL:
OPT. LOWER LEVEL:
TOTAL FINISHED:

2496 SQ FT
1500+ SQ FT
3996+ SQ FT

FOOTPRINT:
96' WIDE
85' DEEP

SCAN HERE:



PLANS, IMAGES, AND COPIES THEREOF ARE PROTECTED UNDER THE COPYRIGHT LAWS OF THE UNITED STATES AND SHALL REMAIN AT ALL TIMES THE PROPERTY OF ROCKY MOUNTAIN PLAN CO., LLC, ITS SUCCESSORS AND ASSIGNS



- FEATURES:**
- VAULTED CEILING AND TRUSS DETAILS BRING MODERN LODGE STYLE TO THIS COMFORTABLE OPEN FLOOR PLAN
 - EASY ONE-LEVEL LIVING WITH THREE MAIN-LEVEL BEDROOMS PLUS A STUDY TO WORK FROM HOME
 - PRIMARY SUITE WING ENJOYS A SPA-LIKE BATH, LARGE CLOSETS, AND COVERED DECK ACCESS
 - GOURMET KITCHEN IS OPEN TO DINING ROOM AND GREAT ROOM WITH FIREPLACE AND VIEWS
 - OPTIONAL LOWER LEVEL EXPANDS THIS HOME TO ADD TWO ADDITIONAL BEDROOMS, PLUS A GAME AND REC ROOM



REAR ELEVATION SHOWN WITH WALKOUT LOWER LEVEL

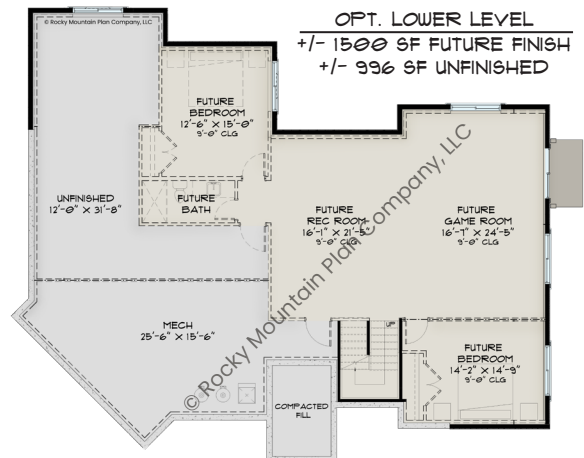

VISIT WWW.ROCKYMOUNTAINPLAN.COM TO ORDER THIS PLAN