

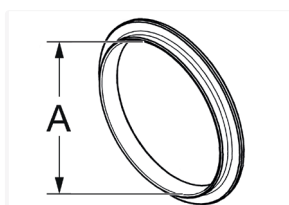

Retraction system spare parts

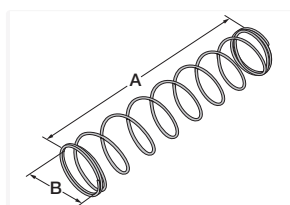
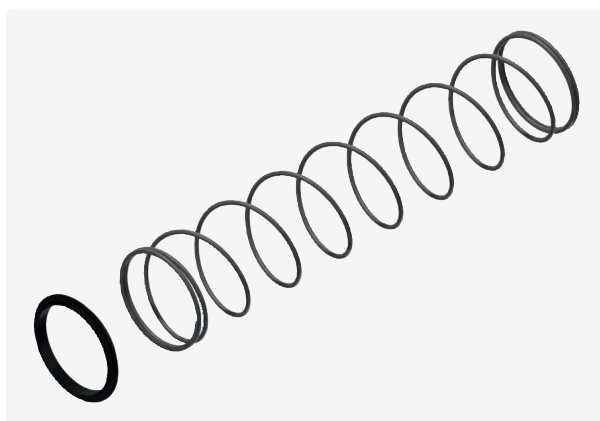

Product information

Replacement parts for retraction system.
For centering rings, a center ball joint type KMG/G is additionally required.
Type R-FES spring end pieces are inserted directly into a system holder.
From size 56 Jumbo the R-FES is used together with the TRO-70.

PU pcs.: 1

Information, conformities and approvals



| Article | Order No. | Color | A mm | B mm | Suitable for EW-PAE | Suitable for EWX-PAE |
|----------------------------|-----------|----------------|------|------|---------------------|----------------------|
| Compression spring | | | | | | |
| M25/P21 compression spring | 83692754 | Material color | 164 | 30 | M25/P21 | M25/P21 |
| M32/P29 compression spring | 83692756 | Material color | 164 | 38 | M32/P29 | M32/P29 |
| R-FED 40-350 | 83952440 | Material color | 350 | 53 | | |
| R-FED 40-600 | 83952442 | Material color | 600 | 52 | | |
| R-FED 50-350 | 83952450 | Material color | 350 | 62 | | |
| R-FED 50-600 | 83952452 | Material color | 600 | 62 | | |
| R-FED 56-500 | 83952456 | Material color | 500 | 75 | | |
| R-FED 56-800 | 83952458 | Material color | 800 | 75 | | |
| R-FED 70-250 | 83692714 | Material color | 250 | 91.5 | | |
| R-FED 70-800 | 83952464 | Material color | 800 | 88 | | |



Retraction system spare parts

| Article | Order No. | Color | A mm | B mm | Suitable for EW-PAE | Suitable for EWX-PAE |
|---------------------------------------|-----------|-------|------|------|---------------------|----------------------|
| Pressure spring with end piece | | | | | | |
| M25/P21 centring device | 83692702 | Black | 36 | | M25/P21 | M25/P21 |
| M32/P29 centring device | 83692704 | Black | 42 | | M32/P29 | M32/P29 |
| R-FES M40/P36 | 83692705 | Black | 47 | | | |
| R-FES M50/P48 | 83692706 | Black | 57 | | | |
| R-FES 56 Jumbo | 83692707 | Black | 72.5 | | | |
| R-FES 70 Jumbo | 83692708 | Black | 82.5 | | | |

Technical information



Halogen-free

Conformity



RoHS (EC Directive
2011/65/EU)

Approvals and operating permits



ROBI approval

All details given in our sales brochures and catalogues, as well as the information available online, are based on our current knowledge of the products described. The electronic data and files made available by Murrplastik, particularly CAD files are based on our current knowledge of the product described. A legally binding assurance of certain properties or the suitability for a certain purpose can not be determined from this information. All information with respect to the chemical and physical properties of Murrplastik products, as well as application advice given verbally, in writing or by tests, is given to the best of our knowledge. They do not release the buyer from the obligation to carry out his own tests and trials in order to determine the concrete suitability of the products for the intended purpose. Murrplastik accepts no responsibility for the available information being up-to-date, correct or complete. Neither do we accept responsibility for the quality of this information. Murrplastik accepts no liability for damage caused as a result of using our products. Murrplastik reserves the right to make technical changes and improvements through constant further development of products and services. Our General Terms and Conditions apply.